

FOR KCC USE:

FORM C-1 7/91

FORM MUST BE TYPED

FORM MUST BE SIGNED

ALL BLANKS MUST BE FILLED

EFFECTIVE DATE: 11-3-92

State of Kansas

*COR

DISTRICT # 1

NOTICE OF INTENTION TO DRILL

SEAT... Yes. No

Must be approved by the K.C.C. five (5) days prior to commencing well

Expected Spud Date 11/11/92 month day year

Spot NE NW Sec 3 Twp 19S Rg 20 East West

OPERATOR: License # 8061 Name: Oil Producers, Inc. of Kansas Address: P.O. Box 8647 City/State/Zip: Wichita, Ks. 67208 Contact Person: John S. Weir Phone: 316 681-0231

4620 feet from South / North line of Section 3630 feet from East / West line of Section IS SECTION X REGULAR IRREGULAR

CONTRACTOR: License #: 4958 Name: Mallard JV Inc.

(NOTE: Locate well on the Section Plat on Reverse Side) County: Rush Lease Name: Brack Well #: 1 Field Name:

Well Drilled For: Well Class: Type Equipment:

- X Oil Enh Rec X Infield X Mud Rotary Gas Storage Pool Ext. Air Rotary OWD Disposal Wildcat Cable Seismic; # of Holes Other

Is this a Prorated/Spaced Field? Cherokee Sand yes X no Target Formation(s): 330 Nearest lease or unit boundary: 330

If OWD: old well information as follows:

Operator: Well Name: Comp. Date: Old Total Depth

Ground Surface Elevation: feet MSL Water well within one-quarter mile: yes X no Public water supply well within one mile: yes X no

Directional, Deviated or Horizontal wellbore? yes X no

If yes, true vertical depth: Bottom Hole Location:

Depth to bottom of fresh water: 330 Depth to bottom of usable water: 320 Surface Pipe by Alternate: 1 X 2 Length of Surface Pipe Planned to be set: 260

Length of Conductor pipe required: 4200 Projected Total Depth: Formation at Total Depth:

Water Source for Drilling Operations: well farm pond X other DWR Permit #: Will Cores Be Taken?: yes no

If yes, proposed zone:

was #15-165-21, 261

AFFIDAVIT * IS # 15-165-21, 621

The undersigned hereby affirms that the drilling, completion and eventual plugging of this well will comply with K.S.A. 55-101, et. seq. It is agreed that the following minimum requirements will be met:

- 1. Notify the appropriate district office prior to spudding of well; 2. A copy of the approved notice of intent to drill shall be posted on each drilling rig; 3. The minimum amount of surface pipe as specified below shall be set by circulating cement to the top; in all cases surface pipe shall be set through all unconsolidated materials plus a minimum of 20 feet into the underlying formation; 4. If the well is dry hole, an agreement between the operator and the district office on plug length and placement is necessary prior to plugging; 5. The appropriate district office will be notified before well is either plugged or production casing is cemented in; 6. IF AN ALTERNATE II COMPLETION, PRODUCTION PIPE SHALL BE CEMENTED FROM BELOW ANY USABLE WATER TO SURFACE WITHIN 120 DAYS OF SPUD DATE. IN ALL CASES, NOTIFY DISTRICT OFFICE PRIOR TO ANY CEMENTING.

I hereby certify that the statements made herein are true and to the best of my knowledge and belief.

Date: 10/28/92 Signature of Operator or Agent: Title: President

FOR KCC USE: API # 15-165-21,621-0000 Conductor pipe required None feet Minimum surface pipe required 200 feet per Alt. X(2) Approved by: CB 10-30-92 This authorization expires: 4-30-93 (This authorization void if drilling not started within 6 months of effective date.) Spud date: Agent:

11/2/92

RECEIVED STATE CORPORATION COMMISSION

OCT 30 1992 10-30-92 CONSERVATION DIVISION Wichita, Kansas

REMEMBER TO:

- File Drill Pit Application (form CDP-1) with Intent to Drill; - File Completion Form ACO-1 within 120 days of spud date; - File acreage attribution plat according to field proration orders; - Notify appropriate district office 48 hours prior to workover or re-entry; - Submit plugging report (CP-4) after plugging is completed; - Obtain written approval before disposing or injecting salt water.

Mail to: Conservation Division, 200 Colorado Derby Building, 202 W. First St., Wichita, Kansas 67202-1286.

M 19 20

IN ALL CASES PLOT THE INTENDED WELL ON THE PLAT BELOW

PLAT OF ACREAGE ATTRIBUTABLE TO A WELL IN A PRORATED OR SPACED FIELD

If the intended well is in a prorated or spaced field, please fully complete this side of the form. If the intended well is in a prorated or spaced field complete the plat below showing that the well will be properly located in relationship to other wells producing from the common source of supply. Please show all the wells within 1 mile of the boundaries of the proposed acreage attribution unit for gas wells and within 1/2 mile of the boundaries of the proposed acreage attribution unit for oil wells.

API NO. 15- _____
 OPERATOR Oil Producers, Inc. of Kansas
 LEASE Brack
 WELL NUMBER #1
 FIELD _____

LOCATION OF WELL: COUNTY Rush
4620 feet from south/north line of section
3630 feet from east/west line of section
 SECTION 3 TWP 19S RG 20W

NUMBER OF ACRES ATTRIBUTABLE TO WELL _____
 QTR/QTR/QTR OF ACREAGE _____

IS SECTION _____ REGULAR or _____ IRREGULAR
IF SECTION IS IRREGULAR, LOCATE WELL FROM NEAREST CORNER BOUNDARY.

Section corner used: _____ NE _____ NW _____ SE _____ SW

PLAT

(Show location of the well and shade attributable acreage for prorated or spaced wells.)
 (Show footage to the nearest lease or unit boundary line.)

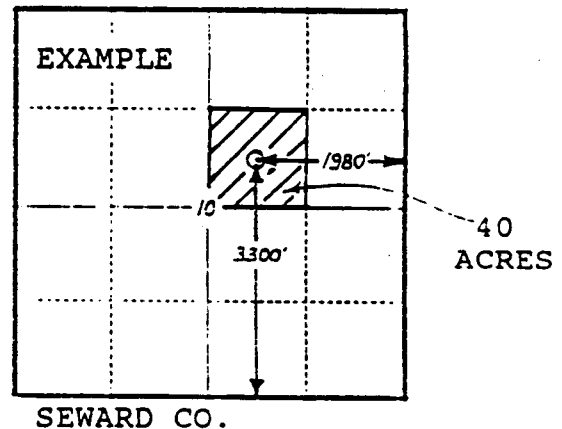
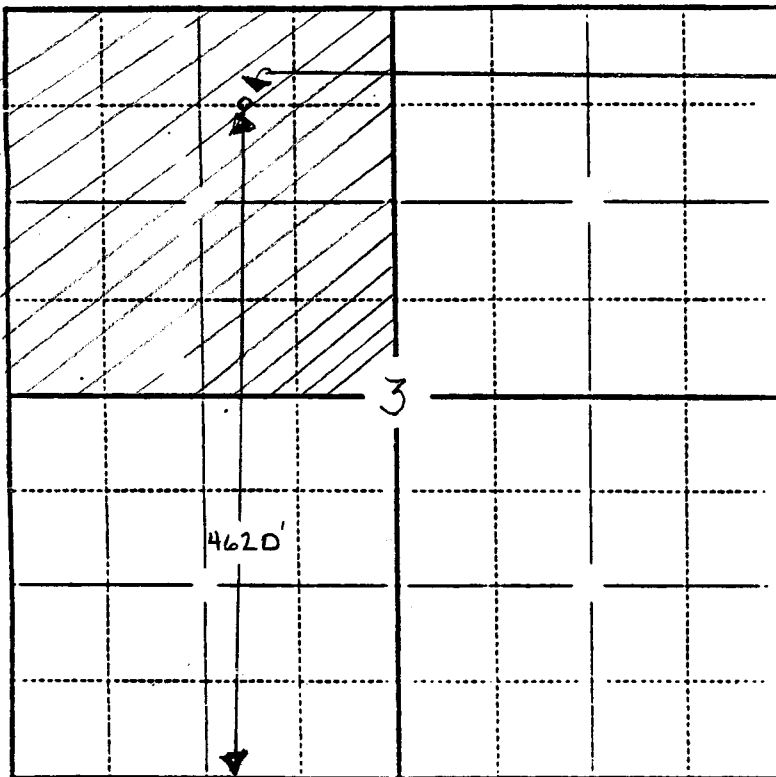

In plotting the proposed location of the well, you must show:

- 1) The manner in which you are using the depicted plat by identifying section lines, i.e. 1 section, 1 section with 8 surrounding sections, 4 sections, etc.;
- 2) the distance of the proposed drilling location from the section's south/north and east/west lines; and
- 3) the distance to the nearest lease or unit boundary line.