

FOR KCC USE:

EFFECTIVE DATE: 3-2-93

DISTRICT # 1

SEAT... Yes No

State of Kansas

NOTICE OF INTENTION TO DRILL

Must be approved by the K.C.C. five (5) days prior to commencing well

Request Confidential

FORM C-1 7/91

FORM MUST BE TYPED

FORM MUST BE SIGNED

ALL BLANKS MUST BE FILLED

Expected Spud Date 3 15 93
month day year

Spot SW NE SE Sec 2 Twp 19 S, Rg 20 East West

OPERATOR: License # 04782
Name: Ensign Operating Co.
Address: 621 17th St., Suite 1800
City/State/Zip: Denver, Co. 80293
Contact Person: J. C. SIMMONS
Phone: (303) 293-9999

1900 feet from South ~~XXXX~~ line of Section
 800 feet from East / ~~XXXX~~ line of Section

IS SECTION REGULAR IRREGULAR?
(NOTE: Locate well on the Section Plat on Reverse Side)
County: Rush

Lease Name: Wright Well #: 1-2
Field Name: Flavids

Is this a Prorated/Spaced Field? ... yes no

Target Formation(s): Mississippian
Nearest lease or unit boundary: 800

Ground Surface Elevation: 2163 feet MSL
Water well within one-quarter mile: ... yes no

Public water supply well within one mile: ... yes no

Depth to bottom of fresh water: 400
Depth to bottom of usable water: 460 620

Surface Pipe by Alternate: 1 2
Length of Surface Pipe Planned to be set: 590 640

Length of Conductor pipe required: N/A
Projected Total Depth: 4350

Formation at Total Depth: Mississippian
Water Source for Drilling Operations:

DWR Permit #: ? well farm pond other

Will Cores Be Taken?: ... yes no

If yes, proposed zone:

Well Drilled For: Well Class: Type Equipment:

Oil Enh Rec Infield Mud Rotary
 Gas Storage Pool Ext. Air Rotary
 OWD Disposal Wildcat Cable
 Seismic; # of Holes Other

If OWD: old well information as follows:

Operator:
Well Name:
Comp. Date: Old Total Depth

Directional, Deviated or Horizontal wellbore? ... yes no

If yes, true vertical depth:

Bottom Hole Location:

** was se ne se*

AFFIRAVIT ** sw ne se*

The undersigned hereby affirms that the drilling, completion and eventual plugging of this well will comply with K.S.A. 55-101, et. seq.

It is agreed that the following minimum requirements will be met:

1. Notify the appropriate district office prior to spudding of well;
2. A copy of the approved notice of intent to drill shall be posted on each drilling rig;
3. The minimum amount of surface pipe as specified below shall be set by circulating cement to the top; in all cases surface pipe shall be set through all unconsolidated materials plus a minimum of 20 feet into the underlying formation;
4. If the well is dry hole, an agreement between the operator and the district office on plug length and placement is necessary prior to plugging;
5. The appropriate district office will be notified before well is either plugged or production casing is cemented in;
6. IF AN ALTERNATE IS COMPLETED, PRODUCTION PIPE SHALL BE CEMENTED FROM BELOW ANY USABLE WATER TO SURFACE WITHIN 120 DAYS OF SPUD DATE. IN ALL CASES, NOTIFY DISTRICT OFFICE PRIOR TO ANY CEMENTING.

I hereby certify that the statements made herein are true and to the best of my knowledge and belief.

Date: 2/18/93 Signature of Operator or Agent: Connie Smith Title: Sr. Engineering Tech.

FOR KCC USE:
API # 15- 165-21,629-0000
Conductor pipe required None feet
Minimum surface pipe required 640 feet per Alt.
Approved by: CB 2-25-93

This authorization expires: 8-25-93
(This authorization void if drilling not started within 6 months of effective date.)
Spud date: _____ Agent: _____

3-893

N

REMEMBER TO:

- File Drill Pit Application (form CDP-1) with Intent to Drill;
- File Completion Form ACO-1 within 120 days of spud date;
- File acreage attribution plat according to field proration orders;
- Notify appropriate district office 48 hours prior to workover or re-entry;
- Submit plugging report (CP-4) after plugging is completed;
- Obtain written approval before disposing or injecting salt water.

Mail to: Conservation Division, 208 Colorado Derby Building, 202 W. First St., Wichita, Kansas 67202-1286.

RECEIVED STATE CORPORATION COMMISSION

FEB 22 1993

2-22-93

CONSERVATION DIVISION
Wichita, Kansas

N

IN ALL CASES PLOT THE INTENDED WELL ON THE PLAT BELOW

PLAT OF ACREAGE ATTRIBUTABLE TO A WELL IN A PRORATED OR SPACED FIELD

If the intended well is in a prorated or spaced field, please fully complete this side of the form. If the intended well is in a prorated or spaced field complete the plat below showing that the well will be properly located in relationship to other wells producing from the common source of supply. Please show all the wells within 1 mile of the boundaries of the proposed acreage attribution unit for gas wells and within 1/2 mile of the boundaries of the proposed acreage attribution unit for oil wells.

API NO. 15- _____
 OPERATOR _____ LOCATION OF WELL: COUNTY _____
 LEASE _____ feet from south/north line of section _____
 WELL NUMBER _____ feet from east/west line of section _____
 FIELD _____ SECTION _____ TWP _____ RG _____

NUMBER OF ACRES ATTRIBUTABLE TO WELL _____ IS SECTION _____ REGULAR or _____ IRREGULAR
 QTR/QTR/QTR OF ACREAGE _____ IF SECTION IS IRREGULAR, LOCATE WELL FROM NEAREST CORNER BOUNDARY.

Section corner used: _____ NE _____ NW _____ SE _____ SW

PLAT

(Show location of the well and shade attributable acreage for prorated or spaced wells.)
 (Show footage to the nearest lease or unit boundary line.)

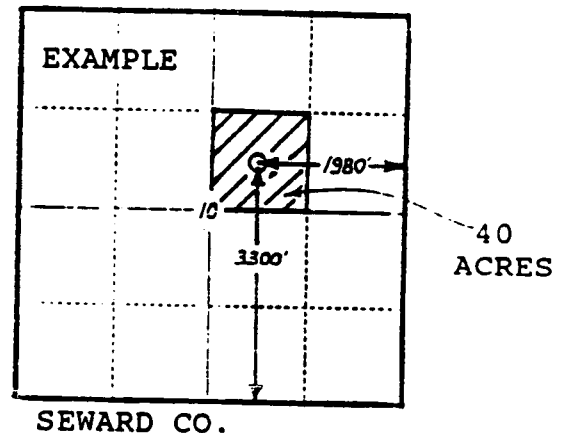
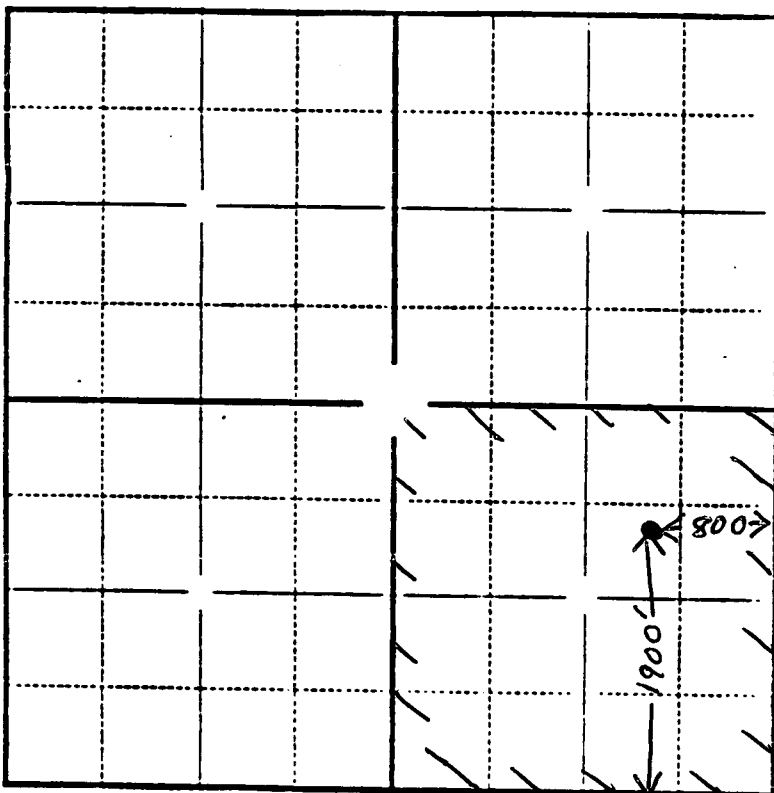

In plotting the proposed location of the well, you must show:

- 1) The manner in which you are using the depicted plat by identifying section lines, i.e. 1 section, 1 section with 8 surrounding sections, 4 sections, etc.;
- 2) the distance of the proposed drilling location from the section's south/north and east/west lines; and
- 3) the distance to the nearest lease or unit boundary line.