

EFFECTIVE DATE: 1-8-91

FORM MUST BE TYPED  
FORM C-1 4/90

State of Kansas  
NOTICE OF INTENTION TO DRILL

FORM MUST BE SIGNED  
ALL BLANKS MUST BE FILLED

Must be approved by the K.C.C. five (5) days prior to commencing well

Expected Spud Date January 12 1991 C N2 SE NE Sec 26 Twp 18 S, Rg 18 <sup>X East</sup> West

OPERATOR: License # 5027  
Name: J. A. ALLISON  
Address: 300 West Douglas, Suite 305  
City/State/Zip: Wichita, Kansas 67202  
Contact Person: J. A. Allison  
Phone: 316-263-2241

3630 feet from South line of Section  
660 feet from East line of Section  
(Note: Locate well on Section Plat on Reverse Side)

CONTRACTOR: License #: 5122  
Name: Woodman-Iannitti Drilling Co.

County: RUSH  
Lease Name: TAMMEN Well #: 2  
Field Name: Rush Center South  
Is this a Prorated Field? ... yes X no  
Target Formation(s): Arbuckle  
Nearest lease or unit boundary: 330  
Ground Surface Elevation: 1985 feet MSL  
Domestic well within 330 feet: ... yes X no  
Municipal well within one mile: ... yes X no  
Depth to bottom of fresh water: 250 200  
Depth to bottom of usable water: 450 550  
Surface Pipe by Alternate: X 1 ... 2  
Length of Surface Pipe Planned to be set: 1111  
Length of Conductor pipe required: None  
Projected Total Depth: 3748'  
Formation at Total Depth: Arbuckle  
Water Source for Drilling Operations:  
... well ... farm pond X other  
DWR Permit #: \_\_\_\_\_  
Will Cores Be Taken?: ... yes X no  
If yes, proposed zone: \_\_\_\_\_

Well Drilled For: Well Class: Type Equipment:  
X Oil ... Inj X Infield X Mud Rotary  
... Gas ... Storage ... Pool Ext. ... Air Rotary  
... OWWO ... Disposal ... Wildcat ... Cable  
... Seismic; ... # of Holes

If OWWO: old well information as follows:  
Operator: \_\_\_\_\_  
Well Name: \_\_\_\_\_  
Comp. Date: \_\_\_\_\_ Old Total Depth \_\_\_\_\_

Directional, Deviated or Horizontal wellbore? ... yes X no  
If yes, total depth location: \_\_\_\_\_

**AFFIDAVIT**

The undersigned hereby affirms that the drilling, completion and eventual plugging of this well will comply with K.S.A. 55-101, et. seq.

It is agreed that the following minimum requirements will be met:

1. The appropriate district office shall be notified before setting surface pipe;
2. The minimum amount of surface pipe as specified above shall be set by circulating cement to the top; in all cases surface pipe shall be set through all unconsolidated materials plus a minimum of 20 feet into the underlying formation;
3. If the well is dry, a plugging proposal shall be submitted to the district office. An agreement between the operator and the district office on plug length and placement is necessary prior to plugging;
4. The appropriate district office will be notified before well is either plugged or production casing is cemented in;
5. If an Alternate II completion, production pipe shall be cemented from below any usable water to surface within 120 days of spud date. In all cases, notify district office prior to any cementing.

I hereby certify that the statements made herein are true and to the best of my knowledge and belief.

Date: Dec...27...1990 Signature of Operator or Agent: J. A. Allison Title: Operator

FOR KCC USE:

API # 15- 165-21,542-0000  
 Conductor pipe required None feet  
 Minimum surface pipe required 550 feet per Alt. ① 2  
 Approved by: MLW 1-3-91  
 EFFECTIVE DATE: 1-8-91  
 This authorization expires: 7-3-91  
 (This authorization void if drilling not started within 6 months of effective date.)  
 Spud date: \_\_\_\_\_ Agent: \_\_\_\_\_

RECEIVED  
 STATE CORPORATION COMMISSION  
 DEC 28 1990  
 12-28-90  
 CONSERVATION DIVISION  
 Wichita, Kansas

MLW  
 18  
 18W

**REMEMBER TO:**

- File Drill Pit Application (form CDP-1) with Intent to Drill;
- File Completion Form ACO-1 within 120 days of spud date;
- File acreage attribution plat according to field proration orders;
- Notify appropriate district office 48 hours prior to workover or re-entry;
- Submit plugging report (CP-4) after plugging is completed;
- Obtain written approval before disposing or injecting salt water.

**PLAT OF ACREAGE ATTRIBUTABLE TO A WELL**

State Corporation Commission, Conservation Division  
200 Colorado Derby Bldg. Wichita, Kansas 67202

OPERATOR J. A. ALLISON LOCATION OF WELL:  
 LEASE TAMMEN 3630 feet north of SE corner  
 WELL NUMBER 2 660 feet west of SE corner  
 FIELD Rush Center South C N2 SE NE Sec. 26 T 18 R 18 XE/W  
 COUNTY RUSH  
 NO. OF ACRES ATTRIBUTABLE TO WELL 40 IS SECTION X REGULAR IRREGULAR?  
 IF IRREGULAR, LOCATE WELL FROM NEAREST  
 DESCRIPTION OF ACREAGE SE NE CORNER BOUNDARY.

NOTE: If plat depicted is insufficient for your circumstances, you may attach your own scaled or surveyed plat.

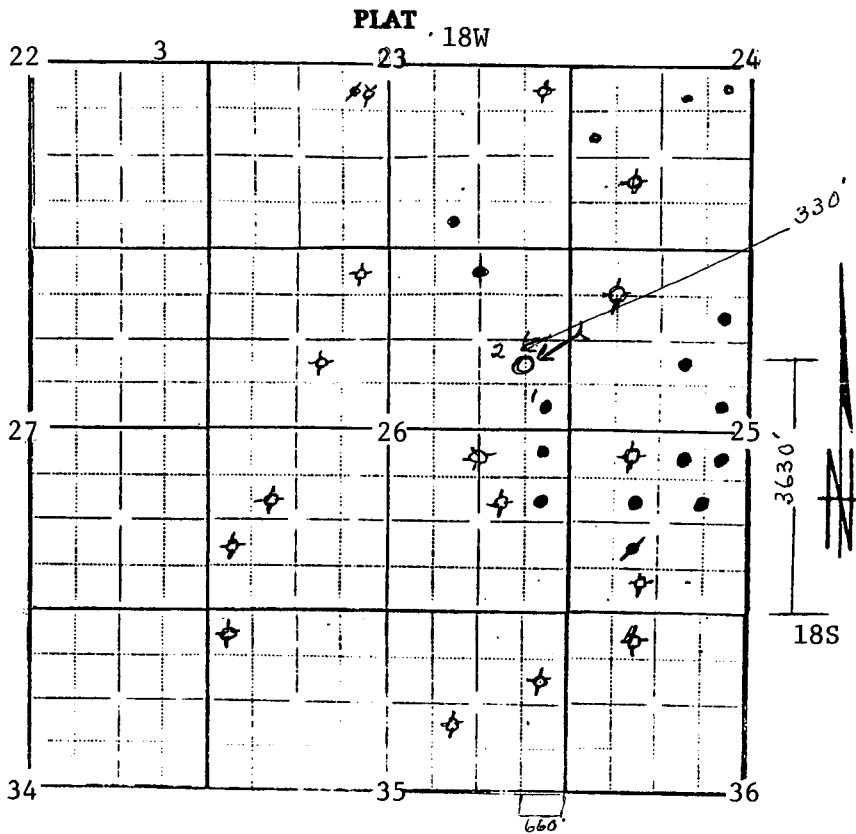

In plotting the proposed location of the well, you must show:

- 1) The manner in which you are using the depicted plat by identifying section lines, i.e. 1 section, section with 8 surrounding partial sections, 4 sections, 16 sections, etc.;
- 2) the well's location relative to the location of other wells producing from the same common source of supply in adjoining drilling units pursuant to K.A.R. 82-3-108, 82-3-207, 82-3-312, or special orders of the Commission;
- 3) the distance of the proposed drilling location from the section's east and south lines; and
- 4) the distance to the nearest lease or unit boundary line.

I hereby certify that the statements made herein are true and to the best of my knowledge and belief.

Signature of Operator or Agent J. A. Allison  
 Title Operator

Date Dec. 27, 1990