

For KCC Use: 7.21.02  
 Effective Date: \_\_\_\_\_  
 District # \_\_\_\_\_  
 SGA?  Yes  No

KANSAS CORPORATION COMMISSION  
 OIL & GAS CONSERVATION DIVISION  
**NOTICE OF INTENT TO DRILL**

**CORRECTED**

Form C-1  
 September 1999  
 Form must be Typed  
 Form must be Signed  
 All blanks must be Filled

Must be approved by KCC five (5) days prior to commencing well

**\*\*Corrected\*\***

Expected Spud Date August 3 2002  
month day year

Spot 20'S&70'W of \*\*\*  
C W/2 SE Sec. 11 Twp. 18 S. R. 18W  East  West  
1300 feet from (S) (circle one) Line of Section  
2050 feet from (E) (circle one) Line of Section  
 Is SECTION  Regular  Irregular?

OPERATOR: License# 6170 **RECEIVED**  
 Name: GLOBE OPERATING, INC.  
 Address: P.O. Box 12 AUG 15 2002  
 City/State/Zip: Great Bend, KS 67530 8-15-02  
 Contact Person: Richard Stalcup **KCC WICHITA**  
 Phone: (620) 792-7607

(Note: Locate well on the Section Plat on reverse side)  
 County: Rush  
 Lease Name: Zetko Well #: 1  
 Field Name: Wildcat

CONTRACTOR: License# 31548  
 Name: Discovery Drilling Co., Inc.

<b>Well Drilled For:</b>	<b>Well Class:</b>	<b>Type Equipment:</b>
<input checked="" type="checkbox"/> Oil	<input type="checkbox"/> Enh Rec	<input checked="" type="checkbox"/> Mud Rotary
<input type="checkbox"/> Gas	<input type="checkbox"/> Storage	<input type="checkbox"/> Air Rotary
<input type="checkbox"/> OWWO	<input type="checkbox"/> Disposal	<input type="checkbox"/> Cable
<input type="checkbox"/> Seismic; _____ # of Holes	<input checked="" type="checkbox"/> Wildcat	
<input type="checkbox"/> Other _____	<input type="checkbox"/> Infield	
	<input type="checkbox"/> Pool Ext.	
	<input type="checkbox"/> Other	

Is this a Prorated / Spaced Field?  Yes  No  
 Target Information(s): Arbuckle  
 Nearest Lease or unit boundary: 590'  
 Ground Surface Elevation: 2055 feet MSL  
 Water well within one-quarter mile:  Yes  No  
 Public water supply well within one mile:  Yes  No  
 Depth to bottom of fresh water: 320'  
 Depth to bottom of usable water: 440'  
 Surface Pipe by Alternate:  1  2  
 Length of Surface Pipe Planned to be set: 1250'  
 Length of Conductor Pipe required: None  
 Projected Total Depth: 3860  
 Producing Formation Target: Arbuckle  
 Water Source for Drilling Operations:  
 Well \_\_\_\_\_ Farm Pond  Other \_\_\_\_\_  
 DWR Permit #: \_\_\_\_\_  
 (Note: Apply for Permit with DWR )  
 Will Cores be taken?  Yes  No  
 If Yes, proposed zone: \_\_\_\_\_

If OWWO: old well information as follows:  
 Operator: \_\_\_\_\_  
 Well Name: \_\_\_\_\_  
 Original Completion Date: \_\_\_\_\_ Original Total Depth: \_\_\_\_\_  
 Directional, Deviated or Horizontal wellbore?  Yes  No  
 If Yes, true vertical depth: \_\_\_\_\_  
 Bottom Hole Location: \_\_\_\_\_  
 KCC DKT #: \_\_\_\_\_

**AFFIDAVIT**

\*\*\*\*Was 20'S&30'E

Is 20'&70'W of C/w/2/SE

The undersigned hereby affirms that the drilling, completion and eventual plugging of this well will comply with K.S.A. 55-101, et. seq.

It is agreed that the following minimum requirements will be met:

1. Notify the appropriate district office **prior** to spudding of well;
2. A copy of the approved notice of intent to drill **shall be** posted on each drilling rig;
3. The minimum amount of surface pipe as specified below **shall be set** by circulating cement to the top; in all cases surface pipe **shall be set** through all unconsolidated materials plus a minimum of 20 feet into the underlying formation.
4. If the well is dry hole, an agreement between the operator and the district office on plug length and placement is necessary **prior to plugging**;
5. The appropriate district office will be notified before well is either plugged or production casing is cemented in;
6. If an ALTERNATE II COMPLETION, production pipe shall be cemented from below any usable water to surface within **120 days** of spud date. **In all cases, NOTIFY district office** prior to any cementing.

I hereby certify that the statements made herein are true and to the best of my knowledge and belief.

Date: August 1, 2002 Signature of Operator or Agent: Thomas A. Allen Title: Agent

**For KCC Use ONLY**

API # 15 - 165-21744.00-00  
 Conductor pipe required NONE feet  
 Minimum surface pipe required 460 feet per Alt. (1)  
 Approved by: RJP 7.16.02 / RJP 8.15.02  
 This authorization expires: 1-16-03  
 (This authorization void if drilling not started within 6 months of effective date.)  
 Spud date: \_\_\_\_\_ Agent: \_\_\_\_\_

**Remember to:**

- File Drill Pit Application (form CDP-1) with Intent to Drill;
- File Completion Form ACO-1 within 120 days of spud date;
- File acreage attribution plat according to field proration orders;
- Notify appropriate district office 48 hours prior to workover or re-entry;
- Submit plugging report (CP-4) after plugging is completed;
- Obtain written approval before disposing or injecting salt water.

11  
18  
18W

**IN ALL CASES PLOT THE INTENDED WELL ON THE PLAT BELOW**

*Plat of acreage attributable to a well in a prorated or spaced field*

*If the intended well is in a prorated or spaced field, please fully complete this side of the form.* If the intended well is in a prorated or spaced field complete the plat below showing that the well will be properly located in relationship to other wells producing from the common source of supply. Please show all the wells and within 1 mile of the boundaries of the proposed acreage attribution unit for gas wells and within 1/2 mile of the boundaries of the proposed acreage attribution unit for oil wells.

API No. 15 - \_\_\_\_\_  
 Operator: GLOBE OPERATING, INC.  
 Lease: Zetko  
 Well Number: 1  
 Field: Wildcat  
 Number of Acres attributable to well: 160  
 QTR / QTR / QTR of acreage: \_\_\_\_\_ - \_\_\_\_\_ - \_\_\_\_\_

Location of Well: County: Rush  
 \_\_\_\_\_ 1300 feet from  /  (circle one) Line of Section  
 \_\_\_\_\_ 2050 feet from  /  (circle one) Line of Section  
 Sec. 11 Twp. 18 S. R. 18W  East  West

Is Section X Regular or \_\_\_\_\_ Irregular

**If Section is Irregular, locate well from nearest corner boundary.**  
 Section corner used: \_\_\_NE \_\_\_NW \_\_\_SE \_\_\_SW

**PLAT**

*(Show location of the well and shade attributable acreage for prorated or spaced wells.)  
 (Show footage to the nearest lease or unit boundary line.)*

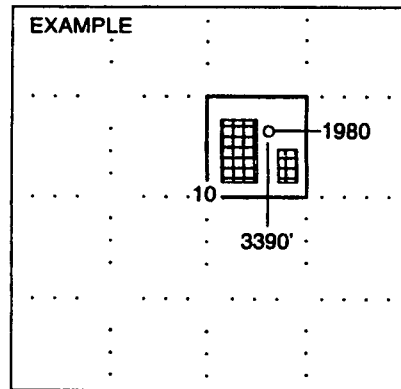
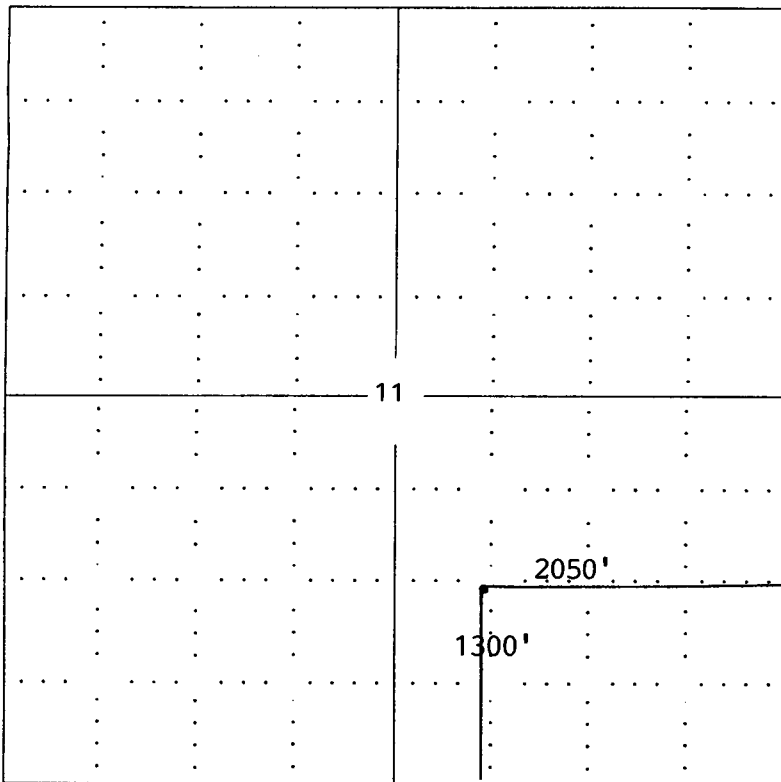

SEWARD CO.

**NOTE: In all cases locate the spot of the proposed drilling location.**

Rush Co., KS

**In plotting the proposed location of the well, you must show:**

1. The manner in which you are using the depicted plat by identifying section lines, i.e. 1 section, 1 section with 8 surrounding sections, 4 sections, etc.
2. The distance of the proposed drilling location from the section's south / north and east / west.
3. The distance to the nearest lease or unit boundary line.
4. If proposed location is located within a prorated or spaced field a certificate of acreage attribution plat must be attached: (CO-7 for oil wells; CG-8 for gas wells).