

EFFECTIVE DATE: 6-4-96

State of Kansas

FORM MUST BE SIGNED

DISTRICT # 4

NOTICE OF INTENTION TO DRILL

ALL BLANKS MUST BE FILLED

SGA? Yes  No

Must be approved by the K.C.C. five (5) days prior to commencing well.

Expected Spud Date 06 03 96  
month day year

Spot 150' S. NW. SE. Sec. 35. Twp. 20 S, Rg 35. XX East West

OPERATOR: License # 5393 ✓  
Name: A. L. Abercrombie Inc.  
Address: .150 N. Main, Ste 801  
City/State/Zip: Wichita, Ks. 67202  
Contact Person: Jerry Langhrer  
Phone: 316-262-1841

...1830..... feet from South / ~~North~~ line of Section  
...1980..... feet from East / ~~West~~ line of Section  
IS SECTION X REGULAR IRREGULAR?

(NOTE: Locate well on the Section Plat on Reverse Side)  
County: Wichita  
Lease Name: Moody Well #: 3  
Field Name: .....

CONTRACTOR: License #: 30684 ✓  
Name: Abercrombie RTD, Inc.

Is this a Prorated/Spaced Field? .... yes XX no ✓  
Target Formation(s): Marmaton  
Nearest lease or unit boundary: 660  
Ground Surface Elevation: 3155 est. feet MSL

Well Drilled For: Well Class: Type Equipment:  
XX Oil ... Enh Rec ... Infield XX Mud Rotary  
... Gas ... Storage XX Pool Ext. ... Air Rotary  
... OWD ... Disposal ... Wildcat ... Cable  
... Seismic; ... # of Holes ... Other

Water well within one-quarter mile: .... yes XX no  
Public water supply well within one mile: .... yes XX no  
Depth to bottom of fresh water: ..... 100' / 180'  
Depth to bottom of usable water: ..... 1150' ✓  
Surface Pipe by Alternate: .... 1 XX 2

If OWD: old well information as follows:  
Operator: .....  
Well Name: .....  
Comp. Date: ..... Old Total Depth .....

Length of Surface Pipe Planned to be set: ..... 240'  
Length of Conductor pipe required: ..... -0-  
Projected Total Depth: ..... 5100'  
Formation at Total Depth: Mississippi  
Water Source for Drilling Operations:  
... well .... farm pond XX other

Directional, Deviated or Horizontal wellbore? .... yes XX no  
If yes, true vertical depth:.....  
Bottom Hole Location.....

Will Cores Be Taken?: .... yes XX no  
If yes, proposed zone: .....

AFFIDAVIT

RECEIVED

The undersigned hereby affirms that the drilling, completion and eventual plugging of this well will comply with K.S.A. 55-101, et. seq.

It is agreed that the following minimum requirements will be met:

KANSAS CORPORATION COMMISSION

MAY 30 1996

5-30-96

1. Notify the appropriate district office prior to spudding of well;
2. A copy of the approved notice of intent to drill shall be posted on each drilling rig;
3. The minimum amount of surface pipe as specified below shall be set by circulating cement to the top in all cases. Surface pipe shall be set through all unconsolidated materials plus a minimum of 20 feet into the underlying formation;
4. If the well is dry hole, an agreement between the operator and the district office on plug length and placement is necessary prior to plugging;
5. The appropriate district office will be notified before well is either plugged or production casing is cemented in;
6. IF AN ALTERNATE II COMPLETION, PRODUCTION PIPE SHALL BE CEMENTED FROM BELOW ANY USABLE WATER TO SURFACE WITHIN 120 DAYS OF SPUD DATE. IN ALL CASES, NOTIFY DISTRICT OFFICE PRIOR TO ANY CEMENTING.

I hereby certify that the statements made herein are true and to the best of my knowledge and belief.

Date: 05-29-96 Signature of Operator or Agent: [Signature] Title: Vice-President

FOR KCC USE:  
 API # 15- 203-20122-0000  
 Conductor pipe required NONE feet  
 Minimum surface pipe required 200 feet per Alt. X(2)  
 Approved by: DPW 5-30-96

---

This authorization expires: 11-30-96  
 (This authorization void if drilling not started within 6 months of effective date.)  
 Spud date: \_\_\_\_\_ Agent: \_\_\_\_\_

REMEMBER TO:

- File Drill Pit Application (form CDP-1) with Intent to Drill;
- File Completion Form ACO-1 within 120 days of spud date;
- File acreage attribution plat according to field prorations orders;
- Notify appropriate district office 48 hours prior to workover or re-entry;
- Submit plugging report (CP-4) after plugging is completed;
- Obtain written approval before disposing or injecting salt water.

Mail to: KCC - Conservation Division, 130 S. Market - Room 2078, Wichita, Kansas 67202.

35  
20  
35W

**IN ALL CASES PLOT THE INTENDED WELL ON THE PLAT BELOW**

**PLAT OF ACREAGE ATTRIBUTABLE TO A WELL IN A PRORATED OR SPACED FIELD**

If the intended well is in a prorated or spaced field, please fully complete this side of the form. If the intended well is in a prorated or spaced field complete the plat below showing that the well will be properly located in relationship to other wells producing from the common source of supply. Please show all the wells within 1 mile of the boundaries of the proposed acreage attribution unit for gas wells and within 1/2 mile of the boundaries of the proposed acreage attribution unit for oil wells.

API NO. 15- \_\_\_\_\_  
 OPERATOR A. L. Abercrombie Inc.  
 LEASE Moody  
 WELL NUMBER 3  
 FIELD \_\_\_\_\_

LOCATION OF WELL: COUNTY Wichita  
1830 feet from (south)/~~north~~ line of section  
1980 feet from (east)/~~west~~ line of section  
 SECTION 35 TWP 20 RG 35W

NUMBER OF ACRES ATTRIBUTABLE TO WELL \_\_\_\_\_  
 QTR/QTR/QTR OF ACREAGE \_\_\_\_\_

IS SECTION XX REGULAR or \_\_\_\_\_ IRREGULAR  
**IF SECTION IS IRREGULAR, LOCATE WELL FROM NEAREST CORNER BOUNDARY.**

Section corner used: \_\_\_\_\_ NE \_\_\_\_\_ NW \_\_\_\_\_ SE \_\_\_\_\_ SW

**PLAT**

(Show location of the well and shade attributable acreage for prorated or spaced wells.)

(Show footage to the nearest lease or unit boundary line.)

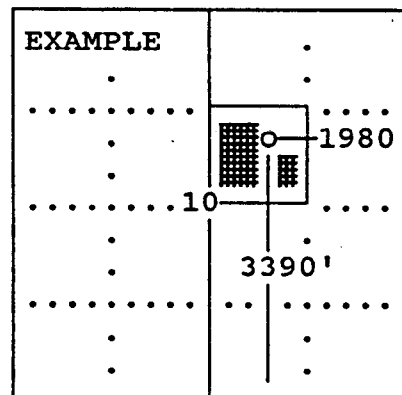
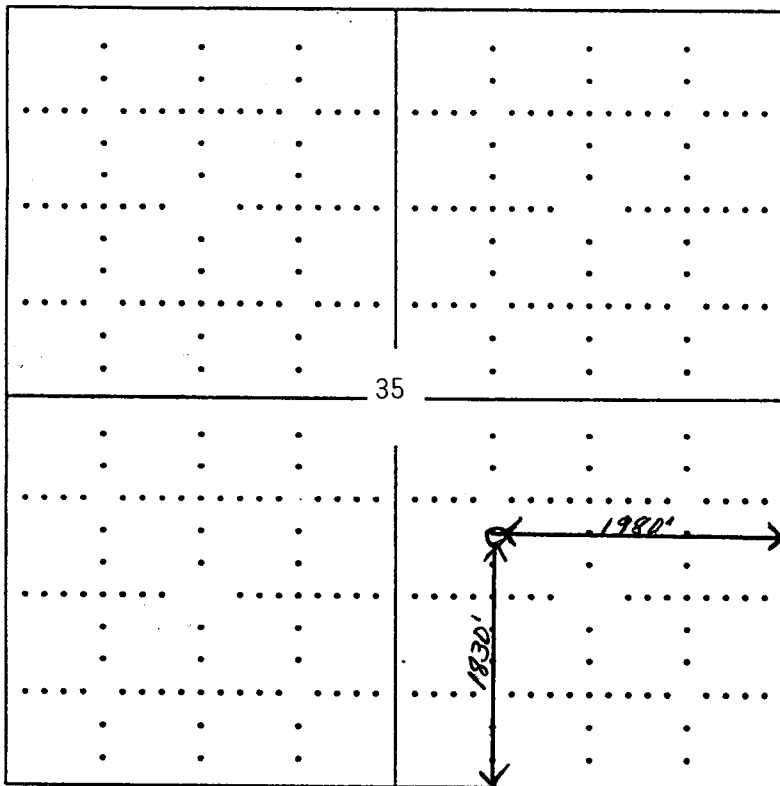

SEWARD CO.

**In plotting the proposed location of the well, you must show:**

- 1) The manner in which you are using the depicted plat by identifying section lines, i.e. 1 section, 1 section with 8 surrounding sections, 4 sections, etc.;
- 2) the distance of the proposed drilling location from the section's south/north and east/west; and
- 3) the distance to the nearest lease or unit boundary line.