

FOR KCC USE:

FORM C-1 7/91
FORM MUST BE TYPED
FORM MUST BE SIGNED

EFFECTIVE DATE: 4-12-95

State of Kansas
ALL BLANKS MUST BE FILLED SGA7...Yes...No Must be approved by the K.C.C.

NOTICE OF INTENTION TO DRILL DIST 1
five (5) days prior to commencing well

Expected Spud Date 4 14 95
month day year

Spot NE NE 33 16 23 East
NW Sec Twp S. Rg X West

OPERATOR: License # 5003
Name: McCoy Petroleum Corporation
Address: 3017 N. Cypress
City/State/Zip: Wichita, KS 67226-4003
Contact Person: Tim Pierce
Phone: (316) 636-2737

4950 feet from South / North line of Section
990 feet from East / West line of Section
IS SECTION X REGULAR IRREGULAR?

(NOTE: Locate well on the Section Plat on Reverse Side)
County: Ness
Lease Name: Schreiber Well #: 1-33
Field Name: WC

CONTRACTOR: License # 4958
Name: Mallard JV, Inc.

Is this a Prorated/Spaced Field? yes X no
Target Formation(s): Cherokee/Mississippian
Nearest lease or unit boundary: 330'
Ground Surface Elevation: 2480' feet MSL

Well Drilled For: Well Class: Type Equipment:
X Oil ... Enh Rec ... Infield X Mud Rotary
... Gas ... Storage ... Pool Ext. ... Air Rotary
... OWVO ... Disposal X Wildcat ... Cable
... Seismic: ... # of Holes ... Other
... Other

Water well within one-quarter mile: yes X no
Public water supply well within one mile: yes X no
Depth to bottom of fresh water: 240
Depth to bottom of usable water: 1300

If OWVO: old well information as follows:
Operator: _____
Well Name: _____
Comp. Date: _____ Old Total Depth _____

Surface Pipe by Alternate: 1 X 2
Length of Surface Pipe Planned to be set: 260
Length of Conductor pipe required: 0
Projected Total Depth: 4550'
Formation at Total Depth: Mississippian

Directional, Deviated or Horizontal wellbore? yes X no
If yes, true vertical depth: _____
Bottom Hole Location: _____

Water Source for Drilling Operations:
... well X farm pond other
DWR Permit #: _____
Will Cores Be Taken?: yes X no
If yes, proposed zone: _____

AFFIDAVIT

The undersigned hereby affirms that the drilling, completion and eventual plugging of this well will comply with K.S.A. 55-101, et. seq.
It is agreed that the following minimum requirements will be met:

RECEIVED
STATE CORPORATION COMMISSION
APR 10 1995
4-10-95
CONSERVATION DIVISION
WICHITA, KANSAS

1. Notify the appropriate district office prior to spudding of well;
2. A copy of the approved notice of intent to drill shall be posted on each drilling rig;
3. The minimum amount of surface pipe as specified below shall be set by circulating cement to the top; in all cases surface pipe shall be set through all unconsolidated materials plus a minimum of 20 feet into the underlying formation;
4. If the well is dry hole, an agreement between the operator and the district office on plug length and placement is necessary prior to plugging;
5. The appropriate district office will be notified before well is either plugged or production casing is cemented in;
6. IF AN ALTERNATE II COMPLETION, PRODUCTION PIPE SHALL BE CEMENTED FROM BELOW ANY USABLE WATER TO SURFACE WITHIN 120 DAYS OF SPUD DATE. IN ALL CASES, NOTIFY DISTRICT OFFICE PRIOR TO ANY CEMENTING.

I hereby certify that the statements made herein are true and to the best of my knowledge and belief.

Date: 4-6-95 Signature of Operator or Agent: Timothy J. Pierce Title: Geologist

FOR KCC USE:
API # 15- 135-23874 0000
Conductor pipe required NONE feet
Minimum surface pipe required 200 feet per Alt. **XO**
Approved by: RAT 4-7-95
This authorization expires: 10-7-95
(This authorization void if drilling not started within 6 months of effective date.)
Spud date: _____ Agent: _____

REMEMBER TO:

- File Drill Pit Application (form CDP-1) with Intent to Drill;
- File Completion Form ACO-1 within 120 days of spud date;
- File acreage attribution plat according to field prorator orders;
- Notify appropriate district office 48 hours prior to workover or re-entry;
- Submit plugging report (CP-4) after plugging is completed;
- Obtain written approval before disposing or injecting salt water.

Mail to: Conservation Division, 200 Colorado Derby Building, 202 W. First St., Wichita, Kansas 67202-1286.

33
16
23w

**IN ALL CASES PLOT THE INTENDED WELL ON THE PLAT BELOW
PLAT OR ACREAGE ATTRIBUTABLE TO A WELL IN A PRORATED OR SPACED FIELD**

If the intended well is in a prorated or spaced field, please fully complete this side of the form. If the intended well is in a prorated or spaced field complete the plat below showing that the well will be properly located in relationship to other wells producing from the common source of supply. Please show all the wells within 1 mile of the boundaries of the proposed acreage attribution unit for gas wells and within 1/2 mile of the boundaries of the proposed acreage attribution unit for oil wells.

API NO. 15- _____

OPERATOR McGoy Petroleum Corporation

LEASE Schreiber

WELL NUMBER 1-33

FIELD MC

NUMBER OF ACRES ATTRIBUTABLE TO WELL 40

QTR/QTR/QTR OF ACREAGE - NE - NE - NE

IS SECTION REGULAR or IRREGULAR

IF SECTION IS IRREGULAR, LOCATE WELL FROM NEAREST CORNER BOUNDARY _____

Section corner used: _____ NE _____ NW _____ SE _____ SW

LOCATION OF WELLS: COUNTY Ness

feet from south/north line of section 4950

feet from east/west line of section 990

SECTION 33 TWP 16S R 23W

(Show location of the well and shade attributable acreage for prorated or spaced wells.)
(Show footage to the nearest lease or unit boundary line.)

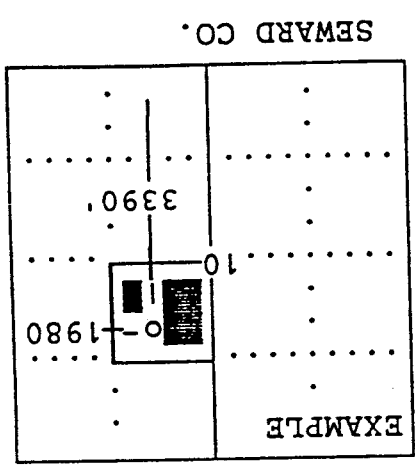
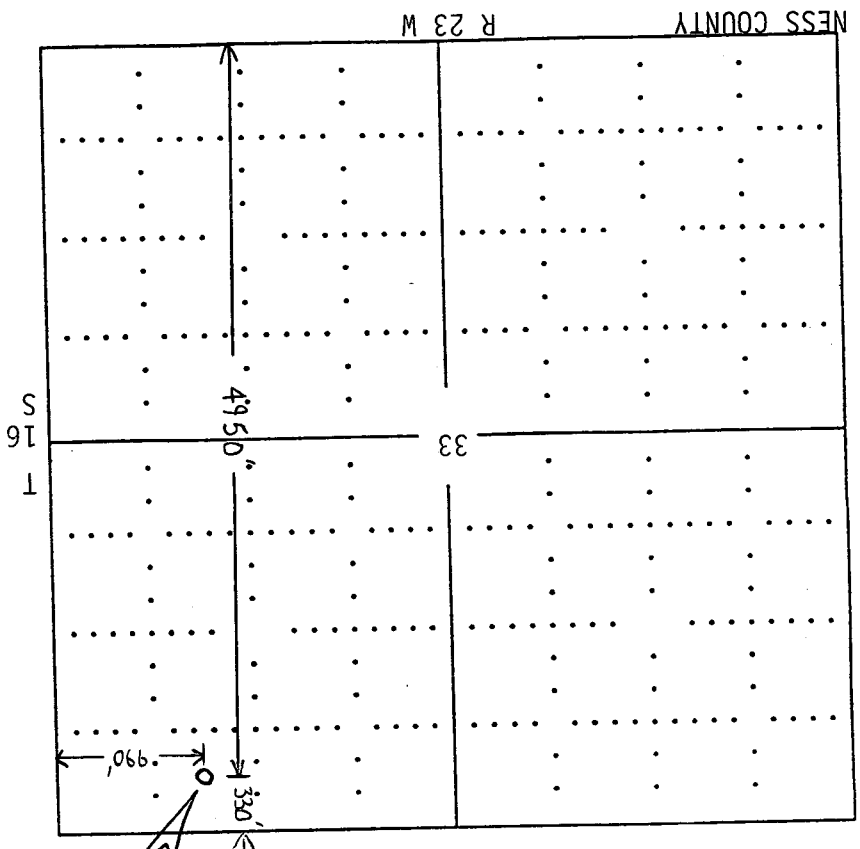

In plotting the proposed location of the well, you must show:

- 1) The manner in which you are using the depicted plat by identifying section lines, i.e. 1 section, 1 section with 8 surrounding sections, 4 sections, etc.;
- 2) the distance of the proposed drilling location from the section's south/north an east/west; and
- 3) the distance to the nearest lease or unit boundary line.