

STATE CORPORATION COMMISSION OF KANSAS
OIL & GAS CONSERVATION DIVISION

WELL COMPLETION OR RECOMPLETION FORM
ACO-1 WELL HISTORY

DESCRIPTION OF WELL AND LEASE

Operator: license # 5161
name Palomino Petroleum
address P. O. Box 18610
City/State/Zip Wichita, Kansas 67218

Operator Contact Person Bob Watchous
Phone (316) 683-8152

Contractor: license # 5422
name Abercrombie Drilling, Inc.

Wellsite Geologist Steve Carl
Phone (316) 265-2121
PURCHASER Inland Purchasing & Transportation

Designate Type of Completion
 New Well Re-Entry Workover

Oil SWD Temp Abd
 Gas Inj Delayed Comp.
 Dry Other (Core, Water Supply etc.)

If OWWO: old well info as follows:
Operator
Well Name
Comp. Date Old Total Depth

WELL HISTORY

Drilling Method: Mud Rotary Air Rotary Cable
8-13-85 8-23-85 9-19-85
Spud Date Date Reached TD Completion Date
4600 4551
Total Depth PBDT

Amount of Surface Pipe Set and Cemented at 248 feet

Multiple Stage Cementing Collar Used? Yes No

If Yes, Show Depth Set feet

If alternate 2 completion, cement circulated
from 2402 feet depth to Surface w/ 400 SX cmt

API NO. 15 - 101-21,206-6000
County Lane
SE SE NE Sec 12 Twp 17 Rge 29

Rec'd
10-02-1985

2970 Ft North from Southeast Corner of Section
330 Ft West from Southeast Corner of Section
(Note: locate well in section plat below)

Lease Name Eaton Twelve Well# 1

Field Name ~~Wildcat~~ Terwillger

Producing Formation ~~Lans. SS & Morn.~~ (commingled)

Elevation: Ground 2778 KB 2783

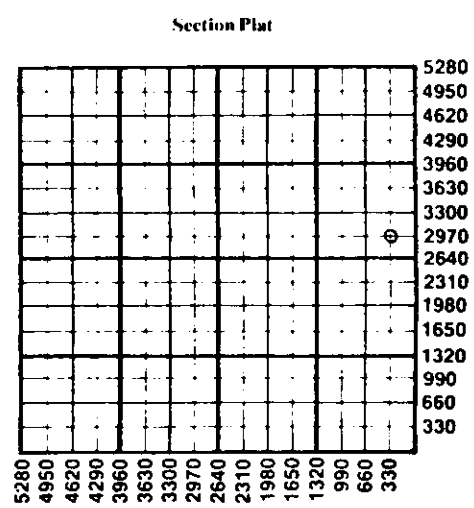

WATER SUPPLY INFORMATION

Source of Water:
Division of Water Resources Permit #
 Groundwater Ft North From Southeast Corner and
(Well) Ft West From Southeast Corner of
Sec Twp Rge East West
 Surface Water Ft North From Southeast Corner and
(Stream, Pond etc.) Ft West From Southeast Corner
Sec Twp Rge East West
 Other (explain)
(purchased from city, R.W.D.#)

Disposition of Produced Water: Disposal Repressuring
Docket #

INSTRUCTIONS: This form shall be completed in duplicate and filed with the Kansas Corporation Commission, 200 Colorado Derby Building, Wichita, Kansas 67202, within 90 days after completion or recompletion of any well. Rules 82-3-130 and 82-3-107 apply.
Information on side two of this form will be held confidential for a period of 12 months if requested in writing and submitted with the form. See rule 82-3-107 for confidentiality in excess of 12 months.
One copy of all wireline logs and drillers time log shall be attached with this form. Submit CP-4 form with all plugged wells. Submit CP-111 form with all temporarily abandoned wells.

All requirements of the statutes, rules, and regulations promulgated to regulate the oil and gas industry have been fully complied with and the statements herein are complete and correct to the best of my knowledge.

Signature Bob Watchous
Title Owner Date 10-18-85
Subscribed and sworn to before me this 18th day of October 19 85
Notary Public Kathryn L. Frerking
Date Commission Expires Aug 31, 1989

K.C.C. OFFICE USE ONLY
F Letter of Confidentiality Attached
C Wireline Log Received
C Drillers Timelog Received
Distribution
 KCC SWD/Rep NGPA
 KGS Plug Other (Specify)

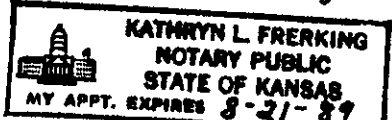

Sec 12 Twp 17 Rge 29

Operator Name Palomino Petroleum Lease Name Eaton Twelve Well# 1 SEC 12 TWP. 17 RGE. 29 East West

WELL LOG

INSTRUCTIONS: Show important tops and base of formations penetrated. Detail all cores. Report all drill stem tests giving interval tested, time tool open and closed, flowing and shut-in pressures, whether shut-in pressure reached static level, hydrostatic pressures, bottom hole temperature, fluid recovery, and flow rates if gas to surface during test. Attach extra sheet if more space is needed. Attach copy of log.

Drill Stem Tests Taken Yes No
 Samples Sent to Geological Survey Yes No
 Cores Taken Yes No

Formation Description
 Log Sample

Name Top Bottom

PALOMINO PETROLEUM #1 EATON TWELVE 12-17-29W SE SE NE
 WICHITA, KS.
 CONTR ABERCROMBIE DRILLING CTY LANE
 GEOL FIELD TERWILLIGER
 ELV 2783 KB SPD 8/13/85 CARD ISSUED 10/10/85 # P 14 BO & 28 BWPD
 LKC 4048-4388 OA
 MARM 4470-4475
 API 15-101-21,206
 CHER 4539-4549 OA

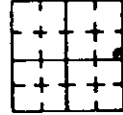

LOG	Top	Depth/Datum
ANH	2171+	612
HEEB	3929	1146
LANS	3965	1182
STARK	4223	1440
FT SC	4469	1686
CHER SH	4496	1713
MISS	4569	1786
RTD	4600	1817
LTD	4603	1820

8 5/8 " 248 / 185SX, 4 1/2 " 4598 / 200SX
 DST (1) 4028-4065 (LANS) / 30-45-45-60, 60' MDY OIL (70% OIL), 60' MDY OIL (55% OIL), 60' OCM (20% OIL), SIP 1119-1077#, FP 43-54 / 86-108#
 DST (2) 4458-4555 (LANS) / 30-30-45-60, 90' OCM, SIP 894-1044#, FP 32-32 / 54-54#
 MICT - CO, PF (JOHN ZN) 4546-4549, 4539-41, AC 750G, NO FL, PF (FT SC) 4470-75, AC 1000G, SWB DWN & REC 3 BPH (50% OIL), PF (LKC) 4386-88 & 4342-44, AC 1000G, NO FL, SWB DWN & REC 1.2 BF (5% OIL) / 1 HR, PF (LANS 70' ZN) 4048-4050, AC 1000G, SWB DWN & REC 4.5 BO / 1 HR, CMTD DWN BK SIDE W/ 400SX, T&R, POP, P 14 BO & 28 BWPD, ALL ZONES COMMINGLED

COPYRIGHT 1985
 INDEPENDENT OIL & GAS SERVICE, INC.
 WICHITA, KANSAS

Note: Was Landman Explor. #1-12 Eaton. Produced by Palomino at casing joint.

CASING RECORD <input checked="" type="checkbox"/> new <input type="checkbox"/> used							
Report all strings set - conductor, surface, intermediate, production, etc.							
Purpose of string	size hole drilled	size casing set (in O.D.)	weight lbs/ft.	setting depth	type of cement	# sacks used	type and percent additives
Surface Production	12 1/4 7 7/8	8 5/8 4 1/2	20 9 1/2	248 4598	Common 60-40 Pozmix	185 200	2% gel, 3% cc 10% gel, 10% salt 15 bbl salt flush

PERFORATION RECORD		Acid, Fracture, Shot, Cement Squeeze Record	
shots per foot	specify footage of each interval perforated	(amount and kind of material used)	Depth
4	4539-4549	750 gal. 15% NE	See perfs.
4	4470-4475	1000 gal. 15% NE	✓ ✓
4	4386-4388	1000 gal. 15% N.E.	✓ ✓
4	4239-41 & 4203-05	1000 gal. 15% N.E.	✓ ✓
4	4048-50	1000 gal. 15% N.E.	✓ ✓

TUBING RECORD size 2 3/8" O.D. set at 4547 packer at None Liner Run Yes No

Date of First Production 9-19-85 Producing method flowing pumping gas lift Other (explain)

Estimated Production Per 24 Hours	Oil	Gas	Water	Gas-Oil Ratio	Gravity
14 Bbls		MCF	28 Bbls		CFPB

Disposition of gas: vented sold used on lease
None

METHOD OF COMPLETION
 open hole perforation
 other (specify)
 Dually Completed. Commingled

PRODUCTION INTERVAL
 4470-75 and
 4048-50

RECEIVED

STATE CORPORATION COMMISSION

OCT 21 1985