

15-165-20269-0000

STATE OF KANSAS
STATE CORPORATION COMMISSION

WELL PLUGGING RECORD

Give All Information Completely
Make Required Affidavit
Mail or Deliver Report to:
Conservation Division
State Corporation Commission
212 North Market, Insurance Bldg.
Wichita, Kansas

Rush County. Sec. 10 Twp. 19s Rge. 20w (E) (W)

Location as "NE/CNW/SW" or footage from lines. C NE, SW,

Lease Owner John O. Farmer, Inc.

Lease Name WEBS Well No. 1

Office Address Box 352, Russell, Kansas

Character of Well (completed as Oil, Gas or Dry Hole) Dry Hole

Date well completed 11/8 1969

Application for plugging filed 11/8 1969

Application for plugging approved 11/8 1969

Plugging commenced 11/8 1969

Plugging completed 8:30 P.M. 11/8 1969

Reason for abandonment of well or producing formation

If a producing well is abandoned, date of last production 19

Was permission obtained from the Conservation Division or its agents before plugging was commenced? Yes

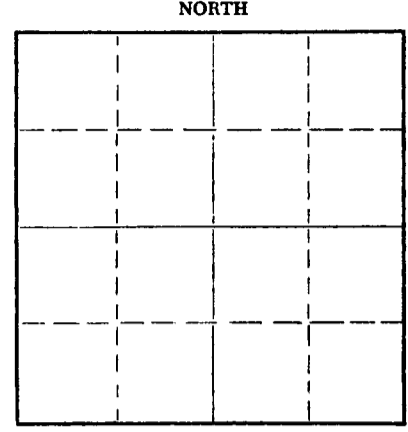

Locate well correctly on above Section Plat

Name of Conservation Agent who supervised plugging of this well Leo Massey, Hays

Producing formation Depth to top Bottom Total Depth of Well 4256 Feet

Show depth and thickness of all water, oil and gas formations.

OIL, GAS OR WATER RECORDS

CASING RECORD

FORMATION	CONTENT	FROM	TO	SIZE	PUT IN	PULLED OUT

Describe in detail the manner in which the well was plugged, indicating where the mud fluid was placed and the method or methods used in introducing it into the hole. If cement or other plugs were used, state the character of same and depth placed, from feet to feet for each plug set.

Plug # 1 540' 70 sx. cement
Plug # 2 180' 20 sx. cement
Plug # 3 40' 10 sx. cement
Completed: 8:30 P.M. 11/8/69
Leo Massey, State Plugger

RECEIVED
STATE CORPORATION COMMISSION
NOV 14 1969
CONSERVATION DIVISION
Wichita, Kansas

(If additional description is necessary, use BACK of this sheet)

Name of Plugging Contractor John O. Farmer, Inc.

Address P.O. Box 352, Russell, Kansas 67665

STATE OF KANSAS, COUNTY OF RUSSELL, ss.
JOHN O. FARMER, President (employee of owner) or (owner or operator) of the above-described

well, being first duly sworn on oath, says: That I have knowledge of the facts, statements, and matters herein contained and the log of the above-described well as filed and that the same are true and correct. So help me God.

(Signature) John O. Farmer
P.O. Box 352, Russell, Kansas (Address)

Subscribed and sworn to before me this 13th day of November, 1969

My commission expires February 15, 1971
Helen Carlson Notary Public

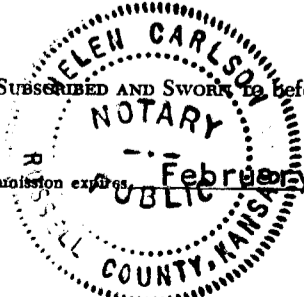

OPERATOR John O. Farmer, Inc.

ADDRESS Box 352, Russell, Kansas

FORMATION RECORD

Give detailed description and thickness of all formation drilled through, contents of sand, whether dry, water, oil or gas.

Formation	Top	Bottom	Formation	Top	Bottom
Surface		191			
Shale	191	830			
Sand	830	1020			
Redbed	1020	1378			
Anhydrite	1378	1390			
Shale shells	1390	2295			
Shale lime	2295	2545			
Lime shale	2545	3875			
Lime	3875	4120			
Lime shale	4120	4215			
Shale lime	4215	4250			
Mississippi	4250	4356			

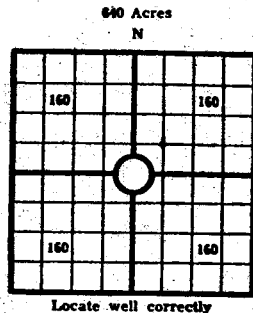

Locate well correctly

COUNTY Rush SEC. 10 TWP. 19s RGE. 20w

COMPANY OPERATING John O. Farmer, Inc.

OFFICE ADDRESS Box 352, Russell, Kansas

DRILLING STARTED 10/28/69 DRILLING FINISHED 11/8/69

DATE OF FIRST PRODUCTION _____ COMPLETED

WELL LOCATED CZ $\frac{1}{4}$ NE $\frac{1}{4}$ SW $\frac{1}{4}$ North of South

Line and _____ ft. East of West Line of Quarter Section

Elevation (Relative to sea level) DERRICK FLOOR 2197 GROUND 2194

CHARACTER OF WELL (Oil, gas or dryhole) Dryhole

OIL OR GAS SANDS OR ZONES

Name	From	To	Name	From	To
1			4		
2			5		
3			6		

Perforating Record If Any

Shot Record

Formation	From	To	No. of Shots	Formation	From	To	Size of Shot

CASING RECORD

Amount Set				Amount Pulled				Packer Record			
Size	Wt.	Thds.	Make	Ft.	In.	Ft.	In.	Size	Length	Depth Set	Make

Liner Record: Amount _____ Kind _____ Top _____ Bottom _____

CEMENTING AND MUDDING

Size	Amount Set		Sacks Cement	Chemical		Method of Cementing	Amount	Mudding Method	Results (See Note)
	Ft.	In.		Gal.	Make				
5/8"	191'		140	sx.	cement				

Note: What method was used to protect sands if outer strings were pulled?

NOTE: Were bottom hole plugs used? If so, state kind, depth set and results obtained

TOOLS USED

Rotary Tools were used from 0 feet to R.T.D. Cable tools were used from _____ feet to _____ feet, and from _____ feet to _____ feet, and from _____ feet to _____ feet

Type Rig Rotary

INITIAL PRODUCTION TEST

Describe initial test: whether by flow through tubing or casing or by pumping _____

Amount of Oil Production _____ bbls. Size of choke, if any _____ Length of test _____ Water Production _____ bbls. Gravity of oil _____ Type of Pump if pump is used, describe _____

Sample tops

Tops

Heebner

3704'

Toronto

3729'

Lansing

3753'

B/ Kansas City

4061'

Cherokee sand

4217'

R.T.D.

4256'

RECEIVED
STATE COMMISSION
NOV-14-69
CONSERVATION DIVISION
Wichita, Kansas

I, the undersigned, being first duly sworn upon oath, state that this well record is true, correct and complete according to the records of this office and to the best of my knowledge and belief.

John O. Farmer
Name and title of representative of company
President

13th day of November, 1969

Subscribed and sworn to before me this _____ day of _____, 1969
Helen Carlson, Notary Public

Helen Carlson
Notary Public

FARMER NAME WEBS WELL NO. 1 COUNTY RUSH SEC. 10 TWP. 19S RGE. 20W