

Physical Productivity Report to THE STATE CORPORATION COMMISSION, Conservation Division, 212 N. Market, Wichita, Kansas

GEAR PETROLEUM INC. LEISARY 1-32 WA KIOWA MISS PERMIAN CORP  
 Producer's Name Lease Name Well No. Pool County Producing Horizon Pipe Line (Purchaser)

Taken 2 15 1984 Effective 2 16 1984 Sec 32 Twp 29s R 16 E W 15-097-20967-0000  
 Month Day Year Month Day Year Lease Description

Tank No.	Size	Opening Gauge				Barrels	Closing Gauge				Barrels
		Oil Level		B. S. & W.			Oil Level		B. S. & W.		
		Ft.	In.	Ft.	In.		Ft.	In.	Ft.	In.	
Gun Bbl.	4X20										
Settling Tank	200	6	2			7	6			26.72	

Well Data	
Top Prod. Horizon	Ft. Total Depth 4608 Ft.
Perforations	open hole to 4594-4608 Ft.
Size of Casing	4 1/2 Set at 4594 Ft.
Size of Tubing	2 3/8 Set at 4602 Ft.
Size of Pump	2 X 1 1/2 X 14 Type metal metal
Gravity of Oil	41 Temp. 60°
Percentage of Water	none Acid gal. Date

RECEIVED  
 STATE CORPORATION COMMISSION  
 CONSERVATION DIVISION  
 Wichita, Kansas  
 FEB 22 1984

Total Bbls. Produced = 26.72 X 3 = Productivity.

REMARKS:

SEALS and USES:

WITNESSING: We, the undersigned, personally witnessed the gauging periods as indicated by our signatures, and certify that they were taken according to the Commission's Rules.

Gauge Witnesses	Opening Gauge	Closing Gauge
For Producer	<i>[Signature]</i>	<i>[Signature]</i>
For Offset Owner		
For State	<i>[Signature]</i>	<i>[Signature]</i>

Test Data			
Temporary	Permanent <input checked="" type="checkbox"/>	Field	Special
Flowing	Swabbing	Pumping <input checked="" type="checkbox"/>	

Length of Stroke 64" In. S. P. M. 6

Pretest Information:

Hours pumped	72 hrs +
Bbls. Produced	
Tank Tables Used	
Est.	1.67 (Bbls. per In.)
Checked by:	

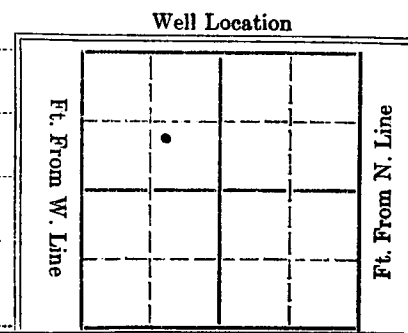

Send ORIGINAL WHITE COPY to OFFICE. Give PINK to PRODUCER. BLUE to last OFFSET WITNESS. YELLOW retained by GAUGER.—REPORT FULLY ANY INCOMPLETED POTENTIAL.

Physical Productivity Report to THE STATE CORPORATION COMMISSION, Conservation Division, 212 N. Market, Wichita, Kansas

GEAR PETROLEUM INC. LEASE NAME LIBRARY Well No. 1-32 Pool JVA Goldie, SO. V. 1000 County MISS Producing Horizon PERMIAN CORR Pipe Line (Purchaser)

Taken 2 FEB 22 1984 Effective 2 16 1984 Sec 32 Twp 29 R 16 E W

Tank No.	Size	Opening Gauge				Barrels	Closing Gauge				Barrels
		Time on: 10:20 AM		Time off: 1:00 AM			Oil Level		B. S. & W.		
		Ft.	In.	Ft.	In.		Ft.	In.	Ft.	In.	
Gun Bbl.	11x70										
Settling Tank	200	6	2				11	6			26.72

Well Data	
Top Prod. Horizon	Ft. Total Depth 4160.5 Ft.
Perforations	Open hole to 4159.4 - 4160.5 Ft.
Size of Casing	2 1/2 Set at 4159.4 Ft.
Size of Tubing	2 1/8 Set at 4160.2 Ft.
Size of Pump	2 x 1 1/2 x 14 Type metal metal
Gravity of Oil	41 Temp. 60
Percentage of Water	Acid gal. Date

Test Data			
Temporary	Permanent <input checked="" type="checkbox"/>	Field	Special
Flowing	Swabbing	Pumping <input checked="" type="checkbox"/>	
Length of Stroke	14" In.	S. P. M.	6

Pretest Information: Hours pumped 72 hrs 1

Well Location	
Bbbls. Produced	Est. 1.67 (Bbbls. per In.)
Tank Tables Used	
Checked by:	

Total Bbbls. Produced = 6.72 X 3 = Productivity

REMARKS:

SEALS and USES:

WITNESSING: We, the undersigned, personally witnessed the gauging periods as indicated by our signatures, and certify that they were taken according to the Commission's Rules.

Gauge Witnesses	Opening Gauge	Closing Gauge
For Producer	<i>Robert A. Gillman</i>	<i>Robert A. Gillman</i>
For Offset Owner		
For State	<i>Stuebelman</i>	<i>Stuebelman</i>

Send ORIGINAL WHITE COPY to OFFICE. Give PINK to PRODUCER. BLUE to last OFFSET WITNESS. YELLOW retained by GAUGER.—REPORT FULLY ANY INCOMPLETED POTENTIAL.