

STATE OF KANSAS
KANSAS CORPORATION COMMISSION
CONSERVATION DIVISION
130 South Market - Room 2078
Wichita, Kansas 67202

FORM CP-1 (3/92)

WELL PLUGGING APPLICATION FORM
(PLEASE TYPE FORM and File ONE Copy)

API # 15-007-21,992 . 00 . 00 (Identifier number of this well). This must be listed for wells drilled since 1967; if no API# was issued, indicate spud or completion date.

WELL OPERATOR Hummon Corporation KCC LICENSE # 5050 *6/01*
(owner/company name) (operator's)

ADDRESS 950 N. Tyler CITY Wichita

STATE KS ZIP CODE 67212 CONTACT PHONE # (316) 773-2300

LEASE Rucker WELL# 2 SEC. 7 T. 32 R. 10 (East West)

SW . SW . NW SPOT LOCATION/OOOO COUNTY Barber

1980 FEET (in exact footage) FROM S/(N) (circle one) LINE OF SECTION (NOT Lease Line)

660 FEET (in exact footage) FROM E/(W) (circle one) LINE OF SECTION (NOT Lease Line)

Check One: OIL WELL GAS WELL D&A SWD/ENHR WELL DOCKET# _____

CONDUCTOR CASING SIZE _____ SET AT _____ CEMENTED WITH _____ SACKS

SURFACE CASING SIZE 8 5/8" SET AT 224' CEMENTED WITH 200 SACKS

PRODUCTION CASING SIZE 5 1/2" SET AT 3779 CEMENTED WITH 100 SACKS

LIST (ALL) PERFORATIONS and BRIDGEPLUG SETS: 3729-31, 3612-15'

ELEVATION 1522 GL/1535 KB.D. 3780 PBDT 3747 ANHYDRITE DEPTH _____
(G.L./K.B.) (Stone Corral Formation)

CONDITION OF WELL: GOOD POOR CASING LEAK JUNK IN HOLE

PROPOSED METHOD OF PLUGGING as required by KCC

RECEIVED
KANSAS CORPORATION COMMISSION

JUN 6 2001

(If additional space is needed attach separate page)

IS WELL LOG ATTACHED TO THIS APPLICATION AS REQUIRED? yes IS ACO-1 FILED? yes

CONSERVATION DIVISION

If not explain why? _____

PLUGGING OF THIS WELL WILL BE DONE IN ACCORDANCE WITH K.S.A. 55-101 et. seq. AND THE RULES AND REGULATIONS OF THE STATE CORPORATION COMMISSION.

LIST NAME OF COMPANY REPRESENTATIVE AUTHORIZED TO BE IN CHARGE OF PLUGGING OPERATIONS:

Dennis Walker PHONE# () 620-886-0120

ADDRESS 907 N. Walnut city/State Medicine Lodge, KS 67104

PLUGGING CONTRACTOR Clarke Corporation KCC LICENSE # 5105 *6/01*
(company name) (contractor's)

ADDRESS P.O. Box 187 Medicine Lodge PHONE # () 620-886-0024

PROPOSED DATE AND HOUR OF PLUGGING (If Known?) 6/11/01

PAYMENT OF THE PLUGGING FEE (K.A.R. 82-3-118) WILL BE GUARANTEED BY OPERATOR OR AGENT

DATE: 6/4/01 AUTHORIZED OPERATOR/AGENT: Karen Houshey
(signature)

STATE CORPORATION COMMISSION OF KANSAS
OIL & GAS CONSERVATION DIVISION

WELL COMPLETION OR RECOMPLETION FORM
ACO-1 WELL HISTORY

DESCRIPTION OF WELL AND LEASE

Operator: License # 5050
Name Hummion Corporation
Address 400 One Main Place
City/State/Zip Wichita, KS 67202

Purchaser Derby Refining
Wichita, Kansas 67202

Operator Contact Person Wilber D. Berg
Phone (316) 263-8521

Contractor: License # 5148
Name Big H Drilling, Inc.

Wellsite Geologist Dave Goldak
Phone (316) 263-8521

Designate Type of Completion

- New Well Re-Entry Workover
- Oil SWD Temp Abd
- Gas Inj Delayed Comp.
- Dry Other (Core, Water Supply etc.)

If OWMO: old well info as follows:

Operator
Well Name
Comp. Date Old Total Depth.....

WELL HISTORY

Drilling Method:

- Mud Rotary Air Rotary Cable

1/14/85 1/21/85 1/21/85
Spud Date Date Reached TD Completion Date
3780' 3747'
Total Depth PBTD

Amount of Surface Pipe Set and Cemented at 224 feet
Multiple Stage Cementing Collar Used? Yes No
If yes, show depth set.....feet
If alternate 2 completion, cement circulated
from.....feet depth to.....w/.....SX cmt

API NO. 15- 007-21,992 : 00 : 00

County Barber
660' FWL
660' FSL NW/4 Sec. 7 Twp. 32S Rge. 10 East West

3240 Ft North from Southeast Corner of Section
4620 Ft West from Southeast Corner of Section
(Note: Locate well in section plat below)

Lease Name Rucker Well # 2

Field Name McGuire-Goeman

Producing Formation Douglas

Elevation: Ground 1522 KB 1535

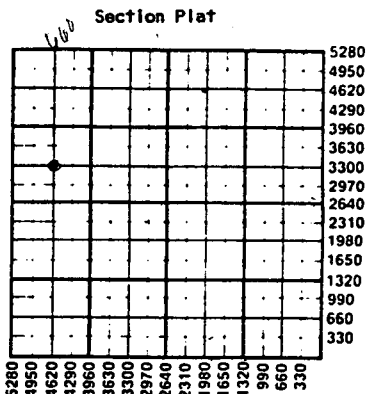

WATER SUPPLY INFORMATION

Disposition of Produced Water: Disposal
Docket # C-21,045 Repressuring

Questions on this portion of the ACO-1 call:

Water Resources Board (913) 296-3717

Source of Water:
Division of Water Resources Permit # T 85-38

Groundwater.....Ft North from Southeast Corner
(Well)Ft West from Southeast Corner of
Sec Twp Rge East West

Surface Water 1320 Ft North from Southeast Corner
(Stream, pond etc) 1980 Ft West from Southeast Corner
Sec 12 Twp 32 Rge 11 East West

Other (explain).....
(purchased from city, R.W.D. #)

INSTRUCTIONS: This form shall be completed in duplicate and filed with the Kansas Corporation Commission, 200 Colorado Derby Building, Wichita, Kansas 67202, within 90 days after completion or recompletion of any well. Rule 82-3-130 and 82-3-107 apply. Information on slide two of this form will be held confidential for a period of 12 months if requested in writing and submitted with the form. See rule 82-3-107 for confidentiality in excess of 12 months. One copy of all wireline logs and drillers time log shall be attached with this form. Submit CP-4 form with all plugged wells. Submit CP-111 form with all temporarily abandoned wells.

All requirements of the statutes, rules and regulations promulgated to regulate the oil and gas industry have been fully complied with and the statements herein are complete and correct to the best of my knowledge.

Signature Wilber D. Berg

Title Wilber D. Berg, Prod. Supt. Date 4/4/85

Subscribed and sworn to before me this 4th day of April 1985

Notary Public Sandra L. Mendoza

Date Commission Expires February 13, 1986

SANDRA L. MENDOZA
STATE NOTARY PUBLIC
SEDGWICK COUNTY, KANSAS

K.C.C. OFFICE USE ONLY
F Letter of Confidentiality Attached
C Wireline Log Received
C Drillers Timelog Received
Distribution
 KCC SWD/Rep NGPA
 KGS Plug Other
(Specify)

RECEIVED
KANSAS CORPORATION COMMISSION

JUN 6 2001

CONSERVATION DIVISION

Operator Name Hummon Corporation Lease Name Rucker Well # 2

Sec. 7 Twp. 32S Rge. 10 East West County Barber

WELL LOG

INSTRUCTIONS: Show important tops and base of formations penetrated. Detail all cores. Report all drill stem tests giving interval tested, time tool open and closed, flowing and shut-in pressures, whether shut-in pressure reached static level, hydrostatic pressures, bottom hole temperature, fluid recovery, and flow rates if gas to surface during test. Attach extra sheet if more space is needed. Attach copy of log.

Drill Stem Tests Taken	<input checked="" type="checkbox"/> Yes	<input type="checkbox"/> No	Formation Description	<input checked="" type="checkbox"/> Log	<input type="checkbox"/> Sample
Samples Sent to Geological Survey	<input checked="" type="checkbox"/> Yes	<input type="checkbox"/> No	Name	Top	Bottom
Cores Taken	<input type="checkbox"/> Yes	<input checked="" type="checkbox"/> No			

DST #1: 3612 - 3620
 45/60/45/90 Rec. 30' OCM
 GTS in 7 min. 60' HOCCM
 20 min GA 14,100 CFG 180' froggy oil
 30 min GA 12,500 CFG 120' SW
 40 min GA 12,500 CFG SIP 1274/1274
 45 min GA 14,100 CFG IFP 59/108
 FFP 118/137
 HP 1805/1805

DST #2: 3728 - 3740
 30/60/30/60 Rec. 120' drlg. M w/oil spots in tool
 SIP 1394/1376
 IFP 59/59
 FFP 68/68
 HP 1815/1815

CASING RECORD <input checked="" type="checkbox"/> New <input type="checkbox"/> Used							
Report all strings set-conductor, surface, intermediate, production, etc.							
Purpose of String	Size Hole Drilled	Size Casing Set (in O.D.)	Weight Lbs/Ft.	Setting Depth	Type of Cement	#Sacks Used	Type and Percent Additives
SURFACE	12"	8-5/8"	23#	223.70'	Common	200sx	2% Gel 1% CC
PRODUCTION	7-7/8"	5"	14#	3779'	60/40 Poz	100sx	2% Gel 10% salt 3/4 of 1% D-1

PERFORATION RECORD				Acid, Fracture, Shot, Cement Squeeze Record			
Shots Per Foot	Specify Footage of Each Interval Perforated			(Amount and Kind of Material Used)		Depth	
4 shots/ft.	3729 - 3731			250 gals double-strength FE	3729-31		
4 shots/ft.	3612 - 3615			250 gals double-strength FE	3612-15		
				2000 gals gel pad	2000 gals Mod-202		
				2000 gals double-strength 15% FE	4700 gals flush w/formation wtr. 3612-15		

TUBING RECORD				Liner Run <input type="checkbox"/> Yes <input checked="" type="checkbox"/> No	
Size	Set At	Packer at			
2-3/8"	3665'	NONE			

Date of First Production March 13, 1985 Producing Method Flowing Pumping Gas Lift Other (explain).....

Estimated Production Per 24 Hours	Oil	Gas	Water	Gas-Oil Ratio	Gravity
10 Bbls		MCF	12 Bbls	CFPB	28°

METHOD OF COMPLETION Production Interval

Disposition of gas: Vented Open Hole Perforation 3612 - 3615
 Sold Other (Specify)
 Used on Lease Dually Completed
 Commingled



Kansas Corporation Commission

Bill Graves, Governor John Wine, Chair Cynthia L. Claus, Commissioner Brian J. Moline, Commissioner

NOTICE OF RECEIPT OF WELL PLUGGING APPLICATION (CP-1)

Hummon Corporation
950 N. Tyler
Wichita, KS 67212-3240

June 11, 2001

RUCKER #2
API 15-007-21992-00-00
3240 S 4620 E
S2SWNW 7-32S-10W
BARBER COUNTY

Dear Dennis Walker:

This letter is to notify you that the Conservation Division is in receipt of your plugging proposal, form CP-1, for the above-captioned well.

Your CP-1 has been reviewed by the Conservation Division central office for completeness and to verify license numbers. The plugging proposal will now be forwarded to the district office listed below for review of your proposed method of plugging.

Please contact the district office for approval of your proposed plugging method at least five (5) days before plugging the well, pursuant to K.A.R. 82-3-113 (b). If a workover pit will be used during the plugging of the well it must be permitted. A CDP-1 form must be filed and approved prior to the use of the pit.

The Conservation Division's review of form CP-1, either in the central or district office, does not include an inquiry into well ownership or the filing operator's legal right to plug the well.

This notice in no way constitutes authorization to plug the above-captioned well by persons not having legal rights of ownership or interest in the well. This notice is void after ninety (90) days from the above date.

Sincerely,

A handwritten signature in cursive script that reads "David P. Williams".

David P. Williams
Production Supervisor

District: #1
304 W. McArtor
Dodge City, KS 67801
(316) 225-8888