

STATE OF KANSAS  
STATE CORPORATION COMMISSION

Give All Information Completely  
Make Required Affidavit  
Mail or Deliver Report to:  
Conservation Division  
State Corporation Commission  
212 North Market, Insurance Bldg.  
Wichita, Kansas

15:135:20163-0000  
WELL PLUGGING RECORD

NORTH

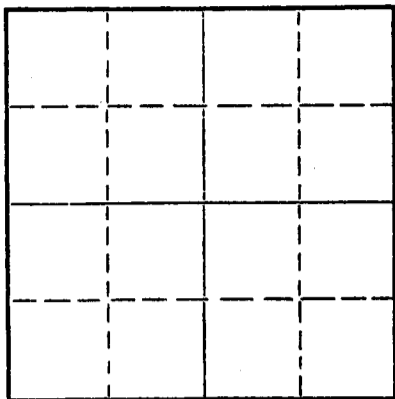

Locate well correctly on above  
Section Plat

NESS County. Sec. 18 Twp. 16S Rge. 23W (E) (W)  
Location as "NE/CNW/SW" or footage from lines C SE, SW,  
Lease Owner John O. Farmer, Inc.  
Lease Name Schoepfel Well No. 1  
Office Address P.O. Box 352, Russell, Kansas  
Character of Well (completed as Oil, Gas or Dry Hole) Dryhole  
Date well completed 7/17 1968  
Application for plugging filed 7/17 1968  
Application for plugging approved 7/17 1968  
Plugging commenced 7/17 1968  
Plugging completed 12:30 P.M. 7/17 1968  
Reason for abandonment of well or producing formation

If a producing well is abandoned, date of last production 19  
Was permission obtained from the Conservation Division or its agents before plugging was commenced? Yes

Name of Conservation Agent who supervised plugging of this well Leo Massey, Hays, Kansas  
Producing formation Depth to top Bottom Total Depth of Well 4544 Feet  
Show depth and thickness of all water, oil and gas formations.

OIL, GAS OR WATER RECORDS

CASING RECORD

| FORMATION | CONTENT | FROM | TO | SIZE | PUT IN | PULLED OUT |
|-----------|---------|------|----|------|--------|------------|
|           |         |      |    |      |        |            |
|           |         |      |    |      |        |            |
|           |         |      |    |      |        |            |
|           |         |      |    |      |        |            |
|           |         |      |    |      |        |            |
|           |         |      |    |      |        |            |
|           |         |      |    |      |        |            |
|           |         |      |    |      |        |            |
|           |         |      |    |      |        |            |
|           |         |      |    |      |        |            |

Describe in detail the manner in which the well was plugged, indicating where the mud fluid was placed and the method or methods used in introducing it into the hole. If cement or other plugs were used, state the character of same and depth placed, from feet to feet for each plug set.

Plug # 1 800' 70 sx. cement  
Plug # 2 250' 20 sx. cement  
Plug # 3 40' 10 sx. cement  
Completed: 12:30 P.M. 7/17/68  
Leo Massey, State Plugger

RECEIVED  
STATE CORPORATION COMMISSION  
JUL 22 1968  
CONSERVATION DIVISION  
Wichita, Kansas

(If additional description is necessary, use BACK of this sheet)  
Name of Plugging Contractor John O. Farmer, Inc.  
Address P.O. Box 352, Russell, Kansas

STATE OF KANSAS, COUNTY OF RUSSELL, ss.  
JOHN O. FARMER, President (employee of owner) or (owner or operator) of the above-described well, being first duly sworn on oath, says: That I have knowledge of the facts, statements, and matters herein contained and the log of the above-described well as filed and that the same are true and correct. So help me God.

(Signature) John O. Farmer  
Box 352, Russell, Kansas  
(Address)

Subscribed and sworn to before me this 20th day of July, 1968

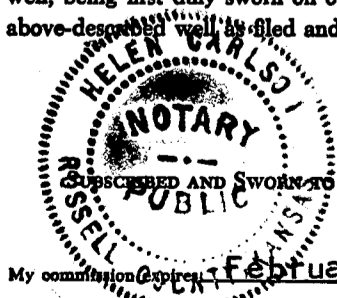

My commission expires February 15, 1971

Helen Carlson  
Notary Public.

OPERATOR John O. Farmer, Inc.

ADDRESS Box 352, Russell, Kansas

FORMATION RECORD 15-135-20163-0000

Give detailed description and thickness of all formation drilled through, contents of sand, whether dry, water, oil or gas.

FARM NAME Schoeppe1 WELL NO. 1 COUNTY Ness SEC. 18 TWP. 16S RGE. 23W

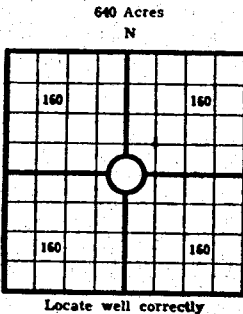

COUNTY Ness, SEC. 18, TWP. 16S, RGE. 23W  
 COMPANY OPERATING John O. Farmer, Inc.  
 OFFICE ADDRESS Box 352, Russell, Ks.  
 DRILLING STARTED 7/6, 1968, DRILLING FINISHED 7/17, 1968  
 DATE OF FIRST PRODUCTION \_\_\_\_\_ COMPLETED \_\_\_\_\_  
 WELL LOCATED C  $\frac{1}{4}$  SE  $\frac{1}{4}$  SW  $\frac{1}{4}$ , North of South  
 Line and \_\_\_\_\_ ft. East of West Line of Quarter Section  
 Elevation (Relative to sea level) DERRICK FLOOR 2491, GROUND 2488  
 CHARACTER OF WELL (Oil, gas or dryhole) Dryhole

OIL OR GAS SANDS OR ZONES

| Name | From | To | Name | From | To |
|------|------|----|------|------|----|
| 1    |      |    | 4    |      |    |
| 2    |      |    | 5    |      |    |
| 3    |      |    | 6    |      |    |

Perforating Record If Any

| Formation | From | To | No. of Shots | Formation | From | To | Size of Shot |
|-----------|------|----|--------------|-----------|------|----|--------------|
|           |      |    |              |           |      |    |              |

CASING RECORD

| Amount Set |     |       |      |     |     | Amount Pulled |     |      |        | Packer Record |      |
|------------|-----|-------|------|-----|-----|---------------|-----|------|--------|---------------|------|
| Size       | Wt. | Thds. | Make | Ft. | In. | Ft.           | In. | Size | Length | Depth Set     | Make |
| 8          | 5/8 |       |      | 264 |     |               |     |      |        |               |      |

Liner Record: Amount \_\_\_\_\_ Kind \_\_\_\_\_ Top \_\_\_\_\_ Bottom \_\_\_\_\_

CEMENTING AND MUDDING

| Size | Amount Set |      | Sacks Cement | Chemical |      | Method of Cementing | Amount | Mudding Method | Results (See Note) |
|------|------------|------|--------------|----------|------|---------------------|--------|----------------|--------------------|
|      | Ft.        | In.  |              | Gal.     | Make |                     |        |                |                    |
| 8    | 5/8        | 264' | 185          | SX.      |      |                     |        |                |                    |

Note: What method was used to protect sands if outer strings were pulled? \_\_\_\_\_

NOTE: Were bottom hole plugs used? \_\_\_\_\_ If so, state kind, depth set and results obtained \_\_\_\_\_

TOOLS USED

Rotary Tools were used from 0 feet to P.T.D. Cable tools were used from \_\_\_\_\_ feet to \_\_\_\_\_ feet, and from \_\_\_\_\_ feet to \_\_\_\_\_ feet, and from \_\_\_\_\_ feet to \_\_\_\_\_ feet to \_\_\_\_\_  
 Type Rig Rotary

INITIAL PRODUCTION TEST

Describe initial test: whether by flow through tubing or casing or by pumping \_\_\_\_\_

Amount of Oil Production \_\_\_\_\_ bbls. Size of choke, if any \_\_\_\_\_ Length of test \_\_\_\_\_ Water  
 Production \_\_\_\_\_ bbls. Gravity of oil \_\_\_\_\_ Type of Pump if pump is used, describe \_\_\_\_\_

| Formation    | Top  | Bottom | Formation | XXXXXX |
|--------------|------|--------|-----------|--------|
| Surface      |      | 270    |           |        |
| Shale & sand | 270  | 1240   |           |        |
| Shale shells | 1240 | 1340   |           |        |
| Sand         | 1340 | 1525   |           |        |
| Shale shells | 1525 | 1670   |           |        |
| Shale redbed | 1670 | 1855   |           |        |
| Anhydrite    | 1855 | 1894   |           |        |
| Shale shells | 1894 | 2345   |           |        |
| Shale lime   | 2345 | 2670   |           |        |
| Lime shale   | 2670 | 4544   |           |        |

Log Tops

|                  |       |
|------------------|-------|
| Heebner          | 3890' |
| Toronto          | 3904' |
| Lansing K.C.     | 3934' |
| Base Kansas City | 4224' |
| Pawnee           | 4340' |
| Cherokee         | 4422' |
| Mississippi      | 4524' |
| Log T.D.         | 4540' |
| Rotary T.D.      | 4544' |

RECEIVED  
 STATE CORPORATION COMMISSION  
 JUL 22 1968  
 CONSERVATION DIVISION  
 Wichita, Kansas

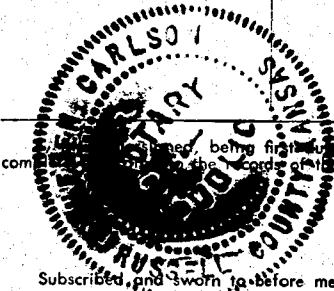

Subscribed, being first duly sworn upon oath, that this well record is true, correct and complete, and to the best of my knowledge and belief.

John O. Farmer  
 Name and title of representative of company  
 President

Subscribed and sworn to before me this 20th day of July, 1968

My Commission expires 2/15/71

Helen Carlson  
 Notary Public.