

STATE OF KANSAS  
STATE CORPORATION COMMISSION  
200 Colorado Derby Building  
Wichita, Kansas 67202

WELL PLUGGING RECORD  
K.A.R.-82-3-117

API NUMBER 15-203-20,045-0000

LEASE NAME Wilken

WELL NUMBER #1

SPOT LOCATION C SE SW

SEC. 34 TWP. 20S RGE. 35W (E) or (W)

COUNTY Wichita

Date Well Completed \_\_\_\_\_

Plugging Commenced 7-30-86

Plugging Completed 8-6-86

TYPE OR PRINT

NOTICE: Fill out completely  
and return to Cons. Div.  
office within 30 days.

LEASE OPERATOR J.A. Allison

ADDRESS 300 W. Douglas, Suite 305, Wichita, Ks 67202-2975

PHONE # (316) 263-2241 OPERATORS LICENSE NO. 5027

Character of Well Oil  
(Oil, Gas, D&A, SWD, Input, Water Supply Well)

Did you notify the KCC/KDHE Joint District Office prior to plugging this well? Yes

Which KCC/KDHE Joint Office did you notify? Dodge City, Kansas

Is ACO-1 filed? \_\_\_\_\_ If not, is well log attached? \_\_\_\_\_

Producing formation \_\_\_\_\_ Depth to top \_\_\_\_\_ bottom T.D. 5016'

Show depth and thickness of all water, oil and gas formations.

OIL, GAS OR WATER RECORDS

CASING RECORD

Formation	Content	From	To	Size	Put in	Pulled out
				8-5/8"	331'	none
				5-1/2"	4689'	2950'

Describe in detail the manner in which the well was plugged, indicating where the mud fluid was placed and the method or methods used in introducing it into the hole. If cement or other plugs were used state, the character of same and depth placed, from \_\_\_\_\_ feet to \_\_\_\_\_ feet each set.

Plugged off bottom with sand to 4450' and 5 sacks cement. Shot pipe @2950', pulled a total of 72 joints of 5-1/2" casing. Plugged surface with 3 hulls, 15 gel, 50 cement, 10 gel, 1 hull, plug and 150 cement, 60/40 pos, 6% gel. Plugging Complete.

(If additional description is necessary, use BACK of this form.)

Name of Plugging Contractor Kelso Casing Pulling, Inc. License No. 6050

Address P.O. Box 347 Chase, Kansas 67524

STATE OF Kansas COUNTY OF Rice, ss.

R. Darrell Kelso, President (employee of operator) or (operator) of above-described well, being first duly sworn on oath, says: That I have knowledge of the facts, statements, and matters herein contained and the log of the above-described well as filed that the same are true and correct, so help me God.

(Signature) R. Darrell Kelso

(Address) Box 347 Chase, Ks. 67524

SUBSCRIBED AND SWORN TO before me this 12th day of August, 1986



Irene Hoover  
Notary Public

My Commission expires: \_\_\_\_\_

AUG 14 1986  
8-14-86

**KANSAS DRILLERS LOG**

**IMPORTANT**  
Kans. Geo. Survey request  
samples on this well.

S. 34 T. 20 R. 35 <sup>NE</sup> <sub>W</sub>

API No. 15 — 203 — 20,045-0000  
County Number

Loc. C SE SW

Operator  
J. A. Allison

County Wichita

Address  
300 West Douglas, Suite 305 Wichita, Kansas 67202

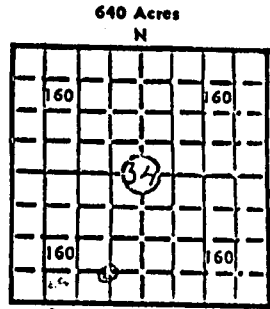

Well No. #1 Lease Name Wilkin

Elev.: Gr. 3172'

Footage Location  
660 feet from (N) (S) line 660 feet from (E) (W) line SW 1/4

Principal Contractor Gabbert-Jones, Inc. Geologist Delbert J. Costa

Spud Date August 14, 1979 Total Depth 5016' P.B.T.D. 4646

Date Completed 9/28/79 Oil Purchaser OKC

DF 3177' KB 3177'

**CASING RECORD**

Report of all strings set — surface, intermediate, production, etc.

Purpose of string	Size hole drilled	Size casing set (in O.D.)	Weight lbs/ft.	Setting depth	Type cement	Sacks	Type and percent additives
Surface		8-5/8"		331'	Common	250	
Production	7 7/8	5 1/2	5 1/2#	4689	60/40 Poz	150	10% salt

**LINER RECORD**

**PERFORATION RECORD**

Top, ft.	Bottom, ft.	Sacks cement	Shots per ft.	Size & type	Depth interval
			4/ft	DP	4502-4516

**TUBING RECORD**

Size	Setting depth	Packer set at
2 7/8	4617	

**ACID, FRACTURE, SHOT, CEMENT SQUEEZE RECORD**

Amount and kind of material used	Depth interval treated
100q 15% HCC 10009 15% HCL	4502-4516

**INITIAL PRODUCTION**

III 17 1980

Date of first production <u>October 6, 1979</u>	Producing method (flowing, pumping, gas lift, etc.) <u>Pump</u>	CONSERVATION DIVISION Wichita, Kansas	
RATE OF PRODUCTION PER 24 HOURS	Oil <u>70</u> bbls.	Gas <u>2</u> MCF	Water <u>2</u> bbls.
Disposition of gas (vented, used on lease or sold)		Gas-oil ratio <u>CFPB</u>	
Producing interval(s) <u>4502-4516</u>			

**INSTRUCTIONS:** As provided in KCC Rule 82-2-125, within 90 days after completion of a well, one completed copy of this Drillers Log shall be transmitted to the State Geological Survey of Kansas, 4150 Monroe Street, Wichita, Kansas 67209. Copies of this form are available from the Conservation Division, State Corporation Commission, 3830 So. Meridian (P.O. Box 17027), Wichita, Kansas 66217. Phone AC 316-522-2206. If confidential custody is desired, please note Rule 82-2-125. Drillers Logs will be on open file in the Oil and Gas Division, State Geological Survey of Kansas, Lawrence, Kansas 66044.