

15135-21616-0000

STATE OF KANSAS
STATE CORPORATION COMMISSION

WELL PLUGGING RECORD

Give All Information Completely
Make Required Affidavit
Mail or Deliver Report to
Conservation Division
State Corporation Comm.
245 North Water
Wichita, KS 67202

Ness County, Sec. 5 Twp. 16 Rge. 23 E/W
Location as "NE/CNW 1/4 SW 1/4" or footage from lines
50' S of C SW NE

Lease Owner Woodman & Iannitti Drilling Co.
Lease Name Combest Well No. 1
Office Address 1008 Douglas Bldg. 104 So. Broadway
Character of Well (Completed as Oil, Gas or Dry Hole)
dry hole

Date Well completed May 4 19 79
Application for plugging filed May 4 19 79
Application for plugging approved May 4 19 79
Plugging commenced May 4 19 79
Plugging completed May 4 19 79
Reason for abandonment of well or producing formation
dry hole

If a producing well is abandoned, date of last production
19

Was permission obtained from the Conservation Division or
its agents before plugging was commenced? yes

Name of Conservation Agent who supervised plugging of this well Clarence Thomas
Producing formation Depth to top Bottom Total Depth of Well 4440
Show depth and thickness of all water, oil and gas formations.

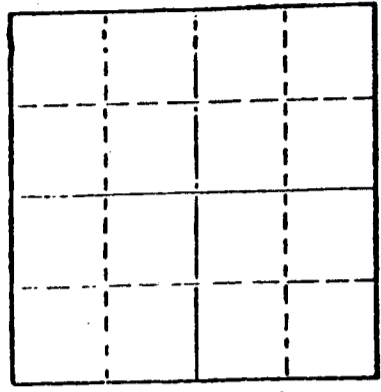

Locate well correctly on above
Section Plat

OIL, GAS OR WATER RECORDS

CASING RECORD

| FORMATION | CONTENT | FROM | TO | SIZE | PUT IN | PULLED OUT |
|-----------|---------|------|----|-------|--------|------------|
| | | | | 8 5/8 | 263 | |
| | | | | | | |
| | | | | | | |
| | | | | | | |

Describe in detail the manner in which the well was plugged, indicating where the mud fluid
was placed and the method or methods used in introducing it into the hold. If cement or other
plugs were used, state the character of same and depth placed, from feet to
feet for each plug set.

1st plug 1250 w/70 sx.
2nd plug 253 w/40 sx.
3rd plug 40 w/10 sx.
3 sx in rat hole

(If additional description is necessary, use BACK of this sheet)

Name of Plugging Contractor Woodman & Iannitti Drilling Co.
STATE CORPORATION COMMISSION

STATE OF KANSAS MAY - 8 1979 OF SEDGWICK, ss.
(employee of owner) or (owner or operator)

of the above-described well, being first duly sworn on oath, says: That I have knowledge of
the facts, statements, and matters contained and the log of the above-described well
as filed and that the same are true and correct. So help me God.

(Signature) K. T. Woodman
1008 Douglas Bldg. 104 So. Broadway
(Address)

SUBSCRIBED AND SWORN TO before me this 7th day of May, 19 79

My commission expires Feb. 11, 1980

Justina Chamberlain
Notary Public.

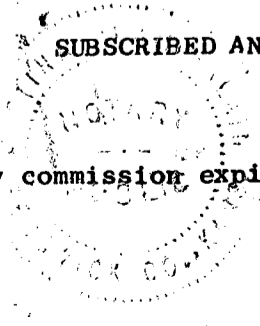

KANSAS DRILLERS LOG

IMPORTANT
Kans. Geo. Survey request
samples on this well.

S. 5 T. 16 R. 23 $\frac{E}{W}$
50' S of
Loc. C SW NE

API No. 15 — 135 — 21,616-0000
County Number

County Ness

Operator
Woodman * Iannitti Drilling Co.

Address
1008 Douglas Bldg. Wichita, Kansas 67202

Well No. # 1 Lease Name Combes 5

Footage Location
feet from (N) (S) line feet from (E) (W) line

Principal Contractor Woodman & Iannitti Drilling Co. Geologist J. C. Musgrove

Spud Date April 25, 1979 Total Depth 4440' P.B.T.D.

Date Completed May 4, 1979 Oil Purchaser

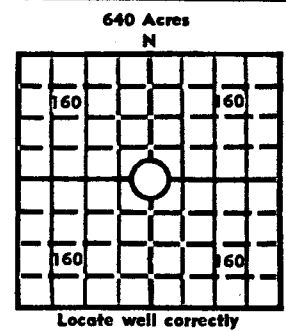

Elev.: Gr. _____
DF _____ KB 2432

CASING RECORD

Report of all strings set — surface, intermediate, production, etc.

| Purpose of string | Size hole drilled | Size casing set (in O.D.) | Weight lbs/ft. | Setting depth | Type cement | Sacks | Type and percent additives |
|-------------------|-------------------|---------------------------|----------------|---------------|-------------|-------|----------------------------|
| Surface | 12 1/2" | 8 5/8 | 28 | 263 | bulk | 185 | |
| | | | | | | | |
| | | | | | | | |
| | | | | | | | |

LINER RECORD

PERFORATION RECORD

| Top, ft. | Bottom, ft. | Sacks cement | Shots per ft. | Size & type | Depth interval |
|----------|-------------|--------------|---------------|-------------|----------------|
| | | | | | |
| | | | | | |

TUBING RECORD

| Size | Setting depth | Packer set at |
|------|---------------|---------------|
| | | |

ACID, FRACTURE, SHOT, CEMENT SQUEEZE RECORD

| Amount and kind of material used | Depth interval treated |
|----------------------------------|------------------------|
| | |
| | |

RECEIVED
STATE CORPORATION COMMISSION

MAY - 8 1979

INITIAL PRODUCTION

CONSERVATION DIVISION
Wichita, Kansas

Date of first production _____ Producing method (flowing, pumping, gas lift, etc.) _____

| | | | | |
|---------------------------------|-----------------|---------------|-------------------|--------------------------|
| RATE OF PRODUCTION PER 24 HOURS | Oil _____ bbls. | Gas _____ MCF | Water _____ bbls. | Gas-oil ratio _____ CFPB |
|---------------------------------|-----------------|---------------|-------------------|--------------------------|

Disposition of gas (vented, used on lease or sold) _____ Producing interval (s) _____

INSTRUCTIONS: As provided in KCC Rule 82-2-125, within 90 days after completion of a well, one completed copy of this Drillers Log shall be transmitted to the State Geological Survey of Kansas, 4150 Monroe Street, Wichita, Kansas 67209. Copies of this form are available from the Conservation Division, State Corporation Commission, 3830 So. Meridian (P.O. Box 17027), Wichita, Kansas 66217. Phone AC 316-522-2206. If confidential custody is desired, please note Rule 82-2-125. Drillers Logs will be on open file in the Oil and Gas Division, State Geological Survey of Kansas, Lawrence, Kansas 66044.

Operator

Woodman & Iannitti Drilling Co.

DESIGNATE TYPE OF COMP.: OIL, GAS, DRY HOLE, SWDW, ETC.:

Dry Hole

Well No.

1

Lease Name

Combest

S 5 T 16 R 23 ^{2X}
W

WELL LOG

Show all important zones of porosity and contents thereof; cored intervals, and all drill-stem tests, including depth interval tested, cushion used, time tool open, flowing and shut-in pressures, and recoveries.

SHOW GEOLOGICAL MARKERS, LOGS RUN, OR OTHER DESCRIPTIVE INFORMATION.

FORMATION DESCRIPTION, CONTENTS, ETC.

TOP

BOTTOM

NAME

DEPTH

Surface soil

40

Shale

40

265

Grey shale

265

665

Redbed

665

714

Dakota sand

714

725

Sand

725

835

Shale & hard sand

835

915

Shale & redbed

915

1245

Dakota sand

1245

1515

Shale & redbed

1515

1565

Redbed & sand

1565

1804

Anhy

1804

1844

Shale

1844

2455

Shale w.lime

2455

2675

Lime & shale

2675

3285

Lime & shale

3285

3850

Lime & shale

3850

3995

Lime

3955

4055

Lime & shale

4055

4100

Lime

4100

4250

Lime & shale

4250

4330

Lime

4330

4440

USE ADDITIONAL SHEETS, IF NECESSARY, TO COMPLETE WELL RECORD.

Date Received

R. T. Woodman

Signature

Partner

Title

May 7, 1979

Date