

FOR KCC USE:

FORM C-1 7/91

FORM MUST BE TYPED

EFFECTIVE DATE: 6-4-96

FORM MUST BE SIGNED

DISTRICT # 1

State of Kansas  
NOTICE OF INTENTION TO DRILL

ALL BLANKS MUST BE FILLED

SGA? Yes  No

Must be approved by the K.C.C. five (5) days prior to commencing well.

Expected Spud Date 6 8 1996  
month day year

Spot SW - NW - SE Sec. 13 Twp. 16 S, Rg. 26 X East West

OPERATOR: License # 4689 ✓  
Name: Thomas C. Lutz  
Address: P.O. Drawer 3067  
City/State/Zip: Lawrence, Kansas 66046  
Contact Person: Thomas C. Lutz  
Phone: (913) 832-1119

..... 1650 ..... feet from South ~~North~~ line of Section  
..... 2310 ..... feet from East ~~West~~ line of Section  
IS SECTION X REGULAR \_\_\_\_\_ IRREGULAR?

(NOTE: Locate well on the Section Plat on Reverse Side)  
County: Ness  
Lease Name: Evel "B" 151A Well #: 4  
Field Name: Arnold SW

CONTRACTOR: License #: 31548 ✓  
Name: Discovery Drilling, Inc.

Is this a Prorated/Spaced Field? .... yes X no ✓  
Target Formation(s): Mississippian

Well Drilled For: Well Class: Type Equipment:  
X Oil ... Enh Rec X Infield X Mud Rotary  
... Gas ... Storage ... Pool Ext. ... Air Rotary  
... OWMO ... Disposal ... Wildcat ... Cable  
... Seismic; ... # of Holes ... Other  
... Other .....

Nearest lease or unit boundary: 1650'  
Ground Surface Elevation: 2570 Est. ..... feet MSL  
Water well within one-quarter mile: .... yes X no

If OWMO: old well information as follows:  
Operator: .....  
Well Name: .....  
Comp. Date: ..... Old Total Depth .....

Public water supply well within one mile: .... yes X no  
Depth to bottom of fresh water: 320-240' .....  
Depth to bottom of usable water: 1250-1150' .....

Directional, Deviated or Horizontal wellbore? .... yes X no  
If yes, true vertical depth: .....  
Bottom Hole Location: .....

Surface Pipe by Alternate: .... 1 X 2  
Length of Surface Pipe Planned to be set: 340' .....  
Length of Conductor pipe required: None .....

Projected Total Depth: 4600' .....  
Formation at Total Depth: Mississippian .....  
Water Source for Drilling Operations:  
... well X farm pond .... other

Will Cores Be Taken?: .... yes X no  
If yes, proposed zone: .....

AFFIDAVIT

The undersigned hereby affirms that the drilling, completion and eventual plugging of this well shall conform with the requirements of the Conservation Division, Kansas, et. seq.

It is agreed that the following minimum requirements will be met:

RECEIVED  
5-30-96  
MAY 30 1996

1. Notify the appropriate district office prior to spudding of well;
2. A copy of the approved notice of intent to drill shall be posted on each drilling rig;
3. The minimum amount of surface pipe as specified below shall be set by circulating cement to the top; in all cases surface pipe shall be set through all unconsolidated materials plus a minimum of 20 feet into the underlying formation;
4. If the well is dry hole, an agreement between the operator and the district office on plug length and placement is necessary prior to plugging;
5. The appropriate district office will be notified before well is either plugged or production casing is cemented in;
6. IF AN ALTERNATE II COMPLETION, PRODUCTION PIPE SHALL BE CEMENTED FROM BELOW ANY USABLE WATER TO SURFACE WITHIN 120 DAYS OF SPUD DATE. IN ALL CASES, NOTIFY DISTRICT OFFICE PRIOR TO ANY CEMENTING.

I hereby certify that the statements made herein are true and to the best of my knowledge and belief.

Date: 5/28/96 ..... Signature of Operator or Agent: Thomas C. Lutz ..... Title: Agent .....

FOR KCC USE:  
API # 15- 135-23938 0000  
Conductor pipe required NONE feet  
Minimum surface pipe required 260 feet per Alt. X (2)  
Approved by: DPW 5-30-96  
This authorization expires: 11-30-96  
(This authorization void if drilling not started within 6 months of effective date.)  
Spud date: \_\_\_\_\_ Agent: \_\_\_\_\_

REMEMBER TO:

- File Drill Pit Application (form CDP-1) with Intent to Drill;
- File Completion Form ACO-1 within 120 days of spud date;
- File acreage attribution plat according to field proration orders;
- Notify appropriate district office 48 hours prior to workover or re-entry;
- Submit plugging report (CP-4) after plugging is completed;
- Obtain written approval before disposing or injecting salt water.

Mail to: KCC - Conservation Division, 130 S. Market - Room 2078, Wichita, Kansas 67202.

CORRECTION TO NAME 11-15-96JK

13  
16  
26W

**IN ALL CASES PLOT THE INTENDED WELL ON THE PLAT BELOW**

**PLAT OF ACREAGE ATTRIBUTABLE TO A WELL IN A PRORATED OR SPACED FIELD**

**If the intended well is in a prorated or spaced field, please fully complete this side of the form.** If the intended well is in a prorated or spaced field complete the plat below showing that the well will be properly located in relationship to other wells producing from the common source of supply. Please show all the wells within 1 mile of the boundaries of the proposed acreage attribution unit for gas wells and within 1/2 mile of the boundaries of the proposed acreage attribution unit for oil wells.

API NO. 15- \_\_\_\_\_  
 OPERATOR Thomas C. Lutz  
 LEASE Evel "B" #4  
 WELL NUMBER 4  
 FIELD Arnold SW

LOCATION OF WELL: COUNTY Ness  
 \_\_\_\_\_ feet from south/~~NORTH~~ line of section  
1650  
 \_\_\_\_\_ feet from east/~~WEST~~ line of section  
2310  
 SECTION 13 TWP 16s RG 26w

NUMBER OF ACRES ATTRIBUTABLE TO WELL 20  
 QTR/QTR/QTR OF ACREAGE SW - NW - SE

IS SECTION X REGULAR or \_\_\_\_\_ IRREGULAR  
**IF SECTION IS IRREGULAR, LOCATE WELL FROM NEAREST CORNER BOUNDARY.**

Section corner used: \_\_\_\_\_ NE \_\_\_\_\_ NW X SE \_\_\_\_\_ SW

**PLAT**

(Show location of the well and shade attributable acreage for prorated or spaced wells.)  
 (Show footage to the nearest lease or unit boundary line.)

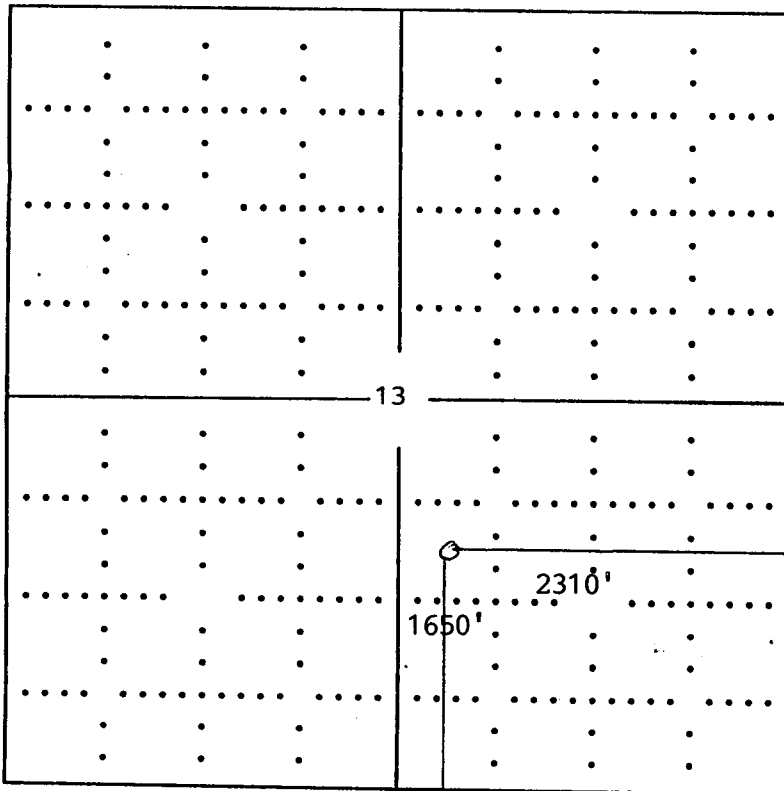

Ness Co.

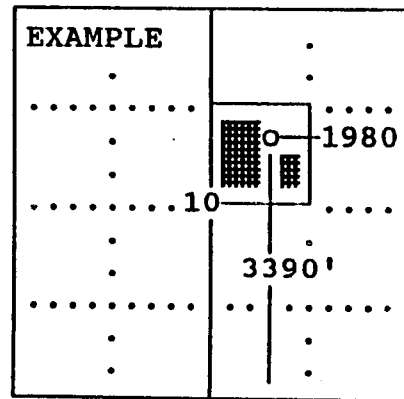

SEWARD CO.

**In plotting the proposed location of the well, you must show:**

- 1) The manner in which you are using the depicted plat by identifying section lines, i.e. 1 section, 1 section with 8 surrounding sections, 4 sections, etc.;
- 2) the distance of the proposed drilling location from the section's south/north and east/west; and
- 3) the distance to the nearest lease or unit boundary line.

Correction

EFFECTIVE DATE: 6-4-96

FORM MUST BE TYPED

DISTRICT # 1

State of Kansas

FORM MUST BE SIGNED

SGA? Yes No

NOTICE OF INTENTION TO DRILL

ALL BLANKS MUST BE FILLED

Must be approved by the K.C.C. five (5) days prior to commencing well.

Expected Spud Date 6 8 1996  
month day year

Spot SW - NW - SE Sec 13 Twp 16 S, Rg 26 East  
West

OPERATOR: License # 4689  
Name: Thomas C. Lutz  
Address: P.O. Drawer 3067  
City/State/Zip: Lawrence, Kansas 66046  
Contact Person: Thomas C. Lutz  
Phone: (913) 832-1119

1650 feet from South ~~North~~ line of Section  
2310 feet from East ~~West~~ line of Section  
IS SECTION X REGULAR IRREGULAR?

(NOTE: Locate well on the Section Plat on Reverse Side)  
County: Ness

Lease Name: Evel "B" "A" Well #: 4  
Field Name: Arnold SW

CONTRACTOR: License #: 31548  
Name: Discovery Drilling, Inc.

Is this a Prorated/Spaced Field? yes X no  
Target Formation(s): Mississippian

Nearest lease or unit boundary: 1650'  
Ground Surface Elevation: 2570 Est. feet MSL

Well Drilled For: Well Class: Type Equipment:  
X Oil ... Enh Rec X Infield X Mud Rotary  
... Gas ... Storage ... Pool Ext. ... Air Rotary  
... OWWD ... Disposal ... Wildcat ... Cable  
... Seismic; ... # of Holes ... Other

Water well within one-quarter mile: yes X no  
Public water supply well within one mile: yes X no

Depth to bottom of fresh water: 320 240'  
Depth to bottom of usable water: 1250 1150'

Surface Pipe by Alternate: 1 X 2  
Length of Surface Pipe Planned to be set: 340'

Length of Conductor pipe required: None  
Projected Total Depth: 4600'

Formation at Total Depth: Mississippian  
Water Source for Drilling Operations:  
... well X farm pond ... other

If OWWD: old well information as follows:  
Operator: \_\_\_\_\_  
Well Name: \_\_\_\_\_  
Comp. Date: \_\_\_\_\_ Old Total Depth \_\_\_\_\_

Directional, Deviated or Horizontal wellbore? yes X no  
If yes, true vertical depth: \_\_\_\_\_  
Bottom Hole Location: \_\_\_\_\_

Will Cores Be Taken?: yes X no  
If yes, proposed zone: \_\_\_\_\_

IS: EVEL "A" 4

AFFIDAVIT WAS: EVEL "B" 4

RECEIVED

The undersigned hereby affirms that the drilling, completion and eventual plugging of this well in accordance with the provisions of the Conservation Division, et. seq.

It is agreed that the following minimum requirements will be met:

MAY 30 1996

1. Notify the appropriate district office prior to spudding of well;
2. A copy of the approved notice of intent to drill shall be posted on each drilling rig;
3. The minimum amount of surface pipe as specified below shall be set by circulating cement to the top; in all cases surface pipe shall be set through all unconsolidated materials plus a minimum of 20 feet into the underlying formation;
4. If the well is dry hole, an agreement between the operator and the district office on plug length and placement is necessary prior to plugging;
5. The appropriate district office will be notified before well is either plugged or production casing is cemented in;
6. IF AN ALTERNATE II COMPLETION, PRODUCTION PIPE SHALL BE CEMENTED FROM BELOW ANY USABLE WATER TO SURFACE WITHIN 120 DAYS OF SPUD DATE. IN ALL CASES, NOTIFY DISTRICT OFFICE PRIOR TO ANY CEMENTING.

I hereby certify that the statements made herein are true and to the best of my knowledge and belief.  
Date: 5/28/96 Signature of Operator or Agent: Thomas C. Lutz Title: Agent

FOR KCC USE:  
 API # 15- 135-23938 0000  
 Conductor pipe required None feet  
 Minimum surface pipe required 260 feet per Alt. X (2)  
 Approved by: DPW 5-30-96 / JK 11-15-96  
 This authorization expires: 11-30-96  
 (This authorization void if drilling not started within 6 months of effective date.)  
 Spud date: \_\_\_\_\_ Agent: \_\_\_\_\_

REMEMBER TO:

- File Drill Pit Application (form CDP-1) with Intent to Drill;
- File Completion Form ACO-1 within 120 days of spud date;
- File acreage attribution plat according to field proration orders;
- Notify appropriate district office 48 hours prior to workover or re-entry;
- Submit plugging report (CP-4) after plugging is completed;
- Obtain written approval before disposing or injecting salt water.

Mail to: KCC - Conservation Division, 130 S. Market - Room 2078, Wichita, Kansas 67202.

13  
10  
26w