

FOR KCC USE:

FORM C-1 7/91

EFFECTIVE DATE: 3-12-95

FORM MUST BE TYPED

DISTRICT # 1

State of Kansas

FORM MUST BE SIGNED

SGA? Yes No

NOTICE OF INTENTION TO DRILL

ALL BLANKS MUST BE FILLED

Must be approved by the K.C.C. five (5) days prior to commencing well.

Expected Spud Date March 18 1995
month day year

Spot NW - SW - SE Sec 13 Twp 16 S, Rg 26 East West

OPERATOR: License # 4689
Name: Thomas C. Lutz
Address: P.O. Box 940
City/State/Zip: Fayetteville, Ar 72702
Contact Person: Thomas C. Lutz
Phone: 501-443-5430

990 FSL feet from South line of Section
2310 FEL feet from East / West line of Section
IS SECTION X REGULAR IRREGULAR?

(NOTE: Locate well on the Section Plat on Reverse Side)

CONTRACTOR: License #: 31548
Name: Discovery Drilling

County: Ness
Lease Name: Evel Well #: A3
Field Name: Arnold SW

Is this a Prorated/Spaced Field? yes no
Target Formation(s): Mississippian

Well Drilled For: Well Class: Type Equipment:
 Oil ... Enh Rec Infield Mud Rotary
... Gas ... Storage ... Pool Ext. ... Air Rotary
... OWMO ... Disposal ... Wildcat ... Cable
... Seismic; ... # of Holes ... Other

Nearest lease or unit boundary: 330'
Ground Surface Elevation: 2560 est feet MSL
Water well within one-quarter mile: yes no

If OWMO: old well information as follows:
Operator: _____
Well Name: _____
Comp. Date: _____ Old Total Depth _____

Public water supply well within one mile: yes no
Depth to bottom of fresh water: 500-720'
Depth to bottom of usable water: 800-1250'

Directional, Deviated or Horizontal wellbore? yes no
If yes, true vertical depth: _____
Bottom Hole Location: _____

Surface Pipe by Alternate: 1 2
Length of Surface Pipe Planned to be set: 250'
Length of Conductor pipe required: NA

Projected Total Depth: 4600'
Formation at Total Depth: Mississippian

Water Source for Drilling Operations:
... well farm pond ... other

Will Cores Be Taken?: yes no
If yes, proposed zone: _____

AFFIDAVIT

The undersigned hereby affirms that the drilling, completion and eventual plugging of this well will comply with K.S.A. 55-101, et. seq.

It is agreed that the following minimum requirements will be met:

1. Notify the appropriate district office prior to spudding of well;
2. A copy of the approved notice of intent to drill shall be posted on each drilling rig;
3. The minimum amount of surface pipe as specified below shall be set by circulating cement to the top; in all cases surface pipe shall be set through all unconsolidated materials plus a minimum of 20 feet into the underlying formation;
4. If the well is dry hole, an agreement between the operator and the district office on plug length and placement is necessary prior to plugging;
5. The appropriate district office will be notified before well is either plugged or production casing is cemented in;
6. IF AN ALTERNATE II COMPLETION, PRODUCTION PIPE SHALL BE CEMENTED FROM BELOW ANY USABLE WATER TO SURFACE WITHIN 120 DAYS OF SPUD DATE. IN ALL CASES, NOTIFY DISTRICT OFFICE PRIOR TO ANY CEMENTING.

I hereby certify that the statements made herein are true and to the best of my knowledge and belief.

Date: 3-3-95 Signature of Operator or Agent: Thomas C. Lutz Title: Agent

FOR KCC USE:
 API # 15- 13523865 0000
 Conductor pipe required NONE feet
 Minimum surface pipe required 340' feet per Alt.
 Approved by: DPW 3-7-95
 This authorization expires: 9-7-95
 (This authorization void if drilling not started within 6 months of effective date.)
 Spud date: _____ Agent: _____

REMEMBER TO:

- File Drill Pit Application (form CDP-1) with Intent to Drill;
- File Completion Form ACO-1 within 120 days of spud date;
- File acreage attribution plat according to field proration orders;
- Notify appropriate district office 48 hours prior to workover or re-entry;
- Submit plugging report (CP-4) after plugging is completed;
- Obtain written approval before disposing or injecting salt water.

Mail to: KCC - Conservation Division, 130 S. Market - Room 2078, Wichita, Kansas 67202.

13
14
263
STATE CORPORATION COMMISSION
MAR 07 1995
3-7-95
CONSERVATION DIVISION
SARAH WELLS

IN ALL CASES PLOT THE INTENDED WELL ON THE PLAT BELOW

PLAT OF ACREAGE ATTRIBUTABLE TO A WELL IN A PRORATED OR SPACED FIELD

If the intended well is in a prorated or spaced field, please fully complete this side of the form. If the intended well is in a prorated or spaced field complete the plat below showing that the well will be properly located in relationship to other wells producing from the common source of supply. Please show all the wells within 1 mile of the boundaries of the proposed acreage attribution unit for gas wells and within 1/2 mile of the boundaries of the proposed acreage attribution unit for oil wells.

API NO. 15- _____
 OPERATOR Thomas C. Lutz LOCATION OF WELL: COUNTY Ness
 LEASE Evel _____ 990 feet from ~~south~~/north line of section
 WELL NUMBER A3 _____ 2310 feet from east/~~west~~ line of section
 FIELD Arnold SW _____ SECTION 13 TWP 16S RG 26W

NUMBER OF ACRES ATTRIBUTABLE TO WELL _____ IS SECTION X REGULAR or _____ IRREGULAR
 QTR/QTR/QTR OF ACREAGE _____ IF SECTION IS IRREGULAR, LOCATE WELL FROM NEAREST CORNER BOUNDARY.

Section corner used: _____ NE _____ NW _____ SE _____ SW

PLAT

(Show location of the well and shade attributable acreage for prorated or spaced wells.)
 (Show footage to the nearest lease or unit boundary line.)

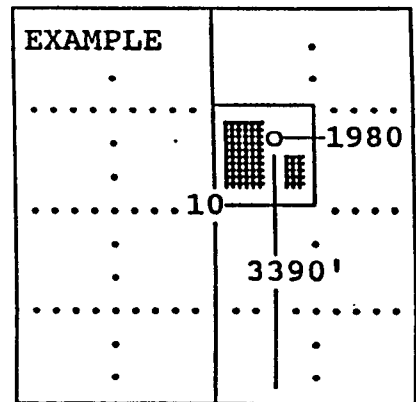
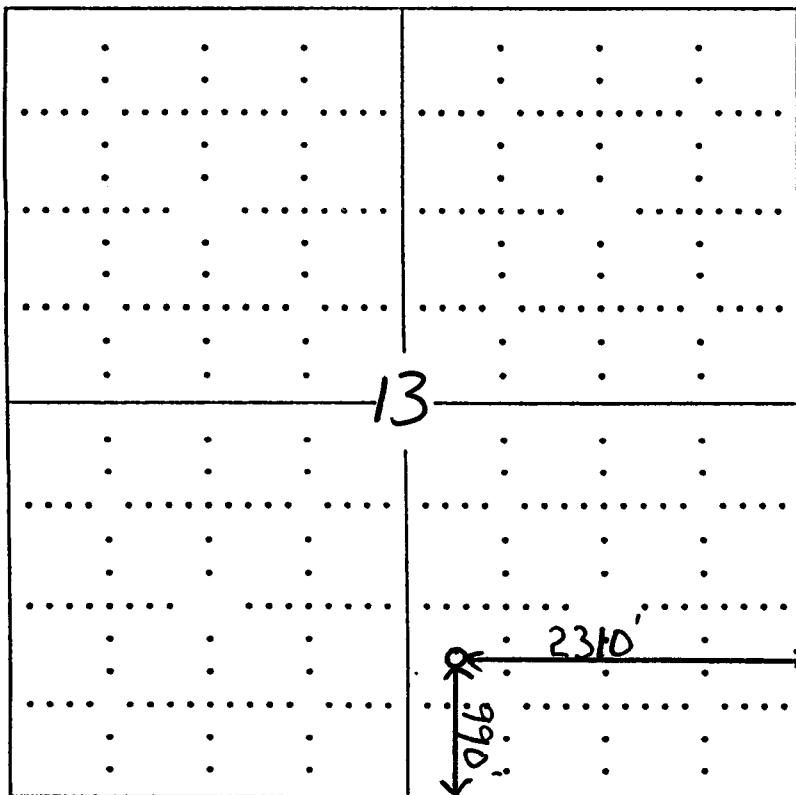

SEWARD CO.

In plotting the proposed location of the well, you must show:

- 1) The manner in which you are using the depicted plat by identifying section lines, i.e. 1 section, 1 section with 8 surrounding sections, 4 sections, etc.;
- 2) the distance of the proposed drilling location from the section's south/north and east/west; and
- 3) the distance to the nearest lease or unit boundary line.