

EFFECTIVE DATE: 10-8-96

State of Kansas

DISTRICT # 1

NOTICE OF INTENTION TO DRILL

SGA? Yes, X No

Must be approved by the K.C.C. five (5) days prior to commencing well.

Expected Spud Date OCTOBER 23 1996 month day year

SW NE SE Sec 24 Twp 16s S, Rg 26 East West

OPERATOR: License # 7200 Name: Scott T. Lutz Address: P.O. Drawer D Shell Knob, MO 65747 Contact Person: Scott T. Lutz Phone: (501) 443-5430

1845 feet from South / X REGULAR line of Section 1185 feet from East / X REGULAR line of Section IS SECTION X REGULAR IRREGULAR?

CONTRACTOR: License #: 31548 Name: Discovery Drilling, Inc.

(NOTE: Locate well on the Section Plat on Reverse Side)

Well Drilled For: Well Class: Type Equipment: X Oil ... Enh Rec X Infield X Mud Rotary ... Gas ... Storage ... Pool Ext. ... Air Rotary ... OWD ... Disposal ... Wildcat ... Cable ... Seismic; ... # of Holes ... Other

County: Ness Lease Name: Nicheror Well #: 10 Field Name: Arnold SW Is this a Prorated/Spaced Field? yes X no Target Formation(s): Mississippian Nearest lease or unit boundary: 1185' Ground Surface Elevation: 2570 EST feet MSL Water well within one-quarter mile: X yes X no Public water supply well within one mile: yes X no Depth to bottom of fresh water: 200' Depth to bottom of usable water: 1150' Surface Pipe by Alternate: 1 X 2 Length of Surface Pipe Planned to be set: 220' Length of Conductor pipe required: None Projected Total Depth: 4600' Formation at Total Depth: Mississippian Water Source for Drilling Operations: well X farm pond other

If OAWD: old well information as follows: Operator: Well Name: Comp. Date: Old Total Depth

Directional, Deviated or Horizontal wellbore? yes X no If yes, true vertical depth: Bottom Hole Location:

Will Cores Be Taken? yes X no If yes, proposed zone:

AFFIDAVIT

The undersigned hereby affirms that the drilling, completion and eventual plugging of this well will comply with K.S.A. 55-101, et. seq. It is agreed that the following minimum requirements will be met:

- 1. Notify the appropriate district office prior to spudding of well;
2. A copy of the approved notice of intent to drill shall be posted on each drilling rig;
3. The minimum amount of surface pipe as specified below shall be set by circulating cement to the top; in all cases surface pipe shall be set through all unconsolidated materials plus a minimum of 20 feet into the underlying formation;
4. If the well is dry hole, an agreement between the operator and the district office on plug length and placement is necessary prior to plugging;
5. The appropriate district office will be notified before well is either plugged or production casing is cemented in;
6. IF AN ALTERNATE IS COMPLETION, PRODUCTION PIPE SHALL BE CEMENTED FROM BELOW ANY USABLE WATER TO SURFACE WITHIN 120 DAYS OF SPUD DATE. IN ALL CASES, NOTIFY DISTRICT OFFICE PRIOR TO ANY CEMENTING.

I hereby certify that the statements made herein are true and to the best of my knowledge and belief. Date: 9/30/96 Signature of Operator or Agent: Thomas H. A. Title: Agent

FOR KCC USE: API # 15- 135-239540000 Conductor pipe required NONE feet Minimum surface pipe required 220 feet per Alt. X(2) Approved by: JK 10-3-96 This authorization expires: 4-3-97 (This authorization void if drilling not started within 6 months of effective date.) Spud date: Agent:

RECEIVED KANSAS CORP COMM 1996 OCT - 3 A 12:35 10-3-96 24 16 2600

- REMEMBER TO: File Drill Pit Application (form CDP-1) with Intent to Drill; File Completion Form ACO-1 within 120 days of spud date; File acreage attribution plat according to field proration orders; Notify appropriate district office 48 hours prior to workover or re-entry; Submit plugging report (CP-4) after plugging is completed; Obtain written approval before disposing or injecting salt water.

Mail to: KCC - Conservation Division, 130 S. Market - Room 207B, Wichita, Kansas 67202.

**IN ALL CASES PLOT THE INTENDED WELL ON THE PLAT BELOW**

**PLAT OF ACREAGE ATTRIBUTABLE TO A WELL IN A PRORATED OR SPACED FIELD**

If the intended well is in a prorated or spaced field, please fully complete this side of the form. If the intended well is in a prorated or spaced field complete the plat below showing that the well will be properly located in relationship to other wells producing from the common source of supply. Please show all the wells within 1 mile of the boundaries of the proposed acreage attribution unit for gas wells and within 1/2 mile of the boundaries of the proposed acreage attribution unit for oil wells.

API NO. 15- \_\_\_\_\_  
 OPERATOR Scott T. Lutz  
 LEASE Nichepor  
 WELL NUMBER 10  
 FIELD \_\_\_\_\_

LOCATION OF WELL: COUNTY Ness  
 \_\_\_\_\_  
1845 feet from south/~~west~~ line of section  
1185 feet from east/~~west~~ line of section  
 SECTION 24 TWP 16s RG 26w

NUMBER OF ACRES ATTRIBUTABLE TO WELL \_\_\_\_\_  
 QTR/QTR/QTR OF ACREAGE SE - NW - SE

IS SECTION X REGULAR or \_\_\_\_\_ IRREGULAR  
**IF SECTION IS IRREGULAR, LOCATE WELL FROM NEAREST CORNER BOUNDARY.**

Section corner used: \_\_\_\_\_ NE \_\_\_\_\_ NW \_\_\_\_\_ SE \_\_\_\_\_ SW

**PLAT**

(Show location of the well and shade attributable acreage for prorated or spaced wells.)  
 (Show footage to the nearest lease or unit boundary line.)

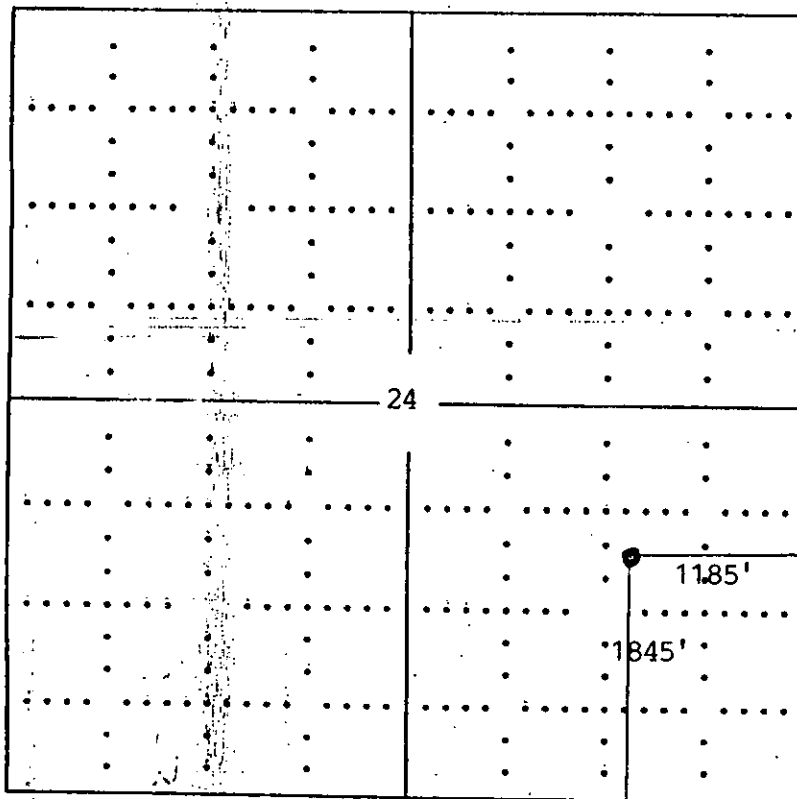

Ness Co.

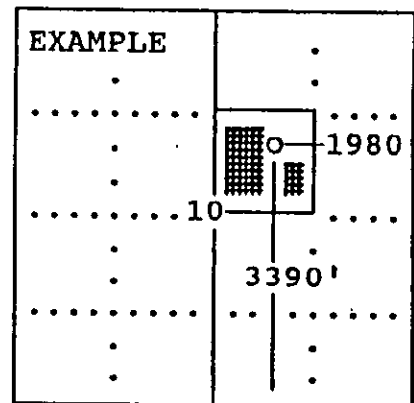

SEWARD CO.

**In plotting the proposed location of the well, you must show:**

- 1) The manner in which you are using the depicted plat by identifying section lines, i.e. 1 section, 1 section with 8 surrounding sections, 4 sections, etc.;
- 2) the distance of the proposed drilling location from the section's south/north and east/west; and
- 3) the distance to the nearest lease or unit boundary line.