

DISTRICT # 1

11-15-92

State of Kansas
NOTICE OF INTENTION TO DRILL

FORM MUST BE TYPED
FORM MUST BE SIGNED
ALL BLANKS MUST BE FILLED

SEAT Yes No

Must be approved by the K.C.C. five (5) days prior to commencing well

Expected Spud Date October 15, 1992
month day year

Spot SE NE SW East
NN NW SE Sec. 23, Twp. 16 S, Rg. 26 X West

OPERATOR: License # 6622 ✓
Name: Jason Oil Company
Address: P.O. Box 701
City/State/Zip: Russell, KS 67665
Contact Person: Jim Schoenberger
Phone: (913)-483-4204
(8027 mobil) TI

1650' 2310' feet from South North line of Section
2970' 2540' feet from East West line of Section
IS SECTION X REGULAR IRREGULAR?

(NOTE: Locate well on the Section Plat on Reverse Side)

CONTRACTOR: License #: 8241 ✓ (913) 483-5345
Name: Emphasis Oil Operations

County: Ness
Lease Name: Utica Well #: 2
Field Name: Unice East

Well Drilled For: Well Class: Type Equipment:

Is this a Prorated/Spaced Field? yes X no
Target Formation(s): Mississippi
Nearest lease or unit boundary: 330

X Oil Enh Rec X Infield X Mud Rotary
Gas Storage Pool Ext. Air Rotary
OUWO Disposal Wldcat Cable
Seismic: # of Holes Other

Ground Surface Elevation: 1987 2625' feet MSL
Domestic well within 330 feet: yes X no
Municipal well within one mile: yes X no

If OUWO: old well information as follows:
Operator:
Well Name:
Comp. Date: Old Total Depth:

Depth to bottom of fresh water: 300
Depth to bottom of usable water: 1175
Surface Pipe by Alternate: 1 X 2

Directional, Deviated or Horizontal wellbore? X yes no
If yes, total depth location: 2540' FEL & 2310' FSL 4724'
Bottom Hole Location: 2970' FEL & 1650' FSL

Length of Surface Pipe Planned to be set: 370
Length of Conductor pipe required: NA
Projected Total Depth: 4725' 4635'

Formation at Total Depth: Mississippi
Water Source for Drilling Operations:
well X farm pond other

DWR Permit #: Will Cores Be Taken? yes X no
If yes, proposed zone:

Docket No. 182,109-C
(C-26,533)

The undersigned hereby affirms that the drilling, completion and eventual plugging of this well will comply with K.S.A. 55-101, et. seq.
It is agreed that the following minimum requirements will be met:

1. Notify the appropriate district office prior to spudding of well;
2. A copy of the approved notice of intent to drill shall be posted on each drilling rig;
3. The minimum amount of surface pipe as specified below shall be set by circulating cement to the top; in all cases surface pipe shall be set through all unconsolidated materials plus a minimum of 20 feet into the underlying formation;
4. If the well is dry hole, an agreement between the operator and the district office on plug length and placement is necessary prior to plugging;
5. The appropriate district office will be notified before well is either plugged or production casing is cemented in;
6. IF AN ALTERNATE II COMPLETION, PRODUCTION PIPE SHALL BE CEMENTED FROM BELOW ANY USABLE WATER TO SURFACE WITHIN 120 DAYS OF SPUD DATE. IN ALL CASES, NOTIFY DISTRICT OFFICE PRIOR TO ANY CEMENTING.

I hereby certify that the statements made herein are true and to the best of my knowledge and belief.

Date: 9-22-92 Signature of Operator or Agent: [Signature] Title: Agent

FOR KCC USE:
 API # 15- 135-23,719 0000
 Conductor pipe required None feet
 Minimum surface pipe required 200' feet per Alt. X ②
 Approved by: C.B. 11-10-92
 This authorization expires: 4-10-93
 (This authorization void if drilling not started within 6 months of effective date.)
 Spud date: Agent:

REMEMBER TO:

- File Drill Pit Application (form CDP-1) with Intent to Drill;
- File Completion Form ACO-1 within 120 days of spud date;
- File acreage attribution plat according to field proration orders;
- Notify appropriate district office 48 hours prior to workover or re-entry;
- Submit plugging report (CP-4) after plugging is completed;
- Obtain written approval before disposing or injecting salt water.

Mail to: Conservation Division, 200 Colorado Derby Building, 202 W. First St., Wichita, Kansas 67202-1286.

RECEIVED
STATE CONSERVATION COMMISSION
9-24-92
SEP 24 1992
CONSERVATION DIVISION
Wichita, Kansas

IN ALL CASES PLOT THE INTENDED WELL ON THE PLAT BELOW

PLAT OF ACREAGE ATTRIBUTABLE TO A WELL IN A PRORATED OR SPACED FIELD

If the intended well is in a prorated or spaced field, please fully complete this side of the form. If the intended well is in a prorated or spaced field complete the plat below showing that the well will be properly located in relationship to other wells producing from the common source of supply. Please show all the wells within 1 mile of the boundaries of the proposed acreage attribution unit for gas wells and within 1/2 mile of the boundaries of the proposed acreage attribution unit for oil wells.

API NO. 15- _____
 OPERATOR _____ LOCATION OF WELL: COUNTY _____
 LEASE _____ feet from south/north line of section
 WELL NUMBER _____ feet from east/west line of section
 FIELD _____ SECTION _____ TWP _____ RG _____

NUMBER OF ACRES ATTRIBUTABLE TO WELL _____ IS SECTION _____ REGULAR or _____ IRREGULAR
 QTR/QTR/QTR OF ACREAGE _____ IF SECTION IS IRREGULAR, LOCATE WELL FROM NEAREST
 CORNER BOUNDARY.

Section corner used: _____ NE _____ NW _____ SE _____ SW

PLAT

(Show location of the well and shade attributable acreage for prorated or spaced wells.)
 (Show footage to the nearest lease or unit boundary line.)

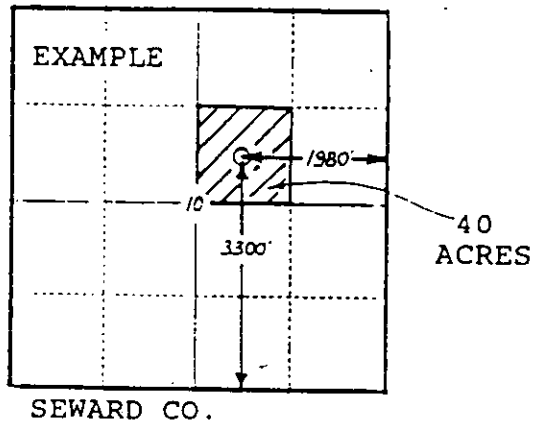
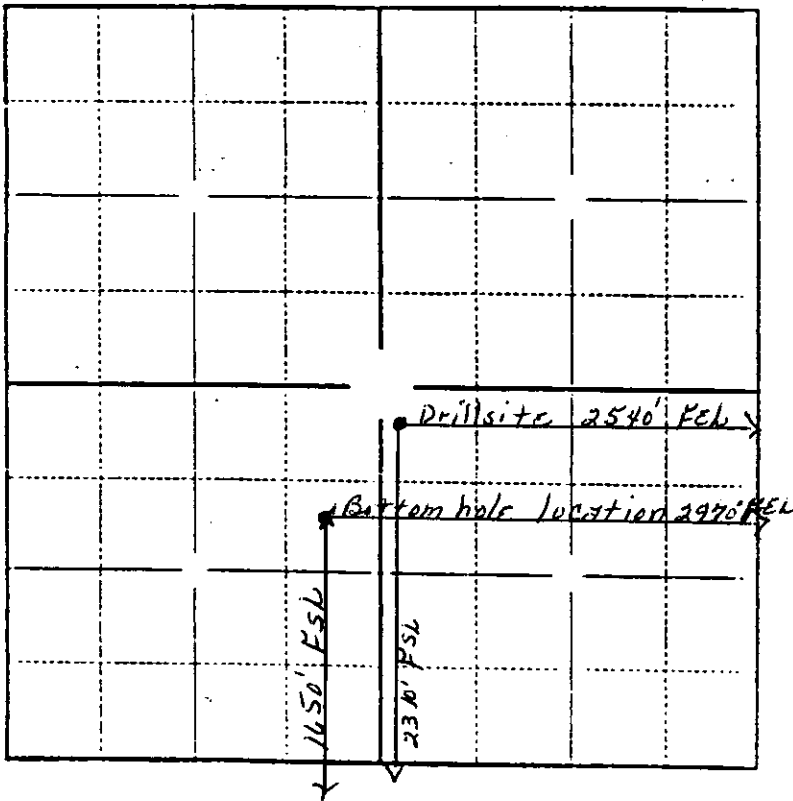

In plotting the proposed location of the well, you must show:

- 1) The manner in which you are using the depicted plat by identifying section lines, i.e. 1 section, 1 section with 8 surrounding sections, 4 sections, etc.;
- 2) the distance of the proposed drilling location from the section's south/north and east/west; and
- 3) the distance to the nearest lease or unit boundary line.