

EFFECTIVE DATE: 2-11-91

FORM MUST BE TYPED
FORM C-1 4/90

State of Kansas

FORM MUST BE SIGNED
ALL BLANKS MUST BE FILLED

NOTICE OF INTENTION TO DRILL

Must be approved by the K.C.C. five (5) days prior to commencing well

Expected Spud Date .. 2 .. 15 .. 91 .. East
month day year .. C SW NE Sec 32 Twp 31 S, Rg 7 X West

OPERATOR: License # 5151
Name: Gear Petroleum Co., Inc.
Address: 125 N. Market, Suite 1075
City/State/Zip: Wichita, KS 67202-1710
Contact Person: Jim Thatcher
Phone: (316) 265-3351

3300 feet from South line of Section
1980 feet from East line of Section
(Note: Locate well on Section Plat on Reverse Side)

CONTRACTOR: License #: 5418
Name: Allen Drilling Co.

County: Harper
Lease Name: Everson Well #: 1
Field Name: ---
Is this a Prorated Field? yes no
Target Formation(s): Elgin, Stalnaker
Nearest lease or unit boundary: 660
Ground Surface Elevation: 1472 feet MSL
Domestic well within 330 feet: yes X no
Municipal well within one mile: yes X no
Depth to bottom of fresh water: 100 50
Depth to bottom of usable water: 180
Surface Pipe by Alternate: X 1 2
Length of Surface Pipe Planned to be set: 250
Length of Conductor pipe required: AQUE
Projected Total Depth: 3700
Formation at Total Depth: Stalnaker
Water Source for Drilling Operations:
... well ... farm pond X ... other
DWR Permit #: ---
Will Cores Be Taken?: yes X no
If yes, proposed zone: ---

Well Drilled For: Well Class: Type Equipment:
X Oil ... Inj ... Infield X Mud Rotary
... Gas ... Storage ... Pool Ext. ... Air Rotary
... OWWO ... Disposal X Wildcat ... Cable
... Seismic; ... # of Holes

If OWWO: old well information as follows:
Operator: ---
Well Name: ---
Comp. Date: --- Old Total Depth ---

Directional, Deviated or Horizontal wellbore? yes X no
If yes, total depth location: ---

AFFIDAVIT

The undersigned hereby affirms that the drilling, completion and eventual plugging of this well will comply with K.S.A. 55-101, et. seq.

- It is agreed that the following minimum requirements will be met:
1. The appropriate district office shall be notified before setting surface pipe;
 2. The minimum amount of surface pipe as specified above shall be set by circulating cement to the top; in all cases surface pipe shall be set through all unconsolidated materials plus a minimum of 20 feet into the underlying formation;
 3. If the well is dry, a plugging proposal shall be submitted to the district office. An agreement between the operator and the district office on plug length and placement is necessary prior to plugging;
 4. The appropriate district office will be notified before well is either plugged or production casing is cemented in;
 5. If an Alternate II completion, production pipe shall be cemented from below any usable water to surface within 120 days of spud date. In all cases, notify district office prior to any cementing.

I hereby certify that the statements made herein are true and to the best of my knowledge and belief.
Date: 2/4/91 Signature of Operator or Agent: Jim Thatcher Title: Area Orlat Prod

FOR KCC USE:
API # 15- 077-21,235-00-00
Conductor pipe required None feet
Minimum surface pipe required 200 feet per Alt (1)
Approved by: MWA 8-6-91
EFFECTIVE DATE: 2-11-91
This authorization expires: 8-6-91
(This authorization void if drilling not started within 6 months of effective date.)
Spud date: Agent:

RECEIVED
STATE CORPORATION COMMISSION
02-05-1991
FEB 5 1991
CONSERVATION DIVISION
Wichita, Kansas

32
31
2W

REMEMBER TO:

- File Drill Pit Application (form GDP-1) with Intent to Drill;
- File Completion Form ACO-1 within 120 days of spud date;
- File acreage attribution plat according to field proration orders;
- Notify appropriate district office 48 hours prior to workover or re-entry;
- Submit plugging report (CP-4) after plugging is completed;
- Obtain written approval before disposing or injecting salt water.

PLAT OF ACREAGE ATTRIBUTABLE TO A WELL

State Corporation Commission, Conservation Division
200 Colorado Derby Bldg. Wichita, Kansas 67202

OPERATOR Gear Petroleum Co., Inc. LOCATION OF WELL:
 LEASE Everson 3300 feet north of SE corner
 WELL NUMBER 1 1980 feet west of SE corner
 FIELD --- C SW NE Sec. 32 T 31 R 7 E/W
 COUNTY Harper
 NO. OF ACRES ATTRIBUTABLE TO WELL 40 IS SECTION X REGULAR --- IRREGULAR?
 DESCRIPTION OF ACREAGE SW NE IF IRREGULAR, LOCATE WELL FROM NEAREST
 CORNER BOUNDARY.

NOTE: If plat depicted is insufficient for your circumstances, you may attach your own scaled or surveyed plat.

R7W PLAT
V-VIOLA
S-SIMPSON

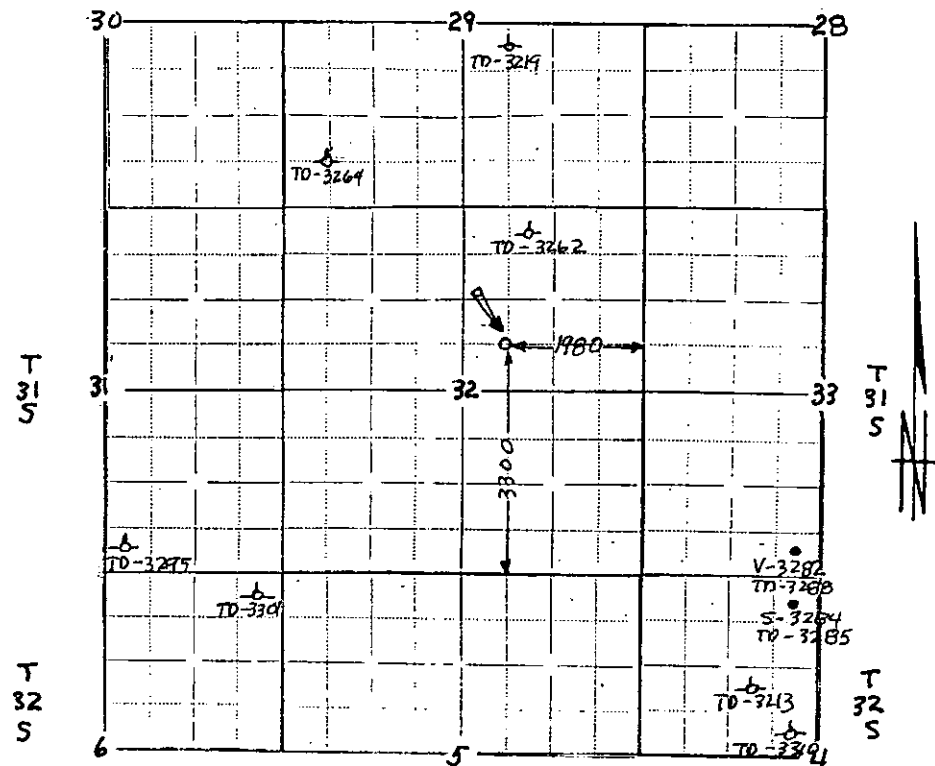

R7W

In plotting the proposed location of the well, you must show:

- 1) The manner in which you are using the depicted plat by identifying section lines, i.e. 1 section, 1 section with 8 surrounding partial sections, 4 sections, 16 sections, etc.;
- 2) the well's location relative to the location of other wells producing from the same common source of supply in adjoining drilling units, pursuant to K.A.R. 82-3-108, 82-3-207, 82-3-312, or special orders of the Commission;
- 3) the distance of the proposed drilling location from the section's east and south lines; and
- 4) the distance to the nearest lease or unit boundary line.

I hereby certify that the statements made herein are true and to the best of my knowledge and belief.

Signature of Operator or Agent Jim Matthews

Date 2/4/91 Title MAN. DRILL & PROD