

ORIGINAL

STATE CORPORATION COMMISSION OF KANSAS  
OIL & GAS CONSERVATION DIVISION

APR NO. 15-.....077-21,202-00-00.....1,5,1989

WELL COMPLETION OR RECOMPLETION FORM  
ACO-1 WELL HISTORY

DESCRIPTION OF WELL AND LEASE

Operator: License # 04511  
Name William H. Davis  
Address 2800 Mid-Continent Tower  
Tulsa, OK 74103  
City/State/Zip

Purchaser n/a

Operator Contact Person Mike Purdum  
Phone (918) 587-7782

Contractor: License # 5418  
Name Allen Drig. Co.

Wellsite Geologist Paul Barker  
Phone (405) 232-3070

Designate Type of Completion  
 New Well  Re-Entry  Workover  
 Oil  SWD  Temp Abd  
 Gas  Inj  Delayed Completion  
 Dry  Other (Core, Water Supply, etc.)

If ONWO: old well info as follows:  
Operator  
Well Name  
Comp. Date Old Total Depth

WELL HISTORY

Drilling Method:  
 Mud Rotary  Air Rotary  Cable  
.....10-30-89.....11-03-89.....11-04-89.....  
Spud Date Date Reached TD Completion Date  
.....3620.....  
Total Depth PBTD

Amount of Surface Pipe Set and Cemented at 316 feet  
Multiple Stage Cementing Collar Used?  Yes  No  
If yes, show depth set.....feet  
If alternate 2 completion, cement circulated  
from.....feet depth to.....w/.....SX cmt

County Harper  
NW NW SW Sec. 4 Twp. 33 Rge. 5  
 East  West

2310 Ft North from Southeast Corner of Section  
4950 Ft West from Southeast Corner of Section  
(Note: Locate well in section plat below)

Lease Name Schmidt Well # 1

Field Name

Producing Formation

Elevation: Ground 1336 KB 1341

Section Plat

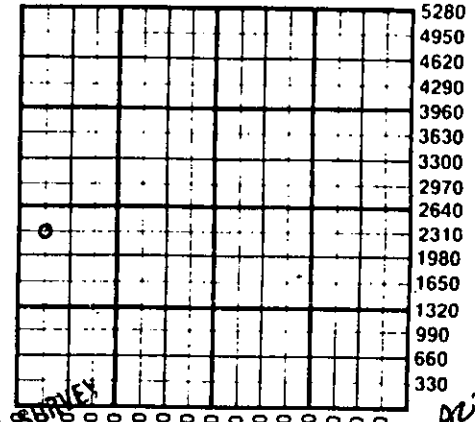

RECEIVED  
STATE CORPORATION COMMISSION  
NOV 27 1989  
NOV 27 1989  
KANSAS GEOLOGICAL SURVEY  
WICHITA BRANCH  
NOV 28 1989

WATER SUPPLY INFORMATION

Disposition of Produced Water:  Disposal  
Docket #  Repressuring

Questions on this portion of the ACO-1 call:  
Water Resources Board (913) 296-3717

Source of Water:  
Division of Water Resources Permit #.....  
 Groundwater.....Ft North from Southeast Corner  
(Well) .....Ft West from Southeast Corner of  
Sec Twp Rge  East  West  
 Surface Water 4620 Ft North from Southeast Corner  
(Stream, pond etc) 4620 Ft West from Southeast Corner  
Sec 7 Twp 33 Rge 5  East  West  
 Other (explain).....  
(purchased from city, R.W.D. #)

INSTRUCTIONS: This form shall be completed in duplicate and filed with the Kansas Corporation Commission, 200 Colorado Derby Building, Wichita, Kansas 67202, within 90 days after completion or recompletion of any well. Rule 82-3-130 and 82-3-107 apply.  
Information on side two of this form will be held confidential for a period of 12 months if requested in writing and submitted with the form. See rule 82-3-107 for confidentiality in excess of 12 months.  
One copy of all wireline logs and drillers time log shall be attached with this form. Submit CP-4 form with all plugged wells. Submit CP-111 form with all temporarily abandoned wells.

All requirements of the statutes, rules and regulations promulgated to regulate the oil and gas industry have been fully complied with and the statements herein are complete and correct to the best of my knowledge.

Signature [Signature]  
Title Operator Date 11-21-89

Subscribed and sworn to before me this 21st day of November 1989  
Notary Public [Signature]  
Date Commission Expires 03-27-89

K.C.C. OFFICE USE ONLY  
 Letter of Confidentiality Attached  
 Wireline Log Received  
 Drillers Timelog Received  
Distribution  
 KCC  SWD/Rep  NGPA  
 KGS  Plug  Other (Specify)

Sec. Twp. Rge.

P1

Operator Name ..... William H. Davis ..... Lease (Name) ..... Schmidt ..... Well # ..... 1

Sec. 4 ..... Twp. 33 ..... Rge. 5 .....  East  West County ..... Harper ..... RELEASED

JAN 15 1991

WELL LOG

INSTRUCTIONS: Show important tops and base of formations penetrated. Detail all cores. Report all drill stem tests giving interval tested, time tool open and closed, flowing and shut-in pressures, whether shut-in pressure reached static level, hydrostatic pressures, bottom hole temperature, fluid recovery, and flow rates if gas to surface during test. Attach extra sheet if more space is needed. Attach copy of log.

FROM CONFIDENTIAL

Drill Stem Tests Taken  Yes  No  
Samples Sent to Geological Survey  Yes  No  
Cores Taken  Yes  No

Formation Description  
 Log  Sample

Stalnaker 3502-17  
IH 1661  
IF 15 min. (52-52)  
Weak blow with slight increase  
ISIP 60 min. (1456)  
FFP 60 min. (63-105)  
fair blow  
FSIP 120 min. (1436)  
FH 1641  
Rec. 210' muddy water

Name	Top	Bottom
Howard Im	2530	
Topeka Im	2755	
Heebner Sh	3120	
Iatan Im	3470	
Stalnaker SS	3501	
TD	3620	

CASING RECORD  New  Used  
Report all strings set-conductor, surface, intermediate, production, etc.

Purpose of String	Size Hole Drilled	Size Casing Set (in O.D.)	Weight Lbs/Ft.	Setting Depth	Type of Cement	#Sacks Used	Type and Percent Additives
Surface	12 1/4	8 5/8	24#	316	60/40	200	2% gel 3% CC

Shots Per Foot	Specify Footage of Each Interval Perforated	Acid, Fracture, Shot, Cement Squeeze Record (Amount and Kind of Material Used)	Depth
.....	.....	.....	.....
.....	.....	.....	.....
.....	.....	.....	.....

TUBING RECORD Size Set At Packer at Liner Run  Yes  No

Date of First Production Producing Method  Flowing  Pumping  Gas Lift  Other (explain).....

Estimated Production Per 24 Hours	Oil Bbls	Gas MCF	Water Bbls	Gas-Oil Ratio	Gravity

METHOD OF COMPLETION Production Interval  
Disposition of gas:  Vented  Open Hole  Perforation  
 Sold  Other (Specify) .....  
 Used on Lease  Dually Completed  Commingled