

STATE CORPORATION COMMISSION OF KANSAS
OIL & GAS CONSERVATION DIVISION
WELL COMPLETION OR RECOMPLETION FORM

ACO-1 WELL HISTORY
DESCRIPTION OF WELL AND LEASE Pendleton
Land & Exploration, Inc

Operator: License # 3536
Name Ramco Drilling Services, Inc.
Address Box 99
City/State/Zip Belpre, Ohio 45714

Purchaser
Operator Contact Person Bob Williamson
Phone 614-423-9591

Contractor: License # 5302
Name Red Tiger Drilling Company
Wellsite Geologist Robert Smith
Phone (316) 564-3362

Designate Type of Completion
 New Well Re-Entry Workover
 Oil SWD Temp Abd
 Gas Inj Delayed Comp.
 Dry Other (Core, Water Supply etc.)
If ONWO: old well Info as follows:
Operator
Well Name
Comp. Date
Old Total Depth

WELL HISTORY

Drilling Method:
 Mud Rotary Air Rotary Cable
3/9/88 3/17/88
Spud Date Date Reached TD Completion Date
3,600'
Total Depth PBTD
Amount of Surface Pipe Set and Cemented at 380.08 feet
Multiple Stage Cementing Collar Used? Yes No
If yes, show depth set...feet
If alternate 2 completion, cement circulated from...feet depth to...w/...SX cmt
Cement Company Name
Invoice #

API NO. 15-009-24,309-00-00
County Barton
NW/4 SW/4 SW/4 Sec. 8 Twp. 17S Rge. 14W East
990 Ft North from Southeast Corner of Section
4950 Ft West from Southeast Corner of Section
(Note: Locate well in section plat below)

Lease Name Beatrice Axman Well # 2
Field Name
Producing Formation
Elevation: Ground 1940 KB 1945

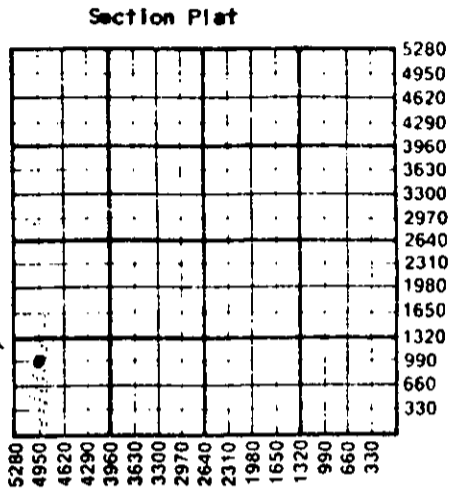

RECEIVED
STATE CORPORATION COMMISSION
JUN 10 1988
CONSERVATION DIVISION
Wichita, Kansas

WATER SUPPLY INFORMATION
Disposition of Produced Water: Disposal
Docket # Repressuring

Questions on this portion of the ACO-1 call:
Water Resources Board (913) 296-3717
Source of Water:
Division of Water Resources Permit #
Groundwater...Ft North from Southeast Corner
(Well) ...Ft West from Southeast Corner of
Sec Twp Rge East West
 Surface Water 5000 Ft North from Southeast Corner
(Stream pond etc 800) ...Ft West from Southeast Corner
Sec 19 Twp 17S Rge 14 East West
Ruth Axman, Hoisington, Ks 67544
Other (explain)
(purchased from city, R.W.O. #)

INSTRUCTIONS: This form shall be completed in triplicate and filed with the Kansas Corporation Commission, 200 Colorado Derby Building, Wichita, Kansas 67202, within 120 days of the spud date of any well. Rule 82-3-130, 82-3-107 and 82-3-106 apply. Information on slide two of this form will be held confidential for a period of 12 months if requested in writing and submitted with the form. See rule 82-3-107 for confidentiality in excess of 12 months. One copy of all wireline logs and drillers time log shall be attached with this form. Submit CP-4 form with all plugged wells. Submit CP-111 form with all temporarily abandoned wells.

All requirements of the statutes, rules and regulations promulgated to regulate the oil and gas industry have been fully complied with and the statements herein are complete and correct to the best of my knowledge.

Signature
Title Vice President/Engineering Date 6/6/88
Subscribed and sworn to before me this 6th day of June 1988
Notary Public Jo Ann Watson
Date Commission Expires January 20, 1991

K.C.C. OFFICE USE ONLY
F Letter of Confidentiality Attached
C Wireline Log Received
C Drillers Time Log Received
Distribution
 KCC SWD/Rep NGPA
 KGS Plug Other
(Specify)
6-10-88
Form ACO-1 (5-86)

Jo Ann Watson, Notary Public,
State of Ohio, My Commission
Expires January 20, 1991.

Att-1-Dlg-9/11/13

ORIGINAL

SIDE TWO

Operator Name Ramco Drilling Services, Inc. & Lease Name Beatrice Axman Well # 2
Pendleton Land & Exploration, Inc.
Sec. 8 Twp. 17S Rge. 14W East West County Barton

WELL LOG

INSTRUCTIONS: Show important tops and base of formations penetrated. Detail all cores. Report all drill stem tests giving interval tested, time tool open and closed, flowing and shut-in pressures, whether shut-in pressure reached static level, hydrostatic pressures, bottom hole temperature, fluid recovery, and flow rates if gas to surface during test. Attach extra sheet if more space is needed. Attach copy of log.

Drill Stem Tests Taken [X] Yes [] No
Samples Sent to Geological Survey [X] Yes [] No
Cores Taken [] Yes [X] No

Formation Description
[] Log [] Sample

DST #1 - Lansing "B" zone, 3153'-3190' 30-60-60-90
IHP: 1734; FHP: 1686; BHT: 106°; IFP: 63-94; weak blow built to 4"; FFP: 94-141 fair blow (4") throughout; SIP's: 597-581. Recvy.: 240' oil & gas cut mud.

DST #2 - Lansing/KC "F" & "G" zones, 3240-3285
30-60-60-90; IHP: 1718; FHP: 1702; BHT: 112°; IFP: 126-157; weak blow built to 5"; FFP: 157-220 weak blow (2") throughout; SIP's: 675-675; Recvy.: 60' mud, 240' watery mud w/ 66,500 chlorides.

DST #3 - Arbuckle, 3405-3492 30-60-30-60
IHP: 1781; FHP: 1781; BHT: 118°; IFP: 722-1116 - immediate strong blow; SIP's: 1148-1148; Recvy.: 2500' water.

Table with 3 columns: Name, Top, Bottom. Rows include Heebner Shale, Brown Lime, Lansing/KC, and Arbuckle.

*Hole Depth Corrected By +33' at 3202' (3202' = 3235')

CASING RECORD, PERFORATION RECORD, TUBING RECORD, and production data tables.

Flush, Gilsonite

METHOD OF COMPLETION
Disposition of gas: [] Vented [] Sold [] Used on Lease
[] Open Hole [] Perforation [] Other (Specify)
[] Dually Completed [] Commingled

Handwritten notes at the bottom of the page.