

WELL PLUGGING RECORD

See All Information Completely
in Required Affidavit
File or Deliver Report to:
Conservation Division
State Corporation Commission
211 No. Broadway
Wichita, Kansas

NESS County, Sec. 26 Twp. 16 Rge. 26W (X) X (W)

Location as "NE/CNW/SW" or footage from lines C NE NW

Lease Owner PETROLEUM, INC.

Lease Name PETERS Well No. 1

Office Address ROUTE 2, GREAT BEND, KANSAS

Character of Well (completed as Oil, Gas or Dry Hole) DRY HOLE

Date well completed FEBRUARY 16, 1963

Application for plugging filed FEBRUARY 16, 1963

Application for plugging approved FEBRUARY 16, 1963

Plugging commenced FEBRUARY 16, 1963

Plugging completed FEBRUARY 16, 1963

Reason for abandonment of well or producing formation NO PRODUCIBLE ZONES

If a producing well is abandoned, date of last production NONE 19

Was permission obtained from the Conservation Division or its agents before plugging was commenced? YES

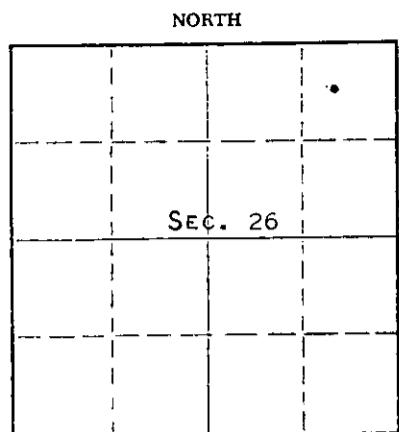

Locate well correctly on above Section Plat

Name of Conservation Agent who supervised plugging of this well ELDON PETTY

Producing formation --- Depth to top --- Bottom --- Total Depth of Well 4603 Feet

Show depth and thickness of all water, oil and gas formations.

OIL, GAS OR WATER RECORDS

CASING RECORD

FORMATION	CONTENT	FROM	TO	SIZE	PUT IN	PULLED OUT
				8-5/8"	258'	NONE

Describe in detail the manner in which the well was plugged, indicating where the mud fluid was placed and the method or methods used in introducing it into the hole. If cement or other plugs were used, state the character of same and depth placed, from --- feet to --- feet for each plug set.

MUDDED UP WITH HEAVY MUD TO 740' FOLLOWED BY WOODEN PLUG. PLACED 20 SACKS CEMENT THROUGH DRILL PIPE ONTO PLUG. MUDDED UP WITH HEAVY MUD TO 240' FOLLOWED BY WOODEN PLUG. PLACED 20 SACKS CEMENT THROUGH DRILL PIPE ONTO PLUG. MUDDED UP WITH HEAVY MUD TO 40', FOLLOWED BY WOODEN PLUG AND 10 SACKS CEMENT TO BASE OF WELL COLLAR.

RECEIVED
STATE CORPORATION COMMISSION

FEB 25 1963

2-25-63

CONSERVATION DIVISION
Wichita, Kansas

(If additional description is necessary, use BACK of this sheet)

Name of Plugging Contractor GARVEY DRILLING COMPANY

Address ROUTE 2, GREAT BEND, KANSAS

STATE OF KANSAS, COUNTY OF BARTON, ss.

DON SEARLE (employee of owner) or (owner) of the above-described

well, being first duly sworn on oath, says: That I have knowledge of the facts, statements, and matters herein contained and the log of the above-described well as filed and that the same are true and correct. So help me God. DON SEARLE, DIST. PROD. SUPT.

(Signature) Don Searle

ROUTE 2, GREAT BEND, KANSAS

(Address)

SUBSCRIBED AND SWORN TO before me this 20TH day of FEBRUARY, 1963

Archer J. Miles

Notary Public.

My commission expires APRIL 14, 1963



WELL LOG

15-135-00477-0000

COMPANY Petroleum Inc

SEC. 26 T. 16S R. 26W

FARM Peters #1

NO. 1

LOC. C-NE-NW

TOTAL DEPTH 4603'

COUNTY Ness

COMM. 1-30-63

COMP. 2-16-63

CONTRACTOR Garvey Drilling Company

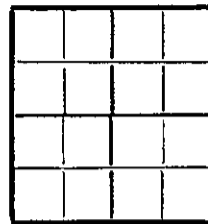

CASING 8 5/8" @ 258' w/200 sx

ELEVATION 2613' D.F.

PRODUCTION D & A

FIGURES INDICATE BOTTOM OF FORMATIONS

- 70' Surface Soil, Sand and Shale
- 550' Shale
- 590' Sandy Shale
- 890' Shale and Shells
- 2004' Shale
- 2040' Anhydrite
- 2600' Shale and Lime
- 2830' Lime and Shale
- 3080' Lime
- 3415' Lime and Shale
- 3565' Chalky Shale and Lime
- 3680' Shale and Stks, Lime and Chalk
- 3740' Lime and Shale
- 4375' Lime
- 4436' Lime and Shale
- 4490' Lime
- 4529' Lime and Shale
- 4559' Lime and Chalk
- 4603' Lime
- 4603' RTD

RECEIVED
STATE CORPORATION COMMISSION

FEB 25 1963

CONSERVATION DIVISION
Wichita, Kansas

State of Kansas }
County of Barton } ss

I, Verne A. Morris of Garvey Drilling Company

upon oath state the above and foregoing is a true and correct copy of the log of the Peters #1 well.

Verne A. Morris

Subscribed and sworn to before me this 19th day of February 19 63

My Commission Expires: April 14th, 1963

Arthur Wiles
NOTARY PUBLIC