

FOR KCC USE:

FORM C-1 7/91

EFFECTIVE DATE: 11-7-92

State of Kansas

FORM MUST BE TYPED

DISTRICT # 11

NOTICE OF INTENTION TO DRILL

FORM MUST BE SIGNED

SGAT... Yes... No

Must be approved by the K.C.C. five (5) days prior to commencing well

ALL BLANKS MUST BE FILLED

Expected Spud Date November 9 1992 month day year

Spot VC S/2 SE NE Sec 21 Twp 32 S, Rg 14 East West

OPERATOR: License # 30349 Name: Vess-Transpacific Operating Co., Inc. Address: P.O. Box 781350 City/State/Zip: Wichita, KS 67278 Contact Person: Bill Horigan Phone: 316-682-1537

2970' feet from South North line of Section 660' feet from East West line of Section IS SECTION X REGULAR IRREGULAR?

CONTRACTOR: License #: 6039 Name: L. D. Drilling, Inc.

(NOTE: Locate well on the Section Plat on Reverse Side) County: Barber

Well Drilled For: Well Class: Type Equipment: X Oil Enh Rec Infield Mud Rotary Gas Storage Pool Ext. Air Rotary OWD Disposal Wildcat Cable Seismic # of Holes Other

Lease Name: Judy Hoagland Well #: 3-21 Field Name: Stumph

If OWD: old well information as follows: Operator: Well Name: Comp. Date: Old Total Depth

Is this a Prorated/Spaced Field? yes X no Target Formation(s): Miss. and Marmaton Nearest lease or unit boundary: 660'

Directional, Deviated or Horizontal wellbore? yes X no If yes; true vertical depth: Bottom Hole Location:

Ground Surface Elevation: feet MSL Water well within one-quarter mile: yes X no Public water supply well within one mile: yes X no

Depth to bottom of fresh water: 100 Depth to bottom of usable water: 180 Surface Pipe by Alternate: X 1 2

Length of Surface Pipe Planned to be set: 280 Length of Conductor pipe required: No

Projected Total Depth: 4750' Formation at Total Depth: Miss. Water Source for Drilling Operations: well X farm pond other

DWR Permit #: Not Available Will Cores Be Taken? yes X no

If yes, proposed zone:

AFFIDAVIT

The undersigned hereby affirms that the drilling, completion and eventual plugging of this well will comply with K.S.A. 55-101, et. seq. It is agreed that the following minimum requirements will be met:

- 1. Notify the appropriate district office prior to spudding of well; 2. A copy of the approved notice of intent to drill shall be posted on each drilling rig; 3. The minimum amount of surface pipe as specified below shall be set by circulating cement to the top; in all cases surface pipe shall be set through all unconsolidated materials plus a minimum of 20 feet into the underlying formation; 4. If the well is dry hole, an agreement between the operator and the district office on plug length and placement is necessary prior to plugging; 5. The appropriate district office will be notified before well is either plugged or production casing is cemented in; 6. IF AN ALTERNATE II COMPLETION, PRODUCTION PIPE SHALL BE CEMENTED FROM BELOW ANY USABLE WATER TO SURFACE WITHIN 120 DAYS OF SPUD DATE. IN ALL CASES, NOTIFY DISTRICT OFFICE PRIOR TO ANY CEMENTING.

I hereby certify that the statements made herein are true and to the best of my knowledge and belief. Date: 10/30/92 Signature of Operator or Agent: Title: Operations Manager

FOR KCC USE: API # 15-007-22,408-0000 Conductor pipe required Nine feet Minimum surface pipe required 200' feet per Alt. Approved by: CB 11-2-92 This authorization expires: 5-2-93 (This authorization void if drilling not started within 6 months of effective date.) Spud date: Agent:

REMEMBER TO:

- File Drill Pit Application (form CDP-1) with Intent to Drill; - File Completion Form ACO-1 within 120 days of spud date; - File acreage attribution plat according to field proration orders; - Notify appropriate district office 48 hours prior to workover or re-entry; - Submit plugging report (CP-4) after plugging is completed; - Obtain written approval before disposing or injecting salt water.

Mail to: Conservation Division, 200 Colorado Derby Building, 202 W. First St., Wichita, Kansas 67202-1286.

RECEIVED STATE CORPORATION COMMISSION NOV 2 1992

21 32 14

IN ALL CASES PLOT THE INTENDED WELL ON THE PLAT BELOW

PLAT OF ACREAGE ATTRIBUTABLE TO A WELL IN A PRORATED OR SPACED FIELD

If the intended well is in a prorated or spaced field, please fully complete this side of the form. If the intended well is in a prorated or spaced field complete the plat below showing that the well will be properly located in relationship to other wells producing from the common source of supply. Please show all the wells within 1 mile of the boundaries of the proposed acreage attribution unit for gas wells and within 1/2 mile of the boundaries of the proposed acreage attribution unit for oil wells.

API NO. 15- _____
 OPERATOR _____
 LEASE _____
 WELL NUMBER _____
 FIELD _____

LOCATION OF WELL: COUNTY _____
 _____ feet from south/north line of section
 _____ feet from east/west line of section
 SECTION _____ TWP _____ RG _____

NUMBER OF ACRES ATTRIBUTABLE TO WELL _____
 QTR/QTR/QTR OF ACREAGE _____

IS SECTION _____ REGULAR or _____ IRREGULAR
IF SECTION IS IRREGULAR, LOCATE WELL FROM NEAREST CORNER BOUNDARY.

Section corner used: _____ NE _____ NW _____ SE _____ SW

PLAT

(Show location of the well and shade attributable acreage for prorated or spaced wells.)
 (Show footage to the nearest lease or unit boundary line.)

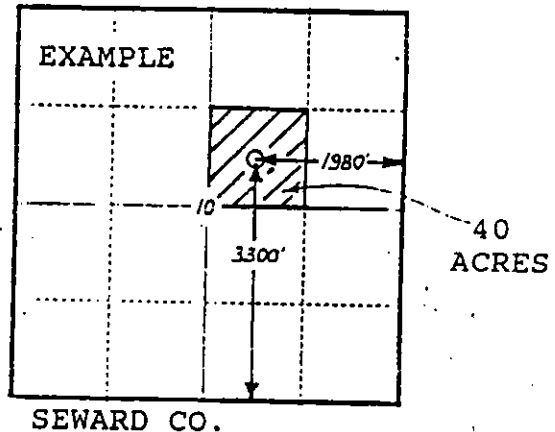
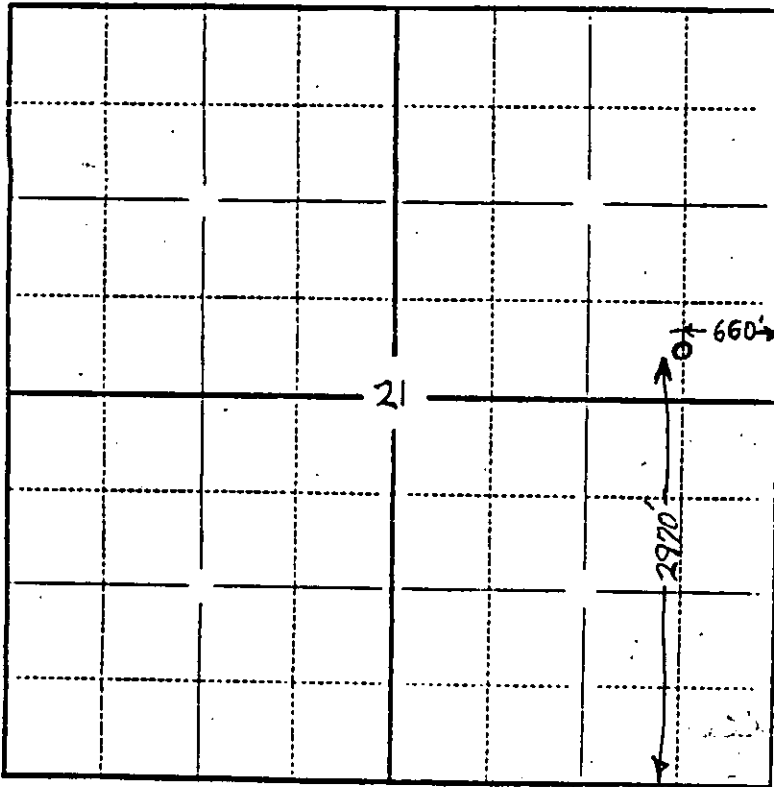

In plotting the proposed location of the well, you must show:

- 1) The manner in which you are using the depicted plat by identifying section lines, i.e. 1 section, 1 section with 8 surrounding sections, 4 sections, etc.;
- 2) the distance of the proposed drilling location from the section's south/north and east/west lines; and
- 3) the distance to the nearest lease or unit boundary line.