

FOR KCC USE:

FORM C-1 7/91
FORM MUST BE TYPED
FORM MUST BE SIGNED
ALL BLANKS MUST BE FILLED

EFFECTIVE DATE: 10-8-97

DISTRICT # 4
SGA Yes No X

State of Kansas
NOTICE OF INTENTION TO DRILL

Must be approved by the K.C.C. five (5) days prior to commencing well

Expected Spud Date: 10-6-97
Month day year

Spot
C E/2, -NE- SW, Sec. 11 Twp 33 S, Rg. 6 W East West

1980 feet from South North Line of Section

2970 feet from East West Line of Section

IS SECTION X REGULAR IRREGULAR?

(Note: Locate well on the Section Plat on Reverse Side)

County: HARPER

Lease Name: WOLFF B. Well #: 3

Field Name: STONEVILLE

Is this a Prorated / Spaced Field? yes no

Target Formation (s): Mississippi

Nearest Lease or unit boundary: 660-330

Ground Surface Elevation: est 1301 feet MSL

Water well within one - quarter mile: yes no

Public water supply well within one mile: yes no

Depth to bottom of fresh water: 140

Depth to bottom of usable water: 180

Surface Pipe by Alternate: X 1 2

Length of Surface Pipe Planned to be set: 240

Length of Conductor pipe required: 0

Projected Total Depth: 4550

Formation at Total Depth: MISSISSIPPI

Water Source for Drilling Operations: Well Farm Pond X other

DWR Permit #: _____

Will Cores Be Taken?: yes no

If yes, proposed zone: _____

OPERATOR: LICENSE # 8061
Name: OIL PRODUCERS, INC. OF KANSAS
Address: P.O. BOX 8647
City/State/Zip: WICHITA, KANSAS 67208
Contact Person: JOHN S. WEIR/DIANA RICHECKY
Phone: 316-681-0231

CONTRACTOR: License # 5929
Name: DUKE DRILLING CO., INC.

Well Drilled For: Well Class: Type Equipment:

X Oil Enh Rec X Infield X Mud Rotary
X Gas Storage Pool Extension Air Rotary
OWWO Disposal Wildcat Cable
Seismic: # of Holes Other

If OWWO: old well information as follows:

Operator: _____
Well Name: _____
Comp. Date: _____ Old Total Depth _____

Directional, Deviated or Horizontal wellbore? yes X no

If yes, true vertical depth: _____

Bottom Hole Location: _____

AFFIDAVIT

The undersigned hereby affirms that the drilling, completion and eventual plugging of this well will comply with K.S.A. 55-101, et. seq.
It is agreed that the following minimum requirements will be met.:

1. Notify the appropriate district office prior to spudding of well;
2. A copy of the approved notice of intent to drill shall be posted on each drilling rig;
3. The minimum amount of surface pipe as specified below shall be set by circulating cement to the top; in all cases surface pipe shall be set through all unconsolidated materials plus a minimum of 20 feet into the underlying formation;
4. If the well is dry hole, an agreement between the operator and the district office on plug length and placement is necessary prior to plugging;
5. The appropriate district office will be notified before well is either plugged or production casing is cemented in;
6. IF AN ALTERNATE II COMPLETION, PRODUCTION PIPE SHALL BE CEMENTED FROM BELOW ANY USABLE WATER TO SURFACE WITHIN 120 DAYS OF SPUD DATE. IN ALL CASES, NOTIFY DISTRICT OFFICE PRIOR TO ANY CEMENTING.

I hereby certify that the statements made herein are true and to the best of my knowledge and belief.

Date: 09/30/97 Signature of Operator or Agent: John S. Weir Title: PRESIDENT

FOR KCC USE:
 API # 15- 077-213400000
 Conductor pipe required NONE feet
 Minimum surface pipe required 200 feet per Alt. 1 X
 Approved by: JK 10-3-97
 This authorization expires: 4-3-98
 (This authorization void if drilling not started within 6 months of effective date.)
 Spud date: _____ Agent: _____

10-03-1997

RECEIVED
OCT 11 1997
KANSAS CONSERVATION DIVISION

REMEMBER TO:

- File Drill Pit Application (form CDP - 1) with Intent to Drill;
- File Completion Form ACO -1 within 120 days of spud date;
- File acreage attribution plat according to field prorator orders;
- Notify appropriate district office 48 hours prior to workover or re-entry;
- Submit plugging report (CP-4) after plugging is completed;
- Obtain written approval before disposing or injecting salt water.

Mail to: KCC - Conservation Division, 130 S. Market - Room 2078, Wichita, Kansas 67202.

33 6W

IN ALL CASES PLOT THE INTENDED WELL ON THE PLAT BELOW

PLAT OF ACREAGE ATTRIBUTABLE TO A WELL IN A PRORATED OR SPACED FIELD

If the intended well is in a prorated or spaced field, please fully complete this side of the form. If the intended well is in a prorated or spaced field complete the plat below showing that the well will be properly located in relationship to other wells producing from the common source of supply. Please show all the wells within 1 mile of the boundaries of the proposed acreage attribution unit for gas wells and within 1/2 mile of the boundaries of the proposed acreage attribution unit for oil wells.

API NO. 15- _____
 OPERATOR OIL PRODUCERS, INC. OF KANSAS
 LEASE WOLFF B
 WELL NUMBER 3
 FIELD _____

LOCATION OF WELL: COUNTY HARPER
 _____ feet from south/north line of section
2970 feet from east/west line of section
 SECTION 11 TWP 33 S RG 6 W

NUMBER OF ACRES ATTRIBUTABLE TO WELL 10
 QTR/QTR/QTR OF ACREAGE _____

IS SECTION X REGULAR or _____ IRREGULAR
IF SECTION IS IRREGULAR, LOCATE WELL FROM NEAREST CORNER BOUNDARY.

Section corner used: _____

PLAT

(Show location of the well and shade attributable acreage for prorated or spaced wells.)
 (Show footage to the nearest lease or unit boundary line.)

RECEIVED
 09-03-1988
 11:00 AM
 11:00 AM

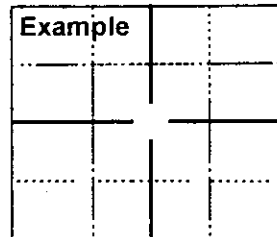
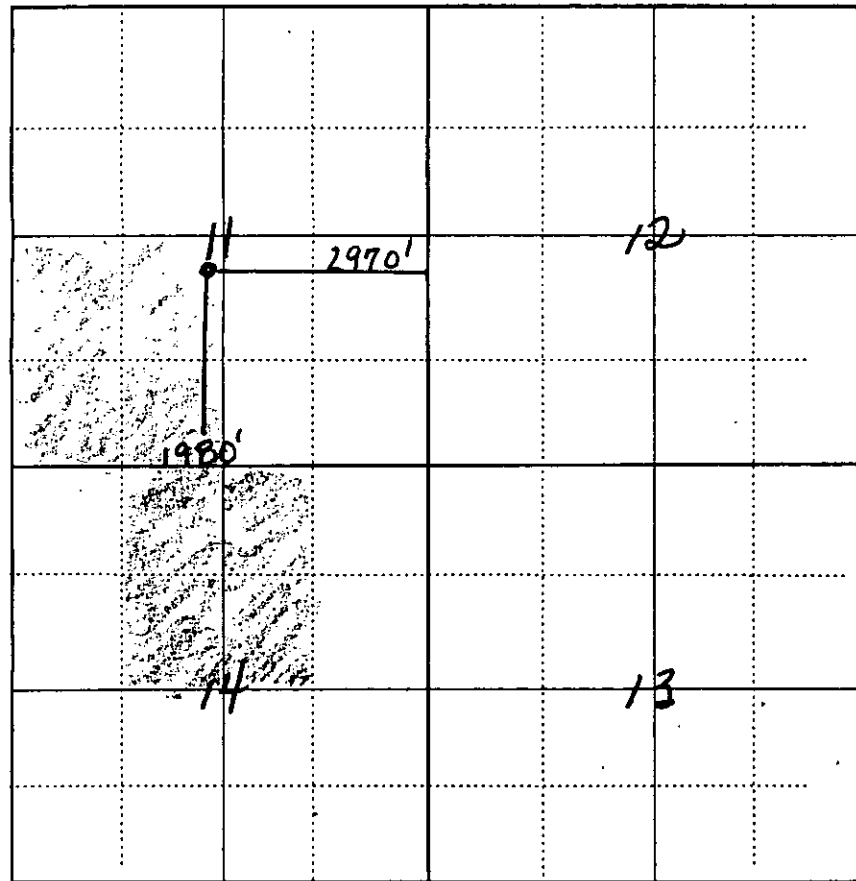

SEWARD CO.

SECTION 11 HARPER COUNTY, KANSAS

In plotting the proposed location of the well, you must show:

- 1) The manner in which you are using the depicted plat by identifying section lines, i.e. 1 section, 1 section with 8 surrounding sections, 4 sections, etc.;
- 2) the distance of the proposed drilling location from the section's south/north and east/west; and
- 3) the distance to the nearest lease or unit boundary line.