

FOR KCC USE:

FORM MUST BE TYPED
FORM MUST BE SIGNED
ALL BLANKS MUST BE FILLED

EFFECTIVE DATE:

State of Kansas

DISTRICT # 2

NOTICE OF INTENTION TO DRILL

SEA? Yes No

Must be approved by the K.C.C. five (5) days prior to commencing well

Expected Spud Date: December 5 92
month day year

East NE NW Sec 11 Twp 33S S, Rg 6W X West

OPERATOR: License # 4538
Name: Boswell Energy Corporation
Address: 501 West I-44, MidFirst Plaza, Suite 300
City/State/Zip: Oklahoma City, OK 73118
Contact Person: R.P. Brandenburg
Phone: 405-840-4073

660 feet from South / North line of Section
1980 feet from East / West line of Section
IS SECTION X REGULAR IRREGULAR

CONTRACTOR: License #
Name: Duke Drilling Company

(NOTE: Locate well on the Section Plat on Reverse Side)

Well Drilled For: Well Class: Type Equipment:
X Oil ... Enh Rec ... Infield X Mud Rotary
Gas ... Storage ... Pool Ext. ... Air Rotary
OUID ... Disposal X Wildcat ... Cable
Seismic; ... # of Holes ... Other
Other

County: Harper
Lease Name: Carothers
Field Name: Unnamed Well # 1

If OUID: old well information as follows:
Operator:
Well Name:
Comp. Date: Old Total Depth

Is this a Prorated/Spaced Field? yes X no
Target Formation(s): Arbuckle

Directional, Deviated or Horizontal wellbore? yes X no

Nearest Lease or unit boundary: 660'
Ground Surface Elevation: 1314' feet MSL

If yes, true vertical depth:
Bottom Hole Location:

Water well within one-quarter mile: yes X no
Public water supply well within one mile: yes X no

AFFIDAVIT

The undersigned hereby affirms that the drilling, completion and eventual plugging of this well will comply with K.S.A. 55-101, et. seq.

It is agreed that the following minimum requirements will be met:

- 1. Notify the appropriate district office prior to spudding of well;
- 2. A copy of the approved notice of intent to drill shall be posted on each drilling rig;
- 3. The minimum amount of surface pipe as specified below shall be set by circulating cement to the top; in all cases surface pipe shall be set through all unconsolidated materials plus a minimum of 20 feet into the underlying formation;
- 4. If the well is dry hole, an agreement between the operator and the district office on plug length and placement is necessary prior to plugging;
- 5. The appropriate district office will be notified before well is either plugged or production casing is cemented in;
- 6. IF AN ALTERNATE II COMPLETION, PRODUCTION PIPE SHALL BE CEMENTED FROM BELOW ANY USABLE WATER TO SURFACE WITHIN 120 DAYS OF SPUD DATE. IN ALL CASES, NOTIFY DISTRICT OFFICE PRIOR TO ANY CEMENTING.

I hereby certify that the statements made herein are true and to the best of my knowledge and belief.
Date: Nov. 25 1992 Signature of Operator or Agent: Jouse C Stacy Title: VICE PRESIDENT

FOR KCC USE:
API # 15- 077-21,265-00-00
Conductor pipe required None feet
Minimum surface pipe required 200 feet per Alt. O & R
Approved by: CR 11-30-92
This authorization expires: 5-30-93
(This authorization void if drilling not started within 6 months of effective date.)
Spud date: Agent:

11-30-1992 =

RECEIVED
CONSERVATION COMMISSION
NOV 30 1992
CONSERVATION DIVISION

REMEMBER TO:

- File Drill Pit Application (form CDP-1) with Intent to Drill;
- File Completion Form ACO-1 within 120 days of spud date;
- File acreage attribution plat according to field prorotation orders;
- Notify appropriate district office 48 hours prior to workover or re-entry;
- Submit plugging report (CP-4) after plugging is completed;
- Obtain written approval before disposing or injecting salt water.

Mail to: Conservation Division, 200 Colorado Derby Building, 202 W. First St., Wichita, Kansas 67202-1286.

IN ALL CASES PLOT THE INTENDED WELL ON THE PLAT BELOW

PLAT OF ACREAGE ATTRIBUTABLE TO A WELL IN A PRORATED OR SPACED FIELD

If the intended well is in a prorated or spaced field, please fully complete this side of the form. If the intended well is in a prorated or spaced field complete the plat below showing that the well will be properly located in relationship to other wells producing from the common source of supply. Please show all the wells within 1 mile of the boundaries of the proposed acreage attribution unit for gas wells and within 1/2 mile of the boundaries of the proposed acreage attribution unit for oil wells.

API NO. 15- _____
 OPERATOR Boswell Energy Corporation
 LEASE Carothers
 WELL NUMBER #1
 FIELD Unknown (Wildcat)

LOCATION OF WELL: COUNTY Harper
 _____ 660 feet from _____/north line of section
 _____ 1,980 feet from _____/west line of section
 SECTION 11 TWP 33S RG 6W

NUMBER OF ACRES ATTRIBUTABLE TO WELL 40
 QTR/QTR/QTR OF ACREAGE C - NE/4 - NW/4

IS SECTION X REGULAR or IRREGULAR
 IF SECTION IS IRREGULAR, LOCATE IT IN TERMS OF NEAREST
 CORNER APPROXIMATELY

Section corner used: NE NW SE SW

(Show location of the well and shaded attributable acreage for prorated or spaced wells.)
 (Show footage to the nearest lease or unit boundary line.)

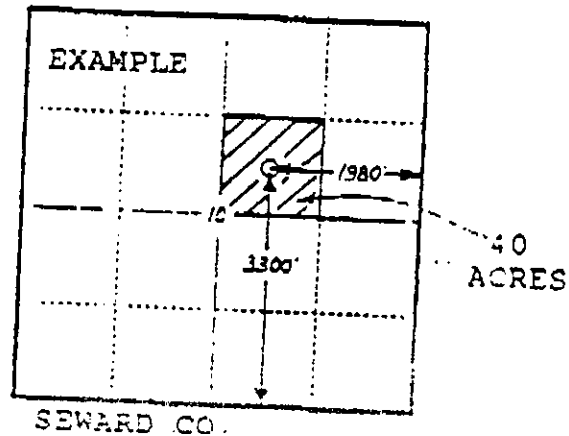
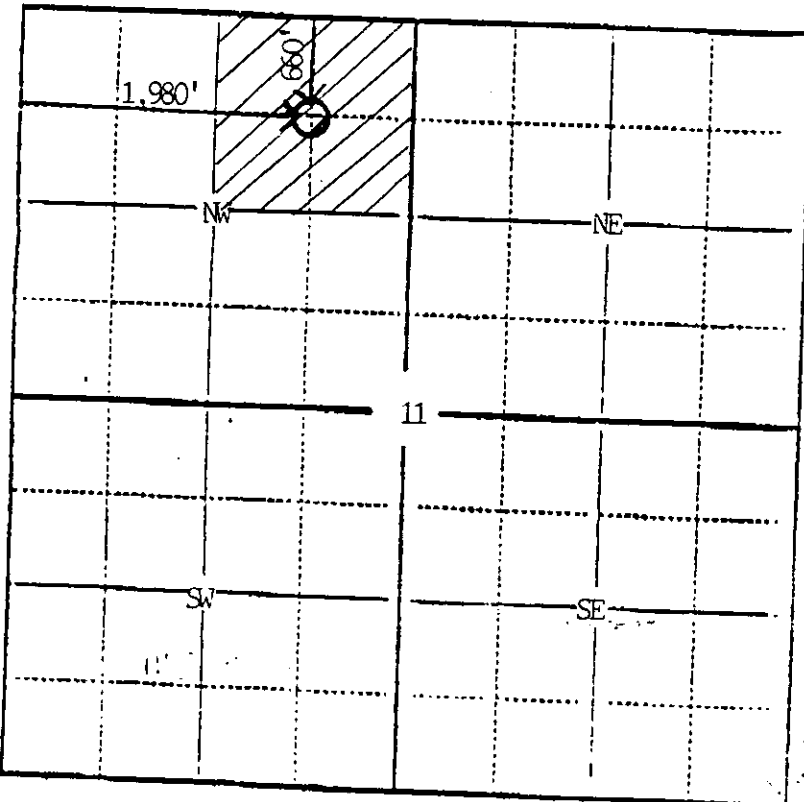

In plotting the proposed location of the well, you must show:

-) The manner in which you are using the depicted plat by identifying section lines, 1 section, 1 section with 8 surrounding sections, 4 sections, etc.;
-) the distance of the proposed drilling location from the section's south/north and east/west lines; and
-) the distance to the nearest lease or unit boundary line.

NOV 30 1992
 DIVISION
 SHERIFF, HARPER