

15-007-01604-0000

STATE OF KANSAS
STATE CORPORATION COMMISSION

WELL PLUGGING RECORD

Give All Information Completely
Make Required Affidavit
Mail or Deliver Report to:
Conservation Division
State Corporation Commission
211 No. Broadway
Wichita, Kansas

Barber

County. Sec. 28 Twp. 32 Rge. 14 (E) W(W)

Location as "NE/CNW&SW&" or footage from lines NE SE NE

Lease Owner Petroleum, Inc.

Lease Name Jacobs "F" Well No. 2

Office Address Route 2, Great Bend, Kansas

Character of Well (completed as Oil, Gas or Dry Hole) Dry hole

Date well completed July 29 19 58

Application for plugging filed July 29 19 58

Application for plugging approved July 29 19 58

Plugging commenced July 29 19 58

Plugging completed July 29 19 58

Reason for abandonment of well or producing formation No producible zones

If a producing well is abandoned, date of last production None 19

Was permission obtained from the Conservation Division or its agents before plugging was commenced? Yes

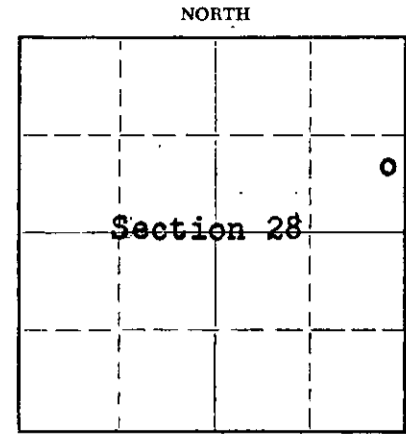

Locate well correctly on above Section Plat

Name of Conservation Agent who supervised plugging of this well W.L. Lackamp

Producing formation ----- Depth to top ----- Bottom ----- Total Depth of Well 4801 Feet

Show depth and thickness of all water, oil and gas formations.

OIL, GAS OR WATER RECORDS

CASING RECORD

FORMATION	CONTENT	FROM	TO	SIZE	PUT IN	PULLED OUT
				8 5/8"	1045'	None

Describe in detail the manner in which the well was plugged, indicating where the mud fluid was placed and the method or methods used in introducing it into the hole. If cement or other plugs were used, state the character of same and depth placed, from _____ feet to _____ feet for each plug set.

Mud up with heavy mud to 1000' followed by a wooden plug. Placed 10 sacks cement through drill pipe on to plug. Mud up to 240' followed by a wooden plug and 1/3 sack hulls. Placed 20 sacks cement through drill pipe on to plug. Mud up to 35' followed by a wooden plug and 1/3 sack hulls. Filled hole to base of well cellar with 10 sacks cement.

(If additional description is necessary, use BACK of this sheet)

Name of Plugging Contractor Garvey Drilling Co.

Address Route 2, Great Bend, Kansas

STATE OF Kansas COUNTY OF Barton ss.

Don Searle (employee of owner) or (owner) of the above-described well, being first duly sworn on oath, says: That I have knowledge of the facts, statements, and matters herein contained and the log of the above-described well as filed and that the same are true and correct. So help me God.

(Signature) Don Searle
Route 2, Great Bend, Kansas
(Address)

SUBSCRIBED AND SWORN TO before me this 7th day of August 1958

My commission expires July 11, 1960

[Signature]
Notary Public.

AUG 8 1958

8-8-58
CONSERVATION DIVISION
Wichita, Kansas

PLUGGING
FILE SEC 28 T 32 R 14W
BOOK PAGE 119 LINE 10

15-007-01604-0000
WELL LOG

COMPANY PETROLEUM, INCORPORATED

SEC. 28 T. 32S R. 14W

FARM JACOBS "F" NO. 2

LOC. NE, SE, NE

TOTAL DEPTH 4801'

COUNTY BARBER CO., KANSAS

COMM. July 11, 1958 COMP. July 29, 1958

CONTRACTOR GARVEY DRILLING COMPANY

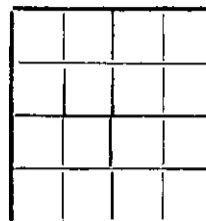

CASING 8 5/8" @ 1045' W/525msax

ELEVATION 1938' DF

PRODUCTION D & A

FIGURES INDICATE BOTTOM OF FORMATIONS

80	Sand & gravel
875	Red bed
950	Gyp & red bed
1045	Red bed & shale
1550	Shale & shells
2110	Shale & lime
2245	Lime
2570	Lime & shale
2675	Lime
3425	Shale & lime
3590	Lime & shale
3720	Lime
3899	Lime, shale & sand
4054	Lime & shale
4119	Shale
4252	Sand & lime
4317	Lime
4407	Lime & shale
4743	Lime
4786	Lime & chat
4801	Chat
4801	T. D.

PLUGGING
FILE SEC. 28 T. 32 R. 14W
BOOK PAGE 119 LINE 10

State of KANSAS }
County of BARTON } ss:

I, VERNE A. MORRIS of GARVEY DRILLING CO.

upon oath state that the above and foregoing is a true and correct copy of the log of the #2 JACOBS "F" well

Subscribed and sworn to before me this 6th day of August 19 58

RECEIVED
STATE CORPORATION COMMISSION
8-8-58
AUG 8 1958

My Commission Expires: July 11, 1960

[Signature]
NOTARY PUBLIC, Kansas