

EFFECTIVE DATE: 8-31-91

State of Kansas

DISTRICT # 1
SGA? Yes No

NOTICE OF INTENTION TO DRILL

Must be approved by the K.C.C. five (5) days prior to commencing well

Expected Spud Date ... 8 ... 30 ... 91 ...
month day year

Spot .SE. SE. SE. Sec 21. Twp 32. S, Rg 15. X East West

OPERATOR: License # 5123
Name: Pickrell Drilling Company, Inc.
Address: 110 N. Market, Suite 205
City/State/Zip: Wichita, Kansas 67202
Contact Person: Don Beauchamp
Phone: 316-262-8427

.330 feet from South / ~~XXXX~~ line of Section
.330 feet from East / ~~XXXX~~ line of Section

IS SECTION X REGULAR IRREGULAR?
(NOTE: Locate well on the Section Plat on Reverse Side)

CONTRACTOR: License #: 5123
Name: Pickrell Drilling Co., Inc.

County: Barber
Lease Name: Marsh Trust Well #: #1 "A"

Field Name: Deerhead
Is this a Prorated/Spaced Field? yes X no

Well Drilled For: Well Class: Type Equipment:
X Oil ... Enh Rec ... Infield X Mud Rotary
X Gas ... Storage X Pool Ext. ... Air Rotary
... OUVVO ... Disposal ... Wildcat ... Cable
... Seismic; ... # of Holes ... Other

Target Formation(s): Elgin Sand
Nearest lease or unit boundary: 330'

Ground Surface Elevation: 1870 feet MSL
Water well within one-quarter mile: yes X no

Public water supply well within one mile: yes X no
Depth to bottom of fresh water: 130

Depth to bottom of usable water: 130
Surface Pipe by Alternate: X 1 2

Length of Surface Pipe Planned to be set: 250'
Length of Conductor pipe required: None

Projected Total Depth: 4000'
Formation at Total Depth: Oread

If OUVVO: old well information as follows:
Operator:
Well Name:
Comp. Date: Old Total Depth

Water Source for Drilling Operations:
... well ... farm pond X ... other

Directional, Deviated or Horizontal wellbore? yes X no
If yes, true vertical depth:
Bottom Hole Location:

DWR Permit #:
Will Cores Be Taken?: yes X no
If yes, proposed zone:

AFFIDAVIT

The undersigned hereby affirms that the drilling, completion and eventual plugging of this well will comply with K.S.A. 55-101, et. seq.

It is agreed that the following minimum requirements will be met:

- 1. Notify the appropriate district office prior to spudding of well;
- 2. A copy of the approved notice of intent to drill shall be posted on each drilling rig;
- 3. The minimum amount of surface pipe as specified below shall be set by circulating cement to the top; in all cases surface pipe shall be set through all unconsolidated materials plus a minimum of 20 feet into the underlying formation;
- 4. If the well is dry hole, an agreement between the operator and the district office on plug length and placement is necessary prior to plugging;
- 5. The appropriate district office will be notified before well is either plugged or production casing is cemented in;
- 6. IF AN ALTERNATE II COMPLETION, PRODUCTION PIPE SHALL BE CEMENTED FROM BELOW ANY USABLE WATER TO SURFACE WITHIN 120 DAYS OF SPUD DATE. IN ALL CASES, NOTIFY DISTRICT OFFICE PRIOR TO ANY CEMENTING.

I hereby certify that the statements made herein are true and to the best of my knowledge and belief.

Date: August 16, 1991 Signature of Operator or Agent: Don Beauchamp Title: Geologist

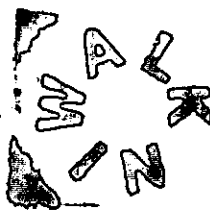

FOR KCC USE:
API # 15- 007-22377-0000
Conductor pipe required None feet
Minimum surface pipe required 200 feet per Alt. X
Approved by: DA 8-26-91
This authorization expires: 2-26-91
(This authorization void if drilling not started within 6 months of effective date.)
Spud date: Agent:

RECEIVED
STATE CORPORATION COMMISSION
CONSERVATION DIVISION
Wichita, Kansas
AUG 20 1991

21
32
15W

REMEMBER TO:

- File Drill Pit Application (form CDP-1) with Intent to Drill;
- File Completion Form ACO-1 within 120 days of spud date;
- File acreage attribution plat according to field proration orders;
- Notify appropriate district office 48 hours prior to workover or re-entry;
- Submit plugging report (CP-4) after plugging is completed;
- Obtain written approval before disposing or injecting salt water.

Mail to: Conservation Division, 200 Colorado Derby Building, 202 W. First St., Wichita, Kansas 67202-1286.

IN ALL CASES PLOT THE INTENDED WELL ON THE PLAT BELOW

PLAT OF ACREAGE ATTRIBUTABLE TO A WELL IN A PRORATED OR SPACED FIELD

If the intended well is in a prorated or spaced field, please fully complete this side of the form. If the intended well is in a prorated or spaced field complete the plat below showing that the well will be properly located in relationship to other wells producing from the common source of supply. Please show all the wells within 1 mile of the boundaries of the proposed acreage attribution unit for gas wells and within 1/2 mile of the boundaries of the proposed acreage attribution unit for oil wells.

API NO. 15- _____
 OPERATOR _____
 LEASE _____
 WELL NUMBER _____
 FIELD _____

LOCATION OF WELL: COUNTY _____
 _____ feet from south/north line of section
 _____ feet from east/west line of section
 SECTION _____ TWP _____ RG _____

NUMBER OF ACRES ATTRIBUTABLE TO WELL _____
 QTR/QTR/QTR OF ACREAGE _____

IS SECTION _____ REGULAR or _____ IRREGULAR
IF SECTION IS IRREGULAR, LOCATE WELL FROM NEAREST CORNER BOUNDARY.

Section corner used: _____ NE _____ NW _____ SE _____ SW

PLAT

(Show location of the well and shade attributable acreage for prorated or spaced wells.)
 (Show footage to the nearest lease or unit boundary line.)

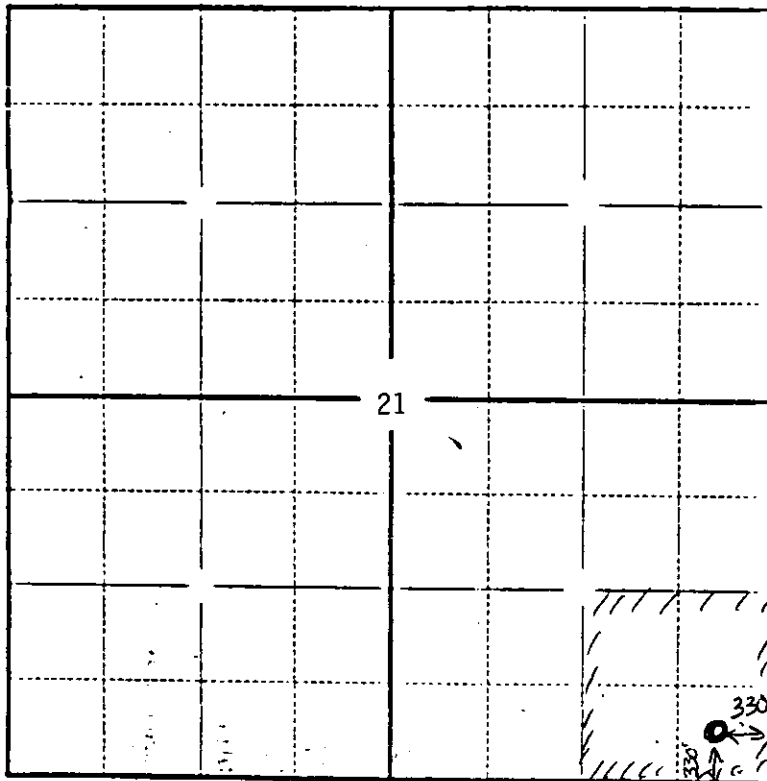

1 SECTION

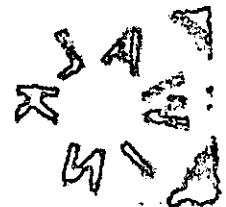
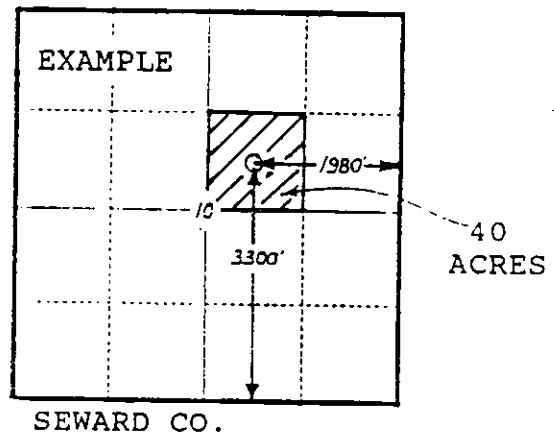

In plotting the proposed location of the well, you must show:

- 1) The manner in which you are using the depicted plat by identifying section lines, i.e. 1 section, 1 section with 8 surrounding sections, 4 sections, etc.;
- 2) the distance of the proposed drilling location from the section's south/north and east/west lines; and
- 3) the distance to the nearest lease or unit boundary line.