

FOR KCC USE:

FORM C-1 7/91

EFFECTIVE DATE: 11-30-92

State of Kansas

FORM MUST BE TYPED

DISTRICT # 1

NOTICE OF INTENTION TO DRILL

FORM MUST BE SIGNED

SGAT: X Yes No

Must be approved by the K.C.C. five (5) days prior to commencing well

ALL BLANKS MUST BE FILLED

Expected Spud Date 12 10 92
month day yearSpot
NE NW SE Sec 10 Twp 32 S. Rg 15 XX East
WestOPERATOR: License # 5290
Name: HINKLE OIL COMPANY
Address: 1016 UNION CENTER BUILDING
City/State/Zip: WICHITA, KANSAS 67202
Contact Person: ORVIE HOWELL
Phone: (316) 267-0231✓ 2310 feet from South XXXX line of Section
✓ 1650 feet from East / XXXX line of Section
IS SECTION X REGULAR IRREGULAR?

(NOTE: Locate well on the Section Plat on Reverse Side)

County: BARBER
Lease Name: ALEXANDER Well #: 1-10
Field Name: DONALD EXTENSION 1/2 MILE SOUTH
Is this a Prorated/Spaced Field? yes X no
Target Formation(s): ARBUCKLE
Nearest lease or unit boundary: 330
Ground Surface Elevation: 2041 feet MSL
Water well within one-quarter mile: X yes no
Public water supply well within one mile: yes X no
Depth to bottom of fresh water: 125
Depth to bottom of usable water: 125 180
Surface Pipe by Alternate: X 1 2
Length of Surface Pipe Planned to be set: 385
Length of Conductor pipe required: NONE
Projected Total Depth: 5600
Formation at Total Depth: ARBUCKLE
Water Source for Drilling Operations:
 well X farm pond otherCONTRACTOR: License # 5929
Name: DUKE DRILLING COMPANYWell Drilled For: Well Class: Type Equipment:
X. Oil Enh Rec Infield Mud Rotary
X. Gas Storage Pool Ext. Air Rotary
 OWD Disposal Wildcat Cable
 Seismic; # of Holes Other
 Other

If OWD: old well information as follows:

Operator:
Well Name:
Comp. Date: Old Total Depth Directional, Deviated or Horizontal wellbore? yes X noIf yes, true vertical depth: Bottom Hole Location: DWR Permit #:
Will Cores Be Taken? yes X no
If yes, proposed zone:

AFFIDAVIT

The undersigned hereby affirms that the drilling, completion and eventual plugging of this well will comply with K.S.A. 55-101, et. seq.

It is agreed that the following minimum requirements will be met:

1. Notify the appropriate district office prior to spudding of well;
2. A copy of the approved notice of intent to drill shall be posted on each drilling rig;
3. The minimum amount of surface pipe as specified below shall be set by circulating cement to the top; in all cases surface pipe shall be set through all unconsolidated materials plus a minimum of 20 feet into the underlying formation;
4. If the well is dry hole, an agreement between the operator and the district office on plug length and placement is necessary prior to plugging;
5. The appropriate district office will be notified before well is either plugged or production casing is cemented in;
6. IF AN ALTERNATE II COMPLETION, PRODUCTION PIPE SHALL BE CEMENTED FROM BELOW ANY USABLE WATER TO SURFACE WITHIN 120 DAYS OF SPUD DATE. IN ALL CASES, NOTIFY DISTRICT OFFICE PRIOR TO ANY CEMENTING.

I hereby certify that the statements made herein are true and to the best of my knowledge and belief.

Date: 11/17/92 Signature of Operator or Agent: Orvie Howell Title: GEN. MANAGER/GEOLOGIST

FOR KCC USE:

API # 15- 007-22,410-0000Conductor pipe required None feetMinimum surface pipe required 200 feet per Alt. ① XApproved by: C.B. 11-24-92This authorization expires: 5-24-93

(This authorization void if drilling not started within 6 months of effective date.)

Spud date: Agent:

REMEMBER TO:

- File Drill Pit Application (form CDP-1) with Intent to Drill;
- File Completion Form ACD-1 within 120 days of spud date;
- File acreage attribution plat according to field proration orders;
- Notify appropriate district office 48 hours prior to workover or re-entry;
- Submit plugging report (CP-4) after plugging is completed;
- Obtain written approval before disposing or injecting salt water.

Mail to: Conservation Division, 200 Colorado Derby Building, 202 W. First St., Wichita, Kansas 67202-1286.

NOV 18 1992
11-18-92
DIVISION

10

32

15

IN ALL CASES PLOT THE INTENDED WELL ON THE PLAT BELOW

PLAT OF ACREAGE ATTRIBUTABLE TO A WELL IN A PRORATED OR SPACED FIELD

~~If the intended well is in a prorated or spaced field, please fully complete this side of the form. If the intended well is in a prorated or spaced field complete the plat below showing that the well will be properly located in relationship to other wells producing from the common source of supply. Please show all the wells within 1 mile of the boundaries of the proposed acreage attribution unit for gas wells and within 1/2 mile of the boundaries of the proposed acreage attribution unit for oil wells.~~

API NO. 15- _____

OPERATOR _____

LEASE _____

WELL NUMBER _____

FIELD _____

LOCATION OF WELL: COUNTY _____

_____ feet from south/north line of section

_____ feet from east/west line of section

SECTION _____ TWP _____ RG _____

NUMBER OF ACRES ATTRIBUTABLE TO WELL _____

QTR/QTR/QTR OF ACREAGE _____

IS SECTION _____ REGULAR OR _____ IRREGULAR

IF SECTION IS IRREGULAR, LOCATE WELL FROM NEAREST CORNER BOUNDARY.

Section corner used: _____ NE _____ NW _____ SE _____ SW

PLAT

(Show location of the well and shade attributable acreage for prorated or spaced wells.)

(Show footage to the nearest lease or unit boundary line.)

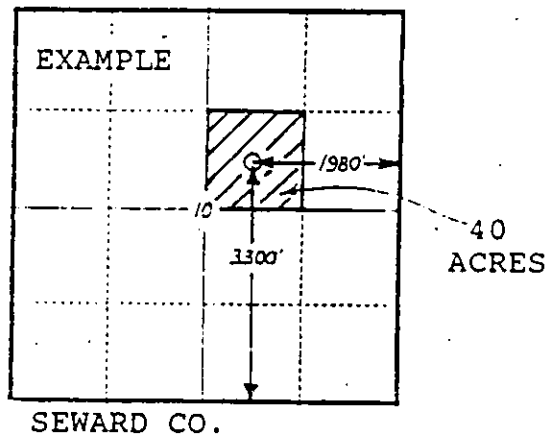
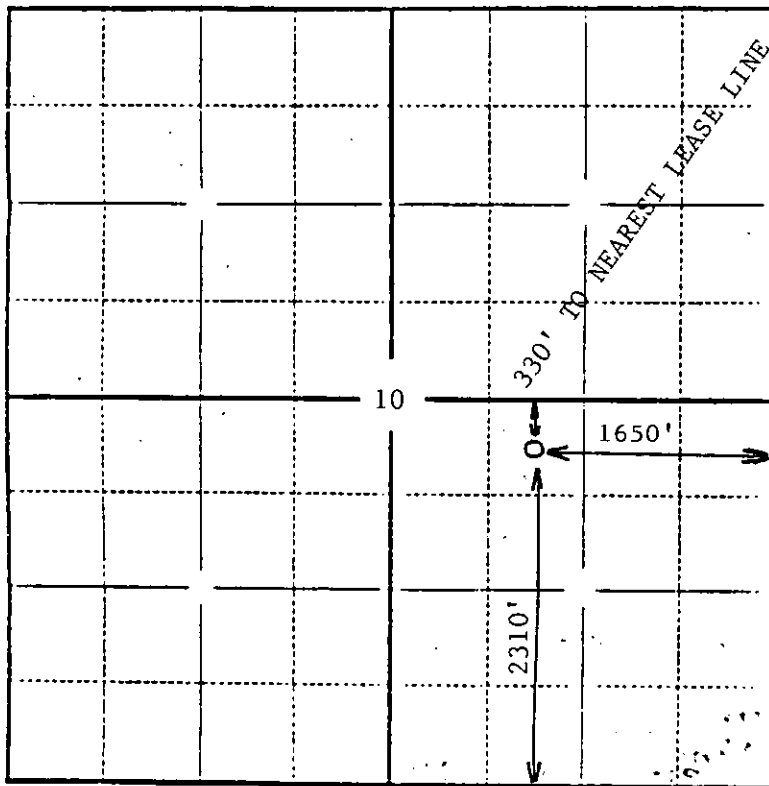

In plotting the proposed location of the well, you must show:

- 1) The manner in which you are using the depicted plat by identifying section lines, i.e. 1 section, 1 section with 8 surrounding sections, 4 sections, etc.;
- 2) the distance of the proposed drilling location from the section's south/north and east/west lines; and
- 3) the distance to the nearest lease or unit boundary line.