

EFFECTIVE DATE: 8-18-97

State of Kansas

FORM MUST BE TYPED

DISTRICT # 1

NOTICE OF INTENTION TO DRILL

FORM MUST BE SIGNED

SCA7...Yes......No

Must be approved by the K.C.C. five (5) days prior to commencing well.

ALL BLANKS MUST BE FILLED

Expected Spud Date 8 month 20 day 97 year

Spot NW - SW - NW Sec 35 Twp 18 S, Rg 21 East West

OPERATOR: License # 4058
Name: American Warrior, Inc.
Address: P.O. Box 399
City/State/Zip: Garden City, Ks 67846
Contact Person: Scott Corsair
Phone: 913 398-2270

1650 feet from South line of Section
330 feet from East line of Section
IS SECTION REGULAR IRREGULAR?

(NOTE: Locate well on the Section Plat on Reverse Side)

CONTRACTOR: License #: 31548
Name: Discovery Drilling

County: Ness
Lease Name: Witthuhn Well #: 1-35
Field Name: Ryervee

Well Drilled For: Well Class: Type Equipment:
 Oil Enh Rec Infield Mud Rotary
 Gas Storage Pool Ext. Air Rotary
 OAWO Disposal Wildcat Cable
 Seismic; # of Holes Other

Is this a Prorated/Spaced Field? yes no
Target Formation(s): Cherokee/Mississippian

Nearest lease or unit boundary: 330'
Ground Surface Elevation: 2190 est. feet MSL

Water well within one-quarter mile: yes no
Public water supply well within one mile: yes no

Depth to bottom of fresh water: 280' 180'
Depth to bottom of usable water: 450' 640' PERMIAN

Surface Pipe by Alternate: 1 2

Length of Surface Pipe Planned to be set: 500' 600' MIN

Length of Conductor pipe required: NA ALT 1

Projected Total Depth: 4200

Formation at Total Depth: Mississippian

Water Source for Drilling Operations:
... well farm pond other

If OAWO: old well information as follows:

Operator:
Well Name:
Comp. Date: Old Total Depth

Directional, Deviated or Horizontal wellbore? yes no
If yes, true vertical depth:
Bottom Hole Location:

Will Cores Be Taken?: yes no
If yes, proposed zone:

AFFIDAVIT

The undersigned hereby affirms that the drilling, completion and eventual plugging of this well will comply with K.S.A. 55-101, et. seq.

It is agreed that the following minimum requirements will be met:

1. Notify the appropriate district office prior to spudding of well;
2. A copy of the approved notice of intent to drill shall be posted on each drilling rig;
3. The minimum amount of surface pipe as specified below shall be set by circulating cement to the top; in all cases surface pipe shall be set through all unconsolidated materials plus a minimum of 20 feet into the underlying formation;
4. If the well is dry hole, an agreement between the operator and the district office on plug length and placement is necessary prior to plugging;
5. The appropriate district office will be notified before well is either plugged or production casing is cemented in;
6. IF AN ALTERNATE II COMPLETION, PRODUCTION PIPE SHALL BE CEMENTED FROM BELOW ANY USABLE WATER TO SURFACE WITHIN 120 DAYS OF SPUD DATE. IN ALL CASES, NOTIFY DISTRICT OFFICE PRIOR TO ANY CEMENTING.

I hereby certify that the statements made herein are true and to the best of my knowledge and belief.

Date: 8-11-97 Signature of Operator or Agent: Scott Corsair Title: Agent

FOR KCC USE:
 API # 15- 135-240250000
 Conductor pipe required NONE feet 200' ALT 2
 Minimum surface pipe required 660' feet per Alt. (1)(2)
 Approved by: JK 8-13-97
 This authorization expires: 2-13-98
 (This authorization void if drilling not started within 6 months of effective date.)
 Spud date: _____ Agent: _____

REMEMBER TO:

- File Drill Pit Application (form CDP-1) with Intent to Drill;
- File Completion Form ACO-1 within 120 days of spud date;
- File acreage attribution plat according to field proration orders;
- Notify appropriate district office 48 hours prior to workover or re-entry;
- Submit plugging report (CP-4) after plugging is completed;
- Obtain written approval before disposing or injecting salt water.

Mail to: KCC - Conservation Division, 130 S. Market - Room 207B, Wichita, Kansas 67202.

CORRECTION 8-29-97 JK

RECEIVED
1997 AUG 13 P 11:55
KANSAS CONSERVATION DIVISION

35 18 210

IN ALL CASES PLOT THE INTENDED WELL ON THE PLAT BELOW

PLAT OF ACREAGE ATTRIBUTABLE TO A WELL IN A PRORATED OR SPACED FIELD

If the intended well is in a prorated or spaced field, please fully complete this side of the form. If the intended well is in a prorated or spaced field complete the plat below showing that the well will be properly located in relationship to other wells producing from the common source of supply. Please show all the wells within 1 mile of the boundaries of the proposed acreage attribution unit for gas wells and within 1/2 mile of the boundaries of the proposed acreage attribution unit for oil wells.

API NO. 15- _____
 OPERATOR American Warrior, Inc.
 LEASE Witthuhn
 WELL NUMBER 1-35
 FIELD Ryersee

LOCATION OF WELL: COUNTY Ness
1650 feet from ~~south~~/north line of section
330 feet from ~~east~~/west line of section
 SECTION 35 TWP 18S RG 21W

NUMBER OF ACRES ATTRIBUTABLE TO WELL 10
 QTR/QTR/QTR OF ACREAGE _____

IS SECTION X REGULAR or _____ IRREGULAR
 IF SECTION IS IRREGULAR, LOCATE WELL FROM NEAREST
CORNER BOUNDARY.

Section corner used: NE NW SE SW

PLAT

(Show location of the well and shade attributable acreage for prorated or spaced wells.)
 (Show footage to the nearest lease or unit boundary line.)

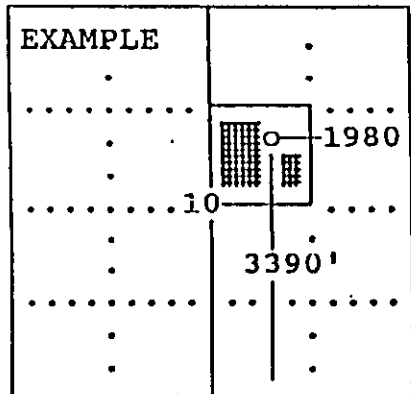
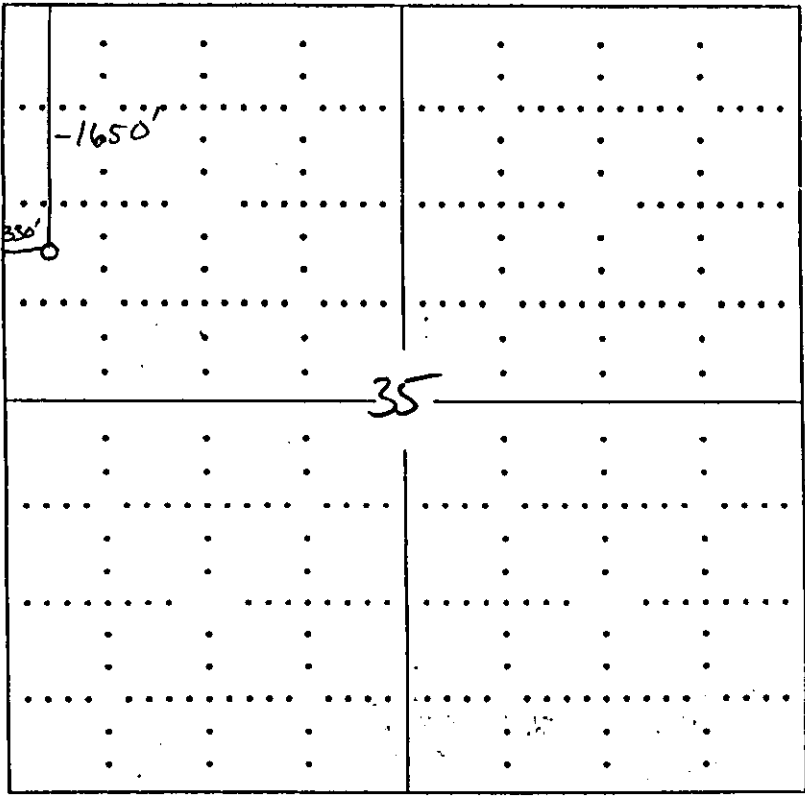

SEWARD CO.

In plotting the proposed location of the well, you must show:

- 1) The manner in which you are using the depicted plat by identifying section lines, i.e. 1 section, 1 section with 8 surrounding sections, 4 sections, etc.;
- 2) the distance of the proposed drilling location from the section's south/north and east/west; and
- 3) the distance to the nearest lease or unit boundary line.