

FOR KCC USE:

X CORRECTION

FORM C-1 7/91

FORM MUST BE TYPED

EFFECTIVE DATE: 11-13-93

State of Kansas

FORM MUST BE SIGNED

DISTRICT # 2

NOTICE OF INTENTION TO DRILL

ALL BLANKS MUST BE FILLED

SGA? Yes, A No

Must be approved by the K.C.C. five (5) days prior to commencing well

Expected Spud Date 11/15/93 Approx 125' No of W/2 W/2 NE Sec 23 Twp 33S Rg 6 East

OPERATOR: License # 8061 Name: Oil Producers, Inc. of Kansas Address: P.O. Box 8647 City/State/Zip: Wichita, Ks 67208 Contact Person: John S. Weir Phone: 316.681-0231

4110 4085 feet from South / North line of Section 2310 feet from East / West line of Section IS SECTION X REGULAR IRREGULAR?

CONTRACTOR: License #: 5822 Name: Val Energy, Inc.

(NOTE: Locate well on the Section Plat on Reverse Side) County: Harper Lease Name: Wolff Well #: 1 Field Name:

Well Drilled For: Well Class: Type Equipment:

X Oil ... Enh Rec ... X Infield ... X Mud Rotary X Gas ... Storage ... Pool Ext. ... Air Rotary ... OWD ... Disposal ... Wildcat ... Cable ... Seismic; ... # of Holes ... Other

Is this a Prorated/Spaced Field? yes X no Target Formation(s): Mississippi Nearest lease or unit boundary: 330' 355'

If OWD: old well information as follows: Operator: Well Name: Comp. Date: Old Total Depth

Ground Surface Elevation: 1294 feet MSL Water well within one-quarter mile: yes X no Public water supply well within one mile: yes X no

Directional, Deviated or Horizontal wellbore? yes X no

Depth to bottom of fresh water: 140 Depth to bottom of usable water: 200 Surface Pipe by Alternate: X 1 2 Length of Surface Pipe Planned to be set: 220

If yes, true vertical depth: Bottom Hole Location:

Length of Conductor pipe required: na Projected Total Depth: 4450' Formation at Total Depth: Mississippi

Water Source for Drilling Operations: well X farm pond other DWR Permit #: Will Cores Be Taken? yes no

If yes, proposed zone:

X WAS 4085' F.S.L. & 330' N.L.B. OIL

AFFIDAVIT IS 4110' F.S.L. & 355' N.L.B. GAS

The undersigned hereby affirms that the drilling, completion and eventual plugging of this well will comply with K.S.A. 55-101, et. seq. 125' N. OF W/2 W/2 NE 150' N. OF W/2 W/2 RECEIVED STATE CORPORATION COMMISSION

- 1. Notify the appropriate district office prior to spudding of well; 2. A copy of the approved notice of intent to drill shall be posted on each drilling rig; 3. The minimum amount of surface pipe as specified below shall be set by circulating cement to the top; in all cases surface pipe shall be set through all unconsolidated materials plus a minimum of 20 feet into the underlying formation; 4. If the well is dry hole, an agreement between the operator and the district office on production and placement is necessary prior to plugging; 5. The appropriate district office will be notified before well is either plugged or production casing is cemented in; 6. IF AN ALTERNATE II COMPLETION, PRODUCTION PIPE SHALL BE CEMENTED FROM BELOW ANY USABLE WATER TO SURFACE WITHIN 120 DAYS OF SPUD DATE. IN ALL CASES, NOTIFY DISTRICT OFFICE PRIOR TO ANY CEMENTING.

I hereby certify that the statements made herein are true and to the best of my knowledge and belief. Date: 11/5/93 Signature of Operator or Agent: John S. Weir Title: President

FOR KCC USE: API # 15- 077-21273-00-00 Conductor pipe required None feet Minimum surface pipe required 220' feet per Alt. OX Approved by: CB 11-8-93 This authorization expires: 5-8-94 (This authorization void if drilling not started within 6 months of effective date.) Spud date: Agent:

REMEMBER TO:

- File Drill Pit Application (form CDP-1) with Intent to Drill; - File Completion Form ACO-1 within 120 days of spud date; - File acreage attribution plat according to field proration orders; - Notify appropriate district office 48 hours prior to workover or re-entry; - Submit plugging report (CP-4) after plugging is completed; - Obtain written approval before disposing or injecting salt water.

Mail to: Conservation Division, 200 Colorado Derby Building, 202 W. First St., Wichita, Kansas 67202-1286.

Handwritten numbers 23, 33, 6

IN ALL CASES PLOT THE INTENDED WELL ON THE PLAT BELOW

PLAT OF ACREAGE ATTRIBUTABLE TO A WELL IN A PRORATED OR SPACED FIELD

If the intended well is in a prorated or spaced field, please fully complete this side of the form. If the intended well is in a prorated or spaced field complete the plat below showing that the well will be properly located in relationship to other wells producing from the common source of supply. Please show all the wells within 1 mile of the boundaries of the proposed acreage attribution unit for gas wells and within 1/2 mile of the boundaries of the proposed acreage attribution unit for oil wells.

API NO. 15- _____
 OPERATOR Oil Producers, Inc. of Kansas
 LEASE Wolff
 WELL NUMBER 1
 FIELD _____

LOCATION OF WELL: COUNTY Harper
 _____ feet from south/north line of section
2310 feet from east/west line of section
 SECTION 23 TWP 33S RG 6W

NUMBER OF ACRES ATTRIBUTABLE TO WELL _____
 QTR/QTR/QTR OF ACREAGE _____

IS SECTION x REGULAR or _____ IRREGULAR
IF SECTION IS IRREGULAR, LOCATE WELL FROM NEAREST CORNER BOUNDARY.

Section corner used: _____ NE _____ NW _____ SE _____ SW
PLAT

(Show location of the well and shade attributable acreage for prorated or spaced wells.)
 (Show footage to the nearest lease or unit boundary line.)

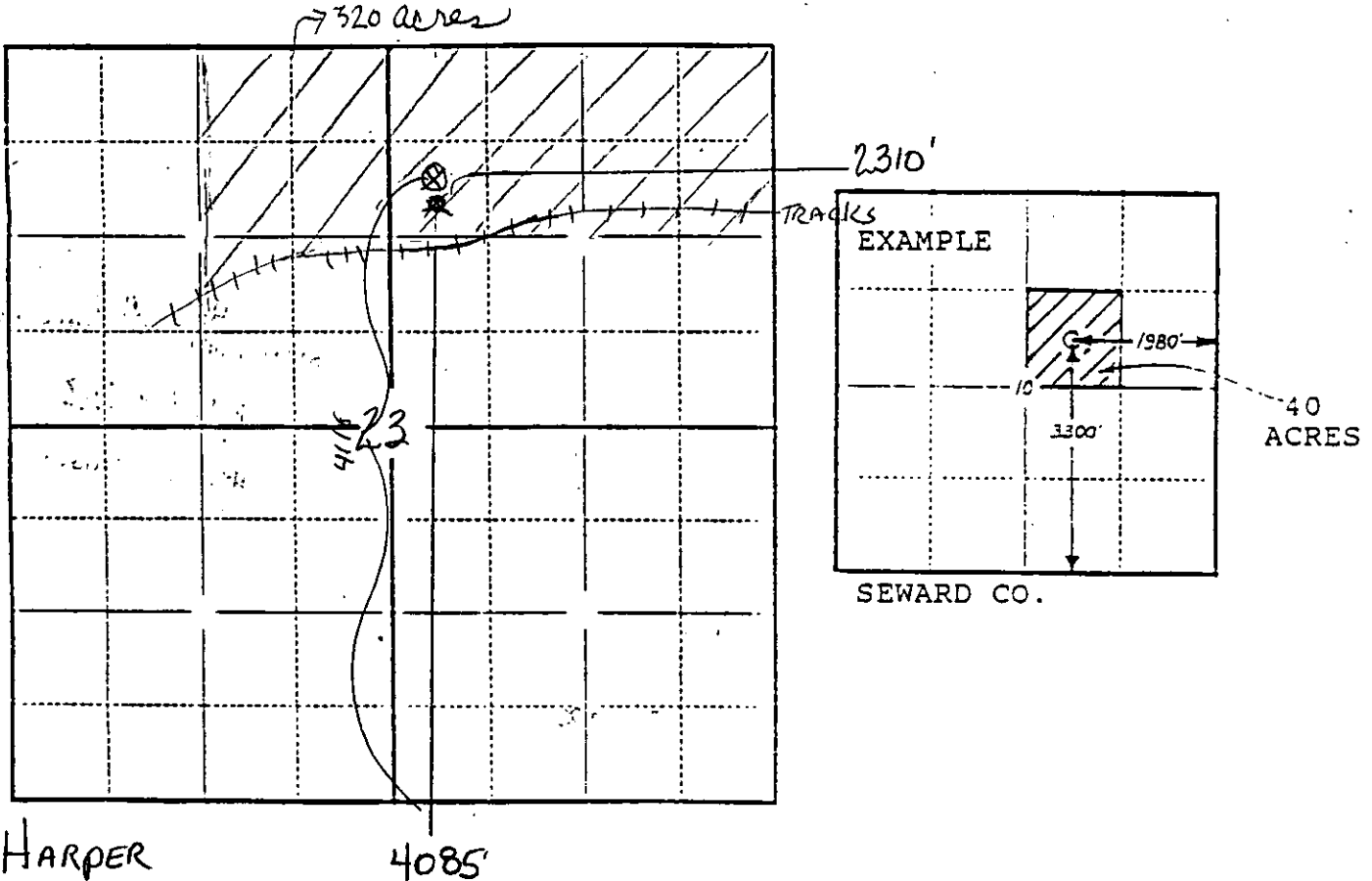

In plotting the proposed location of the well, you must show:

- 1) The manner in which you are using the depicted plat by identifying section lines, i.e. 1 section, 1 section with 8 surrounding sections, 4 sections, etc.;
- 2) the distance of the proposed drilling location from the section's south/north and east/west lines; and
- 3) the distance to the nearest lease or unit boundary line.