

FOR KCC USE:

FORM C-1 7/91

EFFECTIVE DATE: 8-13-94

State of Kansas

FORM MUST BE TYPED

DISTRICT # 2

NOTICE OF INTENTION TO DRILL

FORM MUST BE SIGNED

SEA? Yes 1 No

Must be approved by the K.C.C. five (5) days prior to commencing well

ALL BLANKS MUST BE FILLED

Expected Spud Date 8/11/94  
month day year

Spot SE NE SE Sec 15 Twp 33 S Rg 6W East West

OPERATOR: License # 8061  
Name: Oil Producers, Inc. of Kansas  
Address: P.O. Box 8647  
City/State/Zip: Wichita, Ks. 67208  
Contact Person: John S. Weir  
Phone: 316.681-0231

1650 feet from South / North line of Section  
330 feet from East / West line of Section  
IS SECTION X REGULAR IRREGULAR?

CONTRACTOR: License #: 5929  
Name: Duke Drilling Co.

(NOTE: Locate well on the Section Plat on Reverse Side)

County: Harper  
Lease Name: Truby Well #: 1  
Field Name: \_\_\_\_\_

Well Drilled For: Well Class: Type Equipment:  
X Oil ... Enh Rec X Infield X Mud Rotary  
X Gas ... Storage ... Pool Ext. ... Air Rotary  
... OWO ... Disposal ... Wildcat ... Cable  
... Seismic: ... # of Holes ... Other  
... Other \_\_\_\_\_

Is this a Prorated/Spaced Field? ... yes X no  
Target Formation(s): Mississinni

Nearest lease or unit boundary: 330  
Ground Surface Elevation: est. 1297 feet MSL

Water well within one-quarter mile: ... yes X no  
Public water supply well within one mile: ... yes X no

Depth to bottom of fresh water: 140  
Depth to bottom of usable water: 180

Surface Pipe by Alternate: X 1 2  
Length of Surface Pipe Planned to be set: (225') 220

Length of Conductor pipe required: NA  
Projected Total Depth: 4450

Formation at Total Depth: Miss  
Water Source for Drilling Operations:  
... well ... farm pond X other

If OWO: old well information as follows:  
Operator: \_\_\_\_\_  
Well Name: \_\_\_\_\_  
Comp. Date: \_\_\_\_\_ Old Total Depth \_\_\_\_\_

DWR Permit #: \_\_\_\_\_  
Will Cores Be Taken?: ... yes X no  
If yes, proposed zone: \_\_\_\_\_

Directional, Deviated or Horizontal wellbore? ... yes X no  
If yes, true vertical depth: \_\_\_\_\_  
Bottom Hole Location: \_\_\_\_\_

AFFIDAVIT

The undersigned hereby affirms that the drilling, completion and eventual plugging of this well will comply with K.S.A. 55-101, et. seq.  
It is agreed that the following minimum requirements will be met:

1. Notify the appropriate district office prior to spudding of well;
2. A copy of the approved notice of intent to drill shall be posted on each drilling rig;
3. The minimum amount of surface pipe as specified below shall be set by circulating cement to the top; in all cases surface pipe shall be set through all unconsolidated materials plus a minimum of 20 feet into the underlying formation;
4. If the well is dry hole, an agreement between the operator and the district office on plug length and placement is necessary prior to plugging;
5. The appropriate district office will be notified before well is either plugged or production casing is cemented in;
6. IF AN ALTERNATE II COMPLETION, PRODUCTION PIPE SHALL BE CEMENTED FROM BELOW ANY USABLE WATER TO SURFACE WITHIN 120 DAYS OF SPUD DATE. IN ALL CASES, NOTIFY DISTRICT OFFICE PRIOR TO ANY CEMENTING.

I hereby certify that the statements made herein are true and to the best of my knowledge and belief.  
Date: 8/4/94 Signature of Operator or Agent: John S. Weir Title: President

FOR KCC USE:  
API # 15- 077-21285-00-00  
Conductor pipe required NONE feet  
Minimum surface pipe required 220' feet per Alt. 1  
Approved by: CB 8-8-94  
This authorization expires: 2-8-95  
(This authorization void if drilling not started within 6 months of effective date.)  
Spud date: \_\_\_\_\_ Agent: \_\_\_\_\_

RECEIVED  
KANSAS CORPORATION COMMISSION  
AUG 05 1994  
CONSERVATION DIVISION  
WICHITA, KS

REMEMBER TO:

- File Drill Pit Application (form CDP-1) with Intent to Drill;
- File Completion Form ACC-1 within 120 days of spud date;
- File acreage attribution plat according to field proration orders;
- Notify appropriate district office 48 hours prior to workover or re-entry;
- Submit plugging report (CP-4) after plugging is completed;
- Obtain written approval before disposing or injecting salt water.

Mail to: Conservation Division, 200 Colorado Derby Building, 202 W. First St., Wichita, Kansas 67202-1286.

IN ALL CASES PLOT THE INTENDED WELL ON THE PLAT BELOW

**PLAT OF ACREAGE ATTRIBUTABLE TO A WELL IN A PRORATED OR SPACED FIELD**

If the intended well is in a prorated or spaced field, please fully complete this side of the form. If the intended well is in a prorated or spaced field complete the plat below showing that the well will be properly located in relationship to other wells producing from the common source of supply. Please show all the wells within 1 mile of the boundaries of the proposed acreage attribution unit for gas wells and within 1/2 mile of the boundaries of the proposed acreage attribution unit for oil wells.

API NO. 15- \_\_\_\_\_  
 OPERATOR Oil Producers, Inc. of Kansas LOCATION OF WELL: COUNTY Harper  
 LEASE Truby 1650 feet from south/north line of section  
 WELL NUMBER #1 330 feet from east/west line of section  
 FIELD \_\_\_\_\_ SECTION 15 TWP 33 RG 6W

NUMBER OF ACRES ATTRIBUTABLE TO WELL \_\_\_\_\_ IS SECTION \_\_\_\_\_ REGULAR or \_\_\_\_\_ IRREGULAR  
 QTR/QTR/QTR OF ACREAGE \_\_\_\_\_ IF SECTION IS IRREGULAR, LOCATE WELL FROM NEAREST  
 CORNER BOUNDARY.

Section corner used: \_\_\_\_\_ NE \_\_\_\_\_ NW \_\_\_\_\_ SE \_\_\_\_\_ SW

**PLAT**

(Show location of the well and shade attributable acreage for prorated or spaced wells.)  
 (Show footage to the nearest lease or unit boundary line.)

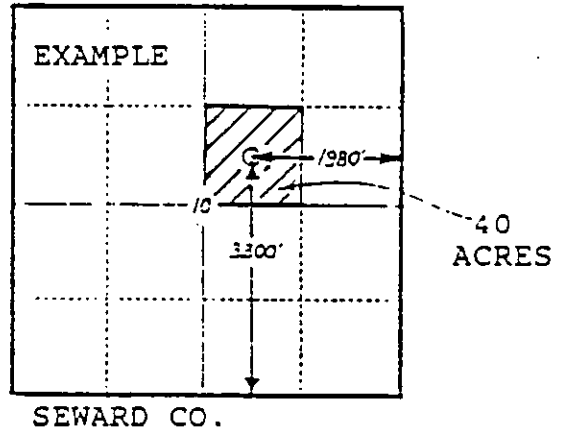
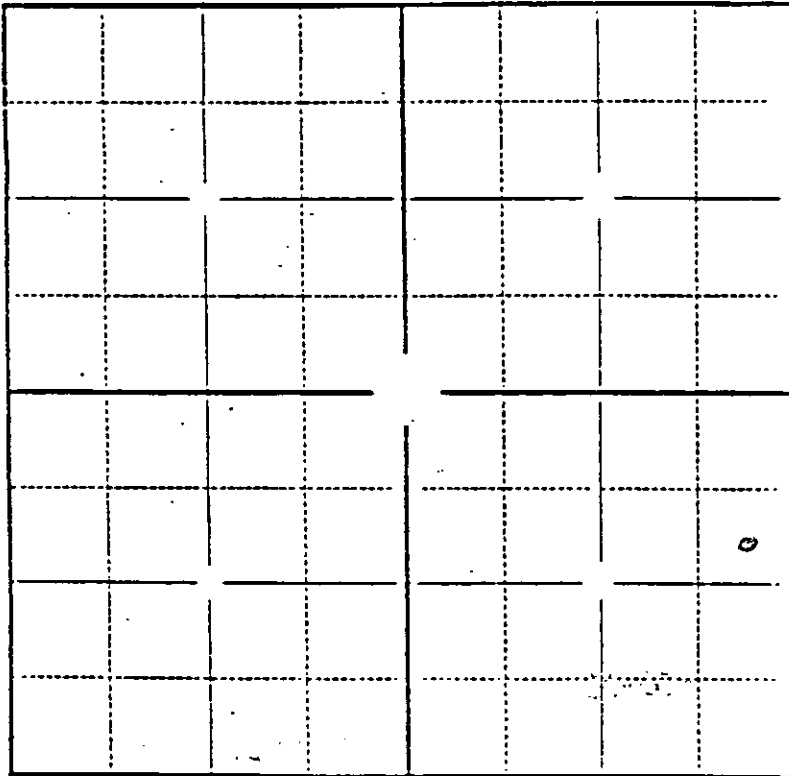

In plotting the proposed location of the well, you must show:

- 1) The manner in which you are using the depicted plat by identifying section lines, i.e. 1 section, 1 section with 8 surrounding sections, 4 sections, etc.;
- 2) the distance of the proposed drilling location from the section's south/north and east/west lines; and
- 3) the distance to the nearest lease or unit boundary line.