

FOR KCC USE:

FORM C-1 7/91

FORM MUST BE TYPED

FORM MUST BE SIGNED

ALL BLANKS MUST BE FILLED

EFFECTIVE DATE: 8-11-91

State of Kansas

DISTRICT #

NOTICE OF INTENTION TO DRILL

SEA? X Yes... No

Must be approved by the K.C.C. five (5) days prior to commencing well

Expected Spud Date JULY 31ST 1991

Spot C SE NE Sec 8 Twp 32 S, Rg 15 East West

OPERATOR: License # 4233
Name: PRECISION PETROLEUM CORP.
Address: P.O. BOX 253
City/State/Zip: WICHITA, KS 67201
Contact Person: GAIL MELTON
Phone: (316) 263-1100

3300 feet from South / North line of Section
660 feet from East / West line of Section
IS SECTION X REGULAR IRREGULAR?

CONTRACTOR: License #: 5929
Name: DUKE DRILLING CO., INC.

(NOTE: Locate well on the Section Plat on Reverse Side)
County: BARBER
Lease Name: MARSH Well #: 1-8

Well Drilled For: Well Class: Type Equipment:
Oil Enh Rec Infield Mud Rotary
Gas Storage Pool Ext Air Rotary
X OWO Disposal Wildcat Cable
Seismic: # of Holes Other

Field Name: NONE
Is this a Prorated/Spaced Field? yes X no
Target Formation(s): LANSING

If OWO: old well information as follows:
Operator: HARRY SPBING
Well Name: MARSH #1-8
Comp. Date: 8/10/84 Old Total Depth 5397

Nearest lease or unit boundary: 660
Ground Surface Elevation: 1977 feet MSL
Water well within one-quarter mile: yes X no

Directional, Deviated or Horizontal wellbore? yes X no
If yes, true vertical depth:
Bottom Hole Location:

Public water supply well within one mile: yes X no
Depth to bottom of fresh water: 100
Depth to bottom of usable water: 180
Surface Pipe by Alternate: X 1 3

Length of Surface Pipe Planned to be set: 486
Length of Conductor pipe required: NONE
Projected Total Depth: 4450 ft
Formation at Total Depth: LANSING

Water Source for Drilling Operations:
... well X farm pond ... other
DWR Permit #:
Will Cores Be Taken? yes X no

AFFIDAVIT

The undersigned hereby affirms that the drilling, completion and eventual plugging of this well will comply with K.S.A. 55-101, et. seq.

It is agreed that the following minimum requirements will be met:

- 1. Notify the appropriate district office prior to spudding of well;
2. A copy of the approved notice of intent to drill shall be posted on each drilling rig;
3. The minimum amount of surface pipe as specified below shall be set by circulating cement to the top; in all cases surface pipe shall be set through all unconsolidated materials plus a minimum of 20 feet into the underlying formation;
4. If the well is dry hole, an agreement between the operator and the district office on plug length and placement is necessary prior to plugging;
5. The appropriate district office will be notified before well is either plugged or production casing is cemented in;
6. IF AN ALTERNATE II COMPLETION, PRODUCTION PIPE SHALL BE CEMENTED FROM BELOW ANY USABLE WATER TO SURFACE WITHIN 120 DAYS OF SPUD DATE. IN ALL CASES, NOTIFY DISTRICT OFFICE PRIOR TO ANY CEMENTING.

I hereby certify that the statements made herein are true and to the best of my knowledge and belief.

Date: 7/30/91 Signature of Operator or Agent: Gail D. Melton Title: PRESIDENT

FOR KCC USE:
API # 15- 007-24 882-A-00-01
Conductor pipe required None feet
Minimum surface pipe required 200 feet per Alt.
Approved by: MLD 8-6-91
This authorization expires: 8-26-92
(This authorization void if drilling not started within 6 months of effective date.)
Spud date: Agent:

Conservation Division
Wichita, Kansas
JUL 30 1991
8 32 15W

REMEMBER TO:

- File Drill Pit Application (form CDP-1) with Intent to Drill;
- File Completion Form ACO-1 within 120 days of spud date;
- File acreage attribution plat according to field proration orders;
- Notify appropriate district office 48 hours prior to workover or re-entry;
- Submit plugging report (CP-4) after plugging is completed;
- Obtain written approval before disposing or injecting salt water.

Mail to: Conservation Division, 200 Colorado Derby Building, 202 W. First St., Wichita, Kansas 67202-1286.

**IN ALL CASES PLOT THE INTENDED WELL ON THE PLAT BELOW**

**PLAT OF ACREAGE ATTRIBUTABLE TO A WELL IN A PRORATED OR SPACED FIELD**

If the intended well is in a prorated or spaced field, please fully complete this side of the form. If the intended well is in a prorated or spaced field complete the plat below showing that the well will be properly located in relationship to other wells producing from the common source of supply. Please show all the wells within 1 mile of the boundaries of the proposed acreage attribution unit for gas wells and within 1/2 mile of the boundaries of the proposed acreage attribution unit for oil wells.

API NO. 15- \_\_\_\_\_  
 OPERATOR \_\_\_\_\_  
 LEASE \_\_\_\_\_  
 WELL NUMBER \_\_\_\_\_  
 FIELD \_\_\_\_\_

LOCATION OF WELL: COUNTY BARBER  
3300 feet from south/north line of section  
660 feet from east/west line of section  
 SECTION 8 TWP 32S RG 15W

NUMBER OF ACRES ATTRIBUTABLE TO WELL \_\_\_\_\_  
 QTR/QTR/QTR OF ACREAGE \_\_\_\_\_

IS SECTION X REGULAR or \_\_\_\_\_ IRREGULAR  
**IF SECTION IS IRREGULAR, LOCATE WELL FROM NEAREST CORNER BOUNDARY.**

Section corner used: \_\_\_\_\_ NE \_\_\_\_\_ NW \_\_\_\_\_ SE \_\_\_\_\_ SW

**PLAT**

(Show location of the well and shade attributable acreage for prorated or spaced wells.)  
 (Show footage to the nearest lease or unit boundary line.)

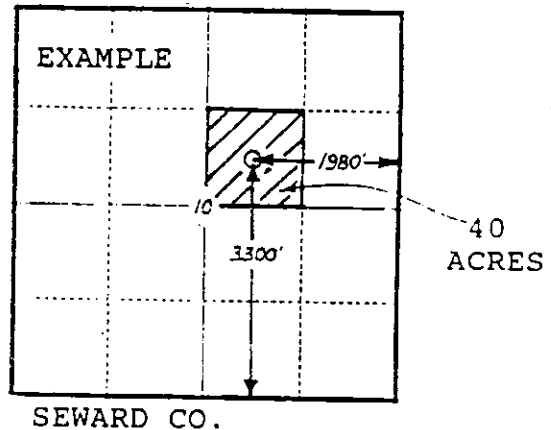
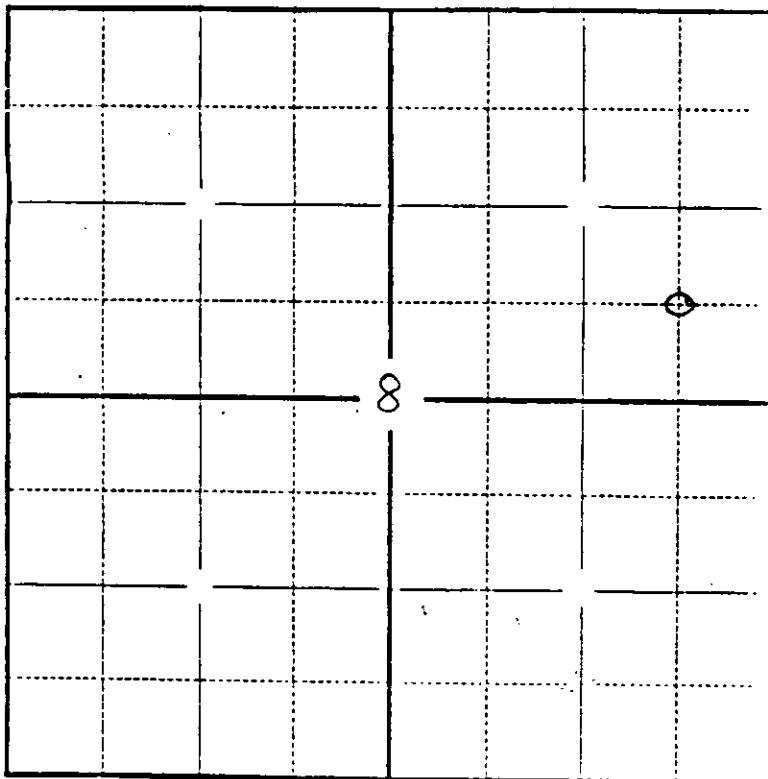

**In plotting the proposed location of the well, you must show:**

- 1) The manner in which you are using the depicted plat by identifying section lines, i.e. 1 section, 1 section with 8 surrounding sections, 4 sections, etc.;
- 2) the distance of the proposed drilling location from the section's south/north and east/west lines; and
- 3) the distance to the nearest lease or unit boundary line.