

CORRECTION

FORM C-1 7/91

EFFECTIVE DATE: 8-20-97

State of Kansas * changed to alt. 2

FORM MUST BE TYPED
FORM MUST BE SIGNED
ALL BLANKS MUST BE FILLED

DISTRICT # 1

NOTICE OF INTENTION TO DRILL

Must be approved by the K.C.C. five (5) days prior to commencing well.

Expected Spud Date: 8 month 27 day 97 year

Spot approx 100 ft of NE of SE 33 Sec 33 Twp 18 S, Rg 21 East X West

OPERATOR: License # 4058
Name: American Warrior, Inc.
Address: P.O. Box 399
Garden City, Ks 67846
Contact Person: Scott Corsair
Phone: 913 398-2270

1450 feet from South ~~North~~ line of Section
1250 feet from East ~~West~~ line of Section
IS SECTION X REGULAR IRREGULAR

CONTRACTOR: License # 31548
Name: Discovery Drilling

(NOTE: Locate well on the Section Plat on Reverse Side)
County: Neosho
Lease Name: RYANSEA Well #: 2-33
Field Name:

Well Drilled For: Well Class: Type Equipment:
X Oil ... X Infield ... X Mud Rotary
... Gas ... Storage ... Pool Ext. ... Air Rotary
... OAWO ... Disposal ... Wildcat ... Cable
... Seismic; ... # of Holes ... Other

Is this a Prorated/Spaced Field? ... yes X no
Target formation(s): Cherokee/Mississippian
Nearest lease or unit boundary: 1250'
Ground Surface Elevation: 2173 feet HSL
Water well within one-quarter mile: ... yes X no
Public water supply well within one mile: 180' ... yes X no

If OAWO: old well information as follows:
Operator:
Well Name:
Comp. Date: Old Total Depth

Depth to bottom of fresh water:
Depth to bottom of usable water: 640'
* Surface Pipe by Alternates: 1 X 2
Length of Surface Pipe Planned to be set: 250'
Length of Conductor pipe required: NA
Projected Total Depth: 4200
Formation at Total Depth: Mississippian
Water Source for Drilling Operations:
... well ... farm pond ... other

Directional, Deviated or Horizontal wellbore? ... yes X no
If yes, true vertical depths:
Bottom Hole Location:

Will Cores Be Taken?: ... yes X no
If yes, proposed zones:

AFFIDAVIT

* SURFACE PIPE WAS ALT 1

The undersigned hereby affirms that the drilling, completion and eventual plugging of this well will comply with K.S.A. 55-101, et. seq.
It is agreed that the following minimum requirements will be met:

1. Notify the appropriate district office prior to spudding of well;
2. A copy of the approved notice of intent to drill shall be posted on each drilling rig;
3. The minimum amount of surface pipe as specified below shall be set by circulating cement to the top; in all cases surface pipe shall be set through all unconsolidated materials plus a minimum of 20 feet into the underlying formation;
4. If the well is dry hole, an agreement between the operator and the district office on plug length and placement is necessary prior to plugging;
5. The appropriate district office will be notified before well is either plugged or production casing is cemented in;
6. IF AN ALTERNATE IS COMPLETION, PRODUCTION PIPE SHALL BE CEMENTED FROM BELOW ANY USABLE WATER TO SURFACE WITHIN 120 DAYS OF SPUD DATE. IN ALL CASES, NOTIFY DISTRICT OFFICE PRIOR TO ANY CEMENTING.

I hereby certify that the statements made herein are true and to the best of my knowledge and belief.

Date: 8-27-97 Signature of Operator or Agent: Scott Corsair Title: AGENT

MIN. SURFACE CASING WAS 660' ALT 1

MIN. SURFACE CASING IS 200' ALT 2

FOR KCC USE:
API # 15- 135-24027 0000
Conductor pipe required NONE feet
Minimum surface pipe required 200' feet per Alt. X 2
Approved by: FOR 8-29-97 / ORIL 8-15-97
This authorization expires: 2-15-98
(This authorization void if drilling not started within 6 months of effective date.)
Spud date: _____ Agent: _____

REMEMBER TO:

- File Drill Pit Application (form CDP-1) with Intent to Drill;
- File Completion Form ACO-1 within 120 days of spud date;
- File acreage attribution plat according to field proration orders;
- Notify appropriate district office 48 hours prior to workover or re-entry;
- Submit plugging report (CP-4) after plugging is completed;
- Obtain written approval before disposing or injecting salt water.

Mail to: KCC - Conservation Division, 130 S. Market - Room 2078, Wichita, Kansas 67202.

RECEIVED
KANSAS CORP DIV
1997 AUG 28 A 11:52
8-28-97

33 18 21W

LOCATE AND INTENDED WELL ON THE PLAT BELOW
 PLAT OF ACREAGE ATTRIBUTABLE TO A WELL IN A PRORATED OR SPACED FIELD

If the intended well is in a prorated or spaced field, please fully complete this side of the form. If the intended well is in a prorated or spaced field complete the plat below showing that the well will be properly located in relationship to other wells producing from the common source of supply. Please show all the wells within 1 mile of the boundaries of the proposed acreage attribution unit for gas wells and within 1/2 mile of the boundaries of the proposed acreage attribution unit for oil wells.

API NO. 15- 135-24027
 OPERATOR American Warrior, Inc.
 LEASE Ryersee
 WELL NUMBER 2-33
 FIELD _____

LOCATION OF WELL: COUNTY Ness
 _____ feet from south _____ line of section
1450 _____
1250 feet from east _____ line of section
 SECTION 33 TWP _____ 18S _____ RG 21W

NUMBER OF ACRES ATTRIBUTABLE TO WELL 10
 QTR/QTR/QTR OF ACREAGE _____

IS SECTION X REGULAR or _____ IRREGULAR
 IF SECTION IS IRREGULAR, LOCATE WELL FROM NEAREST
 CORNER BOUNDARY.

Section corner used: _____ NE _____ NW _____ SE _____ SW

PLAT

(Show location of the well and shade attributable acreage for prorated or spaced wells.)
 (Show footage to the nearest lease or unit boundary line.)

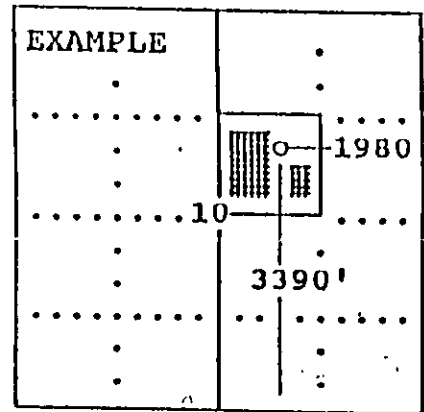
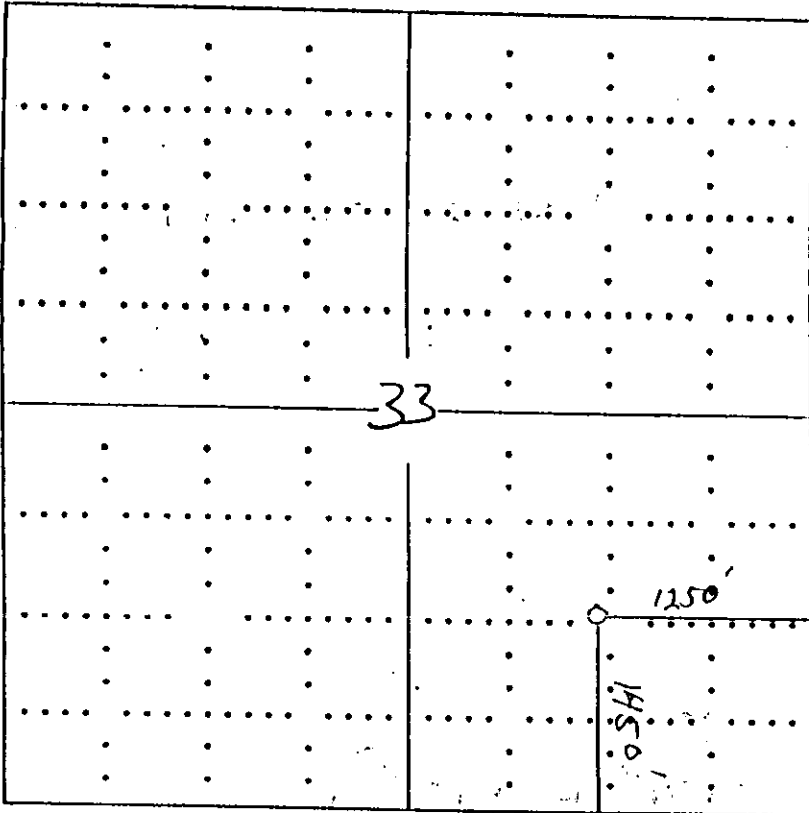

SEWARD CO.

In plotting the proposed location of the well, you must show:

- 1) The manner in which you are using the depicted plat by identifying section lines, i.e. 1 section, 1 section with 8 surrounding sections, 4 sections, etc.;
- 2) the distance of the proposed drilling location from the section's south/north and east/west; and
- 3) the distance to the nearest lease or unit boundary line.