

15-077-01041-0000

STATE OF KANSAS  
STATE CORPORATION COMMISSION

WELL PLUGGING RECORD

Give All Information Completely  
Make Required Affidavit  
Mail or Deliver Report to:  
Conservation Division  
State Corporation Commission  
211 No. Broadway  
Wichita, Kansas

HARBER

County. Sec. 7 Twp. 32 Rge. 9 (E) (W)

Location as "NE/CNW/SW" or footage from lines SE SE NW

Lease Owner PETROLEUM, INC.

Lease Name RICKE Well No. 1

Office Address Route 2, Great Bend, Kansas

Character of Well (completed as Oil, Gas or Dry Hole) Dry Hole

Date well completed January 18, 19 59

Application for plugging filed January 20, 19 59

Application for plugging approved January 23, 19 59

Plugging commenced January 18, 19 59

Plugging completed January 18, 19 59

Reason for abandonment of well or producing formation No Producing Zones

If a producing well is abandoned, date of last production None 19     

Was permission obtained from the Conservation Division or its agents before plugging was commenced? Yes

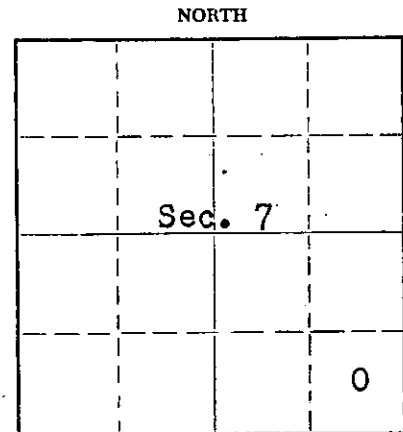

Locate well correctly on above Section Plat

Name of Conservation Agent who supervised plugging of this well Fred Hampel, Pretty Prairie, Kansas

Producing formation      Depth to top      Bottom      Total Depth of Well 440 Feet

Show depth and thickness of all water, oil and gas formations.

OIL, GAS OR WATER RECORDS

CASING RECORD

| FORMATION | CONTENT | FROM | TO | SIZE   | PUT IN | PULLED OUT |
|-----------|---------|------|----|--------|--------|------------|
|           |         |      |    | 8-5/8" | 237'   | None       |
|           |         |      |    |        |        |            |
|           |         |      |    |        |        |            |
|           |         |      |    |        |        |            |
|           |         |      |    |        |        |            |
|           |         |      |    |        |        |            |
|           |         |      |    |        |        |            |
|           |         |      |    |        |        |            |
|           |         |      |    |        |        |            |

Describe in detail the manner in which the well was plugged, indicating where the mud fluid was placed and the method or methods used in introducing it into the hole. If cement or other plugs were used, state the character of same and depth placed, from      feet to      feet for each plug set.

Mud up with heavy mud to 210' followed by 1/3 sack hulls and wooden plug. Placed 20 sacks cement through drill pipe on to plug. Mud up to 40' followed by 1/3 sack hulls and wooden plug. Filled hole to base of well cellar with 10 sacks cement.

(If additional description is necessary, use BACK of this sheet)

Name of Plugging Contractor Garvey Drilling Company

Address Route 2, Great Bend, Kansas

STATE OF KANSAS, COUNTY OF BARTON, ss.  
Don Searle (employee of owner) or ~~Notary Public~~ of the above-described

well, being first duly sworn on oath, says: That I have knowledge of the facts, statements, and matters herein contained and the log of the above-described well as filed and that the same are true and correct. So help me God.

(Signature) Don Searle

Route 2, Great Bend, Kansas (Address)

SUBSCRIBED AND SWORN TO before me this 30 th day of January

My commission expires July 11, 1960

RECEIVED  
STATE CORPORATION COMMISSION  
JAN 31 1959  
Notary Public.  
1-31-59  
CONSERVATION DIVISION  
Wichita, Kansas

PLUGGING  
FILE SEC 7 T 32 R 9W  
BOOK 11 LINE 17

15-077-01041-0000  
WELL LOG

COMPANY PETROLEUM, INCORPORATED

SEC. 7 T. 32S R. 9W

FARM RICKE NO. 1

LOC. SE, SE, NW

TOTAL DEPTH 4440'

COUNTY HARPER CO., KANSAS

COMM. January 5, 1959 COMP. January 18, 1959

CONTRACTOR GARVEY DRILLING COMPANY

CASING 8 5/8" @ 237' W/200 sax.

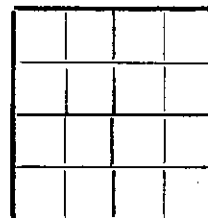

ELEVATION 1472' DF

PRODUCTION D & A

FIGURES INDICATE BOTTOM OF FORMATIONS

|      |                         |
|------|-------------------------|
| 50   | Sand                    |
| 95   | Sand & red bed          |
| 237  | Red rock & shells       |
| 1115 | Red bed, shale & shells |
| 1604 | Shale & lime            |
| 2080 | Lime                    |
| 2905 | Shale & lime            |
| 3163 | Lime                    |
| 3275 | Lime & shale            |
| 3444 | Lime                    |
| 3545 | Lime & shale            |
| 3592 | Shale & sand            |
| 4135 | Lime                    |
| 4200 | Lime & shale            |
| 4245 | Lime                    |
| 4334 | =Lime & shale           |
| 4355 | Chert                   |
| 4365 | Lime                    |
| 4395 | Chert                   |
| 4422 | Cherty lime             |
| 4440 | Chert                   |
| 4440 | T. D.                   |

PLUGGING  
 FILE SEC. 7 T. 32 R. 9W  
 BOOK PAGE 11 LINE 17

State of KANSAS }  
 County of BARTON } ss:

I, VERNE A. MORRIS of GARVEY DRILLING COMPANY

upon oath state that the above and foregoing is a true and correct copy of the log of the RICKE well

Subscribed and sworn to before me this 29th day of January 1959

My Commission Expires: July 11, 1960

**RECEIVED**  
 STATE CORPORATION COMMISSION  
 JAN 31 1959  
 CONSERVATION DIVISION  
 WICHITA, KANSAS

*Verne A. Morris*  
 \_\_\_\_\_  
 NOTARY PUBLIC