

15-077-00985-0000

STATE OF KANSAS  
STATE CORPORATION COMMISSION

Form CP-4

Give All Information Completely  
Make Required Affidavit  
Mail or Deliver Report to:  
Conservation Division  
State Corporation Commission  
212 No. Market  
Wichita, Kansas

WELL PLUGGING RECORD

Harper County, Sec. 18 Twp. 32 Rge. 9 (E) (W)  
Location as "NE/CNW/SW" or footage from lines. CN/2 SW/2 NW/4  
Lease Owner John O. Farmer  
Lease Name Warner Well No. B2  
Office Address Russell, Kansas  
Character of Well (completed as Oil, Gas or Dry Hole)  
Date well completed 19  
Application for plugging filed 19  
Application for plugging approved 19  
Plugging commenced 6/17/67 19  
Plugging completed 6/21/67 19  
Reason for abandonment of well or producing formation depleted.

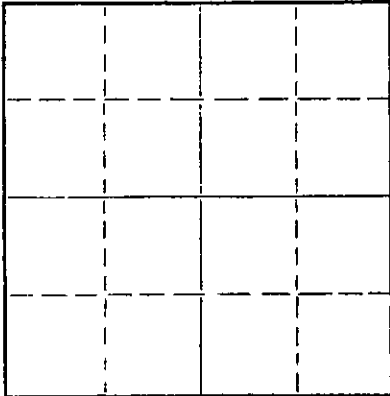

Locate well correctly on above  
Section Plat

If a producing well is abandoned, date of last production 19  
Was permission obtained from the Conservation Division or its agents before plugging was commenced? yes

Name of Conservation Agent who supervised plugging of this well Elving  
Producing formation Depth to top Bottom Total Depth of Well 4344' Feet  
Show depth and thickness of all water, oil and gas formations.

OIL, GAS OR WATER RECORDS

CASING RECORD

FORMATION	CONTENT	FROM	TO	SIZE	PUT IN	PULLED OUT
				8-5/8	255'	none
				5-1/2	4344'	3798'

Describe in detail the manner in which the well was plugged, indicating where the mud fluid was placed and the method or methods used in introducing it into the hole. If cement or other plugs were used, state the character of same and depth placed, from feet to feet for each plug set.

Checked hole, sanded hole to 4300' and set 5 sacks of cement. Loaded hole with water. Checked hole, shot pipe at 3864', 3803'. Set rock bridge at 250' and ran 25 sacks of cement. Mudded to 40' rock bridge and ran 10 sacks of cement. Tallied pipe.

PLUGGING COMPLETE.

RECEIVED  
STATE CORPORATION COMMISSION  
JUN 27 1967  
6-27-67  
CONSERVATION DIVISION  
Wichita, Kansas

(If additional description is necessary, use BACK of this sheet)

Name of Plugging Contractor KNIGHT CASING PULLING COMPANY  
Address CHASE, KANSAS

STATE OF KANSAS, COUNTY OF RICE, ss.  
NOEL J. KNIGHT (employee of owner) or (owner or operator) of the above-described well, being first duly sworn on oath, says: That I have knowledge of the facts, statements, and matters herein contained and the log of the above-described well as filed and that the same are true and correct. So help me God.

(Signature) Noel Knight  
CHASE, KANSAS  
(Address)

SUBSCRIBED AND SWORN to before me this 23rd day of June, 19 67

Margaret Melcher  
Notary Public.

My commission expires February 15, 1971

ADDRESS **Russell, Kansas**

Give detailed description and thickness of all formations drilled through, contents of sand, whether dry, water, oil or gas.

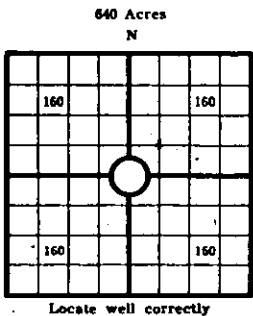

COUNTY **Harper** SEC. **18** TWP. **32** RGE. **9**  
 COMPANY OPERATING **Durbin Bond & Co., Inc.**  
 OFFICE ADDRESS **Little Rock, Arkansas**  
 FARM NAME **WERNER B** WELL NO. **2**  
 DRILLING STARTED **11/30/57** DRILLING FINISHED **12/13/57**  
 DATE OF FIRST PRODUCTION..... COMPLETED.....  
 WELL LOCATED **C 1/4 N/2 1/4 SW 1/4 NW**, North of South  
 Line and.....ft. East of West Line of Quarter Section  
 Elevation (Relative to sea level) DERRICK FLOOR **1440** GROUND.....  
 CHARACTER OF WELL (Oil, gas or dryhole) **oil**

Formation	Top	Bottom	Formation	Top	Bottom
Sand & shale	0	1100			
Shale & shells	1100	1140			
Shale & lime streaks	1140	1410			
Shale & shells	1410	1550			
Line & shale	1550	3920			
Line	3920	4105			
Line & shale	4105	4345			
Mississippi	4345	4345			
T.D.		4345			

OIL OR GAS SANDS OR ZONES

Name	From	To	Name	From	To
1			4		
2			5		
3			6		

Perforating Record If Any

Shot Record

Formation	From	To	No. of Shots	Formation	From	To	Size of Shot

CASING RECORD

Amount Set						Amount Pulled		Packer Record			
Size	Wt.	Thds.	Make	Ft.	In.	Ft.	In.	Size	Length	Depth Set	Make
8-5/8				255							

Liner Record: Amount \_\_\_\_\_ Kind \_\_\_\_\_ Top \_\_\_\_\_ Bottom \_\_\_\_\_

CEMENTING AND MUDDING

Size	Amount Set		Sacks Cement	Chemical		Method of Cementing	Amount	Mudding Method	Results (See Note)
	Ft.	In.		Gal.	Make				
8-5/8	255		200						
8-1/2	4344		76						

Note: What method was used to protect sands if outer strings were pulled? \_\_\_\_\_

NOTE: Were bottom hole plugs used? \_\_\_\_\_ If so, state kind, depth set and results obtained \_\_\_\_\_

TOOLS USED

Rotary Tools were used from \_\_\_\_\_ feet to \_\_\_\_\_ feet to \_\_\_\_\_ feet, and from \_\_\_\_\_ feet to \_\_\_\_\_ feet, and from \_\_\_\_\_ feet to \_\_\_\_\_ feet.  
 Cable tools were used from \_\_\_\_\_ feet to \_\_\_\_\_ feet.  
 Type Rig \_\_\_\_\_

INITIAL PRODUCTION TEST

Describe initial test: whether by flow through tubing or casing or by pumping \_\_\_\_\_  
 Amount of Oil Production \_\_\_\_\_ bbls. Size of choke, if any \_\_\_\_\_ Length of test \_\_\_\_\_ Water Production \_\_\_\_\_ bbls. Gravity of oil \_\_\_\_\_ Type of Pump if pump is used, describe \_\_\_\_\_

**RECEIVED**  
 STATE CORPORATION COMMISSION  
 JUN 28 1967  
 6-22-67  
 CONSERVATION DIVISION  
 WASHINGTON, KANSAS

I, the undersigned, being first duly sworn upon oath, state that this well record is true, correct and complete according to the records of this office and to the best of my knowledge and belief.

*John D. Farmer* President  
 Name and title of representative of company

Subscribed and sworn to before me this 16 day of December, 1957  
 My Commission expires 10/11/58  
*Julius Kennedy*  
 Notary Public

15-077-00985-0000  
 WELL NO. 2 COUNTY Harper  
 SEC. 18 TWP. 32 RGE. 9  
 FARM NAME WERNER B