

WELL PLUGGING RECORD

Give All Information Completely
Make Required Affidavit
Mail or Deliver Report to:
Conservation Division
State Corporation Commission
212 North Market, Insurance Bldg.
Wichita, Kansas

Harper County. Sec. 18 Twp. 32 Rge. 9 (E) W(W)
Location as "NE/CNW/SW" or footage from lines NW/4 SW/4 NW/4
Lease Owner Fender Pipe & Supply Co.,
Lease Name Fender Pipe & Supply-Werner Well No. B-1
Office Address Russell, Kansas.
Character of Well (completed as Oil, Gas or Dry Hole) _____
Date well completed _____ 19____
Application for plugging filed _____ 19____
Application for plugging approved _____ 19____
Plugging commenced Oct 10 19 61
Plugging completed Oct. 13 19 61
Reason for abandonment of well or producing formation _____

NORTH

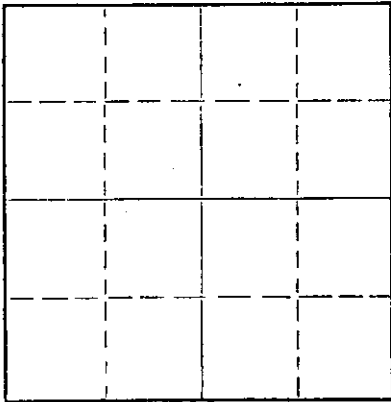

Locate well correctly on above
Section Plat

If a producing well is abandoned, date of last production _____ 19____
Was permission obtained from the Conservation Division or its agents before plugging was commenced? yes.

Name of Conservation Agent who supervised plugging of this well Frank Broadfoot
Producing formation _____ Depth to top _____ Bottom _____ Total Depth of Well 4343 Feet
Show depth and thickness of all water, oil and gas formations.

OIL, GAS OR WATER RECORDS

CASING RECORD

FORMATION	CONTENT	FROM	TO	SIZE	PUT IN	PULLED OUT

Describe in detail the manner in which the well was plugged, indicating where the mud fluid was placed and the method or methods used in introducing it into the hole. If cement or other plugs were used, state the character of same and depth placed, from 4343 feet to Surface. feet for each plug set.

5 1/2 in. casing set at 4335- no perforations. Hole filled with sand to 4325 and 5 sacks of cement placed on top of sand with dump bailer; Pipe shot off at 3373 ft, and all pulled from hole; hole then filled with mud to 240 ft; ten foot rock bridge installed between 240 and 230 feet and 20 sacks of cement poured in hole; hole then filled with mud to 40 ft; ten foot rock bridge installed between 40 and 30 feet and well capped with 10 sacks of cement.

RECEIVED
STATE CORPORATION COMMISSION
NOV 20 1961
11-20-61
CONSERVATION DIVISION
Wichita, Kansas

(If additional description is necessary, use BACK of this sheet)
Name of Plugging Contractor Barnes and Sons Pipe Pulling Co.,
Address Russell, Kansas.

STATE OF Kansas, COUNTY OF Russell, ss.
Allen T. Fender (employee of owner) or (owner or operator) of the above-described well, being first duly sworn on oath, says: That I have knowledge of the facts, statements, and matters herein contained and the log of the above-described well as filed and that the same are true and correct. So help me God.

(Signature) Allen T. Fender
Russell, Kansas
(Address)

SUBSCRIBED AND SWORN TO before me this 15th day of November, 19 61

My commission expires May 26, 1963
Ruth Phillips
Notary Public.

OPERATOR Durbin Bond & Co., Inc.

ADDRESS Little Rock, Arkansas

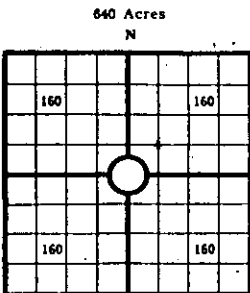

Locate well correctly

COUNTY Harper SEC. 18 TWP. 32 RGE. 9W
 COMPANY OPERATING Durbin Bond & Co.
 OFFICE ADDRESS Little Rock, Arkansas
 FARM NAME WERNER B WELL NO. 1
 DRILLING STARTED 10/10 19 57 DRILLING FINISHED 10/23 57
 DATE OF FIRST PRODUCTION _____ COMPLETED _____
 WELL LOCATED NW $\frac{1}{4}$ SW $\frac{1}{4}$ NW $\frac{1}{4}$ North of South
 Line and _____ ft. East of West Line of Quarter Section
 Elevation (Relative to sea level) DERRICK FLOOR 1448 GROUND 1445
 CHARACTER OF WELL (Oil, gas or dryhole) oil

OIL OR GAS SANDS OR ZONES

Name	From	To	Name	From	To
1			4		
2			5		
3			6		

Perforating Record If Any

Shot Record

Formation	From	To	No. of Shots	Formation	From	To	Size of Shot

CASING RECORD

Amount Set						Amount Pulled				Packer Record	
Size	Wt.	Thds.	Make	Ft.	In.	Ft.	In.	Size	Length	Depth Set	Make
8-5/8				244							

Liner Record: Amount _____ Kind _____ Top _____ Bottom _____

CEMENTING AND MUDDING

Size	Amount Set		Sacks Cement	Chemical		Method of Cementing	Amount	Mudding Method	Results (See Note)
	Ft.	In.		Gal.	Make				
8-5/8	244		175						
8-1/2	4338								

Note: What method was used to protect sands if outer strings were pulled?

NOTE: Were bottom hole plugs used? If so, state kind, depth set and results obtained

TOOLS USED

Rotary Tools were used from _____ feet to _____ feet. Cable tools were used from _____ feet to _____ feet, and from _____ feet to _____ feet, and from _____ feet to _____ feet.

Type Rig _____

INITIAL PRODUCTION TEST

Describe initial test: whether by flow through tubing or casing or by pumping _____

Amount of Oil Production _____ bbls. Size of choke, if any _____ Length of test _____ Water

Production _____ bbls. Gravity of oil _____ Type of Pump if pump is used, describe _____

CONTRACTOR: Jones, Shelburne & Farmer, Inc.
Russell, Kansas FORMATION RECORD

Give detailed description and thickness of all formations drilled through, contents of sand, whether dry, water, oil or gas.

Formation	Top	Bottom	Formation	Top	Bottom
Shale & redbed	0	1140			
Anhydrite	1140	1145			
Shale & shells	1145	1425			
Lime & shale	1425	1625			
Shale & lime	1625	1750			
Lime & shale	1750	2285			
Shale & lime	2285	2485			
Shale	2485	2660			
Shale & lime	2660	3525			
Sand	3525	3575			
Lime & shale	3575	3735			
Lime	3735	3795			
Lime & shale	3795	3925			
Lime	3925	4030			
Lime & shale	4030	4346			
T.D.		4346			

NOV 20 1957
 STATE GEOLOGICAL SURVEY
 CONSERVATION DIVISION
 Wichita, Kansas

I, the undersigned, being first duly sworn upon oath, state that this well record is true, correct and complete according to the records of this office and to the best of my knowledge and belief.

Howard J. Ferrell President
 Name and title of representative of company

Subscribed and sworn to before me this 31st day of October, 19 57
Lucretia Kennedy
 My Commission expires 10/11/58 Notary Public

15-077-01012-000
 COUNTY
 WELL NO.

SEC. TWP. RGE.

FARM NAME