

STATE CORPORATION COMMISSION OF KANSAS
OIL & GAS CONSERVATION DIVISION
WELL COMPLETION OR RECOMPLETION FORM
ACO-1 WELL HISTORY
DESCRIPTION OF WELL AND LEASE

API NO. 15-.....077-21, 157-0000.....
County.....^A Harper.....
NW NW SE East
..... Sect 4..... Twp. 32..Rge...9.. X West

Operator: License # 6151.....
Name Kansas Crude, Inc.....
Address 202 Wolcott Building.....
..... Hutchinson, KS 67501.....
City/State/Zip

2310 Ft North from Southeast Corner of Section
2310 Ft West from Southeast Corner of Section
(Note: Locate well in section plat below)

Purchaser..... Koch Oil Co. - Oil.....
..... Cities Service - Gas.....

Lease Name..... Simpson..... Well #.. 2.....

Operator Contact Person Tim Shaffer.....
Phone (316) 665-7201.....

Field Name..... ~~Spivey Grabs~~ Sharon.....

Contractor: License # 5107.....
Name H-30 Drilling.....

Producing Formation..... MISSISSIPPI.....

Wellsite Geologist... Ardan Ratzlaff.....
Phone.....

Elevation: Ground..... 1497'..... KB.....

Designate Type of Completion
 New Well Re-Entry Workover
 Oil SWD Temp Abd
 Gas Inj Delayed Comp.
 Dry Other (Core, Water Supply etc.)

If OWWO: old well info as follows:
Operator

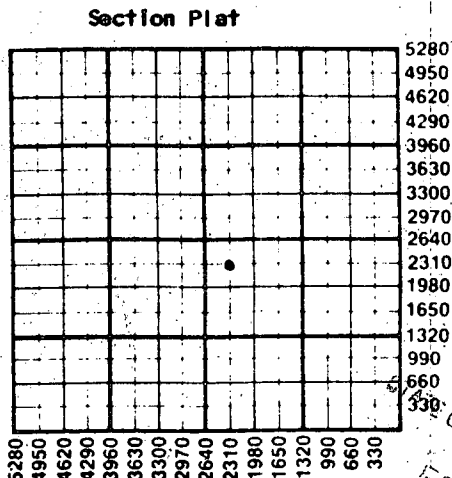

WATER SUPPLY INFORMATION

Disposition of Produced Water: Disposal Repressuring
Docket #

WELL HISTORY

Drilling Method:
 Mud Rotary Air Rotary Cable
..7-14-87... ..7-19-87... ..8-11-87...
Spud Date Date Reached TD Completion Date
..4348'.....
Total Depth PBD ALT

Amount of Surface Pipe Set and Cemented at 208 feet
Multiple Stage Cementing Collar Used? Yes No
If yes, show depth set..... feet
If alternate 2 completion, cement circulated
from..... feet depth to..... w/..... SX cmt
Cement Company Name

Questions on this portion of the ACO-1 call:
Water Resources Board (913) 296-3717

Source of Water:
Division of Water Resources Permit #.....

Groundwater..... Ft North from Southeast Corner
(Well) Ft West from Southeast Corner of
Sec Twp Rge East West

Surface Water..... Ft North from Southeast Corner
(Stream, pond etc)..... Ft West from Southeast Corner
Sec Twp Rge East West

Other (explain) Hauled water from landowner's pond
(purchased from city, R.W.D. #)

INSTRUCTIONS: This form shall be completed in triplicate and filed with the Kansas Corporation Commission, 200 Colorado Derby Building, Wichita, Kansas 67202, within 120 days of the spud date of any well. Rule 82-3-130, 82-3-107 and 82-3-106 apply. Information on side two of this form will be held confidential for a period of 12 months if requested in writing and submitted with the form. See rule 82-3-107 for confidentiality in excess of 12 months. One copy of all wireline logs and drillers time log shall be attached with this form. Submit CP-4 form with all plugged wells. Submit CP-111 form with all temporarily abandoned wells.

All requirements of the statutes, rules and regulations promulgated to regulate the oil and gas industry have been fully complied with and the statements herein are complete and correct to the best of my knowledge.

Signature [Signature]
Title..... Vice - President..... Date 2/17/88

Subscribed and sworn to before me this 17th day of February 1988
Notary Public [Signature]

Date 2-17-90
Notary Public Ronald H. McEwen
NOTARY PUBLIC
State of Kansas
My Appointment Expires:

K.C.C. OFFICE USE ONLY
F Letter of Confidentiality Attached
C Wireline Log Received
C Drillers Timelog Received
Distribution
 KCC SWD/Rep NGPA
 KGS Plug Other
(Specify)
2-18-88
Form ACO-1 (5-86)

RECEIVED
CORPORATION COMMISSION
FEB 18 1988
2-18-88
CONSERVATION DIVISION
WICHITA, KANSAS

Sec 4
Twp 32 N
Rge 9 W

SIDE TWO

Operator Name Kansas Crude, Inc. Lease Name Simpson Well # 2

Sec. 4 Twp. 32 Rge. 9 East West County Harper

WELL LOG

INSTRUCTIONS: Show important tops and base of formations penetrated. Detail all cores. Report all drill stem tests giving interval tested, time tool open and closed, flowing and shut-in pressures, whether shut-in pressure reached static level, hydrostatic pressures, bottom hole temperature, fluid recovery, and flow rates if gas to surface during test. Attach extra sheet if more space is needed. Attach copy of log.

Drill Stem Tests Taken Yes No
 Samples Sent to Geological Survey Yes No
 Cores Taken Yes No

Formation Description
 Log Sample

Name	Top	Bottom
Red Bed	0	817'
Shale and Lime	817'	3,572'
Lime and Shale	3,572'	4,240'
Lime	4,240'	4,348'
Rotary Total Depth		4,348'

D.S.T. No. 1 (4333-4348)
 30-45-45-60

Strong Blow Thru-Out

Rec: 30' Mud W Show of Oil (Less than 1/2 % Oil)
 Note: Good show of Oil on the lower recorder

ISIP/782# FSIP/870#
 IFP/44-44# FFP/55-55#
 TEMP. 119° F

CASING RECORD <input checked="" type="checkbox"/> New <input type="checkbox"/> Used							
Report all strings set-conductor, surface, intermediate, production, etc.							
Purpose of String	Size Hole Drilled	Size Casing Set (In O.D.)	Weight Lbs/Ft.	Setting Depth	Type of Cement	#Sacks Used	Type and Percent Additives
Surface	12-1/4"	8-5/8"	20#	208'	60/40 Pozmix	136	3% cc 2% gel
Production	7-7/8"	5-1/2"	15.5#	4336.5'	60/40 Pozmix	76	10% salt 2% gel 5# gilsonite P/sk 10 bbl. SW Flush
PERFORATION RECORD				Acid, Fracture, Shot, Cement Squeeze Record			
Shots Per Foot	Specify Footage of Each Interval Perforated			(Amount and Kind of Material Used)		Depth	
TUBING RECORD				Liner Run <input type="checkbox"/> Yes <input type="checkbox"/> No			
Size	Set At	Packer at					
Date of First Production		Producing Method					
		<input type="checkbox"/> Flowing <input type="checkbox"/> Pumping <input type="checkbox"/> Gas Lift <input type="checkbox"/> Other (explain).....					
Estimated Production Per 24 Hours		Oil	Gas	Water	Gas-Oil Ratio	Gravity	
		Bbls	MCF	Bbls	CFPB		

METHOD OF COMPLETION

Production Interval

Disposition of gas: Vented Open Hole Perforation
 Sold Other (Specify)
 Used on Lease Dually Completed
 Commingled

Amended

SIDE TWO

948 4399

Operator Name KASSAS CRUDE Lease Name SIMPSON Well # #2

Sec. 4 Twp. 32 Rge. 9 East West County HARDER

WELL LOG

INSTRUCTIONS: Show important tops and base of formations penetrated. Detail all cores. Report all drill stem tests giving interval tested, time tool open and closed, flowing and shut-in pressures, whether shut-in pressure reached static level, hydrostatic pressures, bottom hole temperature, fluid recovery, and flow rates if gas to surface during test. Attach extra sheet if more space is needed. Attach copy of log.

Drill Stem Tests Taken Yes No
Samples Sent to Geological Survey Yes No
Cores Taken Yes No

Formation Description
 Log Sample

Name Top Bottom

CASING RECORD New Used

Report all strings set-conductor, surface, intermediate, production, etc.

Purpose of String	Size Hole Drilled	Size Casing Set (in O.D.)	Weight Lbs/Ft.	Setting Depth	Type of Cement	#Sacks Used	Type and Percent Additives
.....
.....
.....

PERFORATION RECORD

Shots Per Foot	Specify Footage of Each Interval Perforated	Acid, Fracture, Shot, Cement Squeeze Record (Amount and Kind of Material Used)	Depth
.....	15,000 GALS. MY-7-68L
.....	150 SACKS SAND: 400 GALS.
.....	DS Fe ACID
.....

TUBING RECORD	Size <u>2 3/8"</u>	Set At <u>4334'</u>	Packer at <u>.....</u>	Liner Run <input type="checkbox"/> Yes <input checked="" type="checkbox"/> No
---------------	--------------------	---------------------	------------------------	---

Date of First Production <u>9-19-87</u>	Producing Method <input type="checkbox"/> Flowing <input checked="" type="checkbox"/> Pumping <input type="checkbox"/> Gas Lift <input type="checkbox"/> Other (explain).....
---	---

Estimated Production Per 24 Hours	Oil <u>8</u> Bbls	Gas <u>30,000</u> MCF	Water	Gas-Oil Ratio	Gravity
-----------------------------------	-------------------	-----------------------	-------	---------------	---------

METHOD OF COMPLETION

Disposition of gas: Vented Sold Used on Lease
 Open Hole Perforation Other (Specify) 4348-4352
 Dually Completed Commingled

