

STATE OF KANSAS
STATE CORPORATION COMMISSION

Form CP-4

WELL PLUGGING RECORD

Give All Information Completely
Make Required Affidavit
Mail or Deliver Report to:
Conservation Division
State Corporation Commission
211 No. Broadway
Wichita, Kansas

Barber

County. Sec. 1 Twp. 33S Rge. (E) 13 (W)

Location as "NE/CNW/SW" or footage from lines C NE/4 NW/4

Lease Owner Skelly Oil Company

Lease Name G. S. Lonker Well No. 2

Office Address P. O. Box 1650, Tulsa, Oklahoma

Character of Well (completed as Oil, Gas or Dry Hole) Gas-Condensate

Date well completed June 6, 1953

Application for plugging filed January 20, 1965

Application for plugging approved January 21, 1965

Plugging commenced February 22, 1965

Plugging completed February 25, 1965

Reason for abandonment of well or producing formation Depleted

If a producing well is abandoned, date of last production February 19, 1964

Was permission obtained from the Conservation Division or its agents before plugging was commenced? Yes

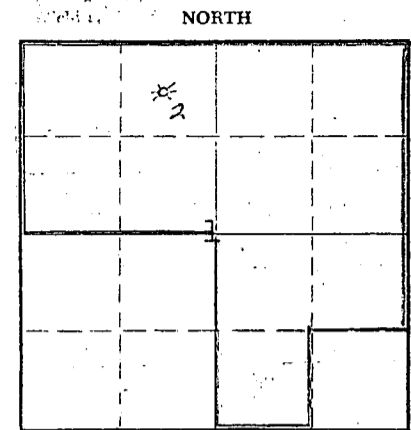

Locate well correctly on above Section Plat

Name of Conservation Agent who supervised plugging of this well Mr. A. Elving

Producing formation Tonganoxie Sand Depth to top 3828' Bottom Total Depth of Well 3845 Feet

Show depth and thickness of all water, oil and gas formations.

OIL, GAS OR WATER RECORDS

CASING RECORD

FORMATION	CONTENT	FROM	TO	SIZE OD	PUT IN	PULLED OUT
Tonganoxie Sand	Gas	3832'	3845'	8-5/8"	544'	None
				5-1/2"	3873'	2593'

Describe in detail the manner in which the well was plugged, indicating where the mud fluid was placed and the method or methods used in introducing it into the hole. If cement or other plugs were used, state the character of same and depth placed, from feet to feet for each plug set.

- Sand 3845' to 3820'
- 5 sacks of cement 3820' to 3780'
- Mud laden fluid 3780' to 270'
- Rock bridge 270' to 260'
- 25 sacks of cement 260' to 185'
- Mud laden fluid 185' to 40'
- Rock bridge 40' to 30'
- 10 sacks of cement 30' to Cellar
- Surface soil Cellar to Surface

RECEIVED
STATE CORPORATION COMMISSION
MAY 5 1965
5-5-65
CONSERVATION DIVISION
Wichita, Kansas

(If additional description is necessary, use BACK of this sheet)

Name of Plugging Contractor Southwest Casing Pulling Co., Inc.

Address Box 364, Great Bend, Kansas

STATE OF Nebraska, COUNTY OF Red Willow, ss.

C. F. Bass (employee of owner) or (owner of operation) of the above-described

well, being first duly sworn on oath, says: That I have knowledge of the facts, statements, and matters herein contained and the log of the above-described well as filed and that the same are true and correct. So help me God.

(Signature) C. F. Bass

P. O. Box 649, McCook, Nebraska

(Address)

SUBSCRIBED AND SWORN TO before me this 4th day of May 19 65

My commission expires June 13, 1969

C. G. Lindsey
Notary Public.

15-007-08448-0000

SKELLY OIL COMPANY

CHANGE IN WELL RECORD

Give complete description of all cleaning out, deepening, plugging back and fishing jobs, changes in casing, material lost in hole, etc., recorded in original well record.

LEASE NAME G. S. Lonker
 SEC. 1 T. 33S R. 13W
 BLOCK _____ SURVEY _____

WELL NO. 2 DISTRICT Platte
 COUNTY Barber AFE NO. 582
 STATE Kansas

TYPE OF WORK PLUG AND ABANDON WELL

Date commenced February 22, 1965 Date completed February 25, 1965
 Deepened from _____ to _____ Total Depth _____
 Plugged back from 3845' to Surface P.B.T.D. P & A
 Cleaned out from _____ to _____
 Production before 0.50 bbls. oil, 15 bbls. water 606*
 Production after _____ bbls. oil _____ bbls. water _____
 Tools owned by: Southwest Casing Pulling Co., Inc. Kind used: Pulling Unit No. days rig time _____
 Cost of Job \$ _____ Revised Estimated Payout (Mos.) _____
Not produced since 2/10/64, unable to flow against line pressure

TREATMENT RECORD

DATE	TYPE TREATMENT	INTERVAL TREATED	AMOUNT OF TREATMENT

CHANGES IN CASING RECORD

STRINGS	SIZE	WHERE SET (Depth)	CEMENTING RECORD		REMARKS
			Sacks Used	Top Cem't. Bhd. Casg.	
Production					
Liner					Top liner.

SIZE	WT.	THDS.	KIND	COND.	LEFT IN				PULLED OUT				
					Jts.	Feet	LTM	In.	Feet	WTM	In.	Jts.	Feet
<u>5-1/2"</u>	<u>17#</u>	<u>SR</u>	<u>BL LW</u>	<u>E</u>	<u>54</u>	<u>1263</u>	<u>0</u>	<u>1280</u>	<u>0</u>	<u>111</u>	<u>2569</u>	<u>3</u>	<u>2593</u>

PRODUCING FROM

FORMATION _____ thru _____ OPEN HOLE PERFORATIONS _____ TOP _____ BOTTOM _____ Total No. Shots _____

REMARKS (Give review of work performed and any other comment of interest.)

The well had declined to the point it would not deliver against the pipeline pressure, and as there are no further zones which merit testing and the well is not needed for salt water disposal or secondary recovery purposes, regular authority was granted to plug and abandon it.

February 22, 1965, moved in and rigged up casing pulling unit of Southwest Casing Pulling Company and plugged the well as follows:

Sand 3845' to 3820'
 5 sacks of cement 3820' to 3780'

Shot 5 1/2" casing at 2565' and pulled 2593' of 5 1/2" casing.

Mud laden fluid 3780' to 270'
 Rock bridge 270' to 260'
 25 sacks of cement 260' to 185'
 Mud laden fluid 185' to 40'
 Rock bridge 40' to 30'
 10 sacks of cement 30' to Cellar
 Surface soil Cellar to Surface

Plugged and abandoned 2/25/65.

WELL NO. 2
 DISTRICT PLATTE
 COUNTY BARBER
 STATE KANSAS
 DATE 2-25-65
 TIME 2:10 PM

CONSERVATION COMMISSION
MAY 5 1965
5-5-65
CONSERVATION DIVISION
Wichita, Kansas

REMARKS (GIVE BRIEF DESCRIPTION OF WORK DONE AND ANY OTHER COMMENTS OF INTEREST)

EXAMINATION LOCATION
OBSERVATION DATE
SITE NO.

SIZE	MATERIAL	DEPTH	KIND	COND.	TEMP.	WIND	DIRECTION	WIND	WIND	WIND	WIND	WIND	WIND	WIND	WIND	WIND	WIND	WIND	WIND	WIND	

CHANGES IN SYSTEM RECORD

DATE	TYPE TREATMENT	INTERVAL TREATED	AMOUNT OF TREATMENT

TREATMENT RECORD

DATE	TIME	LOCATION	AMOUNT	TYPE	REMARKS

TYPE OF WORK

BLOCK NO. _____ SHEET NO. _____
SEC. _____ DISTRICT _____
TOWN _____

CHANGE IN WELL RECORD

SKETCH OIL COMPANY

2001 2002 2003

15-007-0048-0000

SKELLY OIL COMPANY

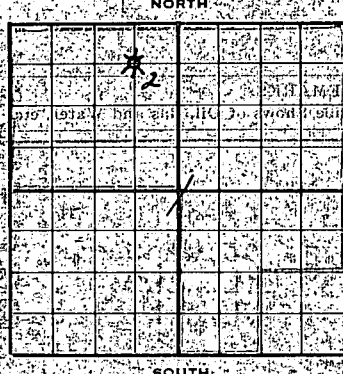

Well Record

Lease Name and No. **C. J. Lonker** Well No. **2** Elev. **10**
 Lease Description: **1/2 and 1/2 Sec. 16 and 15/4 Sec. 16**
13 and 1/2 Sec. 36-225-134, Barber Co., Mo. (76)
 Location made **May 6, 1953** by **Barber Co. Engineer**
660 feet from North line **660** feet from East line
 feet from South line feet from West line of **Sec. 16**

Work com'd **5/8 1953** Rig com'd **5/11 1953** Drlg com'd **5/11 1953** Drlg com'd **5/22 1953**
 Rig Contractor: **Hulme Drilling Company**
 Drilling Contractor: **Hulme Drilling Company, Great Bend, Kansas**

Rotary Drilling from **0'** to **3845'** Cable Tool Drilling from **To complete** to **to**

Commenced Producing **June 6, 1953** Initial Prod. before shot or acid
 Initial Prod. after shot or acid

Dry Gas Well Press **SI CP-10671** Volume **28,350,600**

Casing Head Gas Pressure Volume
 Braden Head (**8-5/8** Size) Gas Pressure Volume
 Braden Head (**8-5/8** Size) Gas Pressure Volume

PRODUCING FORMATION **Tongonoxie Sand** Top **3832'** Bottom **3845'** TOTAL DEPTH **38**

CASING RECORD

OD Size	Wt.	Thds.	Where Set	PULLED OUT			LEFT IN			KIND	Cond'n	CEMENTING	
				Jts.	Feet	In.	Jts.	Feet	In.			Sacks Used	Method Employed
6-5/8"	287	02	545'				27	344	3	R1 LW	C	300	Halliburto
5-1/2"	170	22	3032'				65	3673	3	R1 LW	A	200	Halliburto
(8-3/4" casing on 3 1/2" in casing and 5 1/2" casing to Derrick floor)													
Used 1 - 5" OD Berlin Combination Guide & float line													

Liner Set at Length Perforated at
 Liner Set at Length Perforated at
 Packer Set at Size and Kind
 Packer Set at Size and Kind

SHOT OR ACID TREATMENT RECORD

Date	FIRST		SECOND		THIRD		FOURTH	
	Gals. Shot	Qts.	Gals. Shot	Qts.	Gals. Shot	Qts.	Gals. Shot	Qts.

SIGNIFICANT GEOLOGICAL FORMATIONS

NAME	Top	Bottom	GAS		OIL		REMARKS
			From	To	From	To	
Eggs Sand	3845'						
Becher Shale	3750'						
Tongonoxie Sand	3026'		3831'	3845'			

CLEANING OUT RECORDS

	DATE COMMENCED	DATE COMPLETED	PROD. BEFORE	PROD. AFTER	REMARKS
1st					See Reverse for
2nd					" " "
3rd					" " "
4th					" " "

PLUGGING BACK AND DEEPENING RECORDS

	Date Commenced	Date Completed	No. Feet Plugged Back or Deepened	Prod. Before	Prod. After	REMARKS

RECORD OF FORMATIONS

STATE CORPORATION COMMISSION

FORMATION	TOP	BOTTOM	REMARKS
Red bed, shale and shells	0	300	Set and cemented 4-5/8" OD, 20 lb thd., R-1, L.C. steel casing (C cond.) at 365' with 300 sacks of Pozmix cement. Cement circulated.
Shale and shells	300	365	
Shale and shells	365	410	
Shale, shells and salt	410	475	
Line	475	520	
Line and shale	520	535	
Shale	535	575	
Line and shale	575	595	
Shale and sandy line	595	655	
Shale and line	655	710	
Line and shale	710	725	
Shale and line	725	785	
Sandy line	785	850	
Line	850	895	
Shale	895	945	
Line and shale	945	970	
Shale	970	980	
Shale and sandy line	980	995	
Shale and sand	995	1025	
Line	1025	1031	

TOP PLGIN AND 3645'
TOP POZMIX CEMENT 3754'

TOP FORMATION SAND 3828'

Gray, medium to fine grained clustered loosely cemented sand 3828' - 3845'

Good porosity, no stain, no odor.

Ran Halliburton Brill stem test, packer set at 3829'; used 22' sacher, open 20 minutes, gas to surface in 14 minutes, gas estimated 10,000 M.C.F., recovered 10' condensate, BWP-1200', final flow 1042'.

TOTAL DEPTH 3845'

Ran chamberger Survey.

Set and cemented 5 1/2" OD, 17 lb thd., R-1, L.C. Chester L.C. steel casing (A cond.) at 3832' with 300 sacks Pozmix cement. Finished 5:30 p.m. 5/23/53. Ran Halliburton Temperature Survey and found top of cement at 2570'. On May 26, moved in and rigged up cable tools.

On May 27, bailed hole dry to 3806', 5 1/2" casing tested dry, loaded hole with water and drilled cement plug to 3832'; hung tools in shoe. Cut drilling line and fished out tools lost in hole. Filled cement plug and cleaned out to bottom, 3845'.

On May 29, ran 2" tubing and cased well in. Flowed through 2" tubing, open 1 hour to clean hole; then on May 30, flowed through 2" tubing open, gas gauged 6,640 M.C.F. by spring gauge for indicated deliverability of 24,435 M.C.F., SI CP-1067, CP-9374. Shut in for pipe line connection.

On June 6, took deliverability test by Kansas Power & Light Company with deadweight tester and spring gauge, gas gauged 6,640 M.C.F. for indicated deliverability of 26,350 cubic feet, SI CP-1067, flowing CP-9644.

DEPTH	TEMPERATURE	PRESSURE	REMARKS
250'	75.2	102	
750'	75.0	102	
1000'	75.0	102	
1250'	75.0	102	
1500'	75.0	102	
1750'	75.0	102	
2000'	75.0	102	
2250'	75.0	102	
2500'	75.0	102	
2750'	75.0	102	
3000'	75.0	102	
3250'	75.0	102	
3500'	75.0	102	

JAN 21 1953