

ORIGINAL

TIGHT HOLE CONFIDENTIAL

STATE CORPORATION COMMISSION OF KANSAS
OIL & GAS CONSERVATION DIVISION
WELL COMPLETION FORM
ACO-1 WELL HISTORY
DESCRIPTION OF WELL AND LEASE

API NO. 15- 007-22,344-0000
County Barber
NW NW NW Sec. 11 Twp. 30s Rge. 14w X East West

RELEASED

MAR 09 1991

FROM CONFIDENTIAL

Operator: License # 5056
Name: F. G. HOLL COMPANY
Address: 6427 E. Kellogg
P.O. Box 780167
City/State/Zip: Wichita, KS 67278-0167
Purchaser: Clear Creek
Operator Contact Person: Elwyn H. Nagel
Phone (316) 684-8481
Contractor: Name: Sterling Drilling Company
License: 5142
Wellsite Geologist: Brent B. Reinhardt

4950' Ft. North from Southeast Corner of Section
4950' Ft. West from Southeast Corner of Section
(NOTE: Locate well in section plat below.)

Lease Name JOHNSON Well # 1-11
Field Name Wildcat
Producing Formation Lansing
Elevation: Ground 1921' KB 1930'
Total Depth 4690' PBTD 4154'

Designate Type of Completion
X New Well Re-Entry Workover
X Oil SWD Temp. Abd.
Gas Inj Delayed Comp.
Dry Other (Core, Water Supply, etc.)

If O.W.O.: old well info as follows:
Operator:
Well Name:
Comp. Date Old Total Depth

Drilling Method:
X Mud Rotary Air Rotary Cable
11/24/90 12/5/90 1/7/91
Spud Date Date Reached TD Completion Date

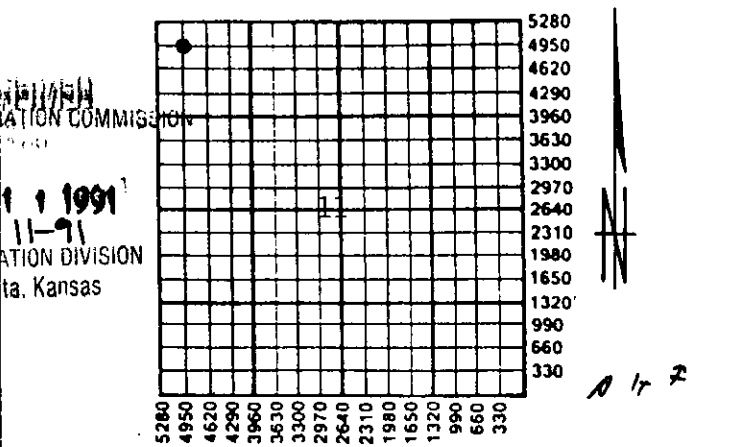

Amount of Surface Pipe Set and Cemented at 218' KB Feet
Multiple Stage Cementing Collar Used? Yes X No
If yes, show depth set Feet
If Alternate II completion, cement circulated from feet depth to w/ sx cmt.

INSTRUCTIONS: This form shall be completed in triplicate and filed with the Kansas Corporation Commission, 200 Colorado Derby Building, Wichita, Kansas 67202, within 120 days of the spud date of any well. Rule 82-3-130, 82-3-107 and 82-3-106 apply. Information on side two of this form will be held confidential for a period of 12 months if requested in writing and submitted with the form. See rule 82-3-107 for confidentiality in excess of 12 months. One copy of all wireline logs and drillers time log shall be attached with this form. ALL CEMENTING TICKETS MUST BE ATTACHED. Submit CP-4 form with all plugged wells. Submit CP-111 form with all temporarily abandoned wells. Any recompletion, workover or conversion of a well requires filing of ACO-2 within 120 days from commencement date of such work.

All requirements of the statutes, rules and regulations promulgated to regulate the oil and gas industry have been fully complied with and the statements herein are complete and correct to the best of my knowledge.

Signature Elwyn H. Nagel
Title Elwyn H. Nagel, Manager Date 3/6/91
Subscribed and sworn to before me this 6th day of March, 1991.
Notary Public V. Jean Feil
Date Commission Expires

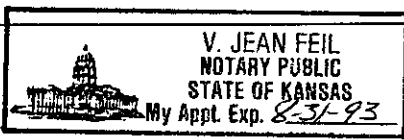

K.C.C. OFFICE USE ONLY
F Letter of Confidentiality Attached
C Wireline Log Received
C Drillers Timelog Received
Distribution
KCC SWD/Rep NGPA
KGS Plug Other (Specify)

CONFIDENTIAL

TIGHT HOLE!

SIDE TWO

Operator Name F. G. HOLL COMPANY Lease Name JOHNSON Well # 1-11

Sec. 11 Twp. 30S Rge. 14W East West County Barber

INSTRUCTIONS: Show important tops and base of formations penetrated. Detail all cores. Report all drill stem tests giving interval tested, time tool open and closed, flowing and shut-in pressures, whether shut-in pressure reached static level, hydrostatic pressures, bottom hole temperature, fluid recovery, and flow rates if gas to surface during test. Attach extra sheet if more space is needed. Attach copy of log.

Drill Stem Tests Taken Yes No
(Attach Additional Sheets.)
Samples Sent to Geological Survey Yes No
Cores Taken Yes No
Electric Log Run Yes No
(Submit Copy.)

Formation Description			
		<input checked="" type="checkbox"/> Log	<input type="checkbox"/> Sample
Name	Top	Bottom	
Indian Cave	2939 (-1009)	Bern	3245 (-1315)
Topeka	3413 (-1483)		
Heebner	3789 (-1859)	Viola	4479 (-2549)
Toronto	3807 (-1877)	Simpson SH	4519 (-2589)
Douglas SH	3824 (-1894)	Simpson SD	4525 (-2595)
Brown Lime	3971 (-2041)	Arbuckle	4629 (-2699)
Lansing	3986 (-2056)	RTD	4690 (-2760)
BKC	4376 (-2446)	LTD	4693 (-2763)
Marmaton	4385 (-2455)		
Conglomerate	4450 (-2520)		

DST #1 (2922-2965) Indian Cave
1) WB dead in 12 mins. 2) NB
REC: 5' M
IHP: 1434 IFP: 79-58:15" ISIP: 326:30"
FHP: 1346 FFP: 84-60:15" FSIP: 177:30"
BHT: 101F

(See attached sheet for additional DST's)

CASING RECORD New Used
Report all strings set-conductor, surface, intermediate, production, etc.

Purpose of String	Size Hole Drilled	Size Casing Set (In O.D.)	Weight Lbs./Ft.	Setting Depth	Type of Cement	# Sacks Used	Type and Percent Additives
Surface	17 1/2"	13 3/8" (N)	48#	218'KB	60/40 POZ	225	2%Gel, 3%CC
Production	7 7/8"	4 1/2" (N&U)	10.5#	4688'KB	Lite	100	Salt, Gils.
					50/50 POZ	125	

Shots Per Foot	Specify Footage of Each Interval Perforated	Acid, Fracture, Shot, Cement Squeeze Record (Amount and Kind of Material Used)	Depth
ISPF	4481-4500 (Viola)	AC:100gls 15%DSFE, SWB:60bbls TO, FR:33,000gls My-T-Gel X-Link, 240sks 20/40, 120sks 12/20, SWB:160bbls, TO	4500'
ISPF	4454-4460 (Conglomerate)	AC:1000gls 15%DSFE, SWB:5BPH Good Gas, SSO	4470'
ISPF	4032-4040, 4167-4169, 4187-4189, 4200-4203 (Lansing)	AC:2000gls 15%SGA, SWB:SO, REAC:2000gls 15% 4032-40, GSO	4430' 4154'

TUBING RECORD Size 2 3/8" Set At 4154' Packer At None Liner Run Yes No

Date of First Production 2/9/91 Producing Method Flowing Pumping Gas Lift Other (Explain)

Estimated Production Per 24 Hours	Oil Bbls.	Gas Mcf	Water Bbls.	Gas-Oil Ratio	Gravity
	25	None	35		

Disposition of Gas: Vented Sold Used on Lease (If vented, submit ACO-18.)
METHOD OF COMPLETION: Open Hole Perforation Dually Completed Commingled Other (Specify) _____
Production Interval: 4032-4040 (Lansing)

TIGHT HOLE!

ORIGINAL

15-007-22344-0000

F. G. HOLL COMPANY

6427 EAST KELLOGG - P.O. BOX 780167
WICHITA, KS 67278-0167

CONFIDENTIAL

JOHNSON #1-11
NW NW NW
Sec 11-30s-14w
Barber County, KS
API#: 15-007-22,344

RELEASED

MAR 09 1993

FROM CONFIDENTIAL

→ DST #2 (3237-3270) Bern-Burlingame
1) FB 5" in bucket 2) FB 4" in bucket
REC: 39' SOSpkDM
1' OCM
40' Total Fluid
IHP: 1573 IFP: 57-57:30" ISIP: 668:60"
FHP: 1567 FFP: 63-63:60" FSIP: 839:90" BHT: 102F

→ DST #3 (3794-3825) Toronto
1) SBOB in 2mins. 2) GTS in 3mins.
Gauged 2nd Opening: 5,320 CFGPD in 5"
3,710 " 15"
2,370 " 25"
5,860 " 35"
1,680 " 45"
1,680 " 55"
REC: 300' SMGO (37%O, 60%G, 3%M)
120' MGO (53%O, 32%G, 5%W, 10%M)
75' MGO (40%O, 48%G, 7%W, 5%M)
45' Wtr
540' Total Fluid
IHP: 1915 IFP: 83-122:30" ISIP: 1275:60"
FHP: 1912 FFP: 143-208:60" FSIP: 1210:90" BHT: 109F CHL: 98,000 ppm

WICHITA
PUBLIC CORPORATION COMMISSION

MAR 11 1991
3-11-91
CONSERVATION DIVISION
Wichita, Kansas

→ DST #4 (4123-4143) LKC "G" ZONE
1) FB throughout 2) FB throughout
REC: 120' SltoCM (2%O)
60' MW w/Scum Oil
300' SW
480' Total Fluid
IHP: 2044 IFP: 97-133:30" ISIP: 1457:60"
FHP: 2040 FFP: 199-270:60" FSIP: 1427:90" BHT: 114F CHL: 140,000 ppm

→ DST #5 (4472-4490) Viola - MISS-RUN: PACKER FAILURE

→ DST #6 (4446-4490) Conglomerate - Viola
1) SBOB, GTS in 5 mins.
Gauged 1st Opening: 341,000 CFGPD in 10" Gauged 2nd Opening: 311,000 CFGPD in 5"
355,000 " 20" 355,000 " 10"
355,000 " 30" 355,000 " 20",30",
40",50",60"
REC: 150' GCM
360' GCMW
510' Total Fluid
IHP: 2259 IFP: 282-245:30" ISIP: 1592:60"
FHP: 2224 FFP: 233-254:60" FSIP: 1570:90" BHT: 117F CHL: 150,000 ppm

15-007-22344-0000

ORIGINAL F. G. HOLL COMPANY

6427 EAST KELLOGG - P.O. BOX 780167
WICHITA, KS 67278-0167

CONFIDENTIAL

JOHNSON #1-11
NW NW NW
Sec 11-30s-14w
Barber County, KS
API#: 15-007-22,344

RELEASED

10 9 1003

FROM CONFIDENTIAL

→ DST #7 (4510-4530) Simpson Sand
1) WSteady 1/4" in bucket 2) NB
REC: 30' DM
IHP: 2338 IFP: 93-65:30" ISIP: 65:60"
FHP: 2236 FFP: 65-65:30" FSIP: 65:60" BHT: 118F

RECEIVED
STATE CORPORATION COMMISSION

MAR 19 1991
3-11-91
CONSERVATION DIVISION
Wichita, Kansas

15-007-22344-0000

DALLAS, TX 75395-1046

INVOICE

HALLIBURTON SERVICES

A Halliburton Company

041893

12/05/1990

WELL/PLANT NAME		WELL/PLANT NO.		STATE	WELL/PLANT
JOHNSON 1-11		BARBER		KS	SAME
SERVICE LOCATION	CONTRACTOR	JOB PURPOSE		TICKET DATE	
PRATT	STERLING DRLG	CEMENT PRODUCTION CASING		12/05/1990	
ACCT. NO.	CUSTOMER AGENT	VENDOR NO.	CUSTOMER PO NUMBER	SHIPPED VIA	FILE NO.
392900	V L THOMPSON			COMPANY TRUCK	06541

F G HOLL
P O BOX 158
BELPRE, KS 67519

DIRECT CORRESPONDENCE TO:
SUITE 1300
LIBERTY TOWER
100 BROADWAY AVENUE
OKLAHOMA CITY, OK 73102-0000

PRICING AREA - MID CONTINENT				
000-117	MILEAGE	18	MI	
		1	UNT	
000-118	MILEAGE SURCHARGE-CEMENT-LAND	18	MI	
		1	UNT	
001-016	CEMENTING CASING	4691	FT	
		1	UNT	
030-016	CEMENTING PLUG 5W ALUM TOP	4.5	IN	
		1	EA	
018-317	SUPER FLUSH	12	SK	
509-968	SALT	400	LB	
12A	GUIDE SHOE - 4 1/2" 8RD THD.	1	EA	
825.201				
24A	INSERT FLOAT VALVE - 4 1/2" 8RD	1	EA	
815.19101				
27	FILL-UP UNIT 4 1/2"-5"	1	EA	
815.19113				
40	CENTRALIZER 4-1/2" MODEL S-4	5	EA	
807.93004				
504-316	HALLIBURTON LIGHT W/STANDARD	100	SK	
504-308	STANDARD CEMENT	63	SK	
506-105	POZMIX A	62	SK	
506-121	HALLIBURTON-GEL 2X	2	SK	
509-968	SALT	1100	LB	
508-292	GILSONITE, SACKED	650	LB	
507-210	FLOCELE	16	LB	
508-087	TUF CEMENT FIBERS NO 2 (POLYPR	16	LB	
507-153	CFR-3	79	LB	
500-307	MILEAGE SURCHARGE-CEMENT MAT.	199.04	TMI	
500-207	BULK SERVICE CHARGE	260	CFT	
500-306	MILEAGE CMTG MAT DEL OR RETURN	199.01	TMI	

***** CONTINUED ON NEXT PAGE *****

TERMS INVOICES PAYABLE NET BY THE 20TH OF THE FOLLOWING MONTH AFTER DATE OF INVOICE. UPON CUSTOMER'S DEFAULT IN PAYMENT OF CUSTOMER'S ACCOUNT BY THE LAST DAY OF THE MONTH FOLLOWING THE MONTH IN WHICH THE INVOICE IS DATED. CUSTOMER AGREES TO PAY INTEREST THEREON AFTER DEFAULT AT THE HIGHEST LAWFUL CONTRACT RATE APPLICABLE BUT NEVER TO EXCEED 18% PER ANNUM. IN THE EVENT IT BECOMES NECESSARY TO EMPLOY AN ATTORNEY TO ENFORCE COLLECTION OF SAID ACCOUNT. CUSTOMER AGREES TO PAY ALL COLLECTION COSTS AND

ORIGINAL
HALLIBURTON SERVICES

P. O. BOX 981046
DALLAS, TX 75395-1046

INVOICE

A Halliburton Company

CONFIDENTIAL

041891 11/24/1990

WELL LEASE NO. PLANT NAME	WELL LEASE LOCATION	STATE	WELL PLANT OWNER
JOHNSON 1-11	BARBER	RELEASED KS	SAME
SERVICE LOCATION	CONTRACTOR	JOB PURPOSE	TICKET DATE
PRATT	STERLING DRLG #4	CEMENT SURFACE CASING	11/24/1990
ACCT NO.	CUSTOMER AGENT	CUSTOMER P.O. NUMBER	FILE NO.
392900	V L THOMPSON	FROM COMPANY	COMPANY TRUCK 05808

F G HOLL
P O BOX 158
BELPRE, KS 67519

DIRECT CORRESPONDENCE TO:
SUITE 1300
LIBERTY TOWER
100 BROADWAY AVENUE
OKLAHOMA CITY, OK 73102-0000

PRICING AREA - MID CONTINENT	
000-117 MILEAGE	18 MI 1 UNT
000-118 MILEAGE SURCHARGE-CEMENT-LAND	18 MI 1 UNT
001-016 CEMENTING CASING	220 FT 1 UNT
030-503 CMTG PLUG LA-11, CR-1, CP-3, TOP	13 3/8 IN 1 EA
504-308 STANDARD CEMENT	135 SK
506-105 POZMIX A	90 SK
506-121 HALLIBURTON-GEL 2%	4 SK
509-406 ANHYDROUS CALCIUM CHLORIDE	6 SK
500-307 MILEAGE SURCHARGE-CEMENT MAT.	181.95 TMI
500-207 BULK SERVICE CHARGE	237 CFT
500-306 MILEAGE CMTG MAT DEL OR RETURN	181.95 TMI

INVOICE SUBTOTAL
DISCOUNT-(BID)
INVOICE BID AMOUNT

*-KANSAS STATE SALES TAX
*-PRATT COUNTY SALES TAX

STATE CORPORATION COMMISSION

MAR 1 1991

CONSERVATION DIVISION
Wichita, Kansas

INVOICE TOTAL - PLEASE PAY THIS AMOUNT =====>

TERMS INVOICES PAYABLE NET BY THE 20TH OF THE FOLLOWING MONTH AFTER DATE OF INVOICE UPON CUSTOMER'S DEFAULT IN PAYMENT OF CUSTOMER'S ACCOUNT BY THE LAST DAY OF THE MONTH FOLLOWING THE MONTH IN WHICH THE INVOICE IS DATED. CUSTOMER AGREES TO PAY INTEREST THEREON AFTER DEFAULT AT THE HIGHEST LAWFUL CONTRACT RATE APPLICABLE BUT NEVER TO EXCEED 18% PER ANNUM IN THE EVENT IT BECOMES NECESSARY TO EMPLOY AN ATTORNEY TO ENFORCE COLLECTION OF SAID ACCOUNT. CUSTOMER AGREES TO PAY ALL COLLECTION COSTS AND