

STATE CORPORATION COMMISSION OF KANSAS  
OIL & GAS CONSERVATION DIVISION  
WELL COMPLETION OR RECOMPLETION FORM  
ACO-1 WELL HISTORY  
DESCRIPTION OF WELL AND LEASE

API NO. 15-007-21,773-0000  
County Barber  
W 1/2 SE 1/4 NE 1/4 Sec. 34 Twp. 30S. Rge. 14 East West

Operator: License # 6093  
Name Marshal Oil & Gas, Inc.  
Address Suite 702, 107 N. Market  
City/State/Zip Wichita, Kansas, 67202

3300 Ft North from Southeast Corner of Section  
990 Ft West from Southeast Corner of Section  
(Note: Locate well in section plat below)

Purchaser None

Lease Name Lambert Well #. 1  
Field Name Unknown

Operator Contact Person Robert D. Gensch  
Phone 316 2674631

Producing Formation Testing Viola  
Elevation: Ground 1754 Gr 1763 KB

Contractor: License # H-30 Drilling  
Name

Wellsite Geologist Robert D. Gensch  
Phone 316 2674631

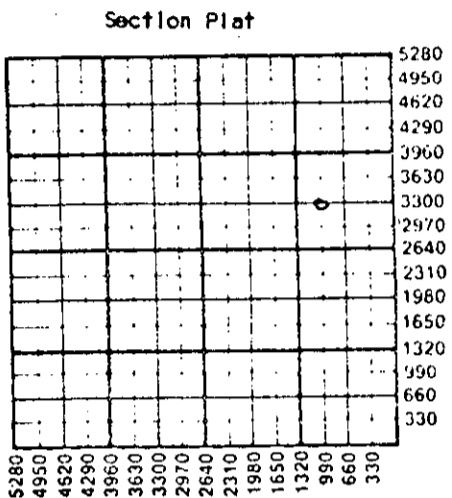

Designate Type of Completion  
New Well Re-Entry Workover

Oil SWD X Temp Abd  
Gas Inj X Delayed Comp.  
Dry Other (Core, Water Supply etc.)

If OWO: old well info as follows:  
Operator  
Well Name  
Comp. Date Old Total Depth

WATER SUPPLY INFORMATION  
Disposition of Produced Water: X Disposal  
Docket # Repressuring

WELL HISTORY

Drilling Method: X Mud Rotary Air Rotary Cable  
2-27-84 3-13-84 In litigation  
Spud Date Date Reached TD Completion Date  
4583 4496  
Total Depth PBD

Questions on this portion of the ACO-1 call:  
Water Resources Board (913) 296-3717  
Source of Water: Lease Pond  
Division of Water Resources Permit # v N/A  
Groundwater Ft North from Southeast Corner (Well) Ft West from Southeast Corner of Sec Twp Rge East West  
Surface Water Ft North from Southeast Corner (Stream, pond etc) Ft West from Southeast Corner Sec Twp Rge East West  
X Other (explain) H-30 Drilling (purchased from city, R.W.D. #)

Amount of Surface Pipe Set and Cemented at 270 feet  
Multiple Stage Cementing Collar Used? Yes X No  
If yes, show depth set feet  
If alternate 2 completion, cement circulated from 270 feet depth to surf. w/ 175 SX cmt  
Cement Company Name Buie  
Invoice # 2618

INSTRUCTIONS: This form shall be completed in duplicate and filed with the Kansas Corporation Commission, 200 Colorado Derby Building, Wichita, Kansas 67202, within 90 days after completion or recompletion of any well. Rule 82-3-130 and 82-3-107 apply.  
Information on side two of this form will be held confidential for a period of 12 months if requested in writing and submitted with the form. See rule 82-3-107 for confidentiality in excess of 12 months. One copy of all wireline logs and drillers time log shall be attached with this form. Submit CP-4 form with all plugged wells. Submit CP-111 form with all temporarily abandoned wells.

All requirements of the statutes, rules and regulations promulgated to regulate the oil and gas industry have been fully complied with and the statements herein are complete and correct to the best of my knowledge.

Signature Robert D. Gensch  
Title Robert D. Gensch, President Date 1-25-86

Subscribed and sworn to before me this 27th day of January 1986  
Notary Public Julie J. Taylor  
Date Commission Expires 10-14-87

K.C.C. OFFICE USE ONLY  
Letter of Confidentiality Attached  
Wireline Log Received  
Drillers Time Log Received  
Distribution  
KCC SWD/Rep NGPA  
KGS Plug Other (Specify)

JAN 29 1986

Sec 2-1/2 Twp 30 Rge 14

Operator Name ..... Marshal Oil & Gas, Inc. .... Lease Name..... Lambert  
 Sec. 34 ..... Twp. 30S ..... Rge. 14 .....  East  West County..... Barber .....

WELL LOG

INSTRUCTIONS: Show important tops and base of formations penetrated. Detail all cores. Report all drill stem tests giving interval tested, time tool open and closed, flowing and shut-in pressures, whether shut-in pressure reached static level, hydrostatic pressures, bottom hole temperature, fluid recovery, and flow rates if gas to surface during test. Attach extra sheet if more space is needed. Attach copy of log.

Drill Stem Tests Taken  Yes  No  
 Samples Sent to Geological Survey  Yes  No  
 Cores Taken  Yes  No

DST # 1: 3095-3115; 15"; 30"; 60"; 45"; GTS stab. 18.5MCFGPD; Rec. 180' SOCGM; 960' SW. IFP 183-162#; FFP 291-572#/ ISIP 937#/ FSIP 937#. HHP 1506-1560#

DST # 2: 3684-98; 30"; 30"; 45"; 30"; GTS Ga 15.7 MCFGPD; Rec. 370' O & GCM; IFP 64-86#; FFO 86-140#; IBHP 980#; FBHP 744#/ HHP 1917-1884#

DST # 3: 3829-37; 30"; 30"; 45"; 30"; Rec. 120' G & OCM, as 0' G & OCW; 125' SW IFP 156-354#/ FFP 500-572#; IBHP 1298#; FBHP 1298#. HHP 2031-2016

DST # 4: 4550-83; 30"; 30"; 30"; 30"; Rec. 120' SOCWM, 1040' SW; HHP 2428-2397#.

Formation Description		
Name	Top	Bottom
Indian Cave	2828	(-1055)
Heebner	3688	(-1905)
Toronto	3686	(-1923)
Lansing	3861	(-2096)
Massey	4295	(-2532)
Miss	4364	(-2601)
Viola	4419	(-2656)
Simpson	4574	(-2811)
RTD	4583	(-2820)

RELEASED

MAY 28 1987

FROM CONFIDENTIAL

CASING RECORD <input checked="" type="checkbox"/> New <input type="checkbox"/> Used							
Report all strings set-conductor, surface, intermediate, production, etc.							
Purpose of String	Size Hole Drilled	Size Casing Set (in O.D.)	Weight Lbs/Ft.	Setting Depth	Type of Cement	#Sacks Used	Type and Percent Additives
Surface		8.5/8	24	270	Class A	175	2% gel; 3% Cal.
Production		7.7/8	10.5	4582'	Class A	350.65/350.123Sx	4% gel; 3% FLAC Posmix

PERFORATION RECORD		Acid, Fracture, Shot, Cement Squeeze Record	
Shots Per Foot	Specify Footage of Each Interval Perforated (Testing Cont)	(Amount and Kind of Material Used)	Depth
2	4469-72 After Sq. knocked out...	500 MA 4469-72; 1250 gal 7% MCA	
2	4336-38 plugs to TD. Frac perfs	Plug 4352; 300 gal 15% HCL	No SHOW
3	3693-96 4469-72 w 19000 # Sd.	Plug 3860; 500 Ga; 15% MSR-100; 1800 Gal Gel Ac. (15% HCL); 1000 Gal 7% MSR Acid; Sq. 3693-96 w/100sx	class A-1900#.

TUBING RECORD		Liner Run <input type="checkbox"/> Yes <input checked="" type="checkbox"/> No	
Size	Set At	Packer at	
2"	4475		

Date of First Production	Producing Method <input checked="" type="checkbox"/> Flowing <input checked="" type="checkbox"/> Pumping <input type="checkbox"/> Gas Lift <input type="checkbox"/> Other (explain).....				
	Oil	Gas	Water	Gas-Oil Ratio	Gravity
Estimated Production Per 24 Hours	5 Bbls	± 30 MCF est. MCF	30 wtr Bbls		40 CFPB

METHOD OF COMPLETION

Production Interval

Disposition of gas:  Vented  Open Hole  Perforation  
 Sold  Other (Specify) ..... 4469-72  
 Used on Lease  Dually Completed .....  
 Commingled