

WELL PLUGGING RECORD

Give All Information Completely
Make Required Affidavit
Mail or Deliver Report to:
Conservation Division
State Corporation Commission
211 No. Broadway
Wichita, Kansas

NORTH

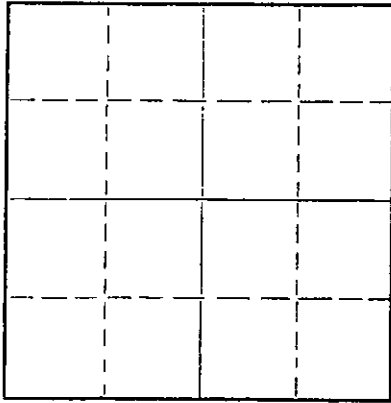

Locate well correctly on above
Section Plat

Ness County. Sec. 13 Twp. 20S Rge. (E) 22 (W)
Location as "NE/CNW/SW" or footage from lines C SW SW

Lease Owner E. Lyle Johnson

Lease Name JANKE Well No. 1

Office Address 626 North Broadway, Moore, Oklahoma

Character of Well (completed as Oil, Gas or Dry Hole) Dry Hole

Date well completed April 28 19 65

Application for plugging filed April 28 19 65

Application for plugging approved April 28 19 65

Plugging commenced April 28 19 65

Plugging completed April 28 19 65

Reason for abandonment of well or producing formation no oil or gas found in commercial quantities.

If a producing well is abandoned, date of last production - - 19 -

Was permission obtained from the Conservation Division or its agents before plugging was commenced? Yes

Name of Conservation Agent who supervised plugging of this well Eldon Petty, Hays, Kansas

Producing formation _____ Depth to top _____ Bottom _____ Total Depth of Well 4413 Feet

Show depth and thickness of all water, oil and gas formations.

OIL, GAS OR WATER RECORDS

CASING RECORD

FORMATION	CONTENT	FROM	TO	SIZE	PUT IN	PULLED OUT
				8-5/8"	308.67'	None

Describe in detail the manner in which the well was plugged, indicating where the mud fluid was placed and the method or methods used in introducing it into the hole. If cement or other plugs were used, state the character of same and depth placed, from _____ feet to _____ feet for each plug set.

Set plug @ 540', spot with 20 sacks cement, mud back to 240', spot with 20 sacks cement, mud back to 40', set bridge and capped with 10 sacks cement. Plugging completed 3:45 p.m. 4-28-65.

RECEIVED
STATE CORPORATION COMMISSION

MAY 4 1965
5-4-65

CONSERVATION DIVISION
Wichita, Kansas

(If additional description is necessary, use BACK of this sheet)

Name of Plugging Contractor Rains & Williamson Oil Co.

Address 1425 Wichita Plaza, Wichita 2, Kansas

STATE OF KANSAS COUNTY OF SEDGWICK, ss.

Wilson Rains (employee of owner) or (owner or operator) of the above-described

well, being first duly sworn on oath, says: That I have knowledge of the facts, statements, and matters herein contained and the log of the above-described well as filed and that the same are true and correct. So help me God.

(Signature) Wilson Rains

1425 Wichita Plaza, Wichita 2, Kansas
(Address)

SUBSCRIBED AND SWORN TO before me this 30th day of April, 19 65

My commission expires January 8, 1968

Shirley Keck
Notary Public.

15133-30340-0000

WELL NO. 1 COUNTY Ness SEC. 13, TWP. 20S, RGE. 22W FARM NAME Janke

Form 1002A

OKLAHOMA CORPORATION COMMISSION
OKLAHOMA OIL AND GAS CONSERVATION DEPARTMENT

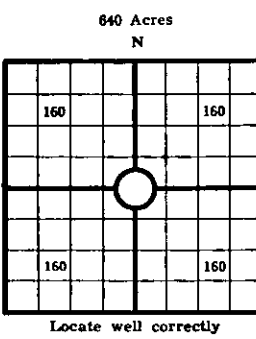

WELL RECORD
COUNTY Ness, SEC. 13, TWP. 20S, RGE. 22W
COMPANY OPERATING E. Lyle Johnson
OFFICE ADDRESS 626 N. Broadway, Moore, Okla.
FARM NAME Janke WELL NO. 1
DRILLING STARTED 4-20-65 DRILLING FINISHED 4-28-65
DATE OF FIRST PRODUCTION None COMPLETED 4-28-65
WELL LOCATED 1/4 SW 1/4 SW 660, North of South
Line and 660 ft. East of West Line of Quarter Section
Elevation (Relative to sea level) DERRICK FLOOR 2246 BROWN 2239.5
CHARACTER OF WELL (Oil, gas or dryhole) Dry hole

OIL OR GAS SANDS OR ZONES

Name	From	To	Name	From	To
1 <u>None</u>			4		
2			5		
3			6		

Perforating Record If Any

Shot Record

Formation	From	To	No. of Shots	Formation	From	To	Size of Shot
<u>None</u>							

CASING RECORD

Amount Set				Amount Pulled				Packer Record			
Size	Wt.	Thds.	Make	Ft.	In.	Ft.	In.	Size	Length	Depth Set	Make
8 <u>5/8</u>	<u>28#</u>	<u>8</u>	<u>used</u>								

Liner Record: Amount _____ Kind _____ Top _____ Bottom _____

CEMENTING AND MUDDING

Size	Amount Set		Sacks Cement	Chemical		Method of Cementing	Amount	Mudding Method	Results (See Note)
	Ft.	In.		Gal.	Make				
8 <u>5/8</u>	<u>307</u>		<u>180</u>	<u>circulated</u>					

Note: What method was used to protect sands if outer strings were pulled? _____

NOTE: Were bottom hole plugs used? _____ If so, state kind, depth set and results obtained _____

TOOLS USED

Rotary Tools were used from 0 feet to TD Cable tools were used from _____ feet to _____ feet, and from _____ feet to _____ feet, and from _____ feet to _____ feet
Type Rig _____

INITIAL PRODUCTION TEST

Describe initial test: whether by flow through tubing or casing or by pumping None
Amount of Oil Production _____ bbls. Size of choke, if any _____ Length of test _____ Water Production _____ bbls. Gravity of oil _____ Type of Pump if pump is used, describe _____

Give detailed description and thickness of all formations drilled through, contents of sand, whether dry, water, oil or gas.

Formation	Top	Bottom	Formation	Top	Bottom
Soil, Clay & Rock					
	0	40			
Shale	40	255			
Sand	255	275			
Shale	275	802			
Anhydrite (Blaine)	802	811			
Shale	811	895			
Sand (Dakota)	895	1125			
Shale & Red-Bed	1125	1459			
Anhydrite	1459	1485			
Shale	1485	1600			
Shale & Shells	1600	1850			
Shale & Lime	1850	2550			
Lime	2550	2860			
Lime & Shale	2860	3210			
Shale & Lime	3210	3560			
Lime & Shale	3560	3845			
Lime	3845	4375			
Lime & Chert	4375	4413			
			Total Depth		

(DRILLERS LOG ATTACHED)

RECEIVED
STATE CORPORATION COMMISSION
MAY 4 1965

CONSERVATION DIVISION
Wichita, Kansas

I, the undersigned, being first duly sworn upon oath, state that this well record is true, correct and complete according to the records of this office and to the best of my knowledge and belief.

E. Lyle Johnson
Name and title of representative of company

Subscribed and sworn to before me this 3rd day of May, 1965
My Commission expires 9-7-65
Louis Trammell
Notary Public.

15-135-30340-0000

ROTARY DRILLING LOG

OPERATOR: E. Lyle Johnson
No. 1 JANKE
C SW SW Section 13-20S-22W
Ness County, Kansas

CONTRACTOR: Rains & Williamson
Oil Co.
COMMENCED: 4-20-65
COMPLETED: 4-28-65

REMARKS: Set 8-5/8" surface
@ 308.67' with 180 sacks
GL3 cement.

FORMATIONS:

Soil, Clay & Rock	40'
Shale	255'
Sand	275'
Shale	802'
Anhydrite (Blaine)	811'
Shale	895'
Sand (Dakota)	1125'
Shale & Red Bed	1459'
Anhydrite	1485'
Shale	1600'
Shale & Shells	1850'
Shale & Lime	2550'
Lime	2860'
Lime & Shale	3210'
Shale & Lime	3560'
Lime & Shale	3845'
Lime	4375'
Lime & Chert	4413'
 Rotary Total Depth (D&A)	 4413'

RECEIVED
STATE CORPORATION COMMISSION

MAY 4 1965

CONSERVATION DIVISION
Wichita, Kansas

We certify the above log is true
and correct to the best of our
knowledge and belief.

RAINS & WILLIAMSON OIL CO.

Wilson Rains
Wilson Rains, Partner

Subscribed and sworn to before me, a Notary Public in and for the State
of Kansas, County of Sedgwick, this 30th day of April, 1965.

My Commission Expires:
January 8, 1968

Shirley Keck
Shirley Keck, Notary Public