

STATE CORPORATION COMMISSION OF KANSAS
OIL & GAS CONSERVATION DIVISION
WELL COMPLETION OR RECOMPLETION FORM
ACO-1 WELL HISTORY
DESCRIPTION OF WELL AND LEASE

API NO. 15-15-077-21,172-000
County Harper
SE/4 East
.50'. E. of .C. Sec. 26. Twp 32S. Rge. 9. West

Operator: License # 03295
Name David W. Clothier
Address 225 North Market
Suite 333
City/State/Zip Wichita, KS 67202

1320 Ft North from Southeast Corner of Section
1270 Ft West from Southeast Corner of Section
(Note: Locate well in section plat below)

Purchaser n/a

Lease Name Brown Well # 1-26

Operator Contact Person David W. Clothier
Phone 316-267-9227

Field Name Sullivan, EAST Field Prospect

Producing Formation Stalnaker

Elevation: Ground 1440' KB 1447'

Contractor: License # 5929
Name Duke Drilling Co., Inc.

Wellsite Geologist David W. Clothier
Phone 316-267-9227

Designate Type of Completion
 New Well Re-Entry Workover

Oil SWD Temp Abd
 Gas SI Inj Delayed Comp.
 Dry Other (Core, Water Supply etc.)

If OWVO: old well info as follows:
Operator
Well Name
Comp. Date
Old Total Depth

RECEIVED
STATE CORPORATION COMMISSION
JUL 1 1988
7-1-88
CONSERVATION DIVISION
Wichita, Kansas

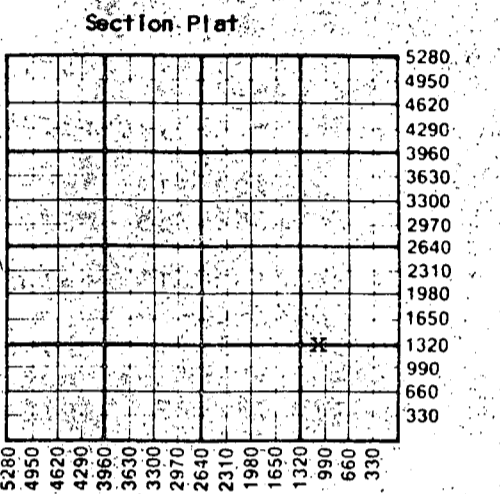

WATER SUPPLY INFORMATION
Disposition of Produced Water: Disposal Repressuring
Docket #

WELL HISTORY
Drilling Method:
 Mud Rotary Air Rotary Cable

..3-02-88.. ..3-08-88... ..3-29-88...
Spud Date Date Reached TD Completion Date
..4,000..ft. ..3920..ft..
Total Depth PBD

Amount of Surface Pipe Set and Cemented at 250 feet
Multiple Stage Cementing Collar Used? Yes No
If yes, show depth set.....feet
If alternate 2 completion, cement circulated
from.....feet depth to.....w/.....SX, cmt
Cement Company Name BJ-Titan Services Co.
Invoice # QN088

Questions on this portion of the ACO-1 call:
Water Resources Board (913) 296-3717
Source of Water:
Division of Water Resources Permit # n/a
Groundwater.....Ft North from Southeast Corner
(Well)Ft West from Southeast Corner of
Sec Twp Rge East West
Surface Water.....Ft North from Southeast Corner
(Stream, pond etc).....Ft West from Southeast Corner
Sec Twp Rge East West
Other (explain) Virgil J. Brown, landowner pond (purchased from city, R.W.D. #)

INSTRUCTIONS: This form shall be completed in triplicate and filed with the Kansas Corporation Commission, 200 Colorado Derby Building, Wichita, Kansas 67202, within 120 days of the spud date of any well. Rule 82-3-130, 82-3-107 and 82-3-106 apply. Information on side two of this form will be held confidential for a period of 12 months if requested in writing and submitted with the form. See rule 82-3-107 for confidentiality in excess of 12 months. One copy of all wireline logs and drillers time log shall be attached with this form. Submit CP-4 form with all plugged wells. Submit CP-111 form with all temporarily abandoned wells.

All requirements of the statutes, rules and regulations promulgated to regulate the oil and gas industry have been fully complied with and the statements herein are complete and correct to the best of my knowledge.



Signature David W. Clothier
Date 6/20/88
Sworn to before me this 28th day of June
Notary Public Martha Calvert Clothier
Date Commission Expires 10/14/90

K.C.C. OFFICE USE ONLY
 Letter of Confidentiality Attached
 Wireline Log Received
 Drillers Time Log Received
Distribution
 KCC SWD/Rep NGPA
 KGS Plug Other (Specify)
7-11-88