

STATE OF KANSAS
STATE CORPORATION COMMISSION

15-135-21237-0000

WELL PLUGGING RECORD

Give All Information Completely
Make Required Affidavit
Mail or Deliver Report to
Conservation Division
State Corporation Comm.
245 North Water
Wichita, KS 67202

NESS County. Sec. 11 Twp 20S Rge. 22W E/W
Location as "NE/CNW 1/4 SW 1/4" or footage from lines
NE NE
Lease Owner Dane G. Hansen Trust
Lease Name Uehling Well No. 1
Office Address Logan, Kansas 67646

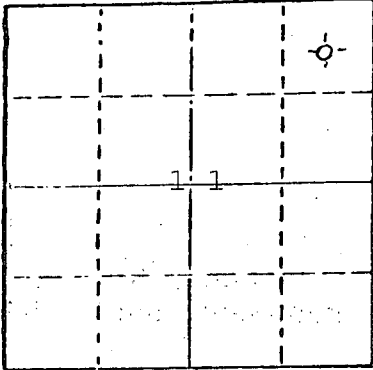

Locate well correctly on above
Section Plat

Character of Well (Completed as Oil, Gas or Dry Hole)
Dry Hole
Date Well completed August 8 1976
Application for plugging filed August 8 1976
Application for plugging approved August 8 1976
Plugging commenced August 8 1976
Plugging completed August 8 1976
Reason for abandonment of well or producing formation
Too low structurally
If a producing well is abandoned, date of last production 19

Was permission obtained from the Conservation Division or
its agents before plugging was commenced? Yes

Name of Conservation Agent who supervised plugging of this well Leo F Massey
Producing formation Depth to top Bottom Total Depth of Well 475
Show depth and thickness of all water, oil and gas formations.

OIL, GAS OR WATER RECORDS

CASING RECORD

FORMATION	CONTENT	FROM	TO	SIZE	PUT IN	PULLED OUT

Describe in detail the manner in which the well was plugged, indicating where the mud fluid
was placed and the method or methods used in introducing it into the hold. If cement or other
plugs were used, state the character of same and depth placed, from feet to
feet for each plug set.

Filled with heavy mud to 600'. Set
plug. Put in 50 sacks cement. Filled
with heavy mud to 240'. Set plug. Put
in 25 sacks cement. Filled with heavy
mud to 40'. Set Plug. Filled to top
with 1 sack hulls & 10 sacks cement plus
2% Gel.

STATE RECEIVED
CORPORATION COMMISSION
AUG 20 1976

(If additional description is necessary, use BACK of this sheet)

Name of Plugging Contractor C-G Drilling Co.
1107 Union National Building, Wichita, Kansas 67202

STATE OF KANSAS COUNTY OF SEDGWICK ss.
G. F. Galloway

(employee of owner) or (owner or operator) of the above-described
well, being first duly sworn on oath, says: That I have knowledge of the facts, statements, and matters herein contained and the log of the
above-described well as filed and that the same are true and correct. So help me God.

(Signature) G. F. Galloway

G. F. Galloway 1107 Union National Bldg.
(Address)

Subscribed and Sworn to before me this 13th day of August 1976

My commission expires December 8, 1979

Phyllis Buchanan
Phyllis Buchanan Notary Public.

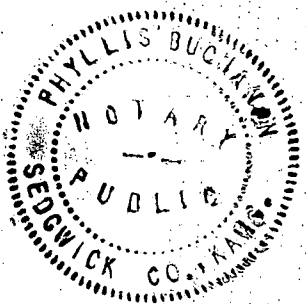

KANSAS DRILLERS LOG

S. 11 T. 20S R. 22W ^E WEST

Loc. NE NE

County NESS

API No. 15 — 135 — 21237-0000
County Number

Operator
 DANE G HANSEN TRUST

Address
 LOGAN, KANSAS 67646

Well No. 1 Lease Name UEHLING #1

Footage Location
660 feet from (N) ~~XX~~ line 660 feet from (E) ~~W~~ line

Principal Contractor C-G DRILLING CO. Geologist J. JESPERSEN

Spud Date JULY 30, 1976 Total Depth 4475 P.B.T.D.

Date Completed AUGUST 8, 1976 Oil Purchaser

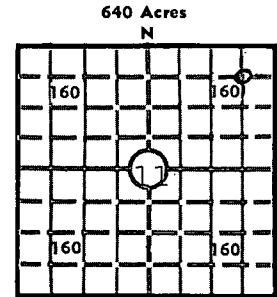

Elev.: Gr. _____

DF _____ KB 2271

CASING RECORD

Report of all strings set — surface, intermediate, production, etc.

Purpose of string	Size hole drilled	Size casing set (in O.D.)	Weight lbs/ft.	Setting depth	Type cement	Sacks	Type and percent additives
SURFACE	12 1/4"	8 5/8"	32#	465.89'	COMMON	225	2% GEL 3% CA CL

LINER RECORD

PERFORATION RECORD

Top, ft.	Bottom, ft.	Sacks cement	Shots per ft.	Size & type	Depth interval

TUBING RECORD

Size	Setting depth	Packer set at

ACID, FRACTURE, SHOT, CEMENT SQUEEZE RECORD

Amount and kind of material used	Depth interval treated

INITIAL PRODUCTION

Date of first production		Producing method (flowing, pumping, gas lift, etc.)			
RATE OF PRODUCTION PER 24 HOURS		Oil	Gas	Water	Gas-oil ratio
		bbls.	MCF	bbls.	bbls./MCF
Disposition of gas (vented, used on lease or sold)				Producing interval (s)	

RECEIVED
 STATE CORPORATION COMMISSION
 AUG 20 1976
 CONSERVATION DIVISION
 WICHITA, KANSAS

INSTRUCTIONS: As provided in KCC Rule 82-2-125, within 90 days after completion of a well, one completed copy of this Drillers Log shall be transmitted to the State Geological Survey of Kansas, 4150 Monroe Street, Wichita, Kansas 67209. Copies of this form are available from the Conservation Division, State Corporation Commission, 3830 So. Meridian (P.O. Box 17027), Wichita, Kansas 66217. Phone AC 316-522-2206. If confidential custody is desired, please note Rule 82-2-125. Drillers Logs will be on open file in the Oil and Gas Division, State Geological Survey of Kansas, Lawrence, Kansas 66044.

Operator
DANE G HANSEN TRUST

DESIGNATE TYPE OF COMP.: OIL, GAS,
DRY HOLE, SWDW, ETC.:
DRY HOLE

Well No.
1

Lease Name
UEHLING

S 11 T 20 S R 22 W E W

WELL LOG

Show all important zones of porosity and contents thereof; cored intervals, and all drill-stem tests, including depth interval tested, cushion used, time tool open, flowing and shut-in pressures, and recoveries.

SHOW GEOLOGICAL MARKERS, LOGS RUN, OR OTHER DESCRIPTIVE INFORMATION.

FORMATION DESCRIPTION, CONTENTS, ETC.	TOP	BOTTOM	NAME	DEPTH
SHALE	0	400		
SAND & SHALE	400	500		
SHALE	500	960		
SAND	960	1180		
SHALE	1180	1285		
RED BED & SHALE	1285	1519		
ANHYDRITE	1519	1559		
SHALE & SHELLS	1559	2845		
LIME & SHALE	2845	3950		
LIME	3950	4070		
LIME & SHALE	4070	4190		
LIME	4190	4425		
MISSISSIPPI	4425	4475		
RTD		4475		
DST #1 4338'-4360' 30-30-30-30 Rec. 20' mud IBHP 152# FBHP 65# IFP 21# FFP 21#				
DST #2 4390'-4435' 30-30-30-30- Rec 5' mud IBHP 65# FBHP 43# IFP 43# FFP 43#				

USE ADDITIONAL SHEETS, IF NECESSARY, TO COMPLETE WELL RECORD.

Date Received	<i>Phyllis Buchanan</i>
	Phyllis Buchanan <small>Signature</small>
	Office Manager <small>Title</small>
	August 16, 1976
	<small>Date</small>