

FOR KCC USE:

EFFECTIVE DATE: 5-16-94

DISTRICT #

SEA? Yes No

**XCORRECTION**

State of Kansas

NOTICE OF INTENTION TO DRILL

Must be approved by the K.C.C. five (5) days prior to commencing well

FORM C-1 7/93  
FORM MUST BE TYPED  
FORM MUST BE SIGNED  
ALL BLANKS MUST BE FILLED

Expected Spud Date 5/30/94 Approx 100' SW of NE SW 1/4 Sec 7 Twp 33 S Rg 12W East: 990 feet from South / North line of Section 4390 feet from East / West line of Section

OPERATOR: License # 8061  
Name: Oil Producers, Inc. of Kansas  
Address: P.O. Box 8647  
City/State/Zip: Wichita, Ks, 67208  
Contact Person: John S. Weir  
Phone: 316.681-0231

CONTRACTOR: License #: 5929  
Name: Duke Drilling Co., Inc.

Well Drilled For: Well Class: Type Equipment:  
Oil Enh Rec Infield Mud Rotary  
Gas Storage Pool Ext. Air Rotary  
CWWD Disposal Wildcat Cable  
Seismic: # of Holes Other

If CWWD: old well information as follows:  
Operator:  
Well Name:  
Comp. Date: Old Total Depth

Directional, Deviated or Horizontal wellbore? yes X no  
If yes, true vertical depth:  
Bottom Hole Location:

IS SECTION X REGULAR IRREGULAR?  
(NOTE: Locate well on the Section Plat on Reverse Side)  
County: Barber  
Lease Name: Alexander B. Well #: #2  
Field Name:  
Is this a Prorated/Spaced Field? yes X no  
Target Formation(s): Douglas Sand  
Nearest lease or unit boundary: 990  
Ground Surface Elevation:  
Water well within one-quarter mile: yes X no  
Public water supply well within one mile: yes X no  
Depth to bottom of fresh water: 80  
Depth to bottom of usable water: 280  
Surface Pipe by Alternate: X 1 2  
Length of Surface Pipe Planned to be set: (250) 200  
Length of Conductor pipe required: NA  
Projected Total Depth: 3900  
Formation at Total Depth: Douglas Sand  
Water Source for Drilling Operations:  
... well ... farm pond ... other  
DVR Permit #:  
Will Cores Be Taken?: yes no  
If yes, proposed zone:

AFFIDAVIT IS 15-007-22442

The undersigned hereby affirms that the drilling, completion and eventual plugging of this well will comply with K.S.A. 55 101, et. seq.  
It is agreed that the following minimum requirements will be met:

RECEIVED  
STATE COMMISSION  
MAY 11 1994  
CONSERVATION DIVISION  
WICHITA, KANSAS

- 1. Notify the appropriate district office prior to spudding of well;
- 2. A copy of the approved notice of intent to drill shall be posted on each drilling rig;
- 3. The minimum amount of surface pipe as specified below shall be set by circulating cement to the top. In all cases surface pipe shall be set through all unconsolidated materials plus a minimum of 20 feet into the underlying formation;
- 4. If the well is dry hole, an agreement between the operator and the district office on plug length and placement is necessary prior to plugging;
- 5. The appropriate district office will be notified before well is either plugged or production casing is cemented in;
- 6. IF AN ALTERNATE II COMPLETION, PRODUCTION PIPE SHALL BE CEMENTED FROM BELOW ANY USABLE WATER TO SURFACE WITHIN 120 DAY OF SPUD DATE. IN ALL CASES, NOTIFY DISTRICT OFFICE PRIOR TO ANY CEMENTING.

I hereby certify that the statements made herein are true and to the best of my knowledge and belief.  
Date: 5/10/94 Signature of Operator or Agent: John S. Weir Title: President

FOR KCC USE:  
API # 15- 007-22442-00-00  
Conductor pipe required NONE feet  
Minimum surface pipe required 200 feet per Alt. X  
Approved by: CB 5-11-94  
This authorization expires: 11-11-94  
(This authorization void if drilling not started within 6 months of effective date.)  
Spud date: Agent:

REMEMBER TO:

- File Drill Pit Application (form CDP-1) with Intent to Drill;
- File Completion Form ACO-1 within 120 days of spud date;
- File acreage attribution plat according to field proration orders;
- Notify appropriate district office 48 hours prior to workover or re-entry;
- Submit plugging report (CP-4) after plugging is completed;
- Obtain written approval before disposing or injecting salt water.

Mail to: Conservation Division, 200 Colorado Derby Building, 202 W. First St., Wichita, Kansas 67202-1286.

7  
33  
12

IN ALL CASES PLOT THE INTENDED WELL ON THE PLAT BELOW

PLAT OF ACREAGE ATTRIBUTABLE TO A WELL IN A PRORATED OR SPACED FIELD

If the intended well is in a prorated or spaced field, please fully complete this side of the form. If the intended well is in a prorated or spaced field complete the plat below showing that the well will be properly located in relationship to other wells producing from the common source of supply. Please show all the wells within 1 mile of the boundaries of the proposed acreage attribution unit for gas wells and within 1/2 mile of the boundaries of the proposed acreage attribution unit for oil wells.

API NO. 15- \_\_\_\_\_  
 OPERATOR Oil Producers, Inc. of Kansas LOCATION OF WELL: COUNTY Barber  
 LEASE Alexander B 990 feet from south/~~north~~ line of section  
 WELL NUMBER #2 4390 feet from east/~~west~~ line of section  
 FIELD \_\_\_\_\_ SECTION 7 TWP 33X RG 12W

NUMBER OF ACRES ATTRIBUTABLE TO WELL \_\_\_\_\_ IS SECTION x REGULAR or \_\_\_\_\_ IRREGULAR  
 QTR/QTR/QTR OF ACREAGE \_\_\_\_\_ IF SECTION IS IRREGULAR, LOCATE WELL FROM NEAREST  
CORNER BOUNDARY.

Section corner used: NE NW SE SW

PLAT

(Show location of the well and shade attributable acreage for prorated or spaced wells.)  
 (Show footage to the nearest lease or unit boundary line.)

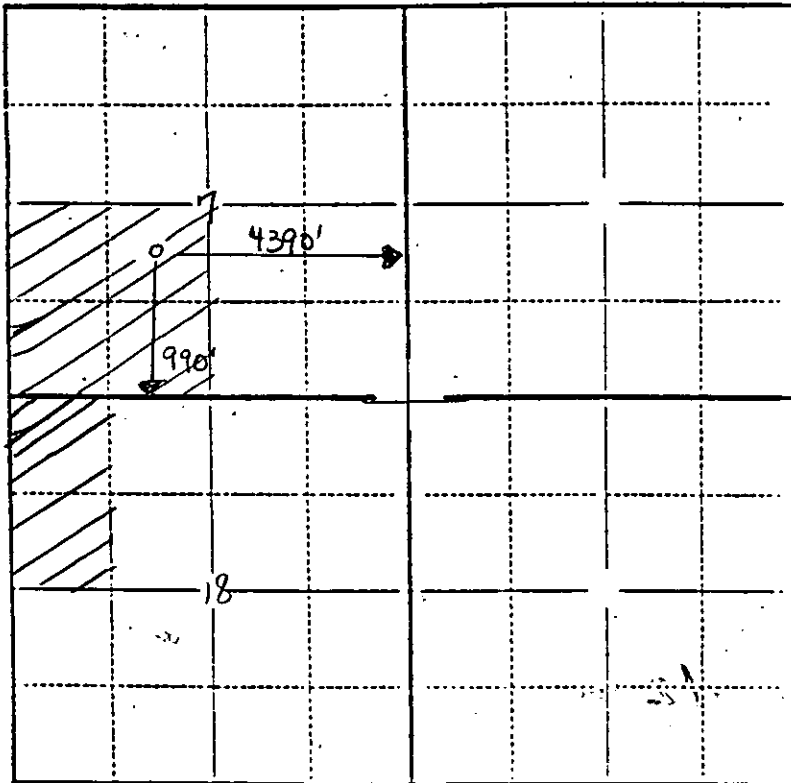

(240' ACRE GAS Unit)

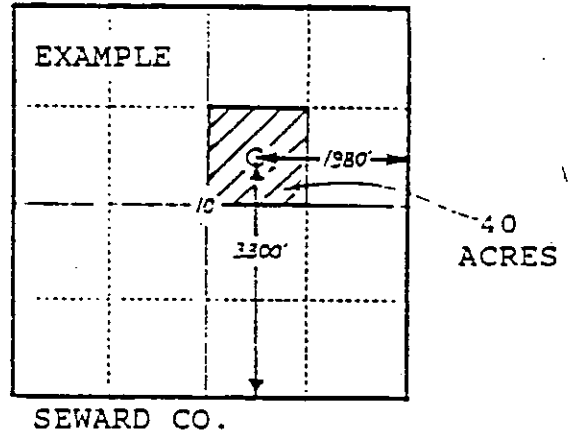

In plotting the proposed location of the well, you must show:

- 1) The manner in which you are using the depicted plat by identifying section lines, i.e. 1 section, 1 section with 8 surrounding sections, 4 sections, etc.;
- 2) the distance of the proposed drilling location from the section's south/north and east/west lines; and
- 3) the distance to the nearest lease or unit boundary line.