

FOR KCC USE:

PICK-UP
CALL WHEN READY
DEEAMN

FORM C-1 7/91
FORM MUST BE TYPED
FORM MUST BE SIGNED
ALL BLANKS MUST BE FILLED

EFFECTIVE DATE: 5-16-94

State of Kansas

NOTICE OF INTENTION TO DRILL

Must be approved by the K.C.C. five (5) days prior to commencing well

DISTRICT # 1

SGA? Yes No

Expected Spud Date May 18, 1994
month day year

Spot NW-SW Sec 3 Twp 33S Rg 11 East West

OPERATOR: License # 5255
Name: McGinness Oil Company
Address: 150 N. Main, Suite 1026
City/State/Zip: Wichita, KS 67202
Contact Person: Douglas H. McGinness
Phone: (316) 267-6065

2580 feet from South / West line of Section
550 feet from West line of Section
IS SECTION X REGULAR IRREGULAR

(NOTE: Locate well on the Section Plat on Reverse Side)

County: Barber
Lease Name: Inslee Well #: 1
Field Name: Rhodes

Is this a Prorated/Spaced Field? yes X no

Target Formation(s): Mississippi

Nearest lease or unit boundary: 550'

Ground Surface Elevation: 1517 feet MSL

Water well within one-quarter mile: yes X no

Public water supply well within one mile: yes X no

Depth to bottom of fresh water: 80'

Depth to bottom of usable water: 180'

Surface Pipe by Alternate: X 1 2

Length of Surface Pipe Planned to be set: 200'

Length of Conductor pipe required: None

Projected Total Depth: 4500'

Formation at Total Depth: Mississippi

Water Source for Drilling Operations:

well X farm pond other

DWR Permit #: _____

Will Cores Be Taken? yes X no

If yes, proposed zone: _____

Well Drilled For: Well Class: Type Equipment:
X Oil ... Enh Rec X Infield X Mud Rotary
X Gas ... Storage ... Pool Ext. ... Air Rotary
... OWD Disposal ... Wildcat ... Cable
... Seismic; ... # of Holes ... Other

If OWD: old well information as follows:
Operator: _____
Well Name: _____
Comp. Date: _____ Old Total Depth _____

Directional, Deviated or Horizontal wellbore? yes X no

If yes, true vertical depth: _____

Bottom Hole Location: _____

AFFIDAVIT

The undersigned hereby affirms that the drilling, completion and eventual plugging of this well will comply with K.S.A. 55-101, et. seq.

It is agreed that the following minimum requirements will be met:

- 1. Notify the appropriate district office prior to spudding of well;
- 2. A copy of the approved notice of intent to drill shall be posted on each drilling rig;
- 3. The minimum amount of surface pipe as specified below shall be set by circulating cement to the top; in all cases surface pipe shall be set through all unconsolidated materials plus a minimum of 20 feet into the underlying formation;
- 4. If the well is dry hole, an agreement between the operator and the district office on plug length and placement is necessary prior to plugging;
- 5. The appropriate district office will be notified before well is either plugged or production casing is cemented in;
- 6. IF AN ALTERNATE II COMPLETION, PRODUCTION PIPE SHALL BE CEMENTED FROM BELOW ANY USABLE WATER TO SURFACE WITHIN 120 DAYS OF SPUD DATE. IN ALL CASES, NOTIFY DISTRICT OFFICE PRIOR TO ANY CEMENTING.

I hereby certify that the statements made herein are true and to the best of my knowledge and belief.

Date: 05-10-94 Signature of Operator or Agent: Douglas H. McGinness Title: President

FOR KCC USE:
API # 15- 007 - 22443 - 00 - 00
Conductor pipe required NONE feet
Minimum surface pipe required 200 feet per Alt. ① X
Approved by: CB 5-11-94
This authorization expires: 11-11-94
(This authorization void if drilling not started within 6 months of effective date.)
Spud date: _____ Agent: _____

REMEMBER TO:

- File Drill Pit Application (form CDP-1) with Intent to Drill;
- File Completion Form ACO-1 within 120 days of spud date;
- File acreage attribution plat according to field proration orders;
- Notify appropriate district office 48 hours prior to workover or re-entry;
- Submit plugging report (CP-4) after plugging is completed;
- Obtain written approval before disposing or injecting salt water.

Mail to: Conservation Division, 200 Colorado Derby Building, 202 W. First St., Wichita, Kansas 67202-1286.

RECEIVED
STATE CORPORATION COMMISSION
MAY 11 1994

CONSERVATION DIVISION
Wichita, Kansas

W
33
11

IN ALL CASES PLOT THE INTENDED WELL ON THE PLAT BELOW

PLAT OF ACREAGE ATTRIBUTABLE TO A WELL IN A PRORATED OR SPACED FIELD

If the intended well is in a prorated or spaced field, please fully complete this side of the form. If the intended well is in a prorated or spaced field complete the plat below showing that the well will be properly located in relationship to other wells producing from the common source of supply. Please show all the wells within 1 mile of the boundaries of the proposed acreage attribution unit for gas wells and within 1/2 mile of the boundaries of the proposed acreage attribution unit for oil wells.

API NO. 15- _____
 OPERATOR _____
 LEASE _____
 WELL NUMBER _____
 FIELD _____

LOCATION OF WELL: COUNTY _____
 _____ feet from south/north line of section
 _____ feet from east/west line of section
 SECTION _____ TWP _____ RG _____

NUMBER OF ACRES ATTRIBUTABLE TO WELL _____
 QTR/QTR/QTR OF ACREAGE _____

IS SECTION _____ REGULAR or _____ IRREGULAR
IF SECTION IS IRREGULAR, LOCATE WELL FROM NEAREST CORNER BOUNDARY.

Section corner used: _____ NE _____ NW _____ SE _____ SW

PLAT

(Show location of the well and shade attributable acreage for prorated or spaced wells.)
 (Show footage to the nearest lease or unit boundary line.)

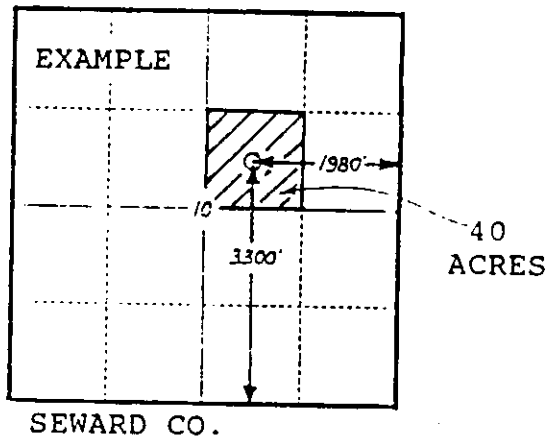
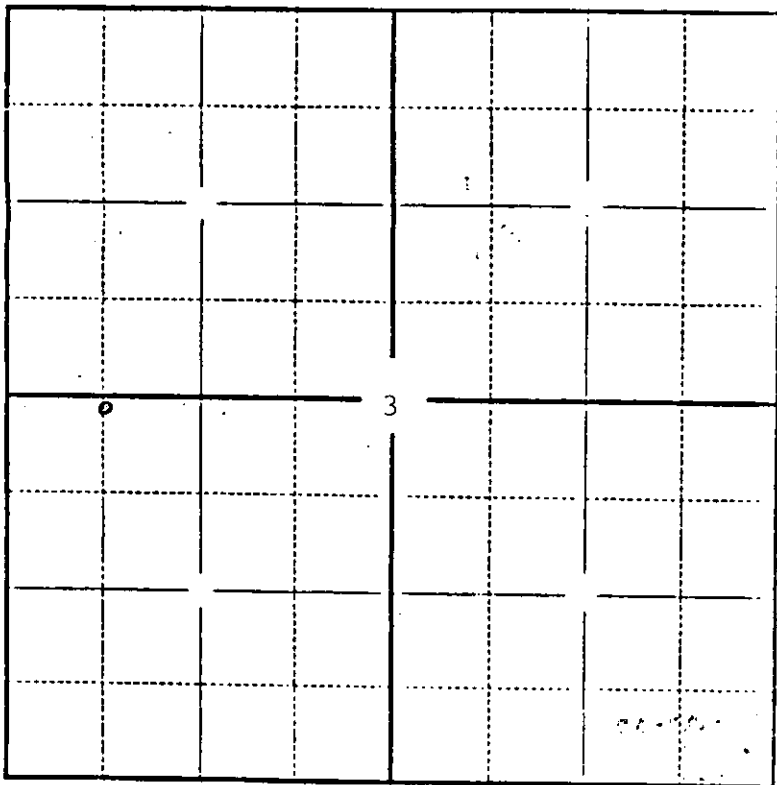

In plotting the proposed location of the well, you must show:

- 1) The manner in which you are using the depicted plat by identifying section lines, i.e. 1 section, 1 section with 8 surrounding sections, 4 sections, etc.;
- 2) the distance of the proposed drilling location from the section's south/north and east/west lines; and
- 3) the distance to the nearest lease or unit boundary line.