

FOR KCC USE:

EFFECTIVE DATE: 11-9-91

DISTRICT #

SGA? Yes No

State of Kansas

NOTICE OF INTENTION TO DRILL

Must be approved by the K.C.C. five (5) days prior to commencing well

SKM FORM C-1 7/91
FORM MUST BE TYPED
FORM MUST BE SIGNED
ALL BLANKS MUST BE FILLED

Expected Spud Date ... November 9, 1991 ... 150' SW NW 1/4, Sec 31, Twp 19 S, Rg 19 X West
Spot _____ East _____
month day year

OPERATOR: License # 30846
Name: Ron and Dan's Oil Co.
Address: 1570 West Alameda
City/State/Zip: Denver, CO 80223
Contact Person: James W. Thompson
Phone: 316-269-0400

4514 feet from South / ~~North~~ line of Section
4726 feet from East / ~~West~~ line of Section
IS SECTION X REGULAR _____ IRREGULAR?

(NOTE: Locate well on the Section Plat on Reverse Side)
County: Rush
Lease Name: Maresch Well #: 1
Field Name: Shiley North
Is this a Prorated/Spaced Field? X yes ___ no

CONTRACTOR: License #: 5929
Name: Duke Drilling Co.

Target Formation(s): Cherokee
Nearest lease or unit boundary: 766'
Ground Surface Elevation: 2249 feet MSL
Water well within one-quarter mile: ___ yes X no

Well Drilled For: Well Class: Type Equipment:
X Oil ___ Enh. Rec X Infield X Mud Rotary
___ Gas ___ Storage ___ Pool Ext. ___ Air Rotary
___ OWD ___ Disposal ___ Wildcat ___ Cable
___ Seismic; ___ # of Holes ___ Other
___ Other

Public water supply well within one mile: ___ yes X no
Depth to bottom of fresh water: ~~200~~ 280'
Depth to bottom of usable water: ~~200~~ 650'
Surface Pipe by Alternate: X 1 ___ 2

If OWD: old well information as follows:
Operator: _____
Well Name: _____
Comp. Date: _____ Old Total Depth _____

Length of Surface Pipe Planned to be set: 1340'
Length of Conductor pipe required: 0
Projected Total Depth: 4350'
Formation at Total Depth: Mississippian

Directional, Deviated or Horizontal wellbore? ___ yes X no
If yes, true vertical depth: _____
Bottom Hole Location: _____

Water Source for Drilling Operations:
___ well X farm pond ___ other
DWR Permit #: _____
Will Cores Be Taken? ___ yes X no
If yes, proposed zone: _____

AFFIDAVIT

The undersigned hereby affirms that the drilling, completion and eventual plugging of this well will comply with K.S.A. 55-101, et. seq.
It is agreed that the following minimum requirements will be met:

- 1. Notify the appropriate district office prior to spudding of well;
- 2. A copy of the approved notice of intent to drill shall be posted on each drilling rig;
- 3. The minimum amount of surface pipe as specified below shall be set by circulating cement to the top; in all cases surface pipe shall be set through all unconsolidated materials plus a minimum of 20 feet into the underlying formation;
- 4. If the well is dry hole, an agreement between the operator and the district office on plug length and placement is necessary prior to plugging;
- 5. The appropriate district office will be notified before well is either plugged or production casing is cemented in;
- 6. IF AN ALTERNATE TO COMPLETION, PRODUCTION PIPE SHALL BE CEMENTED FROM BELOW ANY USABLE WATER TO SURFACE WITHIN 120 DAYS OF SPUD DATE. IN ALL CASES, NOTIFY DISTRICT OFFICE PRIOR TO ANY CEMENTING.

I hereby certify that the statements made herein are true and to the best of my knowledge and belief.

Date: 10/29/91 Signature of Operator or Agent: James W. Thompson Title: Agent

FOR KCC USE:
API # 15- 165-21,593-0000
Conductor pipe required None feet
Minimum surface pipe required 20 feet per Alt. ①
Approved by: MW 11-4-91
This authorization expires: 5-4-92
(This authorization void if drilling not started within 6 months of effective date.)
Spud date: _____ Agent: _____

RECEIVED
COMMISSION

11-4-91
NOV 4 1991

CONSERVATION DIVISION
Wichita, Kansas

REMEMBER TO:

- File Drill Pit Application (form COP-1) with Intent to Drill;
- File Completion Form ACO-1 within 120 days of spud date;
- File acreage attribution plat according to field proration orders;
- Notify appropriate district office 48 hours prior to workover or re-entry;
- Submit plugging report (CP-4) after plugging is completed;
- Obtain written approval before disposing or injecting salt water.

Mail to: Conservation Division, 200 Colorado Derby Building, 202 W. First St., Wichita, Kansas 67202-1286.

31
19
1991

IN ALL CASES PLOT THE INTENDED WELL ON THE PLAT BELOW

PLAT OF ACREAGE ATTRIBUTABLE TO A WELL IN A PRORATED OR SPACED FIELD

If the intended well is in a prorated or spaced field, please fully complete this side of the form. If the intended well is in a prorated or spaced field complete the plat below showing that the well will be properly located in relationship to other wells producing from the common source of supply. Please show all the wells within 1 mile of the boundaries of the proposed acreage attribution unit for gas wells and within 1/2 mile of the boundaries of the proposed acreage attribution unit for oil wells.

API NO. 15- _____
 OPERATOR Ron and Dan's Oil Co.
 LEASE Maresch
 WELL NUMBER 1
 FIELD Shiley North

LOCATION OF WELL: COUNTY Rush
 4514 feet from south/north line of section
 4726 feet from east/west line of section
 SECTION 31 TWP 19S RG 19W

NUMBER OF ACRES ATTRIBUTABLE TO WELL 40
 QTR/QTR/QTR OF ACREAGE 150' SW CNW/4 NW/4

IS SECTION X REGULAR or IRREGULAR
IF SECTION IS IRREGULAR, LOCATE WELL FROM NEAREST CORNER BOUNDARY.

Section corner used: NE NW SE SW

PLAT

(Show location of the well and shade attributable acreage for prorated or spaced wells.)
 (Show footage to the nearest lease or unit boundary line.)

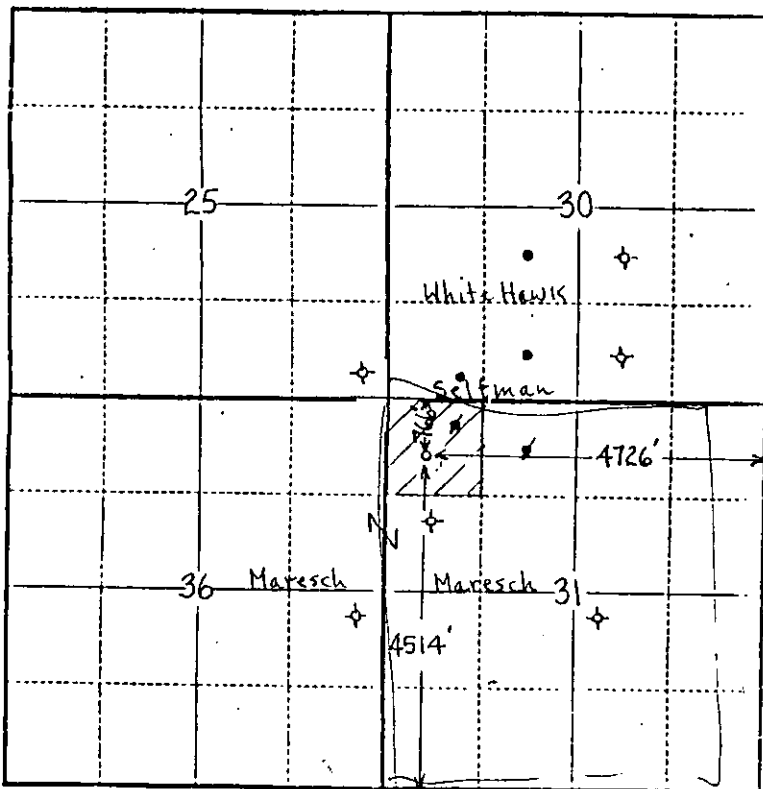

NW/4 Sec. 31-19S-19W and
 NE/4 Sec. 36-19S-19W are
 under the same lease.

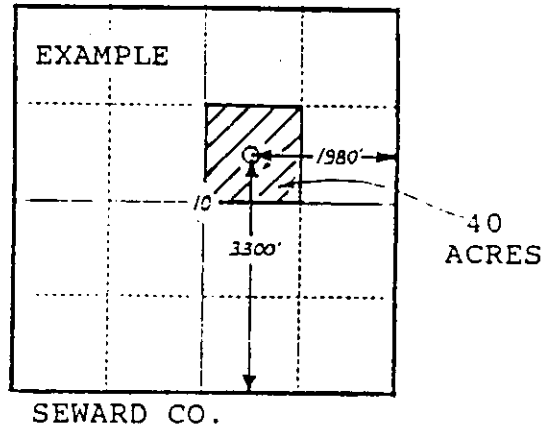

In plotting the proposed location of the well, you must show:

- 1) The manner in which you are using the depicted plat by identifying section lines, i.e. 1 section, 1 section with 8 surrounding sections, 4 sections, etc.;
- 2) the distance of the proposed drilling location from the section's south/north and east/west lines; and
- 3) the distance to the nearest lease or unit boundary line.