

STATE OF KANSAS  
STATE CORPORATION COMMISSION

Give All Information Completely  
Make Required Affidavit  
Mail or Deliver Report to:  
Conservation Division  
State Corporation Commission  
800 Biting Building  
Wichita, Kansas

WELL PLUGGING RECORD

NORTH

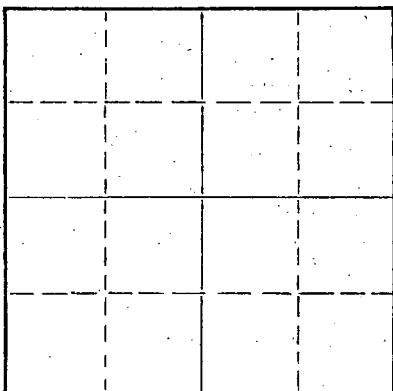

Locate well correctly on above  
Section Plat

Barber County, Sec. 5 Twp. 33S Rge. (E) 15 (W)  
Location as "NE/CNW/SW" or footage from lines SW SW SE SESESW AND KCC  
Lease Owner Jones, Shelburne & Farmer, Inc.  
Lease Name Winters Well No. 1  
Office Address Russell, Kansas  
Character of Well (completed as Oil, Gas or Dry Hole) Dry  
Date well completed 4-7 1955  
Application for plugging filed 4-7 1955  
Application for plugging approved 4-7 1955  
Plugging commenced 4-7 1955  
Plugging completed 4-7 1955  
Reason for abandonment of well or producing formation dry

If a producing well is abandoned, date of last production \_\_\_\_\_ 19\_\_\_\_  
Was permission obtained from the Conservation Division or its agents before plugging was commenced? Yes

Name of Conservation Agent who supervised plugging of this well Ruel Durkee  
Producing formation \_\_\_\_\_ Depth to top \_\_\_\_\_ Bottom \_\_\_\_\_ Total Depth of Well 5130 Feet  
Show depth and thickness of all water, oil and gas formations.

OIL, GAS OR WATER RECORDS

CASING RECORD

FORMATION	CONTENT	FROM	TO	SIZE	PUT IN	PULLED OUT
				8-5/8	515	None

Describe in detail the manner in which the well was plugged, indicating where the mud fluid was placed and the method or methods used in introducing it into the hole. If cement or other plugs were used, state the character of same and depth placed, from \_\_\_\_\_ feet to \_\_\_\_\_ feet for each plug set.

1. Filled hole with heavy mud to 450'
2. Pushed Halliburton plug to 450'
3. Dumped 1/2 sacks hulls on top of plug
4. Spotted 20 sacks cement through drill pipe on top of hulls
5. Filled hole to 35' with heavy mud
6. Pushed plug to 35' and dumped 1/2 sack hulls on top of plug
7. Mixed 10 sacks cement and filled hole to top with same

(If additional description is necessary, use BACK of this sheet)

Name of Plugging Contractor Jones, Shelburne & Farmer, Inc.  
Address Russell, Kansas

STATE OF KANSAS, COUNTY OF RUSSELL, ss.  
John O. Farmer (employee of owner) or (owner or operator) of the above-described

well, being first duly sworn on oath, says: That I have knowledge of the facts, statements, and matters herein contained and the log of the above-described well as filed and that the same are true and correct. So help me God.

(Signature) John O. Farmer  
Russell, Kansas (Address)

SUBSCRIBED AND SWORN TO before me this 14th day of April, 1955

My commission expires October 11, 1958

Lucille Fennedy Notary Public.

RECEIVED  
STATE CORPORATION COMMISSION

APR 15 1955

CONSERVATION DIVISION  
Wichita, Kansas

PLUGGING  
FILE SEC-5-T-33-15W  
BOOK PAGE 110 LINE 21

OPERATOR Jones, Shelburne & Farmer, Inc.

FORMATION RECORD

ADDRESS Russell, Kansas

Give detailed description and thickness of all formations drilled through; contents of sand, whether dry, water, oil or gas.

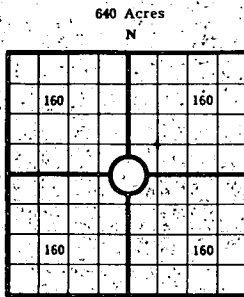
COUNTY Barber SEC 5 TWP 33 RGE 15COMPANY OPERATING Jones, Shelburne & Farmer, Inc.OFFICE ADDRESS Russell, KansasFARM NAME Winter WELL NO. 1DRILLING STARTED 3-15-1955 DRILLING FINISHED 4-6-1955

DATE OF FIRST PRODUCTION \_\_\_\_\_ COMPLETED \_\_\_\_\_

WELL LOCATED SW 1/4 SW 1/4 SE 1/4 North of SouthLine and SE ft. East of West Line of Quarter SectionElevation (Relative to sea level) DERRICK FLOOR 1798 GROUND 1757CHARACTER OF WELL (Oil, gas or dryhole) Dry

## OIL OR GAS SANDS OR ZONES

Name	From	To	Name	From	To
			4		
			5		
			6		

## Perforating Record If Any

## Shot Record

Formation	From	To	No. of Shots	Formation	From	To	Size of Shot

## CASING RECORD

Amount Set				Amount Pulled				Packer Record			
Size	Wt.	Thds.	Make	Ft.	In.	Ft.	In.	Size	Length	Depth Set	Make
5/8				485							

Liner Record: Amount \_\_\_\_\_ Kind \_\_\_\_\_ Top \_\_\_\_\_ Bottom \_\_\_\_\_

## CEMENTING AND MUDDING

Size	Amount Set		Sacks Cement	Chemical		Method of Cementing	Amount	Mudding Method	Results (See Note)
	Ft.	In.		Gal.	Make				
5/8	485		350						

Note: What method was used to protect sands if outer strings were pulled?

NOTE: Were bottom hole plugs used? If so, state kind, depth set and results obtained

## TOOLS USED

Rotary Tools were used from \_\_\_\_\_ feet to \_\_\_\_\_ Cable tools were used from \_\_\_\_\_ feet to \_\_\_\_\_ feet, and from \_\_\_\_\_ feet to \_\_\_\_\_ feet, and from \_\_\_\_\_ feet to \_\_\_\_\_ feet to \_\_\_\_\_

Type of Rig \_\_\_\_\_

## INITIAL PRODUCTION TEST

Describe initial test: whether by flow through tubing or casing or by pumping \_\_\_\_\_

Amount of Oil Production \_\_\_\_\_ bbls. Size of choke, if any \_\_\_\_\_ Length of test \_\_\_\_\_ Water

Production \_\_\_\_\_ bbls. Gravity of oil \_\_\_\_\_ Type of Pump if pump is used, describe \_\_\_\_\_

Formation	Top	Bottom	Formation	Top	Bottom
Surface Clay & Shale	0	190			
Sand	190	250			
Shale & shells	250	1385			
Shale & shells	1385	1735			
Shale & lime	1735	1920			
Lime & shale	1920	2800			
Shale & lime	2800	3528			
Lime & shale	3528	3655			
Shale & lime	3655	3716			
Lime & shale	3716	3890			
Shale & lime	3890	3960			
Lime & shale	3960	4215			
Lime	4215	4256			
Lime & shale	4256	4332			
Lime	4332	4386			
Lime & shale	4386	4438			
Lime	4438	4896			
Lime & shale	4896	4920			
Lime	4920	5076			
Lime & shale	5076	5130			
T.D.:		5130			

TOPS:  
Elevation: 1764  
Kansas City 4124  
Mississippi 4648  
Arbuckle 5080

I, the undersigned, being first duly sworn upon oath, state that this well record is true, correct and complete according to the records of this office and to the best of my knowledge and belief.

John J. Farmer, Jr. Vice-Pres.  
Name and title of representative of company

Subscribed and sworn to before me this 11th day of April, 1955My Commission expires 10-11-58

Jessie J. Farmer  
Notary Public

WELL NO. 1  
COUNTY Barber SEC. 5 TWP. 33 RGE. 15  
FARM NAME Winter