

KANSAS CORPORATION COMMISSION
OIL & GAS CONSERVATION DIVISION

Form ACO-4
Form must be typed
March 2009

APPLICATION FOR COMMINGLING OF
PRODUCTION (K.A.R. 82-3-123) OR FLUIDS (K.A.R. 82-3-123a)

Commingling ID # CO081108

OPERATOR: License # 30606
Name: MURFIN DRILLING COMPANY, INC
Address 1: 250 NORTH WATER SUITE 300
Address 2: _____
City: WICHITA State: KS Zip: 67202 + _____
Contact Person: RONALD SCHRAEDER
Phone: (316) 858-8630

API No. 15 - 065-23330-0000
Spot Description: _____
_____ Sec. 14 Twp. 10 S. R. 24 East West
800 Feet from North / South Line of Section
1650 Feet from East / West Line of Section
County: GRAHAM
Lease Name: GOLTL Well #: 4-14

1. Name and upper and lower limit of each production interval to be commingled:
Formation: TORONTO 3764' : 3778' (Perfs): 3765 - 69'
Formation: LANSING 3778' : 4000' (Perfs): 3778-86', 3809-21', 3851-64',
Formation: _____ (Perfs): 3910-19', 3932-38', 3950-64'
Formation: _____ (Perfs): _____
Formation: _____ (Perfs): _____

2. Estimated amount of fluid production to be commingled from each interval:
Formation: TORONTO 3764' : 3778' BOPD: 5 MCFPD: _____ BWPD: 10
Formation: LANSING 3778' : 4000' BOPD: 2 MCFPD: _____ BWPD: 24
Formation: _____ BOPD: _____ MCFPD: _____ BWPD: _____
Formation: _____ BOPD: _____ MCFPD: _____ BWPD: _____
Formation: _____ BOPD: _____ MCFPD: _____ BWPD: _____

3. Plat map showing the location of the subject well, all other wells on the subject lease, and all wells on offsetting leases within a 1/2 mile radius of the subject well, and for each well the names and addresses of the lessee of record or operator.

4. Signed certificate showing service of the application and affidavit of publication as required in K.A.R. 82-3-135a.

For Commingling of PRODUCTION ONLY, include the following:

- 5. Wireline log of subject well. Previously Filed with ACO-1: Yes No
- 6. Complete Form ACO-1 (Well Completion form) for the subject well.

For Commingling of FLUIDS ONLY, include the following:

- 7. Well construction diagram of subject well.
- 8. Any available water chemistry data demonstrating the compatibility of the fluids to be commingled.

AFFIDAVIT: I am the affiant and hereby certify that to the best of my current information, knowledge and personal belief, this request for commingling is true and proper and I have no information or knowledge, which is inconsistent with the information supplied in this application.

Signature: Ronald J Schraeder
Printed Name: RONALD SCHRAEDER
Title: PRODUCTION ENGINEER

RECEIVED
JUL 25 2011
KCC WICHITA

KCC Office Use Only
 Denied Approved
15-Day Periods Ends: 8/26/2011
Approved By: [Signature] Date: 8/24/11

Protests may be filed by any party having a valid interest in the application. Protests must be in writing and comply with K.A.R. 82-3-135b and must be filed within 15 days of publication of the notice of application.

Affidavit of Notice Served

Re: Application for: GOLTL LEASE
Well Name: GOLTL # 4-14 Legal Location: 800' FSL & 1650' FEL 14-10S-24W

The undersigned hereby certifies that he / she is a duly authorized agent for the applicant, and that on the day 25 of JULY, 2011, a true and correct copy of the application referenced above was delivered or mailed to the following parties:

Note: A copy of this affidavit must be served as a part of the application.

Name

Address (Attach additional sheets if necessary)

OFFSET OPERATORS:

CORAL PRODUCTION CORP

**1600 STOUT STREET SUITE 1500
DENVER, CO 80202**

LANDOWNER:

EVAN E. & JUDY GOLTL

**P.O. BOX 157
HILL CITY, KS 67622**

UNLEASED MINERALS:

NONE

**RECEIVED
JUL 25 2011
KCC WICHITA**

I further attest that notice of the filing of this application was published in the HILL CITY TIMES, the official county publication of GRAHAM county. A copy of the affidavit of this publication is attached.

Signed this 25 day of JULY, 2011

Ronald J. Schneider
Applicant of Duly Authorized Agent

Subscribed and sworn to before me this 25th day of July, 2011

Alissa B. Tevis
Notary Public

My Commission Expires: 5-2-2015



Protests may be filed by any party having a valid interest in the application. Petitions for protests shall be in writing and shall clearly identify the name and address of the protestant and the title of the application. The petition shall include a clear and concise statement of the direct and substantial interest of the protestant in the proceedings, including the manner in which the protestant may be affected, and the nature, extent, character and grounds of the protest. Protestants shall serve the protest upon the applicant by mail or personal service at the same time or before the protestant files the protest with the Conservation Division. Protests must be filed within 30 days of the publication notice of the application.

AFFIDAVIT

STATE OF KANSAS \
- SS.
County of Sedgwick /

Mark Fletchall, of lawful age, being first duly sworn, deposeseth and saith: That he is Record Clerk of The Wichita Eagle, a daily newspaper published in the City of Wichita, County of Sedgwick, State of Kansas, and having a general paid circulation on a daily basis in said County, which said newspaper has been continuously and uninterruptedly published in said County for more than one year prior to the first publication of the notice hereinafter mentioned, and which said newspaper has been entered as second class mail matter at the United States Post Office in Wichita, Kansas, and which said newspaper is not a trade, religious or fraternal publication and that a notice of a true copy is hereto attached was published in the regular and entire Morning issue of said The Wichita Eagle for 1 issues, that the first publication of said notice was

made as aforesaid on the 11th of

August A.D. 2011, with

subsequent publications being made on the following dates:

And affiant further says that he has personal knowledge of the statements above set forth and that they are true.

Mark Fletchall

Subscribed and sworn to before me this

11th day of August, 2011

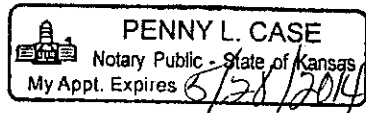

Penny L. Case
Notary Public Sedgwick County, Kansas

Printer's Fee : \$115.60

LEGAL PUBLICATION
PUBLISHED IN THE WICHITA EAGLE
(AUGUST 11, 2011) (3134346)
BEFORE THE STATE CORPORATION
COMMISSION OF
THE STATE OF KANSAS
NOTICE OF FILING APPLICATION
RE: MURFIN DRILLING COMPANY, INC.
Application for Commingling Production
from more than one source in the
Goli Trust #4-14 located in Graham County,
Kansas.
TO: All Oil & Gas Producers, Unleased
Mineral Owners, Landowners, and all
persons whosever concerned.
You and each of you, are hereby notified
the **MURFIN DRILLING COMPANY, INC.**
has filed an application to commingle
the production fluids from the Toronto
Formation between the depths of 3764' and
3778' and Lansing Formation between the
depths of 3778' and 4000' in the Goli Trust
#4-14, 800' FLS & 1650' FEL located in the
Southeast Quarter of Section 14, Range 10
South, Township 24 West, Graham County,
Kansas.
Any person who object to or protest this
application shall be required to file their
objections or protest with the Conservation
Division of the State Corporation
Commission of the State of Kansas within
fifteen (15) days from the date of this
publication. These protests shall be filed
pursuant to Commission regulations and
must state specific reasons why the grant
of the application may cause waste, violate
correlative rights, or pollute the natural
resources of the State of Kansas.
All persons interested or concerned shall
take notice of the foregoing and shall govern
themselves accordingly.
MURFIN DRILLING COMPANY, INC.
250 N. Water, Suite 300
Wichita, KS 67202
316-267-3241

RECEIVED
KANSAS CORPORATION COMMISSION
AUG 17 2011
LEGAL SECTION

First Published In: The Hill City Times
Wednesday, July 27, 2011

AFFIDAVIT OF PUBLICATION
State of Kansas, County of Graham, ss:

BEFORE THE STATE CORPORATION COMMISSION OF THE STATE OF KANSAS
NOTICE OF FILING APPLICATION

JIM LOGBACK, of lawful age, being duly sworn, upon oath states that he is publisher of THE HILL CITY TIMES;

RE: MURFIN DRILLING COMPANY, INC. Application for Commingling Production from more than one source of supply in the Gold Trust #4-14 located in Graham County, Kansas.

THAT said newspaper has been published weekly at least fifty (50) times a year and has been published at least five (5) years in Graham County, Kansas prior to the first publication of the attached notice;

TO: All Oil & Gas Producers, Unleased Mineral Owners, Landowners, and all persons whosever concerned.

THAT said newspaper has a general PAID circulation in GRAHAM COUNTY, KANSAS, and is NOT a trade, religious or fraternal publication.

You and each of you are hereby notified that the MURFIN DRILLING COMPANY, INC. has filed an application to commingle the production fluids from the Toronto Formation between the depths of 3764 and 3778 and Lansing Formation between the depths of 3778 and 4000 in the Gold Trust #4-14, 800 FSL & 1650 FEL located in the Southeast Quarter of Section 14-Range 10 South-Township 24 West, Graham County, Kansas.

THAT said newspaper is PRINTED IN KANSAS and PUBLISHED in GRAHAM COUNTY, KANSAS, and entered as second class mail matter at the post office of its publication in HILL CITY, KANSAS;

Any persons who object to or protest this application shall be required to file their objections or protest with the Conservation Division of the State Corporation Commission of the State of Kansas within fifteen (15) days from the date of this publication. These protests shall be filed pursuant to Commission regulations and must state specific reasons why the grant of the application may cause waste, violate correlative rights, or pollute the natural resources of the State of Kansas.

THAT, a notice of which the attached is a true and correct copy, was published in a regular issue of said newspaper for 1 consecutive weeks commencing with the issue of July 27, 2011.

Jim Logback

Publication Fee \$ 302⁹
Affidavits @ 75¢ .. \$ _____
Extra Copies @ 50¢ \$ _____
TOTAL LEGAL FEE \$ 302⁹

SUBSCRIBED and sworn to before me this 27th day of July, 2011

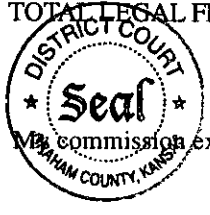

Mary D. Sumner
Notary Public

Clerk of the District Court
Graham County

commission expires KSA 53-501

All persons interested or concerned shall take notice of the foregoing and shall govern themselves accordingly.

MURFIN DRILLING COMPANY, INC.
250 N. Water, Suite 300
Wichita, KS 67202
316-267-3241

KANSAS CORPORATION COMMISSION

JUL 29 2011
RECEIVED

GRAHAM COUNTY
T10S-R24W
TORONTO WELL DATUMS

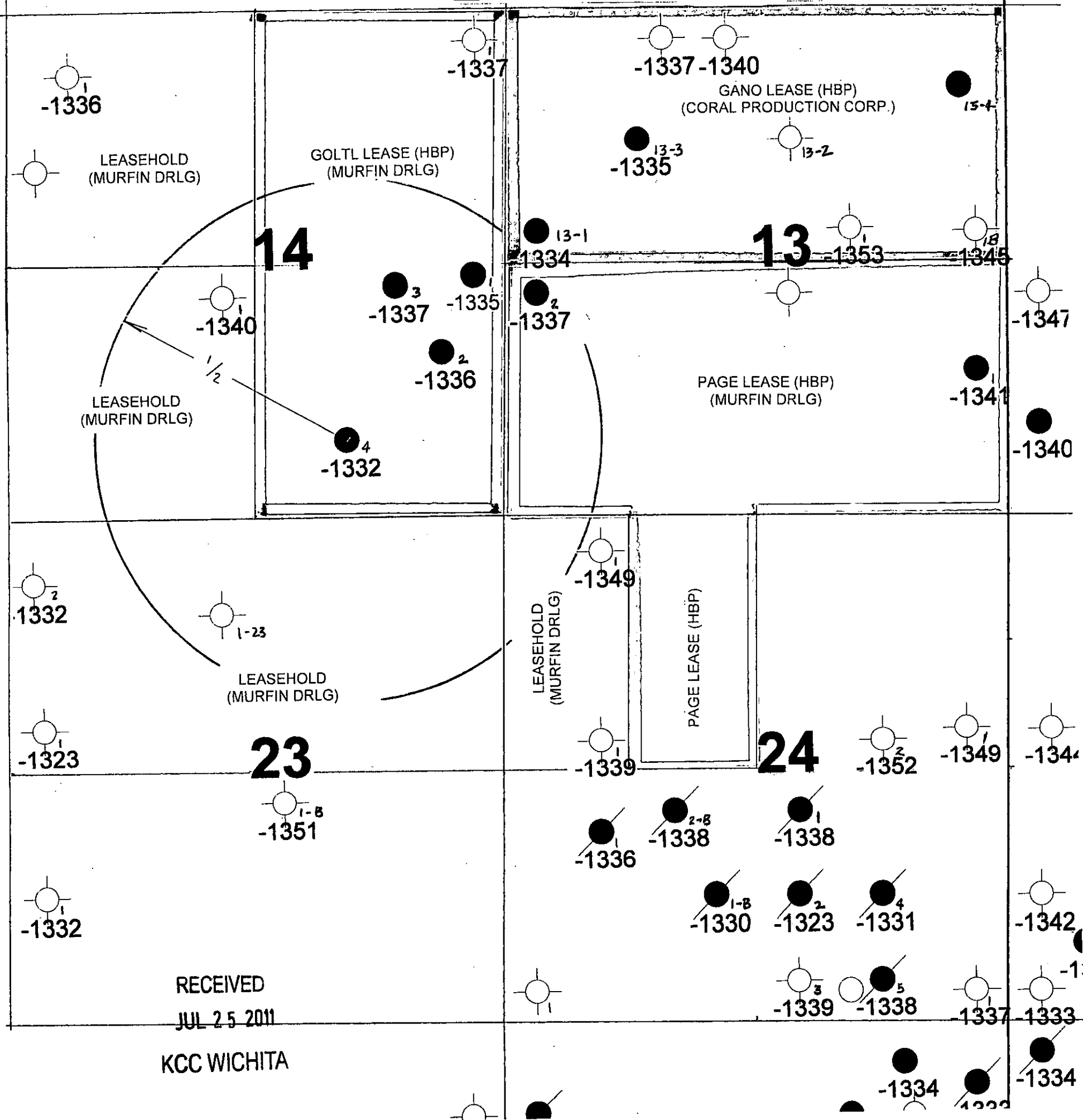

GRAHAM COUNTY
T10S-R24W
LANSING WELL DATUMS

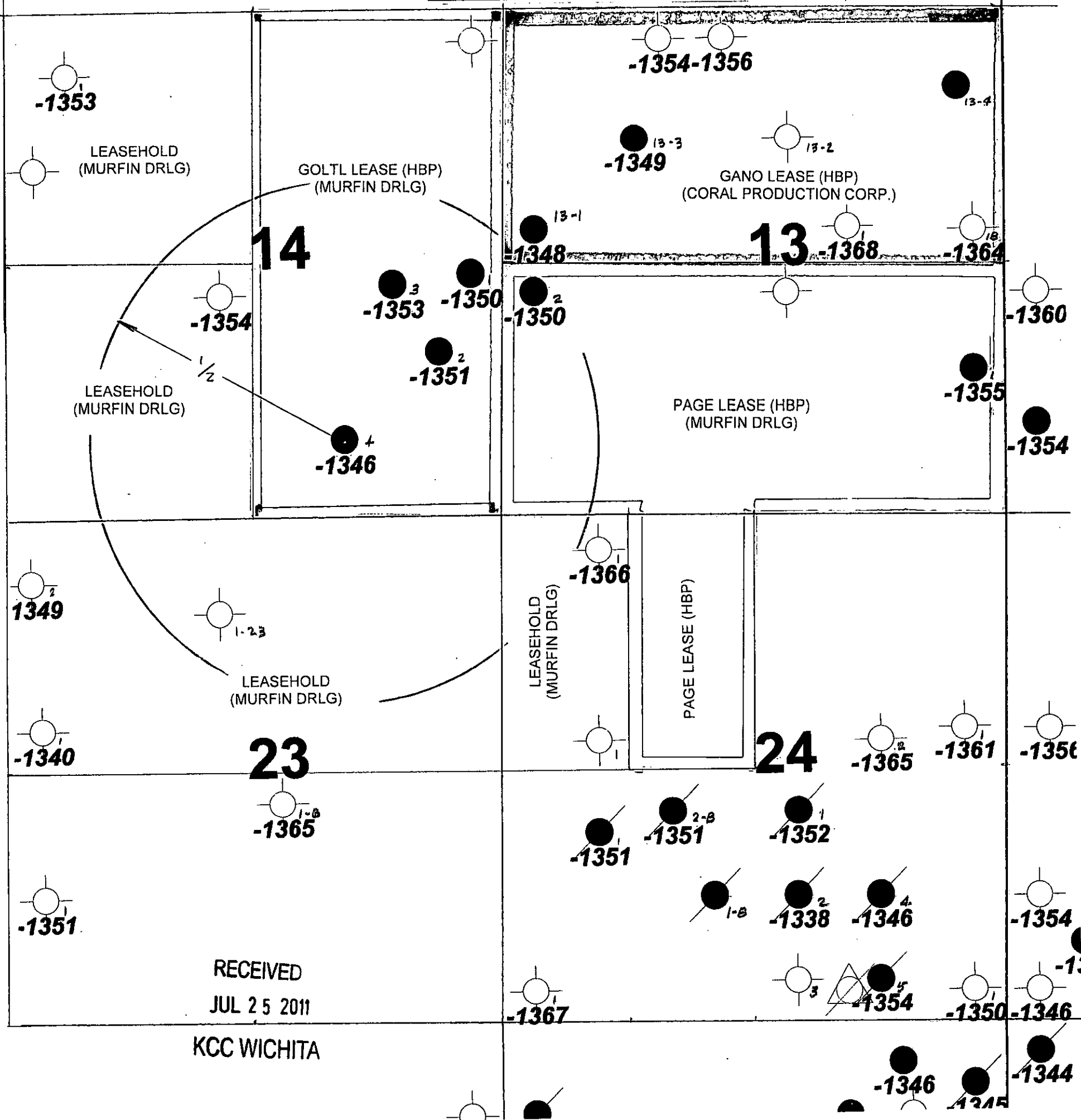

Conservation Division
Finney State Office Building
130 S. Market, Rm. 207B
Wichita, KS 67202-3802



Phone: 316-337-6200
Fax: 316-337-6211
<http://kcc.ks.gov/>

Mark Sievers, Chairman
Ward Loyd, Commissioner
Thomas E. Wright, Commissioner

Sam Brownback, Governor

August 26, 2011

Ronald Schraeder
Murfin Drilling Company, Inc.
250 North Water, Suite 300
Wichita, KS 67202

RE: Approved Commingling CO081108
Goltl #4-14, Sec. 14-T10S-R24W, Graham County
API No. 15-065-23330-00-00

Dear Mr. Schraeder:

Your Application for Commingling (ACO-4) for the above described well has been reviewed and approved by the Kansas Corporation Commission (KCC) per K.A.R. 82-3-123. Notice was examined and found to be proper per K.A.R. 82-3-135a. No protest had been filed within the 15-day protest period. This application, which was received by the KCC on August 17, 2011 concerns approval to simultaneously produce from the following sources of supply through the same tubing string in the same wellbore:

Source of Supply	Estimated Current Production			Perf Depth
	BOPD	MCFPD	BWPD	
Toronto	5	0	10	3765-69
Lansing	2	0	24	3778-3964 OA
Total Estimated Current Production	7	0	34	

Based upon the depth of the Lansing formation perforations, total oil production shall not exceed 100 BOPD and total gas production shall not exceed 50% of the absolute open flow (AOF).

File form ACO-1 upon completion of the well to commingle.

Commingling ID number CO081108 has been assigned to this approved application. Use this number for well completion reports (ACO-1) and other correspondence that may concern this approved commingling.

Sincerely,

Rick Hestermann
Production Department