

STATE OF KANSAS  
STATE CORPORATION COMMISSION

15135-21533-0000

WELL PLUGGING RECORD

Give All Information Completely  
Make Required Affidavit  
Mail or Deliver Report to  
Conservation Division  
State Corporation Comm.  
245 North Water  
Wichita, KS 67202

Ness County, Sec. 29 Twp. 20S Rge. 22W E/W  
Location as "NE/CNW $\frac{1}{4}$ SW $\frac{1}{4}$ " or footage from lines  
C SW SE

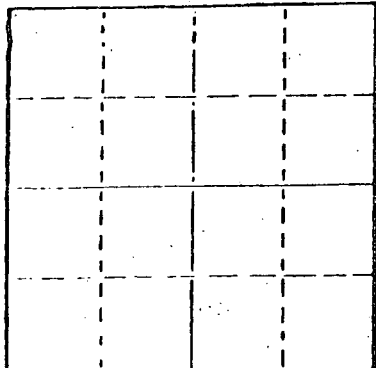

Locate well correctly on above  
Section Plot

Lease Owner Woolsey Petroleum Corporation  
Lease Name Meta Hall Well No. 1  
Office Address Suite 400, 300 West Douglas, Wichita, KS  
Character of Well (Completed as Oil, Gas or Dry Hole)  
dry hole

Date Well completed December 19, 1978  
Application for plugging filed December 19, 1978  
Application for plugging approved December 19, 1978  
Plugging commenced December 19, 1978  
Plugging completed December 19, 1978  
Reason for abandonment of well or producing formation  
dry hole

If a producing well is abandoned, date of last production  
19

Was permission obtained from the Conservation Division or  
its agents before plugging was commenced? yes

Name of Conservation Agent who supervised plugging of this well Leo Massey  
Producing formation Depth to top Bottom Total Depth of Well 4430'  
Show depth and thickness of all water, oil and gas formations.

OIL, GAS OR WATER RECORDS

CASING RECORD

FORMATION	CONTENT	FROM	TO	SIZE	PUT IN	PULLED OUT
				8-5/8"	488'	--

Describe in detail the manner in which the well was plugged, indicating where the mud fluid  
was placed and the method or methods used in introducing it into the hold. If cement or other  
plugs were used, state the character of same and depth placed, from feet to  
feet for each plug set.

50 sx @ 550', 25 sx @ 300',  
plug, 10 sx @ 40'

RECEIVED  
STATE CORPORATION COMMISSION

JAN - 2 1979  
1-2-79

CONSERVATION DIVISION  
Wichita, Kansas

(If additional description is necessary, use BACK of this sheet)

Name of Plugging Contractor

STATE OF KANSAS COUNTY OF SEDGWICK, ss.  
Donald E. Hunt (employee of owner) ~~owner~~ ~~operator~~  
of the above-described well, being first duly sworn on oath, says: That I have knowledge of  
the facts, statements, and matters herein contained and the log of the above-described well  
as filed and that the same are true and correct. So help me God.

(Signature)

*Donald E. Hunt*

Suite 250, 200 West Douglas, Wichita, Kansas  
(Address)

Subscribed and sworn to before me this 29th day of December, 1978

*Kathleen L. Durbin*  
Kathleen L. Durbin Notary Public.

My commission expires January 4, 1981

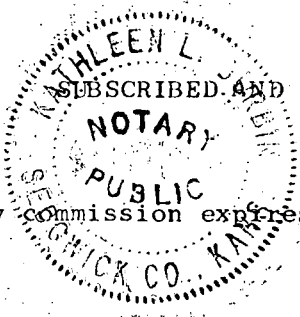

**IMPORTANT**  
Kans. Geo. Survey request  
samples on this well.

**KANSAS DRILLERS LOG**

S. 29 T. 20 R. 22 <sup>E</sup>/<sub>W</sub>

Loc. C SW SE

County Ness

API No. 15 — 135 — 21,533-6000  
County Number

Operator  
Woolsey Petroleum Corp.

Address  
300 West Douglas, Suite 400 Wichita, Kansas 67202

Well No. #1 Lease Name Meta Hall

Footage Location C of SW/4 of SE/4  
feet from (N) (S) line feet from (E) (W) line

Principal Contractor Dunne-Gardner Petroleum, Inc. Geologist Ray Palmer

Spud Date 12-10-78 Total Depth 4430' RTD P.B.T.D.

Date Completed 12-19-78 Oil Purchaser

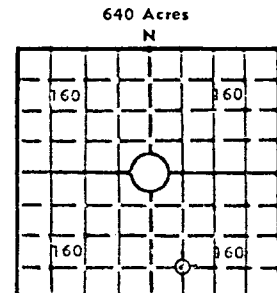

Elev.: Gr. 2193'

DF KB 2202'

**CASING RECORD**

Report of all strings set — surface, intermediate, production, etc.

Purpose of string	Size hole drilled	Size casing set (in O.D.)	Weight lbs/ft.	Setting depth	Type cement	Sacks	Type and percent additives
Surface	12 1/4"	8-5/8"	20#	488'	Light Class "A"	150	3% Cal. Chl.
						150	3% Cal. Chl.

**LINER RECORD**

Top, ft.	Bottom, ft.	Sacks cement

**PERFORATION RECORD**

Shots per ft.	Size & type	Depth interval

**TUBING RECORD**

Size	Setting depth	Packer set at

**ACID, FRACTURE, SHOT, CEMENT SQUEEZE RECORD**

Amount and kind of material used	Depth interval treated

**RECEIVED**  
STATE CORPORATION COMMISSION  
JAN - 8 1979  
CONSERVATION DIVISION  
Wichita, Kansas

**INITIAL PRODUCTION**

Date of first production	Producing method (flowing, pumping, gas lift, etc.)				
RATE OF PRODUCTION PER 24 HOURS	Oil	Gas	Water	Gas-oil ratio	
	bbls.	MCF	bbls.	CFPB	
Disposition of gas (vented, used on lease or sold)			Producing interval(s)		

INSTRUCTIONS: As provided in KCC Rule 82-2-125, within 90 days after completion of a well, one completed copy of this Drillers Log shall be transmitted to the State Geological Survey of Kansas, 4150 Monroe Street, Wichita, Kansas 67209. Copies of this form are available from the Conservation Division, State Corporation Commission, 3830 So. Meridian (P.O. Box 17027), Wichita, Kansas 66217. Phone AC 316-522-2206. If confidential custody is desired, please note Rule 82-2-125. Drillers Logs will be on an open file in the Oil and Gas Division, State Geological Survey of Kansas, Lawrence, Kansas 66044.

DESIGNATE TYPE OF COMP.: OIL, GAS,  
DRY HOLE, SWDW, ETC.:

Operator  
Woolsey Petroleum Corporation

Dry Hole

Well No.

Lease Name

1

Meta Hall

S 29 T 20SR 22 <sup>K</sup><sub>W</sub>

### WELL LOG

Show all important zones of porosity and contents thereof; cored intervals, and all drill-stem tests, including depth interval tested, cushion used, time tool open, flowing and shut-in pressures, and recoveries.

SHOW GEOLOGICAL MARKERS, LOGS RUN,  
OR OTHER DESCRIPTIVE INFORMATION.

FORMATION DESCRIPTION, CONTENTS, ETC.	TOP	BOTTOM	NAME	DEPTH
Sand and shale	0	495		
Red bed shales	495	875		
Sand	875	1090		
Blue shale	1090	1420		
Lime streaks	1420	1520		
Lime and shale	1520	3830		
Lime	3830	4430		
Rotary Total Depth	4430			

USE ADDITIONAL SHEETS, IF NECESSARY, TO COMPLETE WELL RECORD.

Date Received



Signature

Operations Manager

Title

January 3, 1979

Date

Woolsey Petroleum Corporation

#1 Meta Hall  
Ness County, Kansas

C SW SE  
Sec. 29-T29S-R22W

Contr: Dunne-Gardner Petroleum Inc.

Elev: 2202' KB      Comm: 12-10-78      Comp: 12-19-78      IP: D & A

Casing: 8-5/8" 488'/300 sxs.

<u>Log Tops</u>	<u>Depth</u>	<u>Datum</u>
Stone Corral	1423	(+ 779)
Heebner	3713	(-1511)
Lansing	3762	(-1560)
BKS	4126	(-1924)
Ft. Scott	4290	(-2088)
Cherokee	4313	(-2111)
Miss. Osage	4398	(-2196)
Log Total Depth	4428	(-2226)

DST #1 4375-4392'  
45"

IFP 30-20#  
Misrun, packer failed during  
first shut-in period.

DST #2 4390-4430'  
45-45-45-90  
Rec. 3225' SW  
IFP 141-1128#  
ISIP 1400#  
FFP 1168-1380#  
FSIP 1400#  
BHT 132' F

RECEIVED  
STATE CORPORATION COMMISSION

JAN - 8 1979

CONSERVATION DIVISION  
Wichita, Kansas