

STATE OF KANSAS
STATE CORPORATION COMMISSION

WELL PLUGGING RECORD

Give All Information Completely
Make Required Affidavit
Mail or Deliver Report to
Conservation Division
State Corporation Commission
P. O. Box 17027
Wichita, Kansas 67217
NORTH

NESS County, Sec 26 Twp 20S Rge (E) 22 (W)

Location as "NE/CNWKSWK" or footage from lines SE 1/4 NW 1/4
Lease Owner C-G DRILLING CO.
Lessee Name NAREY Well No. 1
Office Address 1107 UNION NATIONAL BUILDING
Character of Well (completed as Oil, Gas or Dry Hole) DRY HOLE
Date well completed DECEMBER 22 19 74
Application for plugging filed DECEMBER 22 19 74
Application for plugging approved DECEMBER 22 19 74
Plugging commenced DECEMBER 22 19 74
Plugging completed DECEMBER 22 19 74
Reason for abandonment of well or producing formation TOO LOW STRUCTURALLY

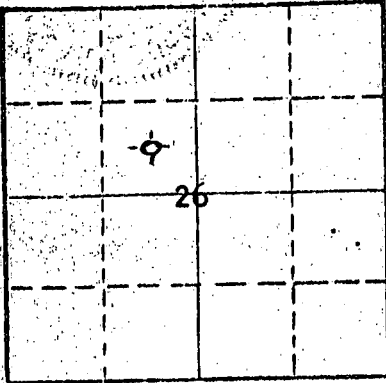

Locate well correctly on above Section Plat

If a producing well is abandoned, date of last production 19
Was permission obtained from the Conservation Division or its agents before plugging was commenced? YES

Name of Conservation Agent who supervised plugging of this well LEO F MASSEY, HAYS, KANSAS
Producing formation Depth to top Bottom Total Depth of Well 4370 Feet
Show depth and thickness of all water, oil and gas formations.

OIL, GAS OR WATER RECORDS

CASING RECORD

FORMATION	CONTENT	FROM	TO	SIZE	PUT IN	PULLED OUT
				8 5/8"	376.93'	None

Describe in detail the manner in which the well was plugged, indicating where the mud fluid was placed and the method or methods used in introducing it into the hole. If cement or other plugs were used, state the character of same and depth placed, from feet to feet for each plug set.

FILLED WITH HEAVY MUD TO 500'. SET PLUG. PUT IN 50 SACKS CEMENT. FILLED WITH HEAVY MUD TO 240'. SET PLUG. PUT IN 25 SACKS CEMENT. FILLED WITH HEAVY MUD TO 40'. SET PLUG. FILLED TO TOP WITH 1 SACKS HULLS & 10 SACKS CEMENT.

RECEIVED
STATE CORPORATION COMMISSION

JAN 3 1975

CONSERVATION DIVISION
Wichita, Kansas

Name of Plugging Contractor C-G DRILLING CO.
Address 1107 UNION NATIONAL BUILDING, WICHITA, KANSAS 67202

STATE OF KANSAS, COUNTY OF SEDGWICK
G. F. Galloway (employee of owner) or (owner or operator) of the above-described well, being first duly sworn on oath, says: That I have knowledge of the facts, statements, and matters herein contained and the log of the above-described well as filed and that the same are true and correct. So help me God.

(Signature) G. F. Galloway
1107 Union National Bldg, Wichita, Ks. (Address)

Subscribed and sworn to before me this 22nd day of December, 1974



December 7, 1975

Phyllis Buchanan Notary Public.

KANSAS DRILLERS LOG

IMPORTANT
 Kans. Geo. Survey request
 samples on this well...

S. 26 T. 20 R. 22 ^N/_W

Loc. SE NW

County Ness

API No. 15 — 135 — 20,972-0000
County Number

Operator
C-G Drilling Co.

Address
1107 Union National Building Wichita, Kansas 67202

Well No. #1 Lease Name Mary Narey #1

Footage Location
330 feet from (N) (S) line 330 feet from (XX) (W) line

Principal Contractor C-G DRILLING CO. Geologist JERRY JESPERSEN

Spud Date DECEMBER 7, 1974 Total Depth 4370 P.B.T.D.

Date Completed Oil Purchaser

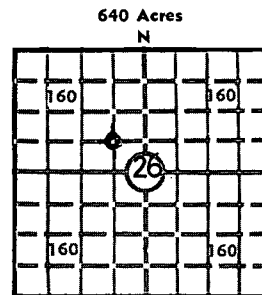

Locate well correctly

Elev.: Gr. 2

DF KB 2225

CASING RECORD

Report of all strings set—surface, intermediate, production, etc.

Purpose of string	Size hole drilled	Size casing set (in O.D.)	Weight lbs/ft.	Setting depth	Type cement	Sacks	Type and percent additives
SURFACE	12 1/4"	8 5/8"	28#	376.93	COMMON	190	2% GEL 3% CA CL

LINER RECORD

PERFORATION RECORD

Top, ft.	Bottom, ft.	Sacks cement	Shots per ft.	Size & type	Depth interval

TUBING RECORD

Size	Setting depth	Packer set at

ACID, FRACTURE, SHOT, CEMENT SQUEEZE RECORD

Amount and kind of material used	Depth interval treated

INITIAL PRODUCTION

Date of first production		Producing method (flowing, pumping, gas lift, etc.)			
RATE OF PRODUCTION PER 24 HOURS	Oil bbls.	Gas MCF	Water bbls.	Gas-oil ratio CFPB	
Disposition of gas (vented, used on lease or sold)			Producing interval (s)		

INSTRUCTIONS: As provided in KCC Rule 82-2-125, within 90 days after completion of a well, one completed copy of this Drillers Log shall be transmitted to the State Geological Survey of Kansas, 4150 Monroe Street, Wichita, Kansas 67209. Copies of this form are available from the Conservation Division, State Corporation Commission, 3830 So. Meridian (P.O. Box 17027), Wichita, Kansas 66217. Phone AC 316-522-2206. If confidential custody is desired, please note Rule 82-2-125. Drillers Logs will be on open file in the Oil and Gas Division, State Geological Survey of Kansas, Lawrence, Kansas 66044.

Operator
C-G DRILLING CO.

DESIGNATE TYPE OF COMP.: OIL, GAS,
 DRY HOLE, SWDW, ETC.:
OIL

Well No.
1

Lease Name
NAREY

S 26 T 20 S R 22 E WEST

WELL LOG

Show all important zones of porosity and contents thereof; cored intervals, and all drill-stem tests, including depth interval tested, cushion used, time tool open, flowing and shut-in pressures, and recoveries.

SHOW GEOLOGICAL MARKERS, LOGS RUN, OR OTHER DESCRIPTIVE INFORMATION.

FORMATION DESCRIPTION, CONTENTS, ETC.	TOP	BOTTOM	NAME	DEPTH
POST ROCK	0	50		
SAND & SHALE	50	325		
SHALE	325	875		
SAND	875	1080		
RED BED	1080	1427		
ANHYDRITE	1427	1462		
SHALE & SAND	1462	1785		
SHALE	1785	2000		
LIME & SHALE	2000	3250		
LIME	3250	3360		
LIME & SHALE	3360	3825		
LIME	3825	4045		
LIME & SHALE	4045	4115		
LIME	4115	4370		
RTD		4370		
<p>DST #1 4350-4362 OPEN 30 SI 30 OPEN 1 HR SI 30 REC 65' MUD W/FEW SPECKS OIL IBHP 1370# FBHP 1360# IFP 54# FFP 65#</p> <p>DST #2 4355-70 OPEN 30 SI 30 OPEN 30 SI 30 REC 2220' SW IBHP 1296#, FBHP 1285# IFP 216# FFP 945</p>				

USE ADDITIONAL SHEETS, IF NECESSARY, TO COMPLETE WELL RECORD.

Date Received

G. F. Galloway
 G. F. Galloway
 Partner

Signature

Title

January 2, 1975

Date