

STATE OF KANSAS  
STATE CORPORATION COMMISSION

WELL PLUGGING RECORD

Give All Information Completely  
Make Required Affidavit  
Mail or Deliver Report to:  
Conservation Division  
State Corporation Commission  
211 No. Broadway  
Wichita, Kansas

Barber

County, Sec. 32 Twp. 33S Rge. (E) 12 (W)

Location as "NE/CNW/SW" or footage from lines C NW/4 NW/4

Lease Owner Skelly Oil Company

Lease Name Vala Smith Well No. 1

Office Address Box 1650, Tulsa, Oklahoma

Character of Well (completed as Oil, Gas or Dry Hole) Dry Hole

Date well completed September 16, 19 56

Application for plugging filed September 17, 19 56

Application for plugging approved September 18, 19 56

Plugging commenced September 17, 19 56

Plugging completed September 17, 19 56

Reason for abandonment of well or producing formation Dry Hole

If a producing well is abandoned, date of last production 19

Was permission obtained from the Conservation Division or its agents before plugging was commenced? Yes (verbally)

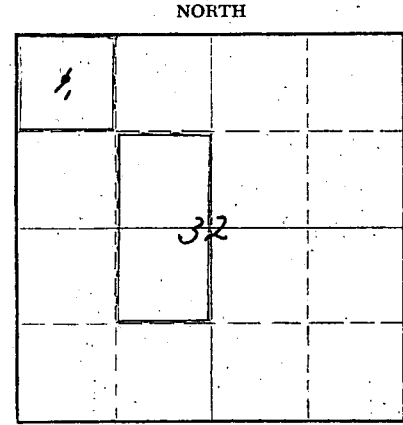

Locate well correctly on above Section Plat

Name of Conservation Agent who supervised plugging of this well Mr. M. A. Rives

Producing formation Depth to top Bottom Total Depth of Well 4694 Feet

Show depth and thickness of all water, oil and gas formations.

OIL, GAS OR WATER RECORDS

CASING RECORD

FORMATION	CONTENT	FROM	TO	OD SIZE	PUT IN	PULLED OUT
Mississippi	Dry	4496'	4694'	8-5/8"	257'0"	None

Describe in detail the manner in which the well was plugged, indicating where the mud fluid was placed and the method or methods used in introducing it into the hole. If cement or other plugs were used, state the character of same and depth placed, from feet to feet for each plug set.

- Mud laden fluid 4694' to 260'
- Wood plug 260'
- 20 sacks of cement 260' to 200'
- Mud laden fluid 200' to 35'
- Wood plug 35'
- 10 sacks of cement 35' to 5'
- Surface soil 5' to 0'

RECEIVED  
STATE CORPORATION COMMISSION  
SEP 20 1956  
CONSERVATION DIVISION  
Wichita, Kansas

(If additional description is necessary, use BACK of this sheet)  
Name of Plugging Contractor Chas. Hulme Drilling, Contr.  
Address Box 36, Great Bend, Kansas

STATE OF Kansas, COUNTY OF Reno, ss.  
H. E. Wamsley (employee of owner) of the above-described well, being first duly sworn on oath, says: That I have knowledge of the facts, statements, and matters herein contained and the log of the above-described well as filed and that the same are true and correct. So help me God.

(Signature) [Signature]  
Box 391, Hutchinson, Kansas (Address)

SUBSCRIBED AND SWORN TO before me this 27th day of September, 1956

My commission expires April 7, 1959 [Signature] Notary Public.

PLUGGING  
FILE SEC 32 T 33 R 12W  
BOOK PAGE 100 LINE 13

# SKELLY OIL COMPANY

## Well Record

NORTH									
SOUTH									

Lease Name and No. **Valo Smith 31427** Well No. **1** Elev. **1459' 0"**  
 Lease Description **NE/4 SE/4 Sec. 31; NW/4 SE/4 & SW/4 NW/4 & SW/4 Sec. 32-33-12N, Jarboe Co., Kans. (160 A.)**  
 Location made **August 23, 1956** by **I. L. Oik**  
**660** feet from North line **660** feet from East line **11/4**  
**660** feet from South line **660** feet from West line of **Sec. 32**

Work com'd. **8/26 1956** Rig com'd. **8/28 1956** Drig com'd. **8/28 1956** Drig com'd. **9/15 1956**  
 Rig Contractor **Chas. Hulso Drilling Company**  
 Drilling Contractor **Chas. Hulso Drilling Co., Great Bend, Kansas**

Rotary Drilling from **0'** to **4694'** Cable Tool Drilling from \_\_\_\_\_ to \_\_\_\_\_

Commenced Producing **DRY HOLE** 19 \_\_\_\_\_ Initial Prod. before shot or acid \_\_\_\_\_ Bbls.  
 Initial Prod. after shot or acid \_\_\_\_\_ Bbls.

Dry Gas Well Press \_\_\_\_\_ Volume \_\_\_\_\_ Cu. ft.  
 Casing Head Gas Pressure \_\_\_\_\_ Volume \_\_\_\_\_ Cu. ft.  
 Braden Head ( \_\_\_\_\_ Size \_\_\_\_\_ ) Gas Pressure \_\_\_\_\_ Volume \_\_\_\_\_ Cu. ft.  
 Braden Head ( \_\_\_\_\_ Size \_\_\_\_\_ ) Gas Pressure \_\_\_\_\_ Volume \_\_\_\_\_ Cu. ft.

PRODUCING FORMATION **DRY HOLE** (Name) Top Bottom TOTAL DEPTH **4694'**

### CASING RECORD

Size	Wt.	Thds.	Where Set	PULLED OUT			LEFT IN			KIND	Cond'n	CEMENTING	
				Jts.	Feet	In.	Jts.	Feet	In.			Sacks Used	Method Employed
<b>6-5/8" 22.7</b>			<b>25'</b>				<b>7</b>	<b>23'</b>				<b>CO</b>	<b>Ball Joint</b>

Liner Set at \_\_\_\_\_ Length \_\_\_\_\_ Perforated at \_\_\_\_\_  
 Liner Set at \_\_\_\_\_ Length \_\_\_\_\_ Perforated at \_\_\_\_\_  
 Packer Set at \_\_\_\_\_ Size and Kind \_\_\_\_\_  
 Packer Set at \_\_\_\_\_ Size and Kind \_\_\_\_\_

### SHOT OR ACID TREATMENT RECORD

	FIRST	SECOND	THIRD	FOURTH
Date				
Acid Used				
Size Shot				
Shot Between				
Size of Shell				
Put in by (Co.)				
Length anchor				
Distance below Casing				
Damage to Casing or Casing Shoulder				

### SIGNIFICANT GEOLOGICAL FORMATIONS

NAME	Top	Bottom	GAS		OIL		REMARKS
			From	To	From	To	
<b>Beaumont shale</b>	<b>3550'</b>						
<b>Douglas</b>	<b>3760'</b>						
<b>Landing Zone</b>	<b>3750'</b>						
<b>Wartson</b>	<b>4399'</b>						
<b>Mississippi sh.</b>	<b>4450'</b>						

### CLEANING OUT RECORDS

	DATE COMMENCED	DATE COMPLETED	PROD. BEFORE	PROD. AFTER	REMARKS
1st					See Reverse for other details.
2nd					" " " "
3rd					" " " "
4th					" " " "

### PLUGGING BACK AND DEEPENING RECORDS

	Date Commenced	Date Completed	No. Feet Plugged Back or Deepened	Prod. Before	Prod. After	REMARKS



# RECORD OF FORMATIONS

FORMATION	TOP	BOTTOM	REMARKS
Surface soil, sand and clay	0	235	
Clay and silt	235	265	Rot and cemented 2-5/8" OD, 22.7% Ormsco P.M., S.S. steel casing (A 2000') at 265' with 200 cubic of cement cement, 2 1/2 gal and 10 calcium chloride. Cement circulated.
Red bed shale	265	450	
Anhydrite	450	875	
Shale and shells	875	1580	
Line	1580	2360	
Line and shale	2360	2500	
Shale	2500	2635	
Shale and line	2635	2785	
Shale	2785	2990	
Line	2990	3120	
Line and shale	3120	3215	
Line	3215	3200	
Line and shale	3200	3225	
Shale	3225	3205	
Chalky line and shale	3205	3352	

Line	3352	4042	
Shale and line	4042	5000	
Light gray and light tan, finely crystalline and creamy chalky line with trace of yellow to orange and brown translucent chert	5000	4550	Run Halliburton drill stem test No. 1, packer set at 4444', used 66' anchor, open 1 hour, very weak blow of air for 7 minutes, recovered 6' of drilling mud, IFF-201, FFP-201, SIF-237.
Line and chert	4550	4552	
Light gray, gray, light tan and brown fine crystalline to coarse crystalline line with trace of vuggy porosity, no stain; also trace clear to white transparent to opaque dense chert, no stain	4552	4674	
Line	4674	4694	Run Halliburton drill stem test No. 2, packer set at 4552', used 44' anchor, open 65 minutes, very weak blow of air for 6 minutes, recovered 5' of drilling mud, IFF-151, FFP-151, SIF-261. Max Schlumberger Survey.
TOTAL DEPTH	4694'		

Since commercial production of gas has not encountered in drilling to the total depth of 4694', regular authority was granted to plug and abandon the location.

On September 17, 1956, the well was plugged as follows:

Mud laden fluid	4694' to 260'
Lead plug	260'
20 sacks of cement	260' to 100'
Mud laden fluid	100' to 5'
Lead plug	5'
10 sacks of cement	5' to 5'
Surface soil	5' to 0'

**Plugged and abandoned**

REMARKS	PROD. BEG.	DATE COMPLETED
	4694'	0 1/2 1956
	260'	0 1/2 1956
	1000'	0 1/2 1956
	1250'	0 1/2 1956